

City of Detroit
**City Engineering Division, Department of Public Works
Survey Bureau**

NOTICE OF PROPOSED CHANGE IN PROPERTY

Date: 11/21/2016

Petition: x931

- | | |
|--|--|
| <input type="checkbox"/> AT&T Telecommunication | <input type="checkbox"/> Berm Use |
| <input type="checkbox"/> Comcast Television (CATV) | <input checked="" type="checkbox"/> Conversion to Easement |
| <input checked="" type="checkbox"/> Detroit Edison (DTE) | <input type="checkbox"/> Dedication |
| <input type="checkbox"/> Fire Department | <input type="checkbox"/> Encroachment |
| <input type="checkbox"/> Great Lakes Water Authority | <input type="checkbox"/> Temporary Closing |
| <input type="checkbox"/> Michcon (DTE) | <input checked="" type="checkbox"/> Vacation |
| <input type="checkbox"/> Planning & Development Department | |
| <input type="checkbox"/> Public Lighting Authority | |
| <input type="checkbox"/> Public Lighting Department | |
| <input type="checkbox"/> Police Department | |
| <input type="checkbox"/> Solid Waste Division, DPW | |
| <input type="checkbox"/> Street Design Bureau, DPW | |
| <input type="checkbox"/> Street Maintenance Division, DPW | |
| <input type="checkbox"/> Traffic Engineering Division, DPW | |
| <input type="checkbox"/> Water and Sewerage Department | |
| <input type="checkbox"/> _____ | |

A petition drawing is attached. Property shown on the attached print is proposed to be changed as indicated. Kindly report (using the back of this sheet) the nature of your services, if any affected by the proposed change and the estimated costs of removing and rerouting such services (if necessary).

Please return one copy to City Engineering Division, DPW within two weeks of the submittal date. Retain one copy and print for you file.

Ron Brundidge, Director, Department of Public Works

By: Richard Doherty, CED DPW
City Engineer

**TO: City Engineering Division, DPW
2 Woodward Ave., Suite 642
Detroit, Michigan 48226-3462
Survey Bureau: 313-224-3970**

Petition: x931

The proposed change in property (referred to on the other side of this sheet) would affect our services as follows:

Not Involved

Involved; but asking you to hold action on this petition until further notice.

Involved; but no objections to the property change.

FOR CONVERSION TO EASEMENT:

Involved; but no objections to the property change...provided as easement of the full width of the public right-of-way (street, alley or other public place) is reserved.

FOR VACATION:

Involved; the nature of our services and the estimated costs of removing and/or rerouting such services are: \$92,148.98

DTE Electric Company
(Utility or City Department)

Kimberly A. Tassen
By

Right of Way Facilitator
Title

12/05/2016
Date

313.235.4458
Area code – Telephone number

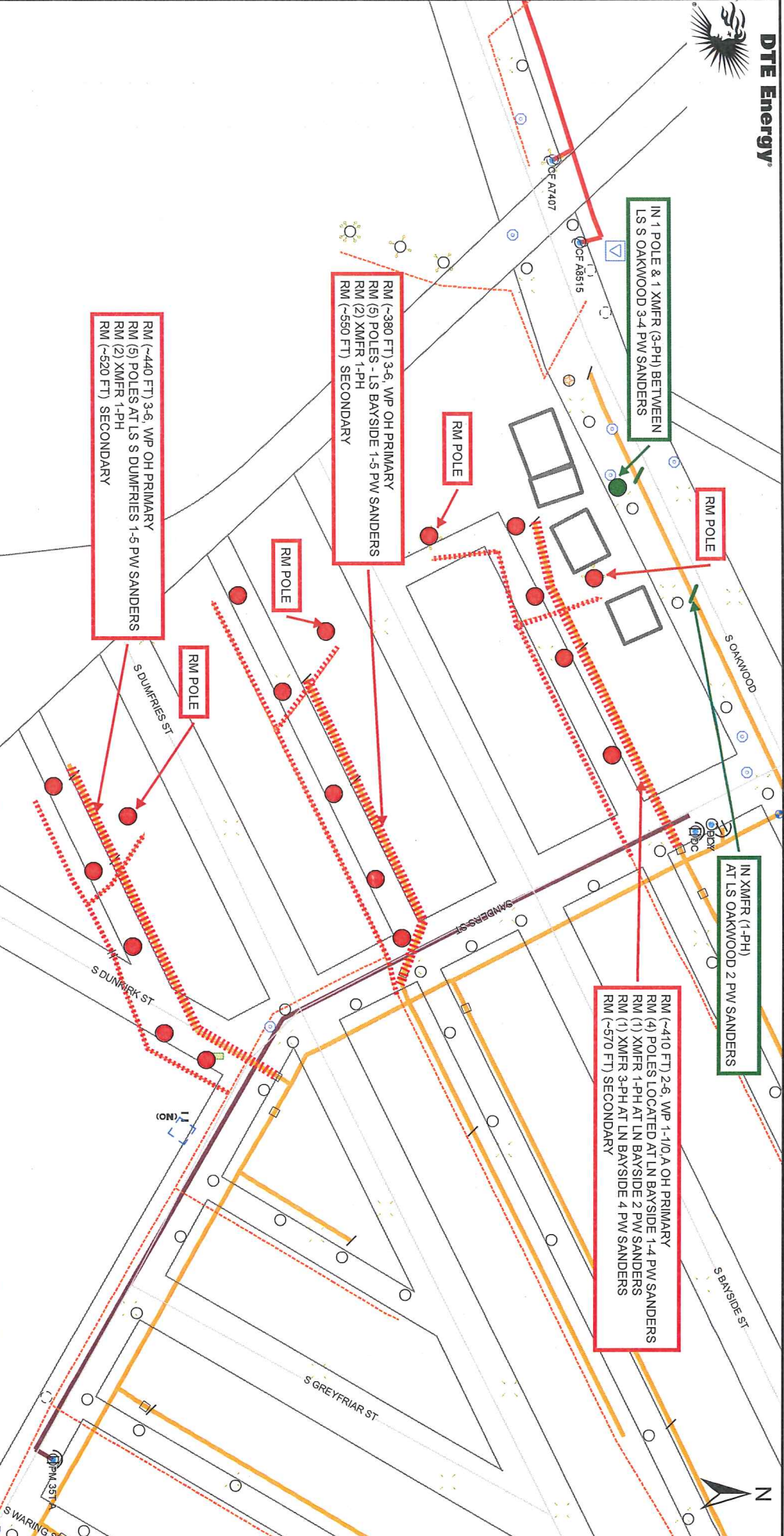

IN 1 POLE & 1 XMFR (3-PH) BETWEEN LS S OAKWOOD 3-4 PW SANDERS

RM POLE

RM (~380 FT) 3-6, WP OH PRIMARY
RM (5) POLES - LS BAYSIDE 1-5 PW SANDERS
RM (2) XMFR 1-PH
RM (~550 FT) SECONDARY

RM POLE

RM (~440 FT) 3-6, WP OH PRIMARY
RM (5) POLES AT LS S DUNPRIES 1-5 PW SANDERS
RM (2) XMFR 1-PH
RM (~520 FT) SECONDARY

RM POLE

IN XMFR (1-PH) AT LS OAKWOOD 2 PW SANDERS

RM (~410 FT) 2-6, WP 1-1/0, A OH PRIMARY
RM (4) POLES LOCATED AT LN BAYSIDE 1-4 PW SANDERS
RM (1) XMFR 1-PH AT LN BAYSIDE 2 PW SANDERS
RM (1) XMFR 3-PH AT LN BAYSIDE 4 PW SANDERS
RM (~570 FT) SECONDARY

<p>CONCEPTUAL DESIGN CIAC COST: \$92,148,98</p>		<p>REASON FOR WORK: Per customer request to remove DTE equipment located at Detroit Salt Company's property and installing required equipment for service.</p>	
<p>APPROVED</p>		<p>DTE ELECTRIC COMPANY REGIONAL PLANNING</p>	
<p>LAYOUT BY A SHARMA</p>		<p>DRAWN BY</p>	
<p>DATE 05/12/2016</p>		<p>DRAWING NUMBER</p>	
<p>SCALE NONE</p>		<p>N/A</p>	
		<p>EG</p>	