

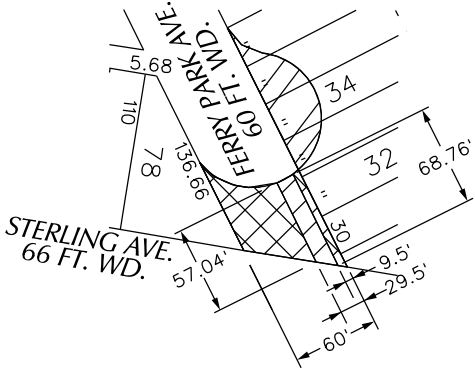

PETITION NO. 930
GIFFELS WEBSTER
28 W. ADAMS, SUITE 1200
DETROIT, MICHIGAN 48226
C/O JOHN REDASH
PHONE NO. 313 962-4442

"REVISED"

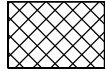

-  - REQUESTED FOR DEDICATION
-  - CONVERSION TO EASEMENT
-  - OUTRIGHT VACATION

I	ADDING A CONVERSION TO EASEMENT AT FERRY PARK AVE. 20 FT. WD. BETWEEN THE CUL-DE-SAC AND STERLING AVE.	WLW	KSM	KSM	1/30/17
H	ADDING A DEDICATION R.O.W. ON MILWAUKEE AVE. TO 73 FT. WD. BETWEEN LINCOLN AND JOHN C. LODGE	WLW	KSM	KSM	1/30/17
G	INCREASE DEDICATION R.O.W. ON LINCOLN AVE. TO 100 FT. WD. BETWEEN MILWAUKEE AND W. GRD. BLVD.	WLW	KSM	KSM	1/30/17
F	REDUCING PREVIOUS VACATION AREA BOUNDARY ON LINCOLN AVE.	WLW	KSM	KSM	6/24/16
E	REMOVING VACATION REQUEST ON PUBLIC ALLEYWAY	WLW	KSM	KSM	6/24/16
D	ADDING A PUBLIC ALLEYWAY (DEDICATION)	WLW	KSM	KSM	6/24/16
C	ADDING A NEW DEDICATION ON THE SOUTHSIDE OF MILWAUKEE AVE.	WLW	KSM	KSM	6/24/16
B	MILWAUKEE AVE. R.O.W. INCREASED TO 70 FT. WD. (DEDICATION)	WLW	KSM	KSM	6/24/16
A	ADDING A TURNAROUND (DEDICATION)	WLW	KSM	KSM	6/24/16
DESCRIPTION		DRWN	CHKD	APPD	DATE
REVISIONS					
DRAWN BY	WLW	CHECKED			
DATE	04-04-16	APPROVED			

REQUEST TO OUTRIGHT VACATE VARIOUS PUBLIC STREETS AND ALLEYS VARIOUS WIDTHS
REQUEST CONVERSION TO EASTMENT A PORTION OF FERRY PARK AVE., 20 FT. WD.
AND

REQUEST FOR DEDICATION LINCOLN AVE. 100 FT. WD., FERRY PARK AVE., 30 FT. RADIUS AND W. MILWAUKEE AVE. VARIOUS WIDTHS
IN THE AREA BOUND BY JOHN C. LODGE FWY., BALTIMORE, LINCOLN, HOLDEN AVE. AND W. GRAND BLVD.

(FOR OFFICE USE ONLY)

CARTO 31 D

CITY OF DETROIT CITY ENGINEERING DEPARTMENT SURVEY BUREAU	
JOB NO.	01-01
DRWG. NO.	X 930