

TO: City Engineering Division, DPW
2 Woodward Ave., Suite 642
Detroit, MI 48226-3462
Survey Bureau: 313-224-3970

Ref. No. 201604002
Petition No. 930 *Revised*

The proposed change in property (referred to above) would affect our services as follows:

- () Not Involved.
- () Involved; but asking you to hold action on this petition until further notice.
- () Involved; the nature of our services, and the estimated costs of removing and/or rerouting such services are:
- (X) Involved; have no objection to the request to outright vacate various public streets and alleys various widths and request conversion to easement a portion of Ferry Park Ave., 20 ft wide and request for dedication Lincoln Ave. 100 ft wide, Ferry Park Ave., 30 ft radius and W. Milwaukee Ave. various widths in the area bound by John C. Lodge Fwy., Baltimore, Lincoln, Holden Ave. and W. Grand Blvd. as shown on drawing no. x 930 dated 4/4/2016 and revised on 6/24/2016 and 1/30/2017 provided that 100% signatures of abutting property owners are secured.

Traffic Engineering Division - DPW
(Utility or City Department)

for Ashok Patel
By 

City Traffic Engineer
Title

March 10, 2017
Date

313 224-1610
Area code-Telephone number

MA/ma

PETITION NO. 930
GIFFELS WEBSTER
28 W. ADAMS, SUITE 1200
DETROIT, MICHIGAN 48226
C/O JOHN REDASH
PHONE NO. 313 962-4442

"REVISED"

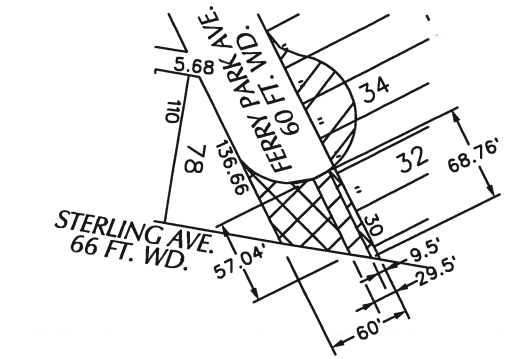

- REQUESTED FOR DEDICATION
- CONVERSION TO EASEMENT
- OUTRIGHT VACATION

I	ADDING A CONVERSION TO EASEMENT AT FERRY PARK AVE. 20 FT. WD. BETWEEN THE CLUB-DE-SAC AND STERLING AVE.	WLW	KSM	KSM	1/30/17
H	ADDING A DEDICATION R.O.W. ON MILWAUKEE AVE. TO 73 FT. WD. BETWEEN LINCOLN AND JOHN C. LODGE	WLW	KSM	KSM	1/30/17
G	INCREASE DEDICATION R.O.W. ON LINCOLN AVE. TO 100 FT. WD. BETWEEN MILWAUKEE AND W. CD. BLVD.	WLW	KSM	KSM	1/30/17
F	REDUCING PREVIOUS VACATION AREA BOUNDARY ON LINCOLN AVE.	WLW	KSM	KSM	6/24/16
E	REMOVING VACATION REQUEST ON PUBLIC ALLEYWAY	WLW	KSM	KSM	6/24/16
D	ADDING A PUBLIC ALLEYWAY (DEDICATION)	WLW	KSM	KSM	6/24/16
C	ADDING A NEW DEDICATION ON THE SOUTHSIDE OF MILWAUKEE AVE.	WLW	KSM	KSM	6/24/16
B	MILWAUKEE AVE. R.O.W. INCREASED TO 70 FT. WD. (DEDICATION)	WLW	KSM	KSM	6/24/16
A	ADDING A TURNAROUND (DEDICATION)	WLW	KSM	KSM	6/24/16
REVISIONS					
DESCRIPTION	DRWN	CHKD	APPD	DATE	
DRAWN BY	WLW	CHECKED			
DATE	04-04-16	APPROVED			

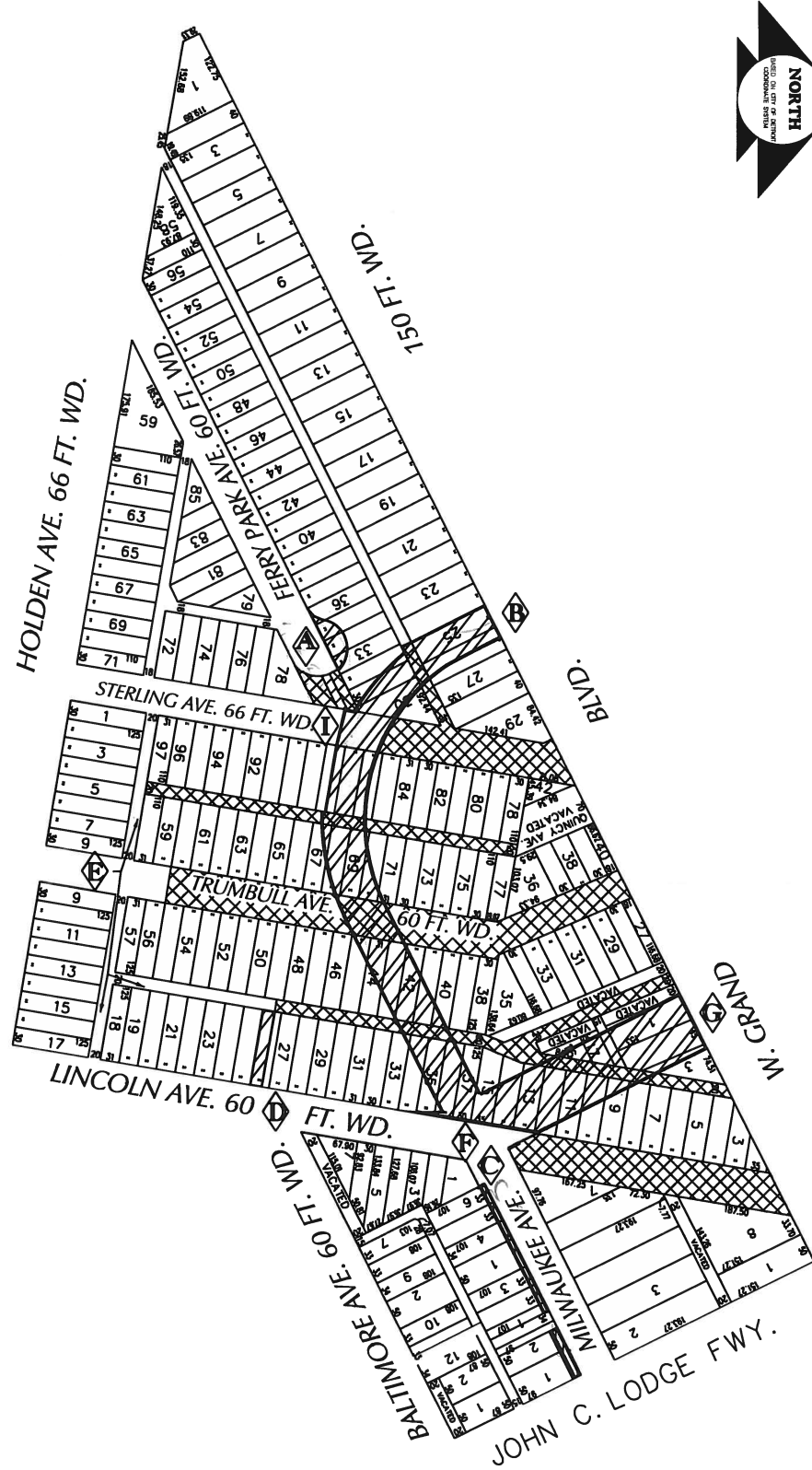

(FOR OFFICE USE ONLY)

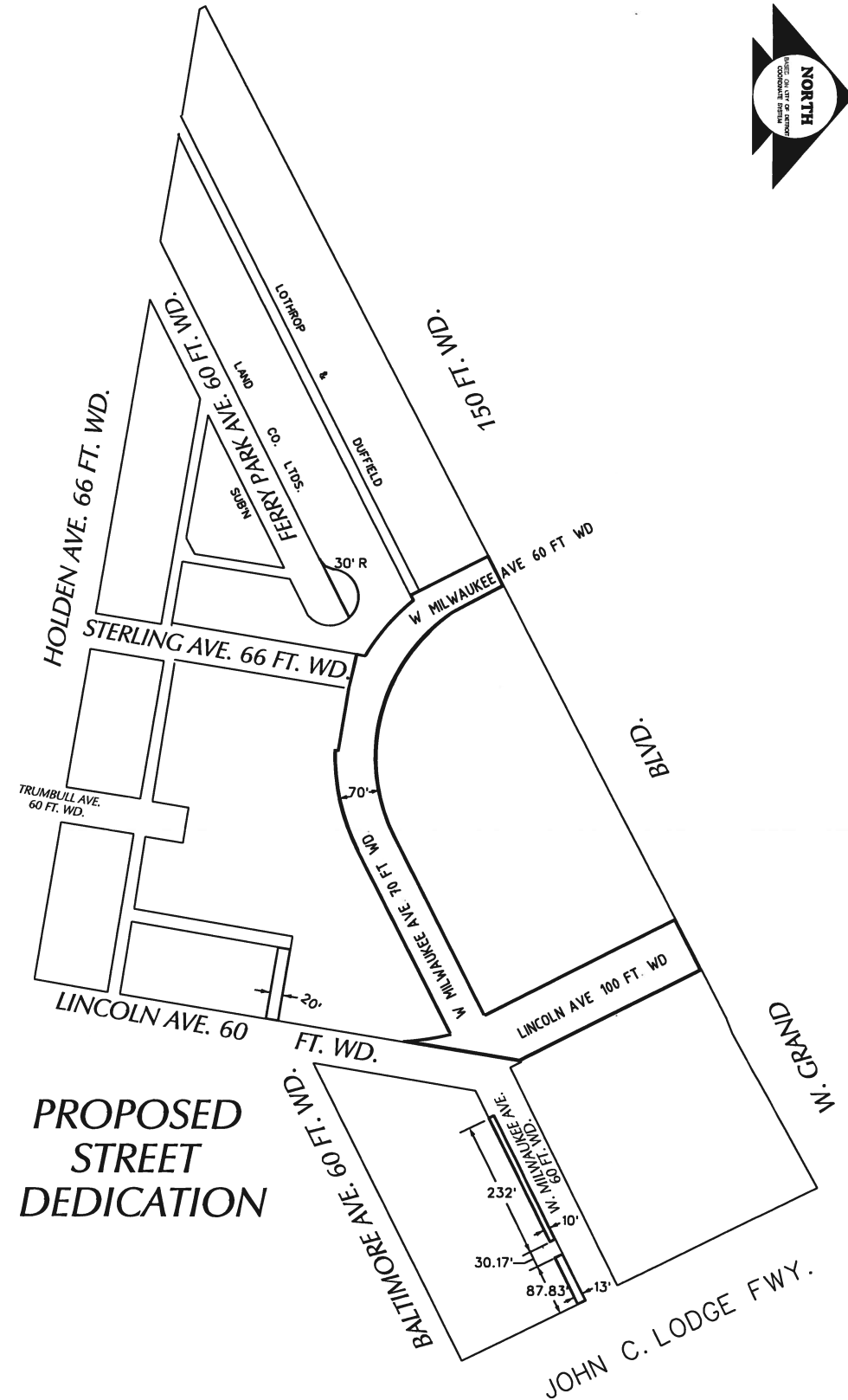

PROPOSED
STREET
DEDICATION

CARTO 31 D

REQUEST TO OUTRIGHT VACATE VARIOUS PUBLIC STREETS AND ALLEYS VARIOUS WIDTHS
REQUEST CONVERSION TO EASTMENT A PORTION OF FERRY PARK AVE., 20 FT. WD.
AND
REQUEST FOR DEDICATION LINCOLN AVE. 100 FT. WD., FERRY PARK AVE., 30 FT. RADIUS AND W. MILWAUKEE AVE. VARIOUS WIDTHS
IN THE AREA BOUND BY JOHN C. LODGE FWY., BALTIMORE, LINCOLN, HOLDEN AVE. AND W. GRAND BLVD.

CITY OF DETROIT CITY ENGINEERING DEPARTMENT SURVEY BUREAU	
JOB NO.	01-01
DRWG. NO.	X 930