

"REVISED"

City of Detroit City Engineering Division, Department of Public Works Survey Bureau

NOTICE OF PROPOSED CHANGE IN PROPERTY

Date: 03/07/2017

Petition: x930

- | | |
|---|--|
| <input type="checkbox"/> AT&T Telecommunication | <input type="checkbox"/> Berm Use |
| <input type="checkbox"/> Comcast Television (CATV) | <input checked="" type="checkbox"/> Conversion to Easement |
| <input type="checkbox"/> Detroit Edison (DTE) | <input checked="" type="checkbox"/> Dedication |
| <input type="checkbox"/> Fire Department | <input type="checkbox"/> Encroachment |
| <input type="checkbox"/> Great Lakes Water Authority | <input type="checkbox"/> Temporary Closing |
| <input type="checkbox"/> Michcon (DTE) | <input checked="" type="checkbox"/> Vacation |
| <input type="checkbox"/> Planning & Development Department | |
| <input type="checkbox"/> Public Lighting Authority | |
| <input type="checkbox"/> Public Lighting Department | |
| <input type="checkbox"/> Police Department | |
| <input type="checkbox"/> Solid Waste Division, DPW | |
| <input type="checkbox"/> Street Design Bureau, DPW | |
| <input type="checkbox"/> Street Maintenance Division, DPW | |
| <input type="checkbox"/> Traffic Engineering Division, DPW | |
| <input checked="" type="checkbox"/> Water and Sewerage Department | |
| <input type="checkbox"/> _____ | |

A petition drawing is attached. Property shown on the attached print is proposed to be changed as indicated. Kindly report (using the back of this sheet) the nature of your services, if any affected by the proposed change and the estimated costs of removing and rerouting such services (if necessary).

Please return one copy to City Engineering Division, DPW within two weeks of the submittal date. Retain one copy and print for you file.

Ron Brundidge, Director, Department of Public Works

By: Richard Doherty, CED DPW
City Engineer

TO: City Engineering Division, DPW
2 Woodward Ave., Suite 642
Detroit, Michigan 48226-3462
Survey Bureau: 313-224-3970

Petition: x930
"REVISED"

The proposed change in property (referred to on the other side of this sheet) would affect our services as follows:

- ☒ Not Involved *C SEE 07/23/16 LETTER*
- ☐ Involved; but asking you to hold action on this petition until further notice.
- ☐ Involved; but no objections to the property change.
- ☐ Involved; objection to the property change.
- ☐ Involved; but no objections to the property change...provided as easement of the full width of the public right-of-way (street, alley or other public place) is reserved.
- ☐ Involved; the nature of our services and the estimated costs of removing and/or rerouting such services are:

GLWA
(Utility or City Department)

DALE ECHOLS
By

ENG TECH II
Title

MARCH 8, 2017
Date

(313) 267-4857
Area code - Telephone number



July 23, 2016

City Engineering Division DPW
Real Estate Group
2 Woodward Ave., Suite 642
Detroit, MI 48226-3462

Attention: Richard Doherty CED DPW,
City Engineer

RE: Petition Number X930 REVISED
Request to Outright Vacate Various Public Streets and Alleys various widths
And Request For Dedication In the Area Bound by John C. Lodge Fwy,
Baltimore, Lincoln, Holden Avenue and W. Grand Boulevard
JOB Number: 01-01 / Drawing Number: X930
Detroit, MI

GLWA GPET 1609

This is in response to your notice dated July 11, 2016 and received by our office on the same by email.

A review of the above plans with our department records indicates no apparent conflict with our water and sewer utilities. No involvement with GLWA.

For locations regarding water and sewer facilities owned and operated by communities other than Great Lakes Water Authority (GLWA), **contact the local community/authority or private concern involved for updated information:**

✓ City of Detroit

If you have questions regarding the above, please call (313) 267-4857 or email: dale.echols@glwater.org
Please send plans and correspondence to:

Dale Echols ET CADD
DWSD / GLWA FIELD ENGINEERING
North Administration Building - CSF
6425 Huber Street, 1st Floor
Detroit, MI 48211-1677

Very Truly Yours,

Dale Echols

Digitally signed by Dale Echols
DN: cn=Dale Echols, o=GLWA,
ou=Field Engineering, email=dale.
echols@glwater.org, c=US
Date: 2016.07.23 15:00:05 -04'00'

Dale Echols ET CADD

DE/dle/Letters PET
cc: PETITIONS

PETITION NO. 930
 GIFFELS WEBSTER
 28 W. ADAMS, SUITE 1200
 DETROIT, MICHIGAN 48226
 C/O JOHN REDASH
 PHONE NO. 313 962-4442

"REVISED"

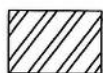
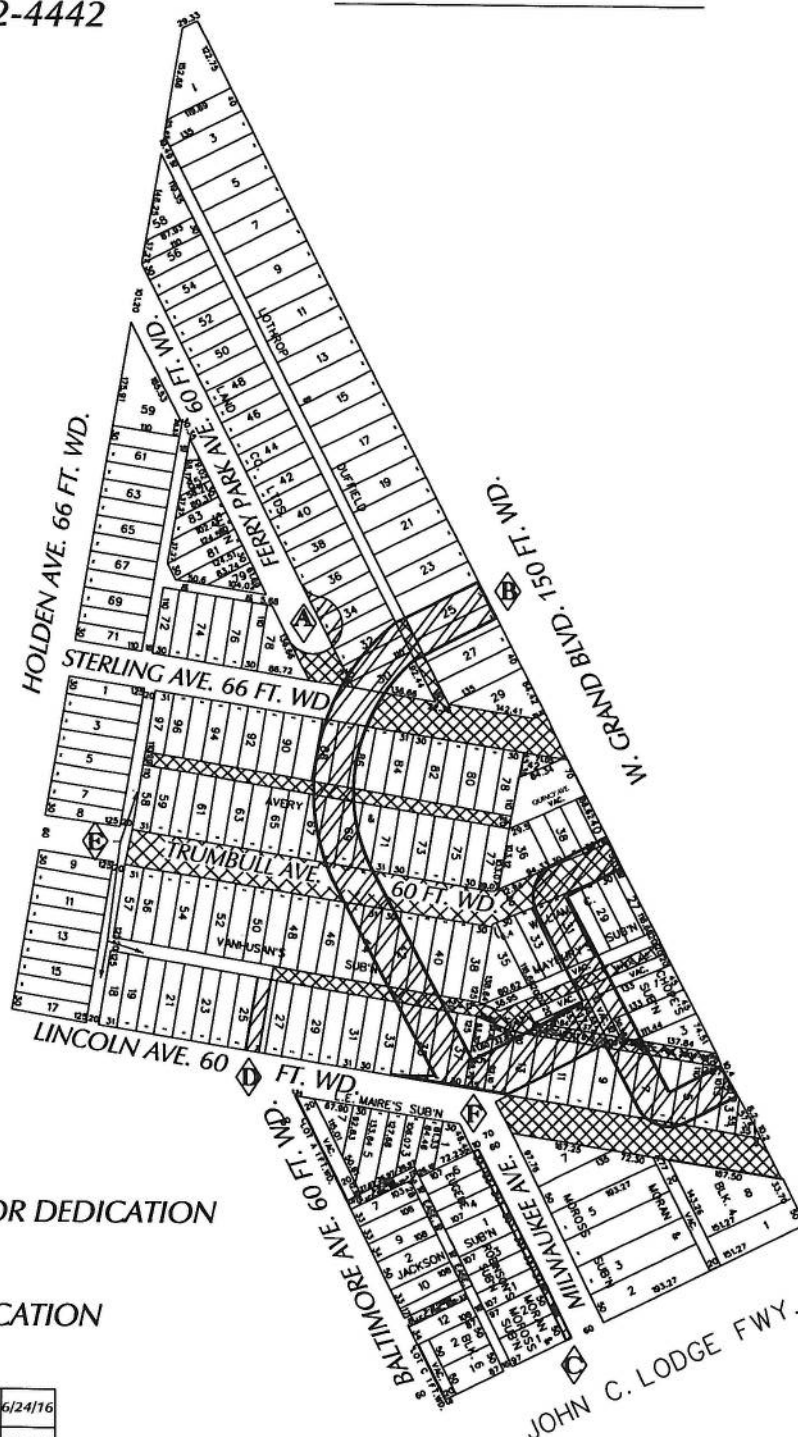

- REQUESTED FOR DEDICATION



- OUTRIGHT VACATION

F	REVISED: REDUCING PREVIOUS VACATION AREA BOUNDARY ON LINCOLN AVE.	WLW	KSM	KSM	6/24/16
E	REVISED: REMOVING VACATION REQUEST ON PUBLIC ALLEYWAY	WLW	KSM	KSM	6/24/16
D	REVISED: ADDING A PUBLIC ALLEYWAY (DEDICATION)	WLW	KSM	KSM	6/24/16
C	REVISED: ADDING A NEW DEDICATION ON THE SOUTHSIDE OF MILWAUKEE AVE.	WLW	KSM	KSM	6/24/16
B	REVISED: MILWAUKEE AVE. R.O.W. INCREASED TO 70 FT. WD. (DEDICATION)	WLW	KSM	KSM	6/24/16
A	REVISED: ADDING A TURNAROUND (DEDICATION)	WLW	KSM	KSM	6/24/16
DESCRIPTION		DRWN	CHKD	APPD	DATE
REVISIONS					
DRAWN BY		WLW			
DATE		04-04-16			
		CHECKED			
		APPROVED			

(FOR OFFICE USE ONLY)

CARTO 31 D

REQUEST TO OUTRIGHT VACATE
 VARIOUS PUBLIC STREETS AND ALLEYS VARIOUS WIDTHS AND
 REQUEST FOR DEDICATION IN THE AREA BOUND BY
 JOHN C. LODGE FWY., BALTIMORE, LINCOLN, HOLDEN AVE.
 AND W. GRAND BLVD.

CITY OF DETROIT CITY ENGINEERING DEPARTMENT SURVEY BUREAU	
JOB NO.	01-01
DRWG. NO.	X 930