

# **"REVISED"**

City of Detroit  
**City Engineering Division, Department of Public Works  
Survey Bureau**

**NOTICE OF PROPOSED CHANGE IN PROPERTY**

Date: 03/07/2017

Petition: x930

- |  |  |
|--|--|
| <input type="checkbox"/> AT&T Telecommunication            | <input type="checkbox"/> Berm Use                          |
| <input type="checkbox"/> Comcast Television (CATV)         | <input checked="" type="checkbox"/> Conversion to Easement |
| <input type="checkbox"/> Detroit Edison (DTE)              | <input checked="" type="checkbox"/> Dedication             |
| <input checked="" type="checkbox"/> Fire Department        | <input type="checkbox"/> Encroachment                      |
| <input type="checkbox"/> Great Lakes Water Authority       | <input type="checkbox"/> Temporary Closing                 |
| <input type="checkbox"/> Michcon (DTE)                     | <input checked="" type="checkbox"/> Vacation               |
| <input type="checkbox"/> Planning & Development Department |  |
| <input type="checkbox"/> Public Lighting Authority         |  |
| <input type="checkbox"/> Public Lighting Department        |  |
| <input type="checkbox"/> Police Department                 |  |
| <input type="checkbox"/> Solid Waste Division, DPW         |  |
| <input type="checkbox"/> Street Design Bureau, DPW         |  |
| <input type="checkbox"/> Street Maintenance Division, DPW  |  |
| <input type="checkbox"/> Traffic Engineering Division, DPW |  |
| <input type="checkbox"/> Water and Sewerage Department     |  |
| <input type="checkbox"/> _____                             |  |

A petition drawing is attached. Property shown on the attached print is proposed to be changed as indicated. Kindly report (using the back of this sheet) the nature of your services, if any affected by the proposed change and the estimated costs of removing and rerouting such services (if necessary).

Please return one copy to City Engineering Division, DPW within two weeks of the submittal date. Retain one copy and print for you file.

Ron Brundidge, Director, Department of Public Works

By: Richard Doherty, CED DPW  
City Engineer

TO: City Engineering Division, DPW  
2 Woodward Ave., Suite 642  
Detroit, Michigan 48226-3462  
Survey Bureau: 313-224-3970

Petition: x930  
"REVISED"

The proposed change in property (referred to on the other side of this sheet) would affect our services as follows:

- ☐ Not Involved
- ☐ Involved; but asking you to hold action on this petition until further notice.
- ☐ Involved; but no objections to the property change.
- ☐ Involved; objection to the property change.
- ☒ Involved; but no objections to the property change...provided as easement of the full width of the public right-of-way (street, alley or other public place) is reserved.  
*MAINTAIN FIRE DEPT VEHICLE ACCESS TO ALL BUILDINGS IN CASE OF FIRE OR OTHER EMERGENCY*
- ☐ Involved; the nature of our services and the estimated costs of removing and/or rerouting such services are:

Fire  
(Utility or City Department)

Glenn Thomas  
By

Chief  
Title

3-9-17  
Date

224-1311  
Area code – Telephone number

# "REVISED"

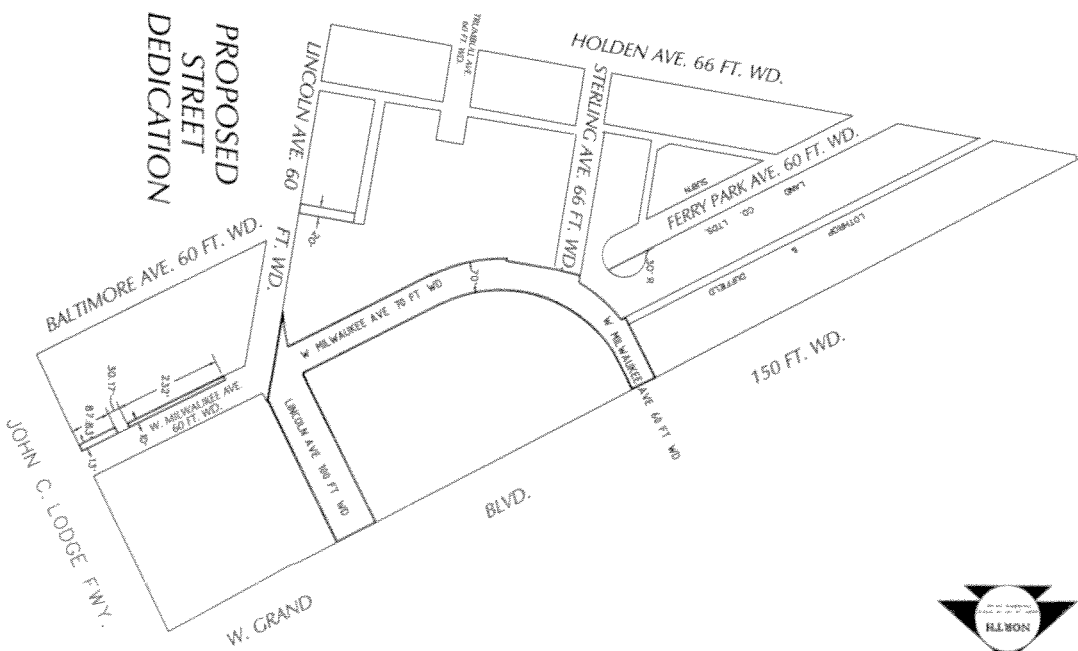
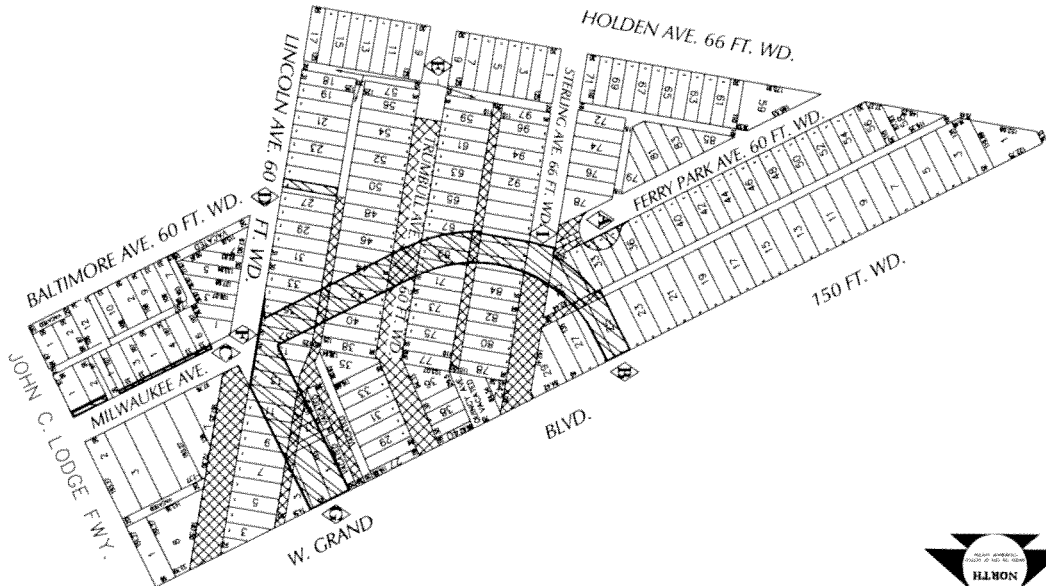
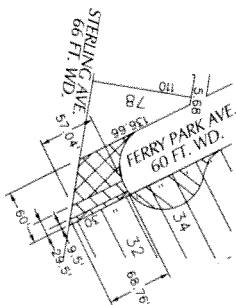
[illegible]

REQUEST TO OUTRIGHT VACATE VARIOUS PUBLIC STREETS AND ALLEYS VARIOUS WIDTHS  
REQUEST CONVERSION TO EASEMENT A PORTION OF FERRY PARK AVE., 20 FT. WD.  
AND  
REQUEST FOR DEDICATION LINCOLN AVE. 100 FT. WD., FERRY PARK AVE., 30 FT. RADIUS AND W. MILWAUKEE AVE. VARIOUS WIDTHS  
IN THE AREA BOUND BY JOHN C. LODGE FWY., BALTIMORE, LINCOLN, HOLDEN AVE. AND W. GRAND BLVD.

CITY OF DETROIT  
CITY ENGINEERING DEPARTMENT  
SURVEY BUREAU  
JOB NO. 01-07  
DRAWING NO. X 930