

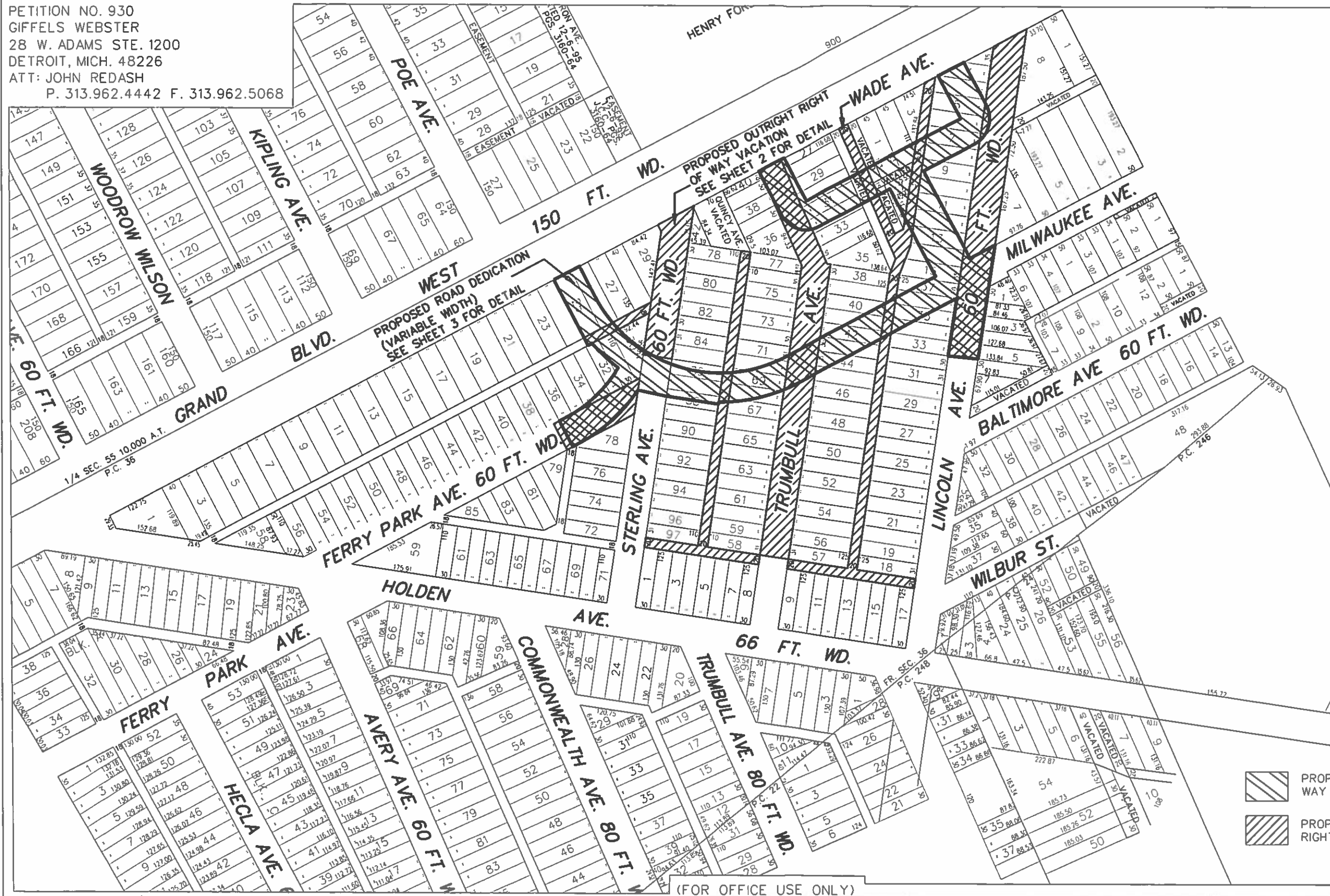

PETITION NO. 930  
 GIFFELS WEBSTER  
 28 W. ADAMS STE. 1200  
 DETROIT, MICH. 48226  
 ATT: JOHN REDASH  
 P. 313.962.4442 F. 313.962.5068

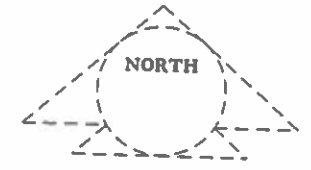

 PROPOSED RIGHT OF WAY DEDICATION  
 PROPOSED OUTRIGHT RIGHT OF WAY VACATION  
 CARTOGRAPHIC MAP NO. 31-C  
 CARTOGRAPHIC MAP NO. 31-D

(FOR OFFICE USE ONLY)

B				
A				
DESCRIPTION				
DRWN	CHKD	APPD	DATE	
REVISIONS				
DRAWN BY		CHECKED		
DATE		APPROVED		
02/04/16				

TO OUTRIGHT VACATE A PORTION OF FERRY PARK AVENUE, STERLING AVENUE, TRUMBULL AVENUE AND LINCOLN AVENUE. ALSO, TO INCLUDE VACATION OF ALL ALLEYS IN THE AREA OF STERLING, GRAND BLVD. WEST, TRUMBULL AND HOLDEN, AND INCLUDE VACATION OF SOME ALLEYS LOCATED IN THE BLOCK BOUNDED BY TRUMBULL AVENUE, GRAND BLVD. WEST, LINCOLN AVENUE, AND HOLDEN AVENUE. TO DEDICATE A NEW RIGHT-OF-WAY IN THE AREA BOUNDED BY GRAND BLVD WEST, LINCOLN, AND HOLDEN.

**CITY OF DETROIT**  
 CITY ENGINEERING DEPARTMENT  
 SURVEY BUREAU  
 JOB NO. 01-01  
 DRWG. NO. X-XXX.DGN

PETITION NO. 930  
 GIFFELS WEBSTER  
 28 W. ADAMS STE. 1200  
 DETROIT, MICH. 48226  
 ATT: JOHN REDASH  
 P. 313.962.4442 F. 313.962.5068

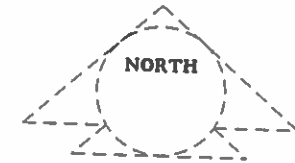

 PROPOSED OUTRIGHT  
 RIGHT OF WAY VACATION

CARTOGRAPHIC MAP NO. 31-C  
 CARTOGRAPHIC MAP NO. 31-D

(FOR OFFICE USE ONLY)

<b>B</b>				
<b>A</b>				
<b>DESCRIPTION</b>	<b>DRAWN</b>	<b>CHKD</b>	<b>APPD</b>	<b>DATE</b>
<b>REVISIONS</b>				
<b>DRAWN BY</b>	<b>CHECKED</b>			
<b>DATE</b>	<b>APPROVED</b>			
02/04/16				

TO OUTRIGHT VACATE A PORTION OF FERRY PARK AVENUE, STERLING AVENUE, TRUMBULL AVENUE AND LINCOLN AVENUE.  
 ALSO, TO INCLUDE VACATION OF ALL ALLEYS IN THE AREA OF STERLING, GRAND BLVD. WEST, TRUMBULL AND HOLDEN, AND INCLUDE VACATION OF  
 SOME ALLEYS LOCATED IN THE BLOCK BOUNDED BY TRUMBULL AVENUE, GRAND BLVD. WEST, LINCOLN AVENUE, AND HOLDEN AVENUE.

**CITY OF DETROIT**  
**CITY ENGINEERING DEPARTMENT**  
**SURVEY BUREAU**

**JOB NO.** 01-01  
**DRWG. NO.** X-XXX.DGN

PETITION NO. 930  
 GIFFELS WEBSTER  
 28 W. ADAMS STE. 1200  
 DETROIT, MICH. 48226  
 ATT: JOHN REDASH  
 P. 313.962.4442 F. 313.962.5068

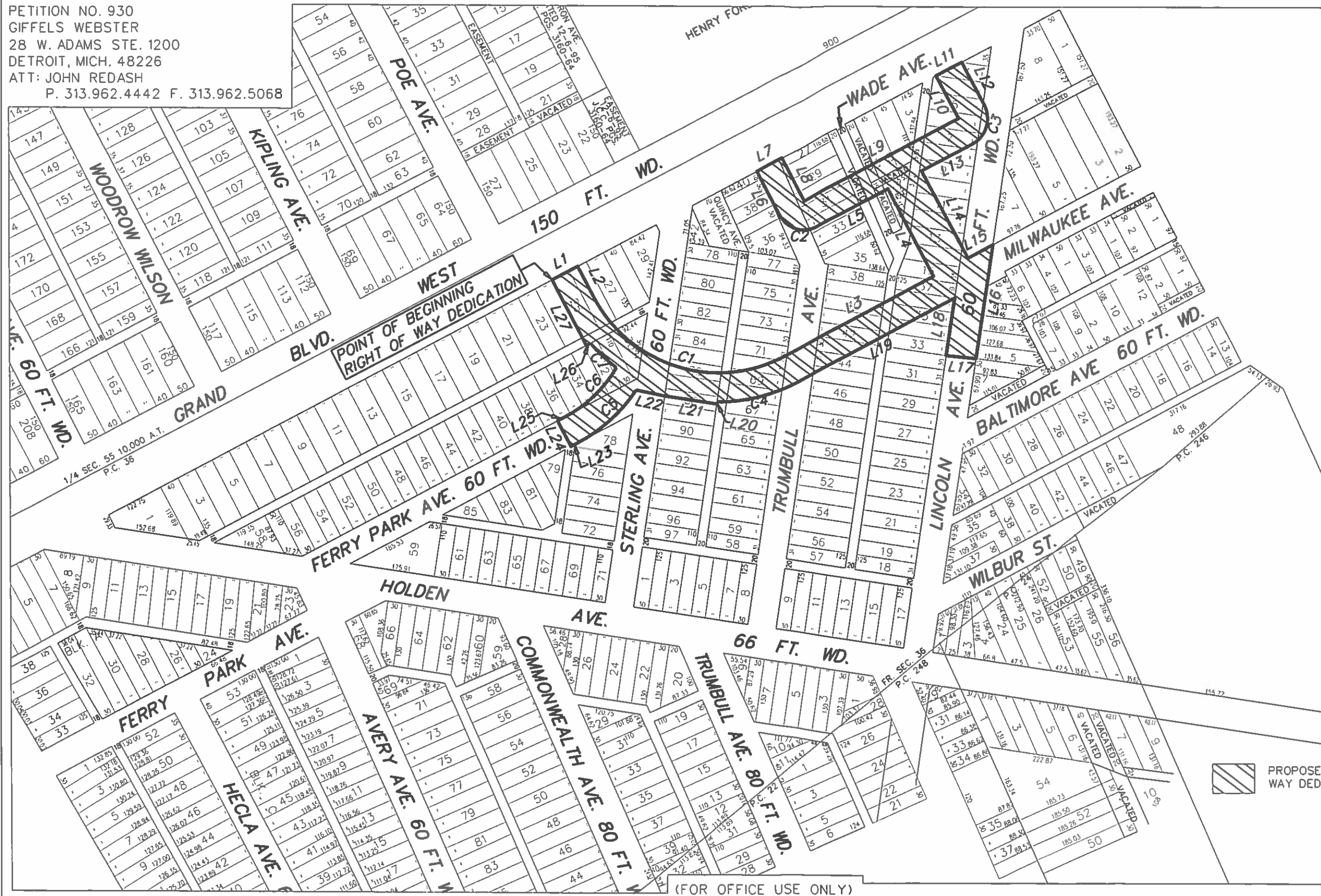
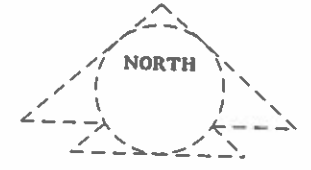

 PROPOSED RIGHT OF WAY DEDICATION

CARTOGRAPHIC MAP NO. 31-C  
 CARTOGRAPHIC MAP NO. 31-D

(FOR OFFICE USE ONLY)

TO DEDICATE A NEW RIGHT-OF-WAY IN THE AREA BOUNDED BY GRAND BLVD WEST, LINCOLN AVENUE, AND HOLDEN AVENUE.

<b>B</b>				
<b>A</b>				
<b>DESCRIPTION</b>	<b>DRAWN</b>	<b>CHKD</b>	<b>APPD</b>	<b>DATE</b>
<b>REVISIONS</b>				
<b>DRAWN BY</b>	<b>CHECKED</b>			
<b>DATE</b>	<b>APPROVED</b>			
02/04/16				

**CITY OF DETROIT**  
**CITY ENGINEERING DEPARTMENT**  
**SURVEY BUREAU**

**JOB NO.** 01-01  
**DRWG. NO.** X-XXX.DGN

PETITION NO. 930  
 GIFFELS WEBSTER  
 28 W. ADAMS STE. 1200  
 DETROIT, MICH. 48226  
 ATT: JOHN REDASH  
 P. 313.962.4442 F. 313.962.5068

**PARCEL LINE DATA**

LINE #	BEARING	DISTANCE
L1	N62°13'54"E	60.00'
L2	S27°46'06"E	70.60'
L3	N62°13'44"E	354.64'
L4	N27°51'30"W	204.58'
L5	S62°13'54"W	166.33'
L6	N27°50'49"W	100.08'
L7	N62°13'54"E	60.00'
L8	S27°50'49"E	100.00'
L9	N62°13'54"E	364.78'
L10	N27°51'55"W	100.00'
L11	N62°13'54"E	60.00'
L12	S27°51'55"E	99.90'
L13	S62°13'54"W	118.45'
L14	S27°51'30"E	204.54'
L15	N62°13'54"E	58.78'
L16	S8°39'41"W	237.43'
L17	N84°13'20"W	61.84'
L18	N8°26'22"E	119.99'
L19	S62°13'44"W	371.77'
L20	S8°49'36"W	4.15'

**PARCEL LINE DATA**

LINE #	BEARING	DISTANCE
L21	N81°27'56"W	110.00'
L22	N78°11'27"W	60.10'
L23	S61°09'58"W	16.88'
L24	N27°46'06"W	59.85'
L25	N62°23'42"E	17.05'
L26	S62°13'54"W	9.65'
L27	N27°46'06"W	152.70'

**PARCEL CURVE DATA**

CURVE #	LENGTH	RADIUS	DELTA	CH. BEARING	CHORD
C1	461.83'	294.00'	90°00'10"	S72°46'11"E	415.79
C2	94.17'	60.00'	89°55'17"	N72°48'27"W	84.79
C3	94.35'	60.00'	90°05'49"	S17°10'59"W	84.92
C4	174.45'	354.00'	28°14'07"	S76°20'47"W	172.69
C5	164.25'	330.00'	28°31'03"	S48°08'08"W	162.56
C6	150.04'	270.22'	31°48'49"	N46°28'50"E	148.12
C7	73.92'	354.00'	11°57'50"	N47°09'41"W	73.78

(FOR OFFICE USE ONLY)

<b>B</b>					
<b>A</b>					
DESCRIPTION	DRWN	CHD	APPD	DATE	
REVISIONS					
DRAWN BY	CHECKED				
DATE	APPROVED				
02/04/16					

<b>CITY OF DETROIT</b>	
CITY ENGINEERING DEPARTMENT	
SURVEY BUREAU	
JOB NO.	01-01
DRWG. NO.	X-XXX.DGN