

"REVISED"

**City of Detroit
City Engineering Division, Department of Public Works
Survey Bureau**

NOTICE OF PROPOSED CHANGE IN PROPERTY

Date: 7/5/2018
11/09/2017

*comp'd
7/16/2018
DWZ*

Petition: x1361 r2

- | | |
|--|--|
| <input type="checkbox"/> AT&T Telecommunication | <input type="checkbox"/> Berm Use |
| <input type="checkbox"/> Comcast Television (CATV) | <input checked="" type="checkbox"/> Conversion to Easement |
| <input checked="" type="checkbox"/> Detroit Edison (DTE) | <input type="checkbox"/> Dedication |
| <input type="checkbox"/> Fire Department | <input type="checkbox"/> Encroachment |
| <input type="checkbox"/> Great Lakes Water Authority | <input type="checkbox"/> Temporary Closing |
| <input type="checkbox"/> Michcon (DTE) | <input type="checkbox"/> Vacation |
| <input type="checkbox"/> Planning & Development Department | |
| <input type="checkbox"/> Public Lighting Authority | |
| <input type="checkbox"/> Public Lighting Department | |
| <input type="checkbox"/> Police Department | |
| <input type="checkbox"/> Solid Waste Division, DPW | |
| <input type="checkbox"/> Street Design Bureau, DPW | |
| <input type="checkbox"/> Street Maintenance Division, DPW | |
| <input type="checkbox"/> Traffic Engineering Division, DPW | |
| <input type="checkbox"/> Water and Sewerage Department | |
| <input type="checkbox"/> _____ | |

A petition drawing is attached. Property shown on the attached print is proposed to be changed as indicated. Kindly report (using the back of this sheet) the nature of your services, if any affected by the proposed change and the estimated costs of removing and rerouting such services (if necessary).

Please return one copy to City Engineering Division, DPW within two weeks of the submittal date. Retain one copy and print for you file.

Ron Brundidge, Director, Department of Public Works

By: Richard Doherty, CED DPW
City Engineer

TO: City Engineering Division, DPW
2 Woodward Ave., Suite 642
Detroit, Michigan 48226-3462
Survey Bureau: 313-224-3970

Petition: x1361
"REVISED"²

The proposed change in property (referred to on the other side of this sheet) would affect our services as follows:

- Not Involved
- Involved; but asking you to hold action on this petition until further notice.
- Involved; but no objections to the property change.
- Involved; but no objections to the property change...provided as easement of the full width of the public right-of-way (street, alley or other public place) is reserved.
DTE ENERGY MUST HAVE ACCESS TO OUR EQUIPMENT AT ALL TIMES. THE RELIABILITY OF ELECTRIC SERVICE WILL BE ADVERSELY AFFECTED IF WE CANNOT ACCESS OUR EQUIPMENT FOR MAINTENANCE & RESTORATION.
- Involved; the nature of our services and the estimated costs of removing and/or rerouting such services are:

DTE ENERGY
(Utility or City Department)

CHRISTINE LEW
By

SR. ENGINEER
Title

7/16/2018
Date

(313) 235-1804
Area code – Telephone number

PETITION NO. 1361
 GAUGI PROPERTIES GROUP INC.
 8930 MCGRAW AVE.
 DETROIT, MICHIGAN 48210
 C/O VINNIE SHOKRIE
 PHONE NO. 313 289-0165



"REVISED"



MICHIGAN AVE. 120 FT. WD.

- CONVERSION TO EASEMENT

(FOR OFFICE USE ONLY)

CARTO 13 E

B					CONVERSION TO EASEMENT THE EAST PORTION OF THE EAST/WEST PUBLIC ALLEY, VARIOUS WIDTHS IN THE BLOCK BOUND BY LIVERNOIS, MICHIGAN, GILBERT AVE. AND MORTON ST.	CITY OF DETROIT CITY ENGINEERING DEPARTMENT SURVEY BUREAU	
A						JOB NO. 01-01	
CHANGE FROM OUTRIGHT OCCUPANCY TO CONVERSION TO EASEMENT						DRWG. NO. X 1361	
DESCRIPTION							
DRAWN BY WLW							
DATE 02-08-17							
REVISIONS							
DRAWN BY WLW							
CHECKED							
DATE 02-08-17							
APPROVED							

#1361 r2

Petition request to Vacate an alley

August 8, 2016

The Honorable City Council

Attn: Office of the city Clerk

200 Coleman A. Young Municipal Center

Detroit, MI. 48226

1-Gaugi Properties Group Inc.

8930 McGraw St.

Detroit, MI. 48210

313-289-0165

Vinnie Shokrie

Convert to Easement
2-~~Vacate~~ an alley between the properties we own by the company.

3- 4201 Livernois Ave. and 4237 Livernois Ave.

~~4237 Livernois Ave. and 4332 Gilbert Ave.~~ *(Not in City Petition)*

4-As soon as possible.

5-for development and expansion. *- for truck turn around; nothing to be built in easement per
Phone discussion and email dated 7/8/2016*

Gaugi Properties Group Inc.

Vinnie Shokrie Vice Pres.

313-289-0165

CITY CLERK 29 NOV 2016 08:49

#1361r2

EMZELL
ADDRESS FOR BUILDING
SUBJECT LABEL
LOCATION: SPENCER MICHIGAN AVE SCHOOL 10

A E M COMMUNITY CENTER
1074 MICHIGAN AVE
ANN ARBOR MI 48104
PLANNING DEPT
ANN ARBOR MI 48104
REAR: 12
ADDRESS: 12
ANN ARBOR MI 48104

SUBJECTS
PLANNING DEPT
ADDRESS
DECKLING
DATE: 04/21/2008
SCALE: NOTED
SHEET TITLE
SITE PLAN
SP-1
SCALE

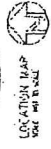
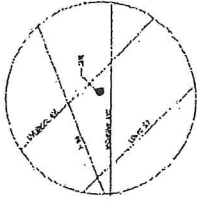

SITE DATA
 BUILDING HEIGHT: 18 FT
 PROPOSED BUILDING AREA: 11,167 SQ. FT.
 PROPOSED USE: RETAIL BUILDING
 ZONING DISTRICT: 14 (GENERAL BUSINESS DISTRICT)
 PLANNING DEPARTMENT OF SPENCER AVE.
 TOTAL NUMBER OF PARKING SPACES PROVIDED = 73 SPACES
 NUMBER OF 1-C. PARKING SPACES PROVIDED = 3 SPACES
 TOTAL NUMBER OF PARKING SPACES PROVIDED = 73 SPACES

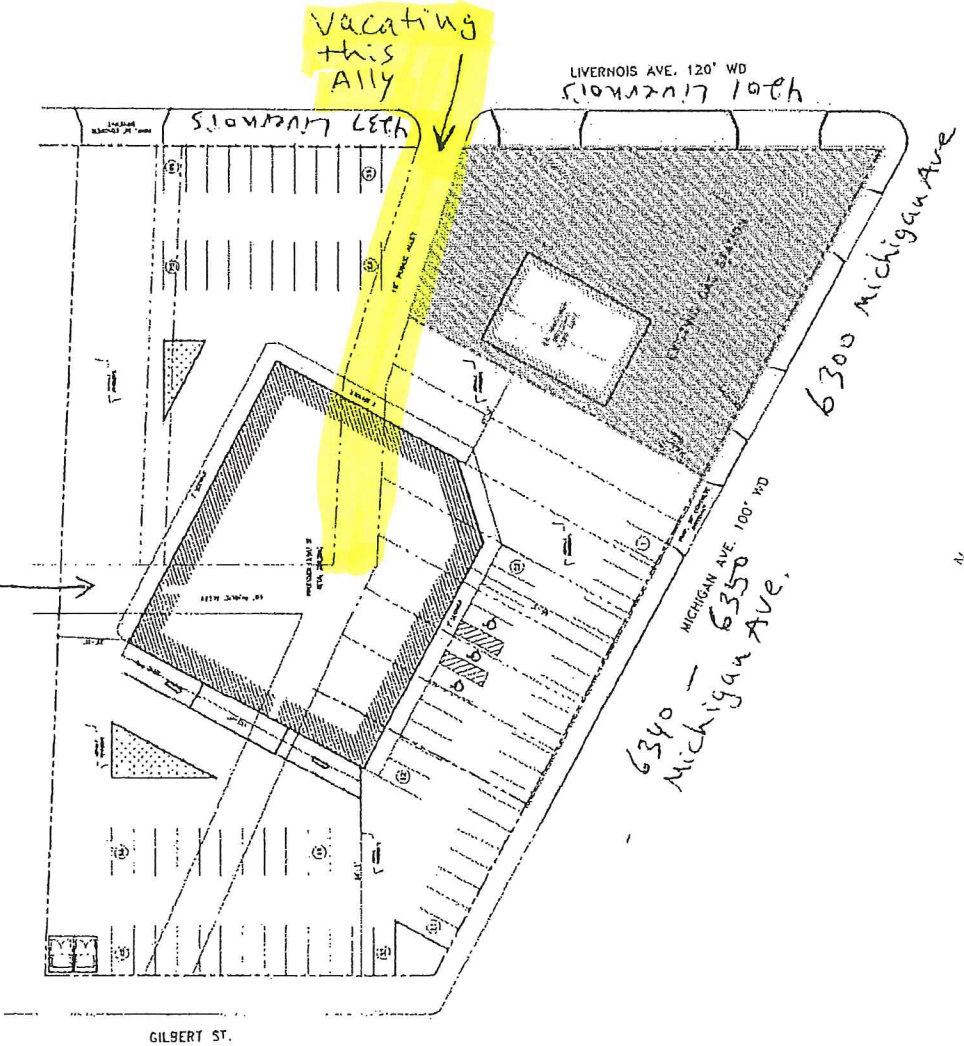

(Not included in this Petition)

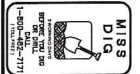
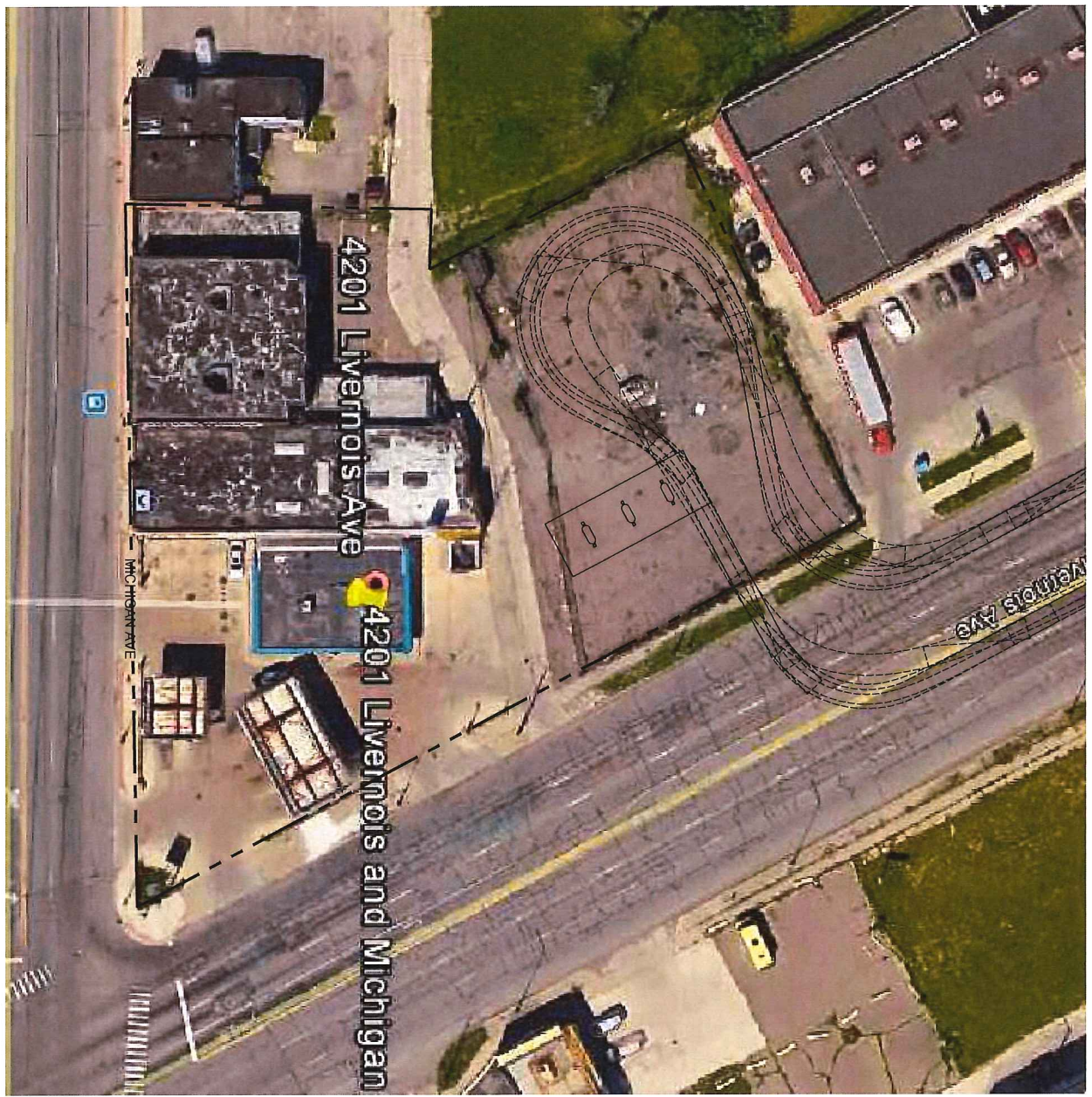
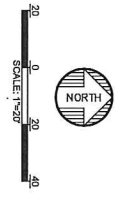
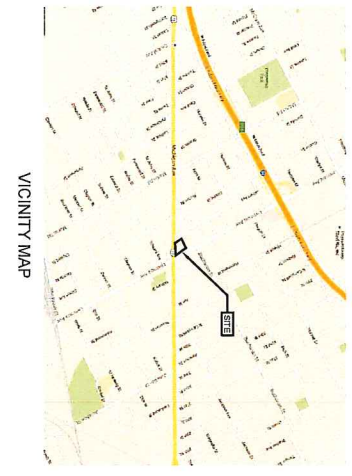

DATE: 2/15/2018
 PROJECT NO.:
 DESIGNED BY: JF
 DRAWN BY: PH
 CHECKED BY: SC

SHEET NO.:
 SITE SWETCH
GLANCE B

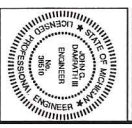

REV	DATE	DESCRIPTION

Livernois and Michigan
 4201 Livernois Ave, Detroit, MI

Gaugli Properties Group, Inc.
 West Bloomfield, MI

DAMRATH GROUP
 development support services

Damrath Group, LLC
 141 Cass Street, #151
 Northville, MI 48167
 Office: 248-878-7115

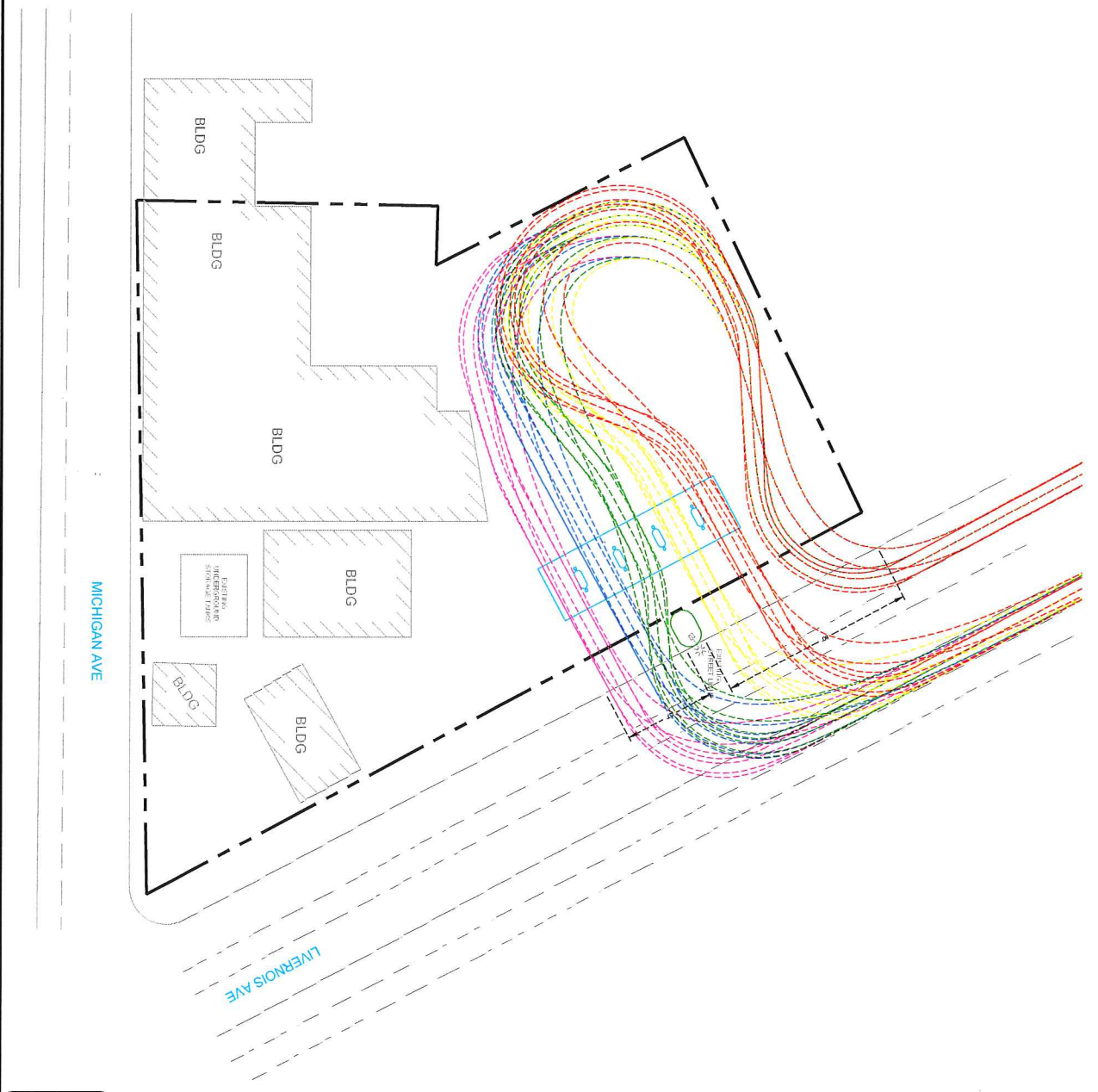
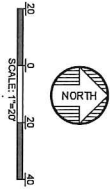
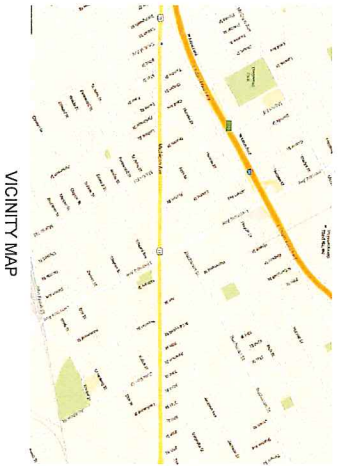

DATE: 3/26/2018
 PROJECT NO.:
 DRAWN BY: J.D.
 CHECKED BY: P.J.
 SITE SKETCH
 SHEET NO.
GLANCE G



REV	DATE	DESCRIPTION

Livernois and Michigan
 4201 Livernois Ave, Detroit, MI

Gaugl Properties Group, Inc.
 West Bloomfield, MI

DAMRATH GROUP
 development support services

Damrath Group, LLC
 141 Corp Centre, #103
 Northville, MI 48167
 Office: 314.480.2165

Christine A Lew

From: vinnieshokrie@aol.com
Sent: Sunday, July 08, 2018 3:34 AM
To: Christine A Lew
Cc: Shoukrisam@aol.com
Subject: [EXTERNAL] Converting an Ally to Easement
Attachments: Valero truck layout 2.pdf

Hello Christine, per our conversation a couple days ago. Please see the attached drawings. We are requesting to convert an ally to an easement per the city's requirements to combine the two lots together. We were able to obtain all the utilities approval except DTE. We are not building on top of the ally nor do we need to move any pools. Please look in to the matter ASAP because the request was submitted about a year ago.

Thanks,

Gaugi Properties Group Inc.

Vinnie Shokrie

Vice Pres.

8930 McGraw St.

Detroit, MI. 48210

Cell-313-289-0165

Fax-313-581-6550