

City of Detroit
**City Engineering Division, Department of Public Works
Survey Bureau**

NOTICE OF PROPOSED CHANGE IN PROPERTY

2nd Notice 1/26/17

Date: 11/30/2016

Petition: x1343

- | | |
|--|--|
| <input type="checkbox"/> AT&T Telecommunication | <input type="checkbox"/> Berm Use |
| <input type="checkbox"/> Comcast Television (CATV) | <input checked="" type="checkbox"/> Conversion to Easement |
| <input type="checkbox"/> Detroit Edison (DTE) | <input type="checkbox"/> Dedication |
| <input type="checkbox"/> Fire Department | <input type="checkbox"/> Encroachment |
| <input type="checkbox"/> Great Lakes Water Authority | <input type="checkbox"/> Temporary Closing |
| <input type="checkbox"/> Michcon (DTE) | <input type="checkbox"/> Vacation |
| <input type="checkbox"/> Planning & Development Department | |
| <input type="checkbox"/> Public Lighting Authority | |
| <input type="checkbox"/> Public Lighting Department | |
| <input type="checkbox"/> Police Department | |
| <input type="checkbox"/> Solid Waste Division, DPW | |
| <input type="checkbox"/> Street Design Bureau, DPW | |
| <input checked="" type="checkbox"/> Street Maintenance Division, DPW | |
| <input type="checkbox"/> Traffic Engineering Division, DPW | |
| <input type="checkbox"/> Water and Sewerage Department | |
| <input type="checkbox"/> _____ | |

A petition drawing is attached. Property shown on the attached print is proposed to be changed as indicated. Kindly report (using the back of this sheet) the nature of your services, if any affected by the proposed change and the estimated costs of removing and rerouting such services (if necessary).

Please return one copy to City Engineering Division, DPW within two weeks of the submittal date. Retain one copy and print for you file.

Ron Brundidge, Director, Department of Public Works

By: Richard Doherty, CED DPW
City Engineer

TO: City Engineering Division, DPW
2 Woodward Ave., Suite 642
Detroit, Michigan 48226-3462
Survey Bureau: 313-224-3970

Petition: x1343

The proposed change in property (referred to on the other side of this sheet) would affect our services as follows:

Not Involved

Involved; but asking you to hold action on this petition until further notice.

Involved; but no objections to the property change.

Involved; but no objections to the property change...provided as easement of the full width of the public right-of-way (street, alley or other public place) is reserved.

Involved; the nature of our services and the estimated costs of removing and/or rerouting such services are:

DPW / SP. MAINTENANCE
(Utility or City Department)

Mr. Leslie R. Walker
By

SUPERVISOR
Title

July 20th 2017
Date

313. 224. 0018
Area code – Telephone number

PETITION NO. 1343
 TENNESSEE MISSIONARY BAPTIST CHURCH
 2100 FISCHER ST.
 DETROIT, MICHIGAN 48214
 C/O PASTOR MILBRUN L. PEARSON II
 PHONE NO. 313 220-8623



VERNOR HWY. 60 FT. WD.

FISCHER AVE. 60 FT. WD.

CRANE AVE. 50 FT. WD.

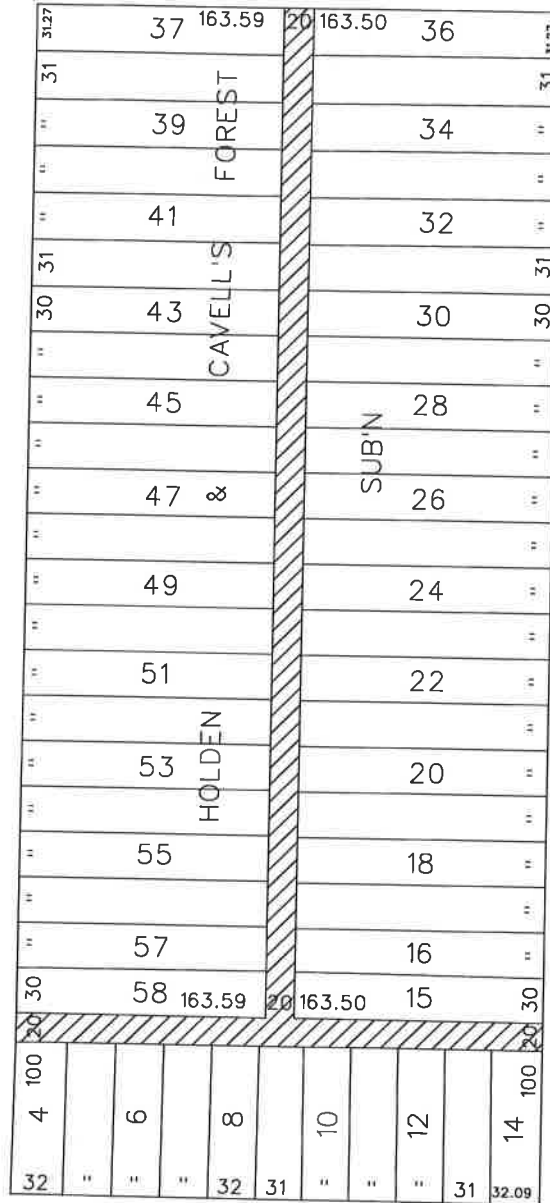

KERCHEVAL AVE. 80 FT. WD.



- REQUESTED CONVERSION TO EASEMENT

(FOR OFFICE USE ONLY)

CARTO 47 F

B					
A					
DESCRIPTION		DRWN	CHKD	APPD	DATE
REVISIONS					
DRAWN BY	WLW	CHECKED			
DATE	11-29-16	APPROVED			

**REQUEST TO CONVERT TO EASEMENT
 THE EAST/WEST AND NORTH/SOUTH
 PUBLIC ALLEY, 20 FT. WD.
 IN THE BLOCK BOUND BY
 CRANE, KERCHEVAL, FISCHER AVE.
 AND VERNOR HWY.**

CITY OF DETROIT	
CITY ENGINEERING DEPARTMENT	
SURVEY BUREAU	
JOB NO.	01-01
DRWG. NO.	X 1343

GRAND RIVER 105' R.O.W.

STAGELIN 130' R.O.W.

NOTE: STAGELIN SOUTH OF

