

TO: City Engineering Division, DPW  
2 Woodward Ave., Suite 642  
Detroit, Michigan 48226-3462  
Survey Bureau: 313-224-3970

Petition: x1332

The proposed change in property (referred to on the other side of this sheet) would affect our services as follows:

- Not Involved
- Involved; but asking you to hold action on this petition until further notice.
- Involved; but no objections to the property change.  
Within the Jam Handy Historic District. Future development would require HDC approval.  
Applicant has no current plans for development. Alley will be blocked and utilities removed.
- Involved; objection to the property change.
- Involved; but no objections to the property change...provided as easement of the full width of the public right-of-way (street, alley or other public place) is reserved.
- Involved; the nature of our services and the estimated costs of removing and/or rerouting such services are:

Planning & Development  
(Utility or City Department)

  
By

Greg Moots-Lead Planner-Office of Zoning Innovation  
Title

6.15.17  
Date

313-224-1358  
Area code – Telephone number

**City of Detroit  
City Engineering Division, Department of Public Works  
Survey Bureau**

**NOTICE OF PROPOSED CHANGE IN PROPERTY**

Date: 04/07/2017

Petition: x1332

- |   |   |
|---|---|
| <input type="checkbox"/> AT&T Telecommunication                       | <input type="checkbox"/> Berm Use               |
| <input type="checkbox"/> Comcast Television (CATV)                    | <input type="checkbox"/> Conversion to Easement |
| <input type="checkbox"/> Detroit Edison (DTE)                         | <input type="checkbox"/> Dedication             |
| <input type="checkbox"/> Fire Department                              | <input type="checkbox"/> Encroachment           |
| <input type="checkbox"/> Great Lakes Water Authority                  | <input type="checkbox"/> Temporary Closing      |
| <input type="checkbox"/> Land Bank Authority                          | <input checked="" type="checkbox"/> Vacation    |
| <input type="checkbox"/> Michcon (DTE)                                |   |
| <input checked="" type="checkbox"/> Planning & Development Department |   |
| <input type="checkbox"/> Public Lighting Authority                    |   |
| <input type="checkbox"/> Public Lighting Department                   |   |
| <input type="checkbox"/> Police Department                            |   |
| <input type="checkbox"/> Solid Waste Division, DPW                    |   |
| <input type="checkbox"/> Street Design Bureau, DPW                    |   |
| <input type="checkbox"/> Street Maintenance Division, DPW             |   |
| <input type="checkbox"/> Traffic Engineering Division, DPW            |   |
| <input type="checkbox"/> Water and Sewerage Department                |   |
| <input type="checkbox"/> _____  |   |

A petition drawing is attached. Property shown on the attached print is proposed to be changed as indicated. Kindly report (using the back of this sheet) the nature of your services, if any affected by the proposed change and the estimated costs of removing and rerouting such services (if necessary).

Please return one copy to City Engineering Division, DPW within two weeks of the submittal date. Retain one copy and print for you file.

Ron Brundidge, Director, Department of Public Works

By: Richard Doherty, CED DPW  
City Engineer

PETITION NO. 1332  
 RUSAS OWNER LLC  
 1514 WASHINGTON BLVD. SUITE 201  
 DETROIT, MICHIGAN 48226  
 C/O JORDAN WOLFE  
 PHONE NO. 313 338-8583



E. GRAND BLVD. 150 FT. WD.

25.9

ST. ANTOINE ST. 50 FT. WD.

27.36

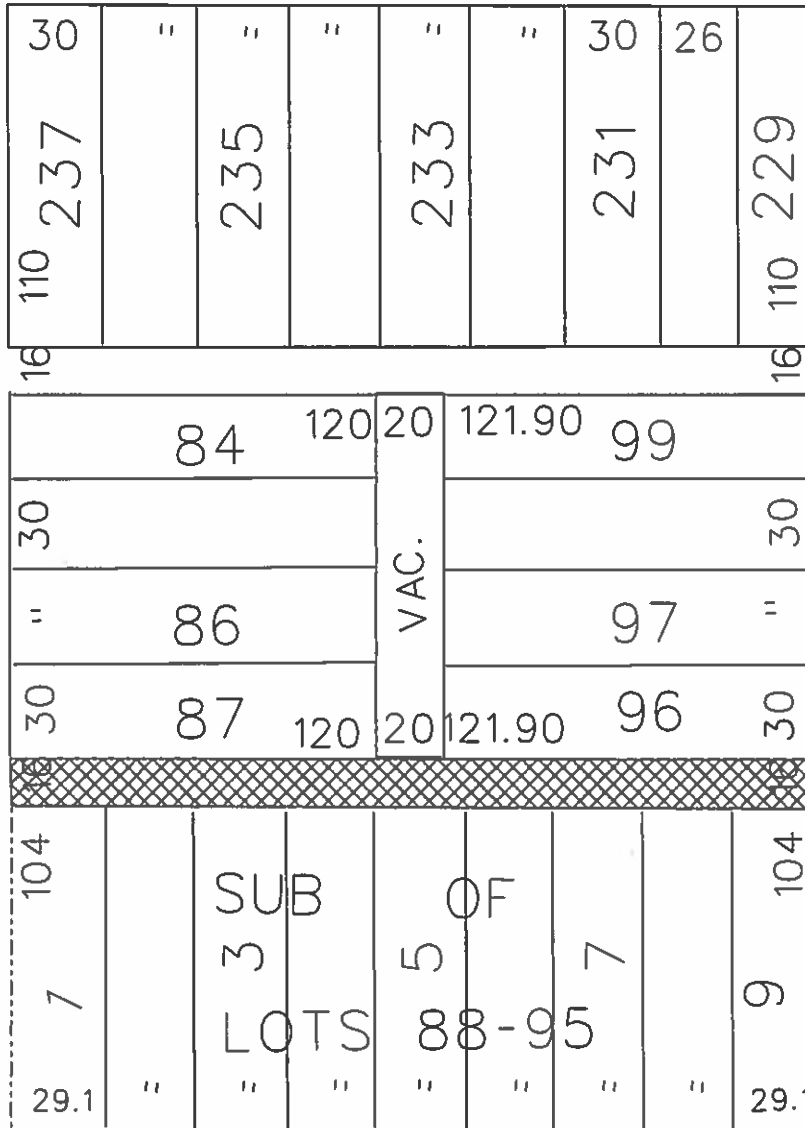

OAKLAND AVE. 50 FT. WD.

MILWAUKEE AVE. 60 FT. WD.



- OUTRIGHT VACATION

(FOR OFFICE USE ONLY)

CARTO 31 F

B						<b>REQUEST TO OUTRIGHT VACATE          THE EAST/WEST PUBLIC ALLEY 16 FT. WD.          IN THE BLOCK BOUND BY          OAKLAND, MILWAUKEE AVE., ST. ANTOINE ST.          AND E. GRAND BLVD.</b>	<b>CITY OF DETROIT          CITY ENGINEERING DEPARTMENT          SURVEY BUREAU</b>	
A					<b>JOB NO. 01-01</b>			
DESCRIPTION		DRWN	CHEK	APPD	DATE			<b>DRWG. NO. X 1332</b>
DRAWN BY		CHECKED						
DATE		APPROVED						

