

PETITION NO. 1318
 GIFFELS WEBSTER
 28 W. ADAMS, SUITE 1200
 DETROIT, MICHIGAN 48226
 C/O DEIRDRE CLEIN
 PHONE NO. 313 962-4442

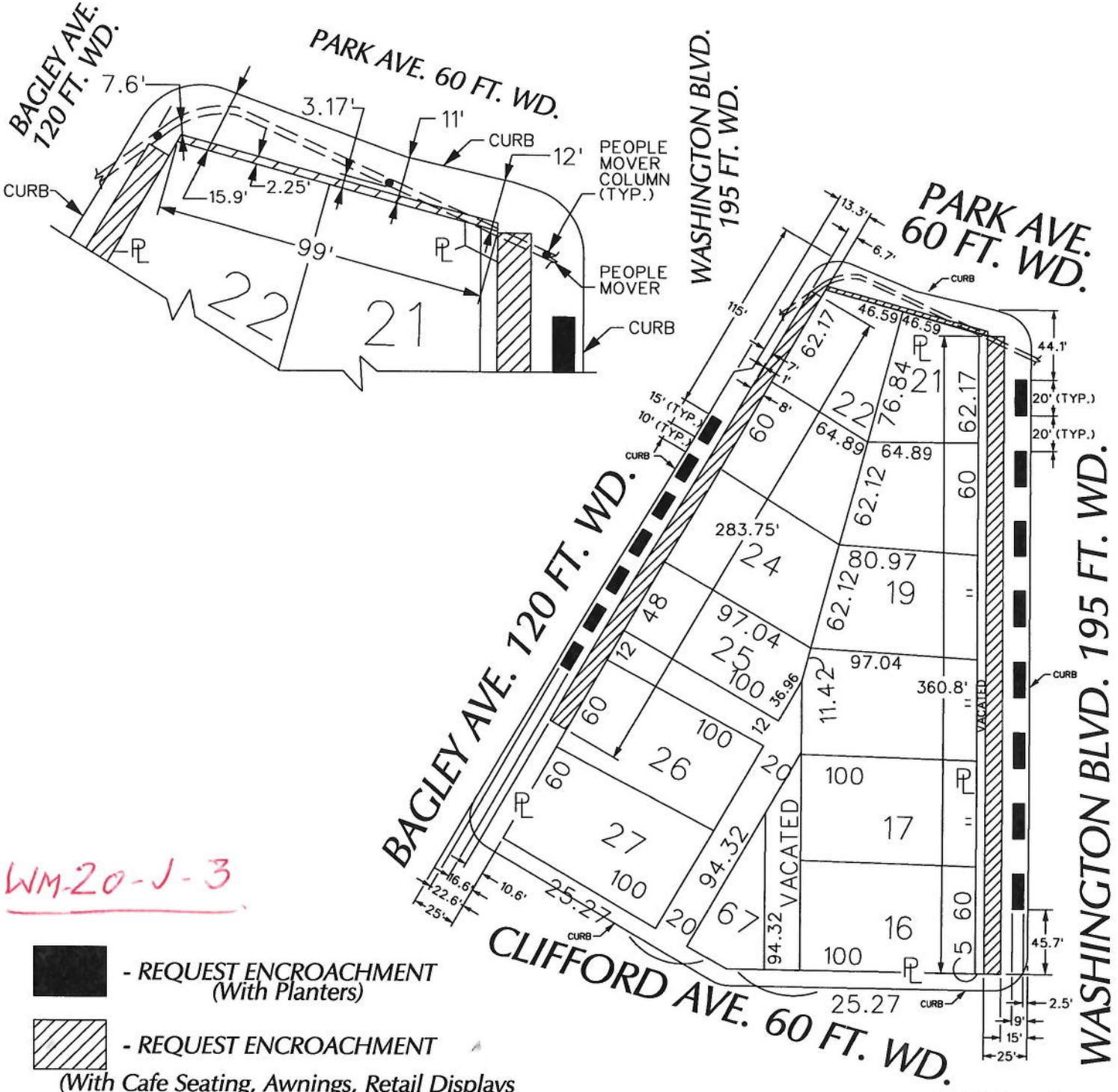

WM-20-J-3

- REQUEST ENCROACHMENT (With Planters)
- REQUEST ENCROACHMENT (With Cafe Seating, Awnings, Retail Displays Stairs, and Landscaping)

(FOR OFFICE USE ONLY)

CARTO 28 B

B						REQUEST ENCROACHMENT INTO PARK, BAGLEY AVE. AND WASHINGTON BLVD. AT 313 PARK PARK AVE. (With Awnings, Retail Displays) WASHINGTON BLVD. AND BAGLEY AVE. (With Planters, Cafe Seating, Awnings, Retail Displays, Stairs, and Landscaping)	CITY OF DETROIT CITY ENGINEERING DEPARTMENT SURVEY BUREAU
A							JOB NO. 01-01
	DESCRIPTION	DRWN	CHKD	APPD	DATE		DRWG. NO. X 1318
	REVISIONS						
	DRAWN BY	CHECKED					
	DATE	APPROVED					
	11-18-16						

City of Detroit
City Engineering Division, Department of Public Works
Survey Bureau

NOTICE OF PROPOSED CHANGE IN PROPERTY

Date: 11/21/2016

Petition: x1318

- | | |
|---|---|
| <input type="checkbox"/> AT&T Telecommunication | <input type="checkbox"/> Berm Use |
| <input type="checkbox"/> Comcast Television (CATV) | <input type="checkbox"/> Conversion to Easement |
| <input type="checkbox"/> Detroit Edison (DTE) | <input type="checkbox"/> Dedication |
| <input type="checkbox"/> Fire Department | <input type="checkbox"/> Encroachment |
| <input checked="" type="checkbox"/> Great Lakes Water Authority ✓ | <input type="checkbox"/> Temporary Closing |
| <input type="checkbox"/> Michcon (DTE) | <input type="checkbox"/> Vacation |
| <input type="checkbox"/> Planning & Development Department | |
| <input type="checkbox"/> Public Lighting Authority | |
| <input type="checkbox"/> Public Lighting Department | |
| <input type="checkbox"/> Police Department | |
| <input type="checkbox"/> Solid Waste Division, DPW | |
| <input type="checkbox"/> Street Design Bureau, DPW | |
| <input type="checkbox"/> Street Maintenance Division, DPW | |
| <input type="checkbox"/> Traffic Engineering Division, DPW | |
| <input type="checkbox"/> Water and Sewerage Department | |
| <input type="checkbox"/> _____ | |

A petition drawing is attached. Property shown on the attached print is proposed to be changed as indicated. Kindly report (using the back of this sheet) the nature of your services, if any affected by the proposed change and the estimated costs of removing and rerouting such services (if necessary).

Please return one copy to City Engineering Division, DPW within two weeks of the submittal date. Retain one copy and print for you file.

Ron Brundidge, Director, Department of Public Works

By: Richard Doherty, CED DPW
City Engineer

TO: City Engineering Division, DPW
2 Woodward Ave., Suite 642
Detroit, Michigan 48226-3462
Survey Bureau: 313-224-3970

Petition: x1318

The proposed change in property (referred to on the other side of this sheet) would affect our services as follows:

- Not Involved ✓
- Involved; but asking you to hold action on this petition until further notice.
- Involved; but no objections to the property change.
- Involved; but no objections to the property change...provided as easement of the full width of the public right-of-way (street, alley or other public place) is reserved.
- Involved; the nature of our services and the estimated costs of removing and/or rerouting such services are:

GREAT LAKES WATER AUTHORITY
(Utility or City Department)

S. Prasad
By

GLWA FIELD ENGINEERING
Title

01/25/2017
Date

313-267-4862
Area code - Telephone number