

PETITION NO. 1318
 GIFFELS WEBSTER
 28 W. ADAMS, SUITE 1200
 DETROIT, MICHIGAN 48226
 C/O DEIRDRE CLEIN
 PHONE NO. 313 962-4442

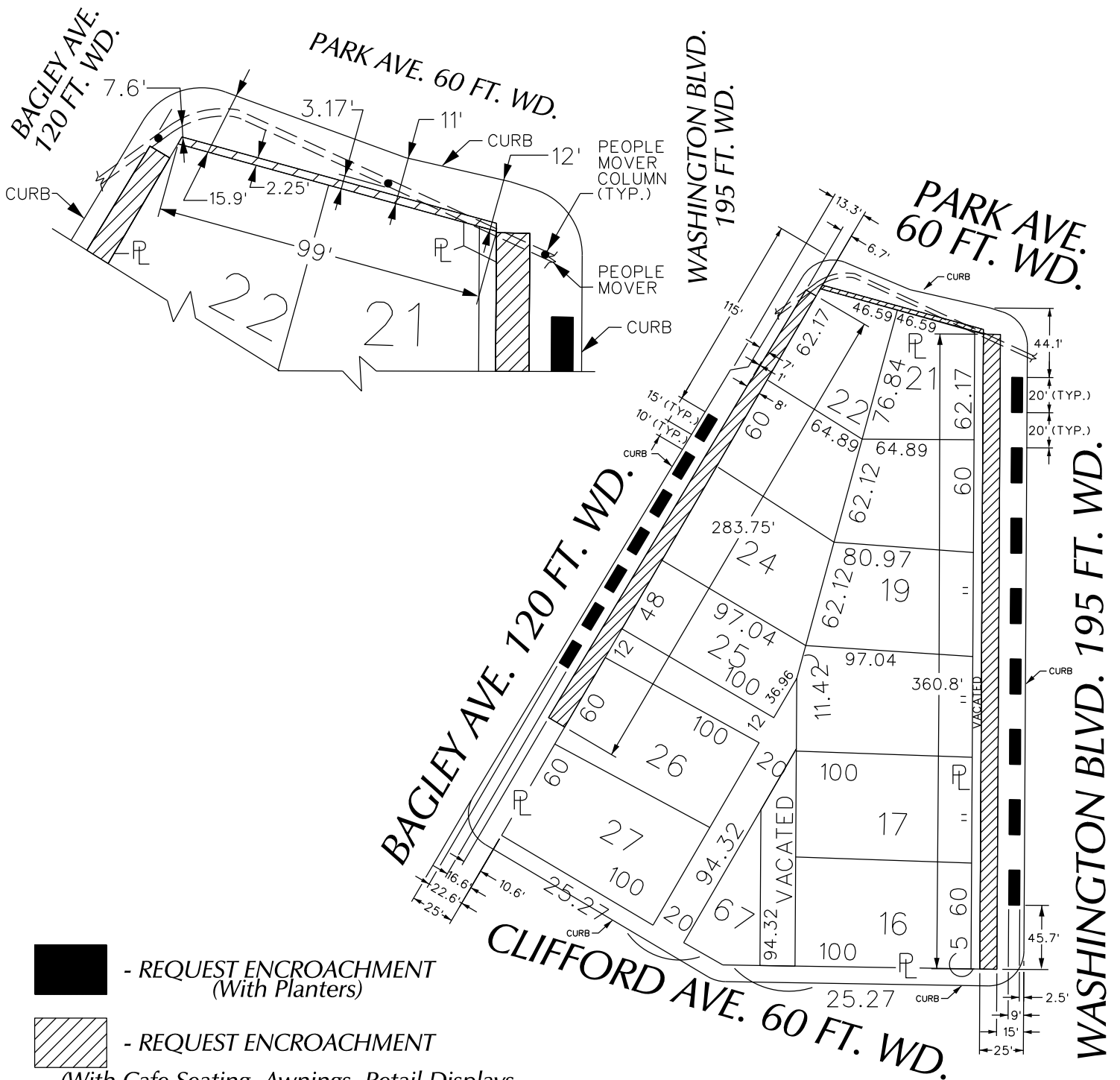

 - REQUEST ENCROACHMENT
 (With Planters)

 - REQUEST ENCROACHMENT
 (With Cafe Seating, Awnings, Retail Displays
 Stairs, and Landscaping)

(FOR OFFICE USE ONLY)

CARTO 28 B

B					
A					
DESCRIPTION	DRWN	CHKD	APPD	DATE	
REVISIONS					
DRAWN BY	WLW	CHECKED			
DATE	11-18-16	APPROVED			

REQUEST ENCROACHMENT
 INTO PARK, BAGLEY AVE. AND WASHINGTON BLVD.
 AT 313 PARK
 PARK AVE.
 (With Awnings, Retail Displays)
 WASHINGTON BLVD. AND BAGLEY AVE.
 (With Planters, Cafe Seating, Awnings,
 Retail Displays, Stairs, and Landscaping)

CITY OF DETROIT CITY ENGINEERING DEPARTMENT SURVEY BUREAU	
JOB NO.	01-01
DRWG. NO.	X 1318