



October 24, 2016

**HAND DELIVER**

**Honorable Detroit City Council  
C/o Detroit City Clerk  
2 Woodward Avenue  
200 Coleman A. Young Municipal Center  
Detroit, Michigan 48226**

RE: Giffels Webster - Request for encroachment into the Woodward Avenue and State Street public right-of-ways.

Giffels Webster, 28 W. Adams, Suite 1200, Detroit, Michigan 48226, on behalf of Bedrock Real Estate Services, LLC, 1092 Woodward Avenue, Detroit, Michigan, 48226, respectfully requests to encroach into the Woodward Avenue and State Street public right-of-ways with the installation of canopies and café seating.

We are requesting a 10.5 foot wide encroachment into the Woodward Avenue right-of-way, 73.3 feet in length, which will begin at grade and extend to the height of the building. Additionally, we are requesting a 6.7 foot wide encroachment into the State Street right-of-way, 59.5 feet in length, which will begin 8 feet above grade and extend to the height of the building.

This encroachment will neither impede pedestrian nor vehicular traffic, nor will it interfere with the maintenance of the public rights-of-way, including utility company and Fire Department access. The requested encroachment maintains at minimum a 6 foot wide access way within the sidewalk for pedestrian use. Obtaining this encroachment is critical to fully utilize this property as a commercial establishment and will promote activity along the street. Drawings of the proposed location of encroachments are enclosed herein.

If you should have any questions, please do not hesitate to contact Giffels Webster planner, Deirdre Clein at (P) 313.962.4442 or [dclein@giffelswebster.com](mailto:dclein@giffelswebster.com).

Respectfully,

A handwritten signature in blue ink, appearing to read "Michael Marks".

Michael Marks, Partner  
Giffels Webster

CC: Bedrock Real Estate Services, LLC

Executive: J.N.R.  
Manager: C.A.A.  
Designer: J.Z.B.  
Quality Control: C.A.A.  
Section:

Professional Seal:



Know what's below.  
Call before you dig.

DATE	ISSUE
Date	Issue

Developed For:

**LOCATION  
SURVEY**

1001 WOODWARD AVENUE

CITY OF DETROIT  
WAYNE COUNTY  
MICHIGAN

Date: 10/17/16  
Scale: 1"=20'  
Sheet: 1 OF 1  
Project: 19140.00D

Copyright © 2016 G&W. All rights reserved.  
No reproduction shall be made without the  
prior written consent of G&W.

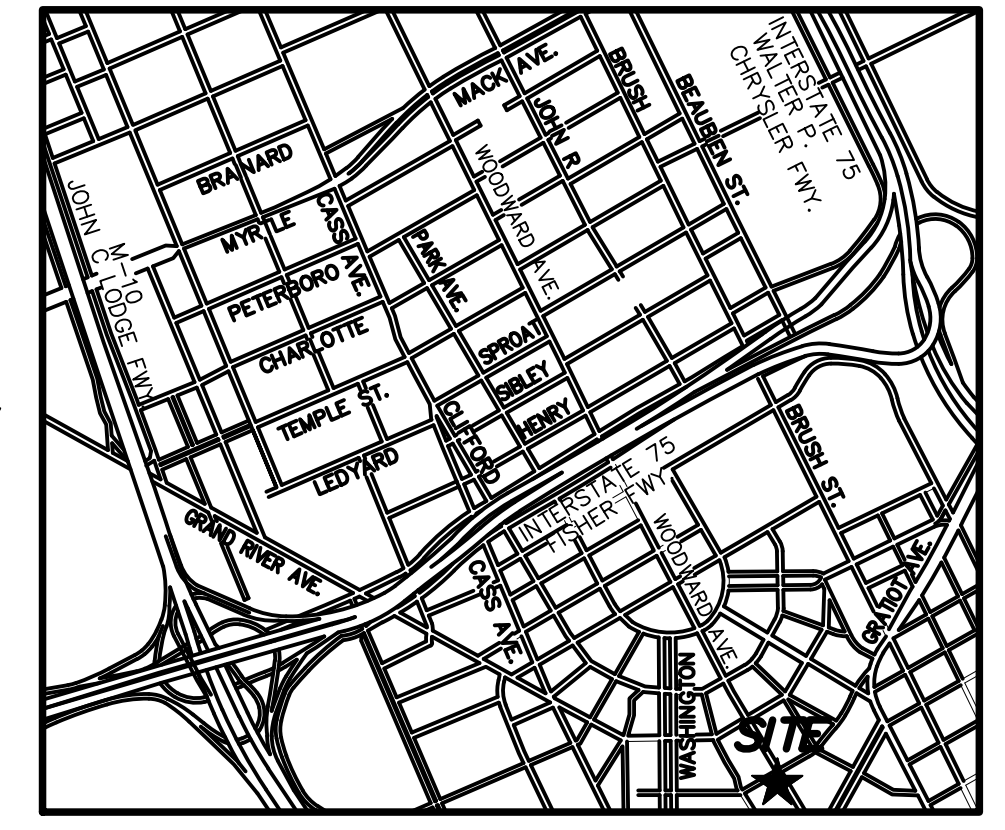

**LOCATION MAP**  
( NOT TO SCALE )

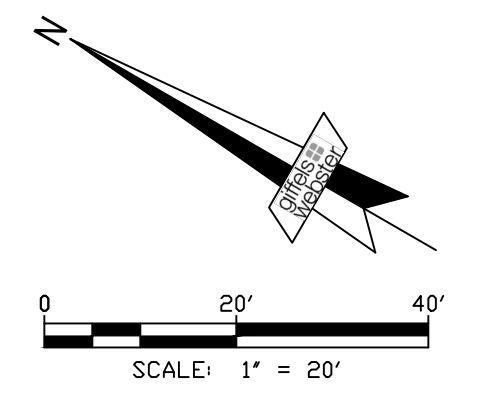

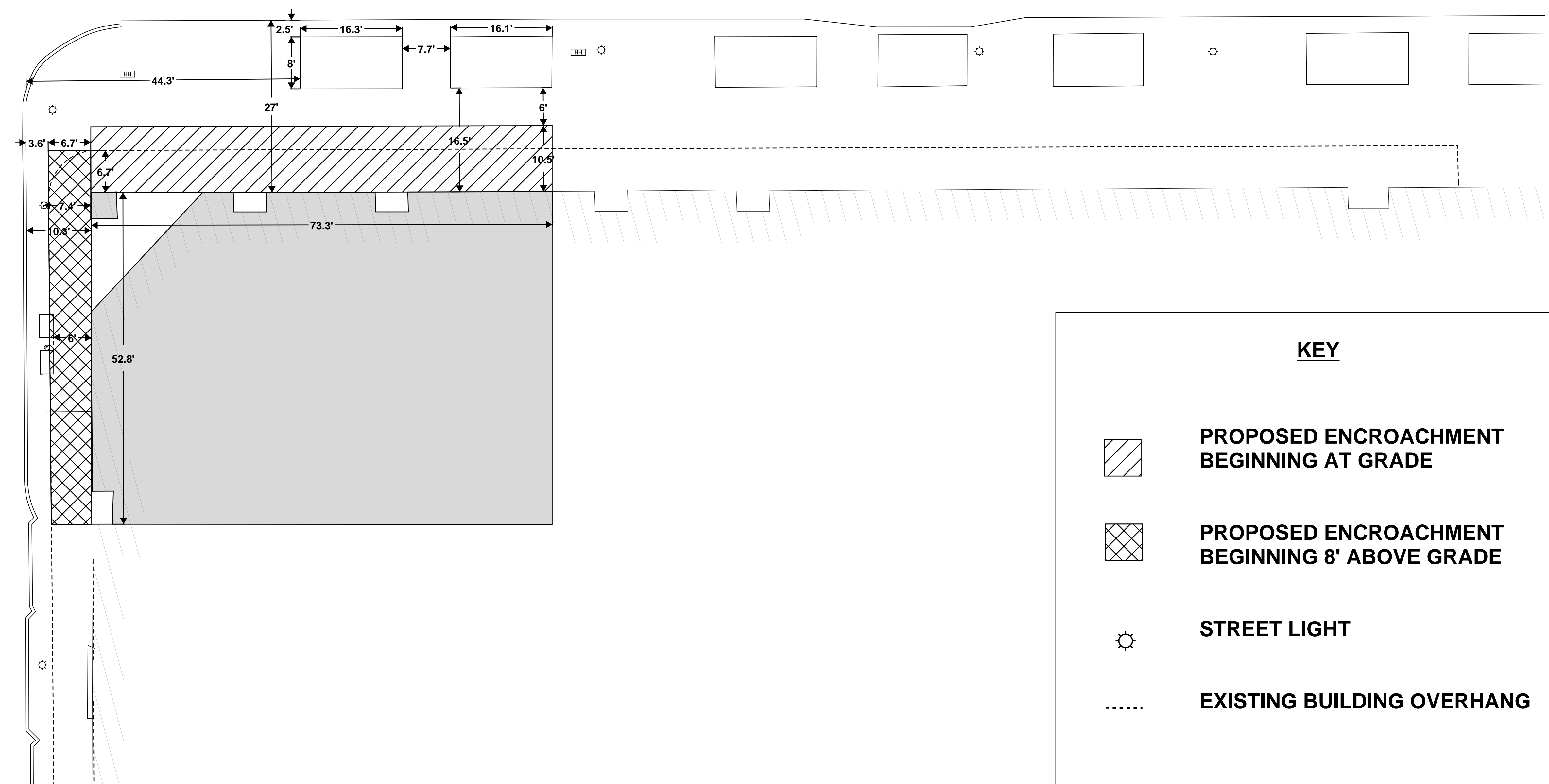

**WOODWARD AVENUE**

**STATE STREET**

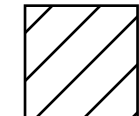
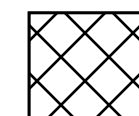

**KEY**

-  **PROPOSED ENCROACHMENT BEGINNING AT GRADE**
-  **PROPOSED ENCROACHMENT BEGINNING 8' ABOVE GRADE**
-  **STREET LIGHT**
-  **EXISTING BUILDING OVERHANG**