

Hamilton Anderson Associates, Inc
 1435 Randolph Suite 200
 Detroit, Michigan 48226
 p 313 964 0270 f 313 964 0170
 www.hamilton-anderson.com

OWNERS THE ROXBURY GROUP
 535 GRISWOLD STREET
 DETROIT, MI 48226
 P 313 936 6118

CONSULTANT DESAI NASR
 6785 DALY ROAD
 WEST BLOOMFIELD, MI 48322
 P 248 932 2010

STRUCTURAL ENGINEER ETS ENGINEERING, INC
 418-1/2 S. WASHINGTON BLVD.
 ROYAL OAK, MI 48068
 P 248 744 0360

ELECTRICAL ENGINEER POTAPA - VAN HOOSEAR
 ENGINEERING, INC
 46613 VAN DYKE AVE
 SHELBY TWP., MI 48317
 P 586 997 0922

CLIENT
SOAVE REAL ESTATE GROUP

3400 EAST LAFAYETTE
 DETROIT, MI 48207
 P 313 567 7000

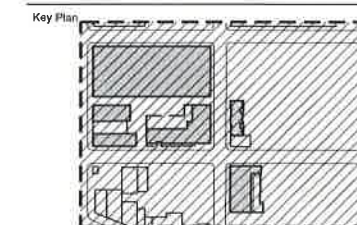

DESIGN DEVELOPMENT TBD
 SCHEMATIC DESIGN FEBRUARY 8, 2016

Project
CORKTOWN DEVELOPMENT

Drawing Title
GENERAL DEVELOPMENT PLAN

Project Number: 2014125 01

Drawn By: HAA Approved By:

Scale:
 Seat:

Signature:

Drawing No:

C1.0

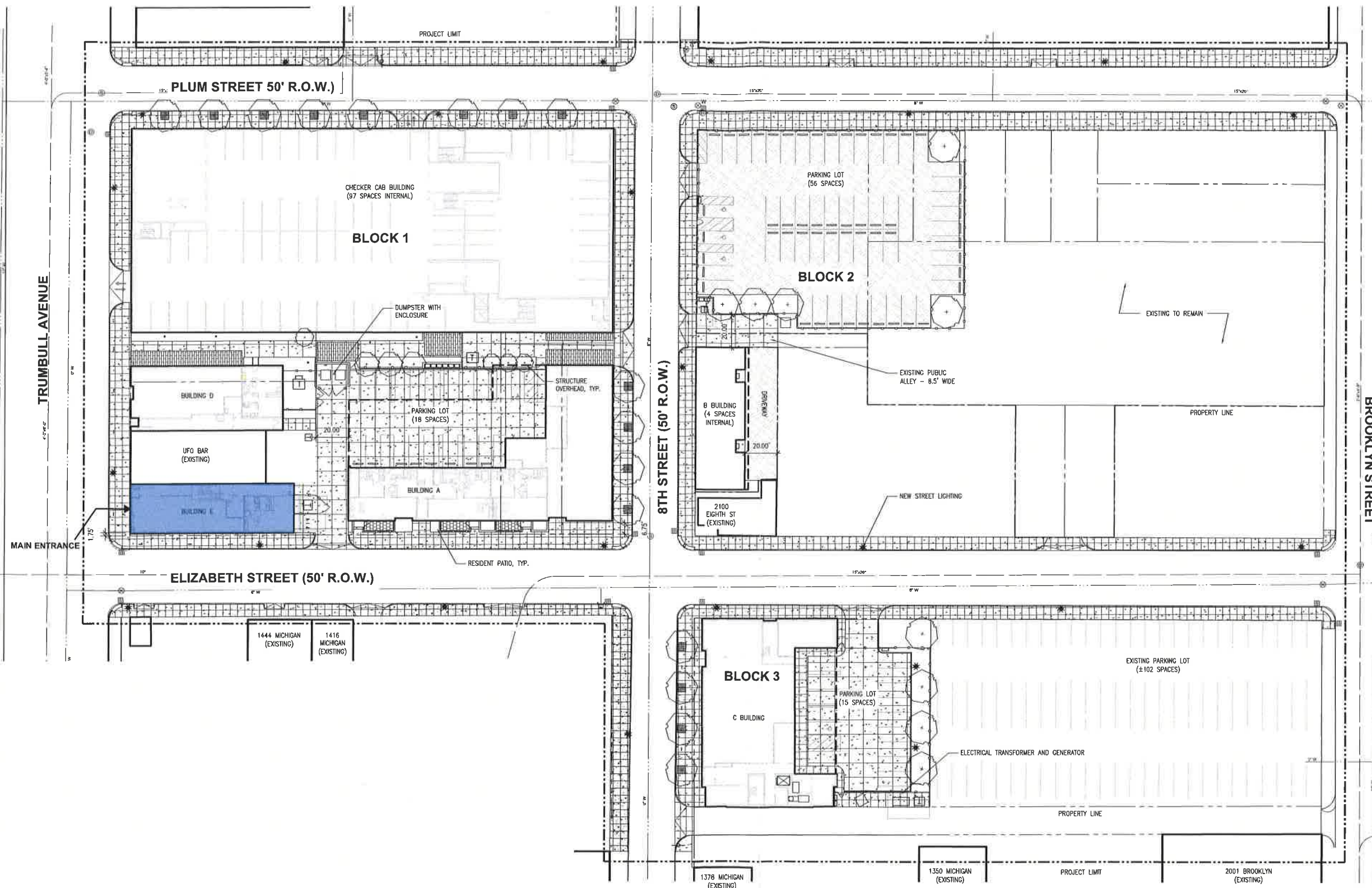

LEGEND

- PROJECT LIMIT
- BUILDING INCLUDED IN SCOPE OF WORK
- ASPHALT PAVEMENT
- SIDEWALK PAVEMENT
- PAVER TYPE 1
- PAVER TYPE 2

- LANDSCAPE AREA
- LIGHT POLE & FOUNDATION

NOTES

1. ALL DIMENSIONS TAKEN FROM BACK OF CURB UNLESS NOTED OTHERWISE.
2. CURBING TO BE REMOVED AND REPLACED IN EXISTING LOCATION.



SCALE: 1" = 30'-0"
 0' 30' 60' 90'

