

PLA Review
5/18/16

City of Detroit
City Engineering Division, Department of Public Works
Survey Bureau

NOTICE OF PROPOSED CHANGE IN PROPERTY

Date: 05/17/2016

Petition: x1129

- | | |
|--|--|
| <input type="checkbox"/> AT&T Telecommunication | <input type="checkbox"/> Berm Use |
| <input type="checkbox"/> Comcast Television (CATV) | <input checked="" type="checkbox"/> Conversion to Easement |
| <input type="checkbox"/> Detroit Edison (DTE) | <input type="checkbox"/> Dedication |
| <input type="checkbox"/> Fire Department | <input type="checkbox"/> Encroachment |
| <input type="checkbox"/> Michcon (DTE) | <input type="checkbox"/> Temporary Closing |
| <input type="checkbox"/> Planning & Development Department | <input type="checkbox"/> Vacation |
| <input type="checkbox"/> Public Lighting Authority | |
| <input type="checkbox"/> Public Lighting Department | |
| <input type="checkbox"/> Police Department | |
| <input type="checkbox"/> Recreation Department | |
| <input type="checkbox"/> Solid Waste Division, DPW | |
| <input type="checkbox"/> Street Design Bureau, DPW | |
| <input type="checkbox"/> Street Maintenance Division, DPW | |
| <input type="checkbox"/> Traffic Engineering Division, DPW | |
| <input type="checkbox"/> Water and Sewerage Department | |
| <input type="checkbox"/> _____ | |

A petition drawing is attached. Property shown on the attached print is proposed to be changed as indicated. Kindly report (using the back of this sheet) the nature of your services, if any affected by the proposed change and the estimated costs of removing and rerouting such services (if necessary).

Please return one copy to City Engineering Division, DPW within two weeks of the submittal date. Retain one copy and print for you file.

Ron Brundidge, Director, Department of Public Works

By: Richard Doherty, CED DPW
City Engineer

TO: City Engineering Division, DPW
2 Woodward Ave., Suite 642
Detroit, Michigan 48226-3462
Survey Bureau: 313-224-3970

Petition: x1129

The proposed change in property (referred to on the other side of this sheet) would affect our services as follows:

- Not Involved
- Involved; but asking you to hold action on this petition until further notice.
- Involved; but no objections to the property change.
- Involved; but no objections to the property change...provided as easement of the full width of the public right-of-way (street, alley or other public place) is reserved.
- Involved; the nature of our services and the estimated costs of removing and/or rerouting such services are:

PLA

(Utility or City Department)

Umalcant Patel, P.E.

By _____

Sr. Project Manager

Title _____

5/18/16

Date _____

313-324-8290

Area code – Telephone number

PETITION NO. 1129
 BODYWERK INC.
 18700 FITZPATRICK AVE.
 DETROIT, MICHIGAN 48228
 C/O CHRISTOPHER KRUSUSKY
 PHONE NO. 313 493-8877



PLYMOUTH AVE. 86 FT. WD.

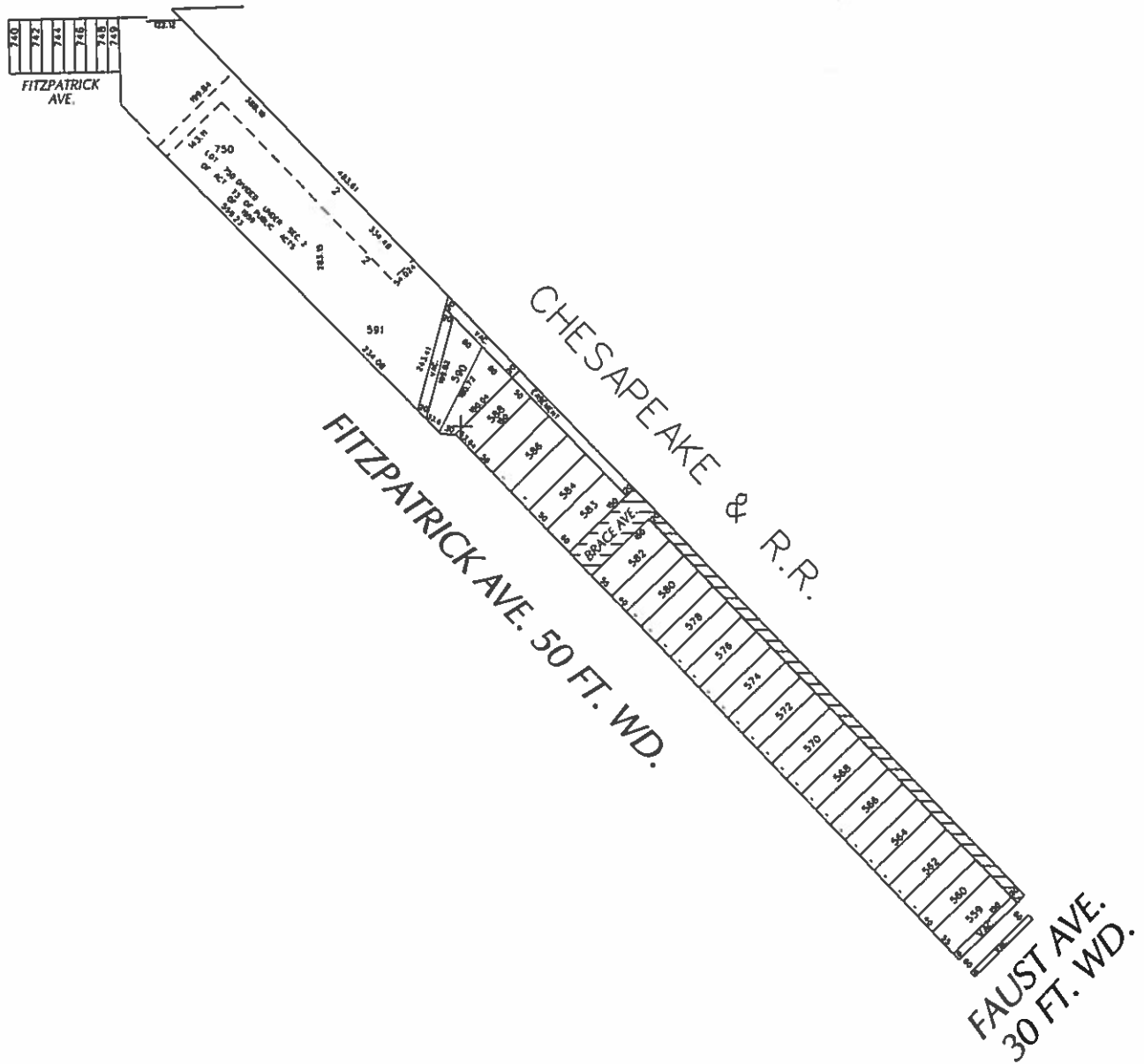

 - REQUESTED CONVERSION TO EASEMENT

(FOR OFFICE USE ONLY)

CARTO 100 C

B						REQUEST TO CONVERT TO EASEMENT BRACE AVE. 60 FT. WD. AND THE NORTH/SOUTH PUBLIC ALLEY, 20 FT. WD. IN THE AREA BOUND BY FAUST, FITZPATRICK, PLYMOUTH AVE. AND CHESAPEAKE & R.R.	CITY OF DETROIT CITY ENGINEERING DEPARTMENT SURVEY BUREAU	
A							JOB NO. 01-01	
DESCRIPTION		DRWN	CHKD	APPD	DATE	DRWG. NO. X 1129		
DRAWN BY		REVISIONS						
WLW		CHECKED						
DATE		APPROVED						
05-17-16								