

City of Detroit  
City Engineering Division, Department of Public Works  
Survey Bureau

NOTICE OF PROPOSED CHANGE IN PROPERTY

Date: 05/17/2016

Petition: x1129

- |  |  |
|--|--|
| <input type="checkbox"/> AT&T Telecommunication            | <input type="checkbox"/> Berm Use                          |
| <input type="checkbox"/> Comcast Television (CATV)         | <input checked="" type="checkbox"/> Conversion to Easement |
| <input type="checkbox"/> Detroit Edison (DTE)              | <input type="checkbox"/> Dedication                        |
| <input type="checkbox"/> Fire Department                   | <input type="checkbox"/> Encroachment                      |
| <input type="checkbox"/> Michcon (DTE)                     | <input type="checkbox"/> Temporary Closing                 |
| <input type="checkbox"/> Planning & Development Department | <input type="checkbox"/> Vacation                          |
| <input type="checkbox"/> Public Lighting Authority         |  |
| <input type="checkbox"/> Public Lighting Department        |  |
| <input type="checkbox"/> Police Department                 |  |
| <input type="checkbox"/> Recreation Department             |  |
| <input type="checkbox"/> Solid Waste Division, DPW         |  |
| <input type="checkbox"/> Street Design Bureau, DPW         |  |
| <input type="checkbox"/> Street Maintenance Division, DPW  |  |
| <input type="checkbox"/> Traffic Engineering Division, DPW |  |
| <input type="checkbox"/> Water and Sewerage Department     |  |
| <input type="checkbox"/> _____                             |  |

A petition drawing is attached. Property shown on the attached print is proposed to be changed as indicated. Kindly report (using the back of this sheet) the nature of your services, if any affected by the proposed change and the estimated costs of removing and rerouting such services (if necessary).

Please return one copy to City Engineering Division, DPW within two weeks of the submittal date. Retain one copy and print for you file.

Ron Brundidge, Director, Department of Public Works

By: Richard Doherty, CED DPW  
City Engineer

TO: City Engineering Division, DPW  
2 Woodward Ave., Suite 642  
Detroit, Michigan 48226-3462  
Survey Bureau: 313-224-3970

Petition: x1129

The proposed change in property (referred to on the other side of this sheet) would affect our services as follows:

- Not Involved
- Involved; but asking you to hold action on this petition until further notice.
- Involved; but no objections to the property change.
- Involved; but no objections to the property change...provided as easement of the full width of the public right-of-way (street, alley or other public place) is reserved.
- Involved; the nature of our services and the estimated costs of removing and/or rerouting such services are:

The Detroit Police Dept.  
(Utility or City Department)

Charles E. Staples II  
By

Police Officer  
Title

5/21/16  
Date

313 596-5610  
Area code - Telephone number

*Read & Forwarded  
Sgt. Chad Jy S-280  
5/23/16*

PETITION NO. 1129  
 BODYWERK INC.  
 18700 FITZPATRICK AVE.  
 DETROIT, MICHIGAN 48228  
 C/O CHRISTOPHER KRUSUSKY  
 PHONE NO. 313 493-8877



PLYMOUTH AVE. 86 FT. WD.

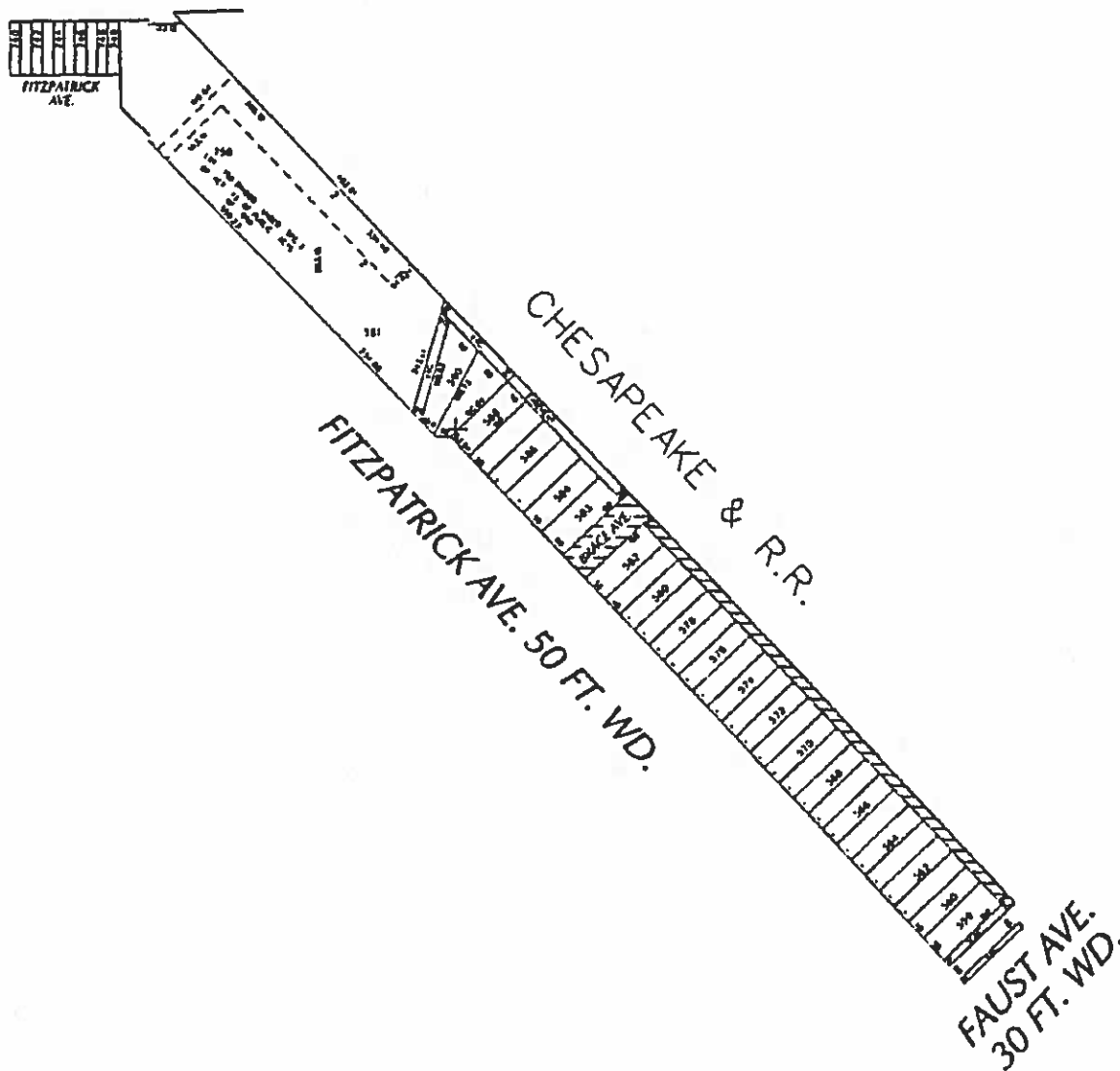

- REQUESTED CONVERSION TO EASEMENT

(FOR OFFICE USE ONLY)

CARTO 100 C

B						<b>REQUEST TO CONVERT TO EASEMENT          BRACE AVE. 60 FT. WD. AND THE          NORTH/SOUTH PUBLIC ALLEY, 20 FT. WD.          IN THE AREA BOUND BY          FAUST, FITZPATRICK, PLYMOUTH AVE.          AND CHESAPEAKE &amp; R.R.</b>	<b>CITY OF DETROIT          CITY ENGINEERING DEPARTMENT          SURVEY BUREAU</b>	
A					JOB NO. 01-01			
DESCRIPTION		DRWN	CHEK	APPD	DATE			DRWG. NO. X 1129
DRAWN BY		REVISIONS						
DATE		CHECKED		APPROVED				
05-17-16		WLW						