

TO: City Engineering Division, DPW
2 Woodward Ave., Suite 642
Detroit, MI 48226-3462
Survey Bureau: 313-224-3970

Ref. No. 201604039
Petition No. 1099REV

The proposed change in property (referred to above) would affect our services as follows:

- () Not Involved.
- () Involved; but asking you to hold action on this petition until further notice.
- () Involved; the nature of our services, and the estimated costs of removing and/or rerouting such services are:
- (X) Involved; have no objection to outright vacate the east/west and the north/south public alley various widths and Park Ave., 60 ft. wide in the area bound by Clifford, Henry St., Woodward Ave. and Fisher Fwy. Service Dr.as shown on drawing no. x1099 dated 4/26/2016 and revised on 10/24/2016 provided that 100% signatures of abutting property owners are secured.

Traffic Engineering Division - DPW
(Utility or City Department)

f / Ashok Patel 
By

Head Transportation Engineer
Title

November 23, 2016
Date

313 224-1610
Area code-Telephone number

MA/ma

PETITION NO. 1099
 GIFFELS WEBSTER
 28 W. ADAMS, SUITE 1200
 DETROIT, MICHIGAN 48226
 C/O DEIRDRE CLEIN
 PHONE NO. 313 962-4442

"REVISED"

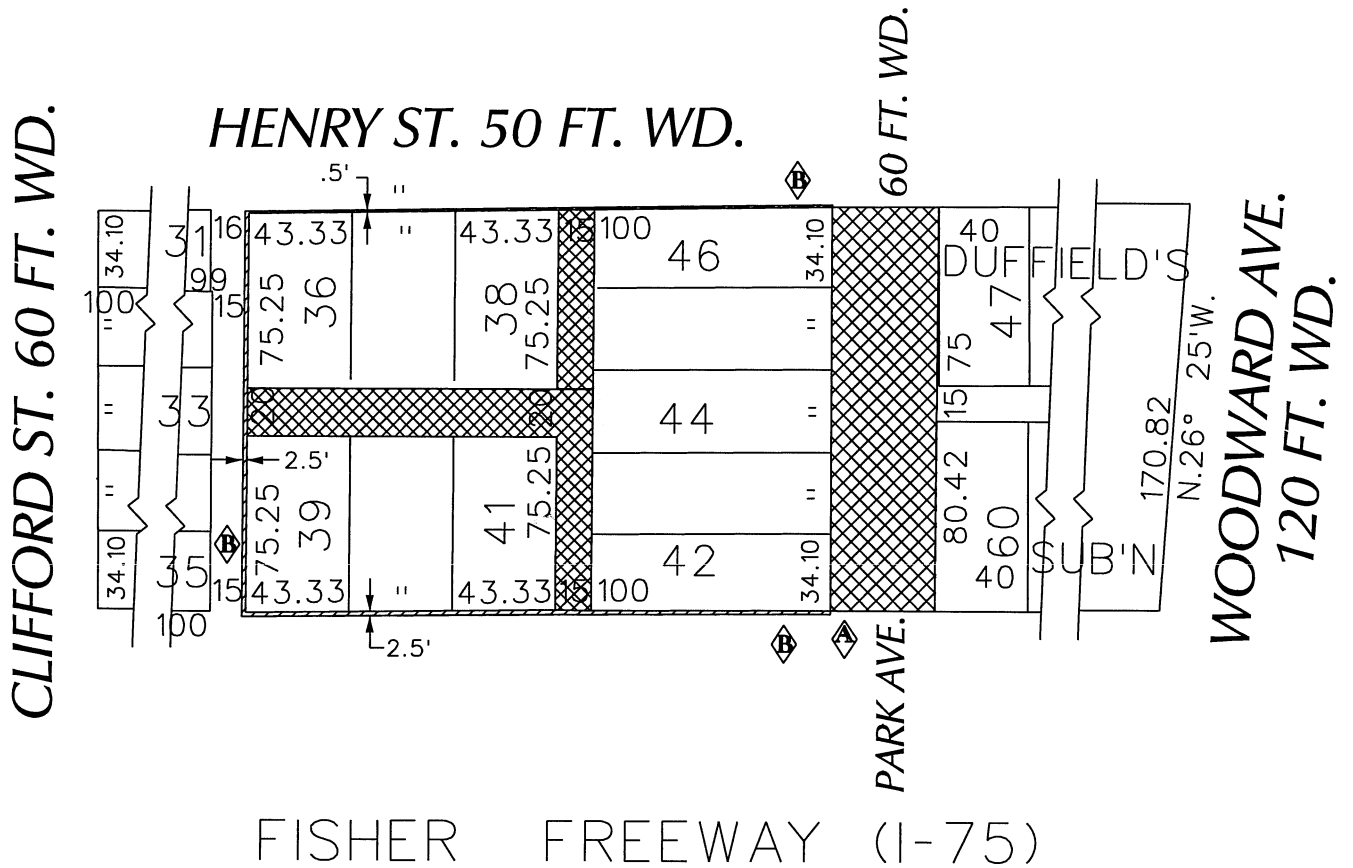

- **OUTRIGHT VACATION**
(Subsurface of Perimeter)
- **OUTRIGHT VACATION**

(FOR OFFICE USE ONLY)

CARTO 29 E

B	VACATE SUBSURFACE OF PERIMETER	WLW	KSM	KSM	10/24/16
A	ADDING PARK AVE. TO REQUEST TO OUTRIGHT VACATE	WLW	KSM	KSM	10/24/16
DESCRIPTION		DRWN	CHKD	APPD	DATE
REVISIONS					
DRAWN BY	WLW	CHECKED			
DATE	04-26-16	APPROVED			

**REQUEST TO OUTRIGHT VACATE
 THE EAST/WEST AND THE NORTH/SOUTH
 PUBLIC ALLEY VARIOUS WIDTHS
 AND PARK AVE., 60 FT. WD.
 IN THE AREA BOUND BY
 CLIFFORD AND HENRY ST., WOODWARD AVE.
 AND FISHER FWY. SERVICE DR.**

CITY OF DETROIT	
CITY ENGINEERING DEPARTMENT	
SURVEY BUREAU	
JOB NO.	01-01
DRWG. NO.	X 1099