



City of Detroit
Inter-Departmental Communication

TO: Richard Doherty, City Engineer
City Engineering/Department of Public Works

FROM: Debra Singleton, Engineer
Detroit Water and Sewerage Department

DATE: August 18, 2016

RE: Petition No. 1099
Request to Outright Vacate the East/West and the North/South Public Alleys in
the Block Bound by Clifford, Henry St., Park Ave. and Fisher Freeway Service
Drive

The Detroit Water and Sewerage Department (DWSD) is in receipt of the subject petition. DWSD has water and/or sewer lines located within the area requested to be outright vacated. The vacation request will be denied unless at least all the following conditions are met:

- Petitioner prepares a relocation plan for DWSD utilities, signed by a Registered Engineer
- DWSD approves the relocation plan
- Petitioner grants DWSD a satisfactory easement
- The Petitioner is to bear the entire cost of the proposed plan, including construction, demolition, permitting, inspection, survey, etc.

The entire work is to be performed in accordance with DWSD specifications and standards. Deposit with DWSD, in advance, the whole amount necessary to cover the costs of permits and inspection.

It is imperative for the Petitioner to contact the DWSD Permits Section directly to discuss this petition. If you have any questions, please feel free to call me at (313) 267-8309 or Mohamed Boudali at (313) 964-9236.

Sincerely,

Debra Singleton
Engineer
Permits Section

DS/MB/mb
Attachments

City of Detroit
**City Engineering Division, Department of Public Works
Survey Bureau**

NOTICE OF PROPOSED CHANGE IN PROPERTY

Date: 04/26/2016

Petition: x1099

- | | |
|--|---|
| <input type="checkbox"/> AT&T Telecommunication | |
| <input type="checkbox"/> Comcast Television (CATV) | <input type="checkbox"/> Berm Use |
| <input type="checkbox"/> Detroit Edison (DTE) | |
| <input type="checkbox"/> Fire Department | <input type="checkbox"/> Conversion to Easement |
| <input type="checkbox"/> Michcon (DTE) | |
| <input type="checkbox"/> Planning & Development Department | <input type="checkbox"/> Dedication |
| <input type="checkbox"/> Public Lighting Authority | |
| <input type="checkbox"/> Public Lighting Department | <input type="checkbox"/> Encroachment |
| <input type="checkbox"/> Police Department | |
| <input type="checkbox"/> Recreation Department | <input type="checkbox"/> Temporary Closing |
| <input type="checkbox"/> Solid Waste Division, DPW | |
| <input type="checkbox"/> Street Design Bureau, DPW | <input checked="" type="checkbox"/> Vacation |
| <input type="checkbox"/> Street Maintenance Division, DPW | |
| <input type="checkbox"/> Traffic Engineering Division, DPW | |
| <input type="checkbox"/> Water and Sewerage Department | |
| <input type="checkbox"/> _____ | |

A petition drawing is attached. Property shown on the attached print is proposed to be changed as indicated. Kindly report (using the back of this sheet) the nature of your services, if any affected by the proposed change and the estimated costs of removing and rerouting such services (if necessary).

Please return one copy to City Engineering Division, DPW within two weeks of the submittal date. Retain one copy and print for you file.

Ron Brundidge, Director, Department of Public Works

By: Richard Doherty, CED DPW
City Engineer

**TO: City Engineering Division, DPW
2 Woodward Ave., Suite 642
Detroit, Michigan 48226-3462
Survey Bureau: 313-224-3970**

Petition: x1099

The proposed change in property (referred to on the other side of this sheet) would affect our services as follows:

- Not Involved

- Involved; but asking you to hold action on this petition until further notice.

- Involved; but no objections to the property change.

- Involved; but no objections to the property change...provided as easement of the full width of the public right-of-way (street, alley or other public place) is reserved.

- Involved; the nature of our services and the estimated costs of removing and/or rerouting such services are:

(Utility or City Department)

By

Title

Date

Area code – Telephone number

PETITION NO. 1099
 GIFFELS WEBSTER
 28 W. ADAMS, SUITE 1200
 DETROIT, MICHIGAN 48226
 C/O DEIRDRE CLEIN
 PHONE NO. 313 962-4442



CLIFFORD ST. 60 FT. WD.

HENRY ST. 50 FT. WD.

PARK AVE. 60 FT. WD.

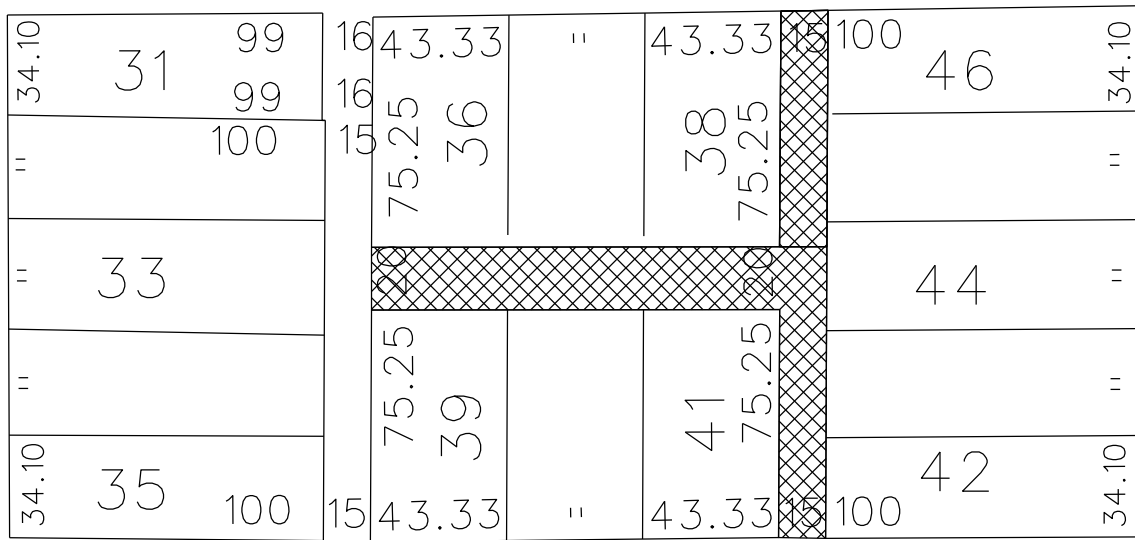

FISHER FREEWAY (I-75)



- OUTRIGHT VACATION

(FOR OFFICE USE ONLY)

CARTO 29 E

B					
A					
DESCRIPTION		DRWN	CHKD	APPD	DATE
REVISIONS					
DRAWN BY		CHECKED			
DATE		APPROVED			
04-26-16					

REQUEST TO OUTRIGHT VACATE
 THE EAST/WEST AND THE NORTH/SOUTH
 PUBLIC ALLEY VARIOUS WIDTHS
 IN THE BLOCK BOUND BY
 CLIFFORD, HENRY ST., PARK AVE.
 AND FISHER FWY. SERVICE DR.

CITY OF DETROIT CITY ENGINEERING DEPARTMENT SURVEY BUREAU	
JOB NO.	01-01
DRWG. NO.	X 1099

Detroit Water & Sewerage Department
Provisions for Relocation Due to Vacation for Petition No 1099

Provided that the petitioner shall design and construct proposed sewers and to make the connections to the existing public sewers as required by the Detroit Water and Sewerage Department (DWSD) prior to construction of the proposed sewers,

Provided that the plans for the sewers shall be prepared by a registered engineer; and further

Provided that DWSD be and is hereby authorized to review the drawings for the proposed sewers and to issue permits for the construction of the sewers, and further

Provided that the entire work is to be performed in accordance with plans and specifications approved by DWSD and constructed under the inspection and approval of DWSD; and further

Provided that the entire cost of the proposed sewers construction, including inspection, survey and engineering shall be borne by the petitioner; and further

Provided that the petitioner shall deposit with DWSD, in advance of engineering, inspection and survey, such amounts as the department deems necessary to cover the costs of these services; and further

Provided that the petitioner shall grant to the City a satisfactory easement for the sewers; and further

Provided that the Board of Water Commissioners shall accept and execute the easement grant on behalf of the City; and further

Provided, that the petitioner shall provide DWSD with as -built drawings on the proposed sewers; and further

Provided that the petitioner shall provide a one (1) year warranty for the proposed sewers; and further

Provided that upon satisfactory completion, the sewers shall become City property and become part of the City system. And any existing sewers that were abandoned shall belong to the petitioner and will no longer be the responsibility of the City.

06/30/14

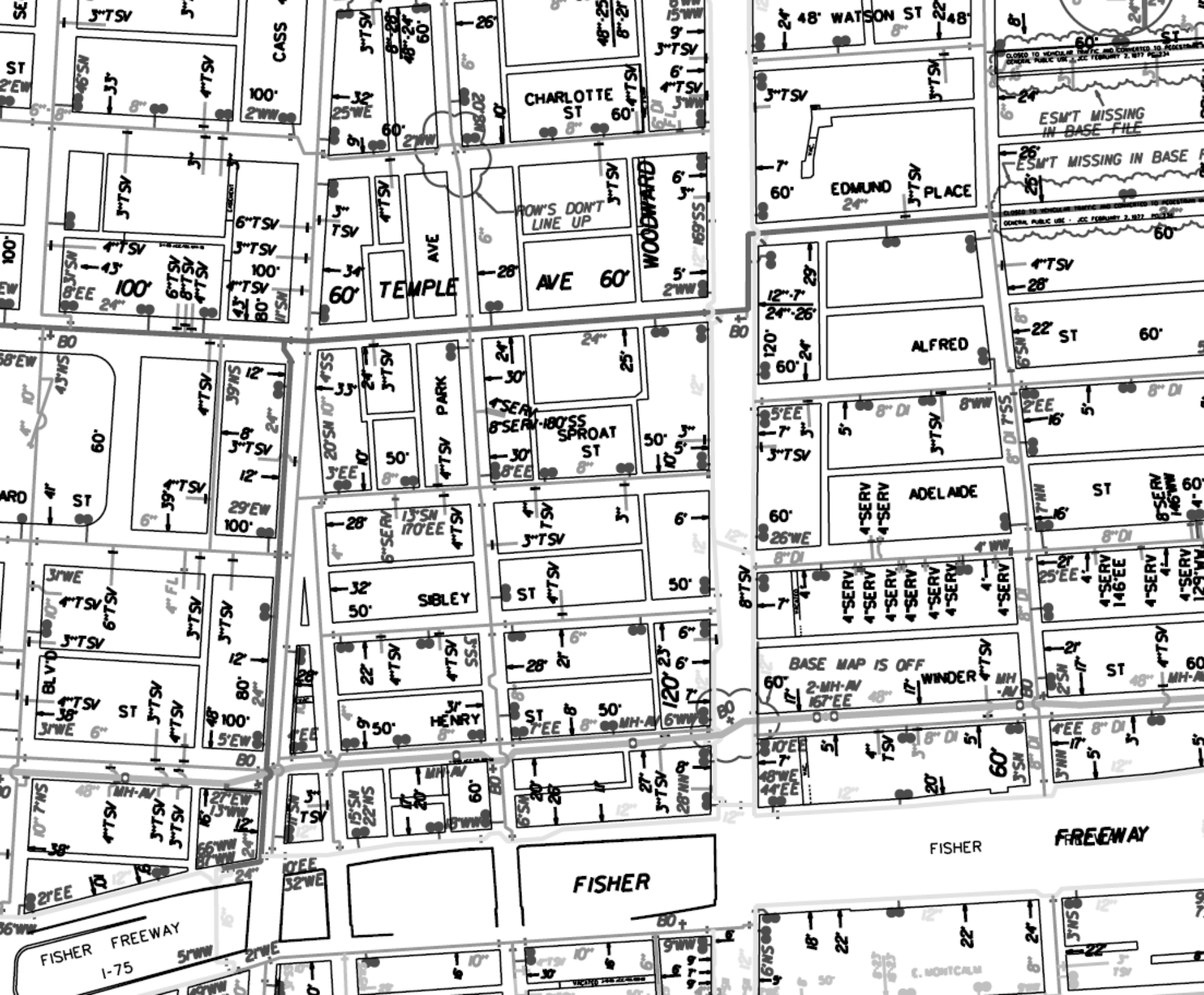

CLOSED TO VEHICULAR TRAFFIC AND CONSIDERED TO BE ACADEMIC
GENERAL PUBLIC USE - JULY FEBRUARY 2, 1977 PLS 334

ESMT MISSING IN BASE FILE

ESMT MISSING IN BASE FILE

CLOSED TO VEHICULAR TRAFFIC AND CONSIDERED TO BE ACADEMIC
GENERAL PUBLIC USE - JULY FEBRUARY 2, 1977 PLS 334

CHARLOTTE ST

EDMUND PLACE

ALFRED

ADELAIDE

SOLEY

HENRY

FISHER

FISHER

FREEWAY

HOW'S DON'T
LINE UP

BASE MAP IS OFF

C. MONTGOMERY

