

TO: City Engineering Division, DPW
2 Woodward Ave., Suite 642
Detroit, MI 48226-3462
Survey Bureau: 313-224-3970

Ref. No. 201604044
Petition No. 1098

The proposed change in property (referred to above) would affect our services as follows:

- Not Involved.
- Involved; but asking you to hold action on this petition until further notice.
- Involved; the nature of our services, and the estimated costs of removing and/or rerouting such services are:
- Involved; have no objection to the requested encroachment into the north/south public alley at 1261 Woodward (with ramp, railing and bollards) as shown on drawing no. x1098 dated 4/28/2016.

Traffic Engineering Division - DPW
(Utility or City Department)

Ashok Patel
By

Head Transportation Engineer
Title

May 16, 2016
Date

313 224-1610
Area code-Telephone number

MA/ma

PETITION NO. 1098
 GIFFELS WEBSTER
 28 W. ADAMS, SUITE 1200
 DETROIT, MICHIGAN 48226
 C/O DEIRDRE CLEIN
 PHONE NO. 313 962-4442



GD. RIVER AVE. 60 FT. WD.

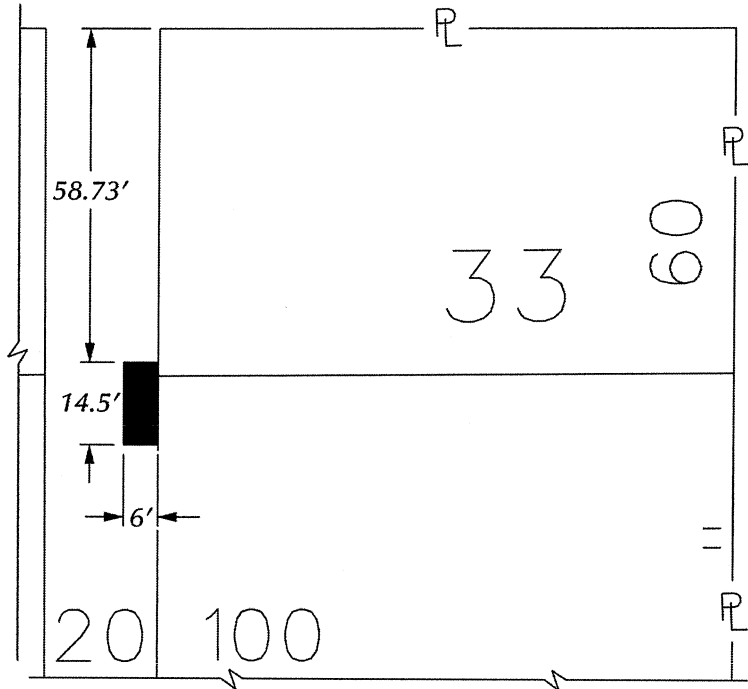

GD. RIVER AVE. 60 FT. WD.

GRISWOLD ST. 60 FT. WD.

60	100	20	100
60	69		33 60
"			"
"	71		35 "
"			"
"	73		37 "
"			"
60	75	20	100 39 60

WOODWARD AVE. 120 FT. WD.

STATE ST. 60 FT. WD.

 - REQUEST ENCROACHMENT
 (With Ramp, Railing and Bollards)

(FOR OFFICE USE ONLY)

CARTO 28 B

B					
A					
DESCRIPTION	DRWN	CHKD	APPD	DATE	
REVISIONS					
DRAWN BY	CHECKED				
DATE	APPROVED				
04-28-16					

REQUEST ENCROACHMENT
 INTO THE NORTH/SOUTH PUBLIC ALLEY
 AT 1261 WOODWARD
 (With Ramp, Railing and Bollards)

CITY OF DETROIT CITY ENGINEERING DEPARTMENT SURVEY BUREAU	
JOB NO.	01-01
DRWG. NO.	X 1098

WOODWARD AVENUE

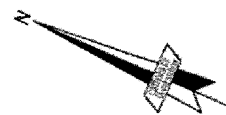

0 10' 20'
SCALE: 1" = 20'

1275 WOODWARD AVENUE

1261 WOODWARD AVENUE

GRAND RIVER AVENUE

6 FT. WIDE BY 14.5 FT. LONG, 4 FT BELOW GRADE TO 6 FT ABOVE GRADE ALLEY RIGHT OF WAY ENCROACHMENT.

6.00 FT.

58.73 FT.

14.50 FT.

35 GRAND RIVER AVENUE



Know what's below.
Call before you dig.

DETROIT, WAYNE, MICHIGAN

**giffels
webster**

28 West Adams Road
Suite 1200
Detroit, MI 48226
p (313) 962-4442
f (313) 962-5068
www.giffelswebster.com

1261 WOODWARD ALLEY
ENCROACHMENT

Date: 04-11-2016
Scale: 1"=20'
Sheet: SK101
Project: 16006.000

Copyright © 2016 Giffels Webster.
No reproduction shall be made
without the prior written consent of
Giffels Webster.

V:\16006.000\1249-1261 Woodward Community Stereo Drawing Files\Engineering\SK101 Encroachment Sheet1.dwg

