



City of Detroit  
Inter-Departmental Communication

---

**TO:** Richard Doherty, City Engineer  
City Engineering/Department of Public Works

**FROM:** Debra Singleton, Engineer  
Detroit Water and Sewerage Department

**DATE:** Sept. 11, 2017

**RE:** Petition No. 1098  
Requested Encroachment Into The North/South Alley At 1261 Woodward (With  
Ramp Railings And Bollards)

---

The above petition received by this office has been reviewed. With regard to DWSD's interests, our comments are as follows:

- Our records indicate that there are water mains and sewers in the alley. DWSD objects to the requested encroachment due to the proximity of our utilities at this proposed location of the ramp railings and bollards due to our maintenance requirements.

If you have any questions, please call me at (313) 267-8309 or Mohammed Fa Siddique at (313)-964-9245

Sincerely,

A handwritten signature in black ink, appearing to read 'Debra Singleton'.

Debra Singleton  
Engineer Permits section

DS/MS/gl

Attachments

CC: Mohamad Farhat, CSF

Michael Duggan, Mayor

City of Detroit  
**City Engineering Division, Department of Public Works  
Survey Bureau**

**NOTICE OF PROPOSED CHANGE IN PROPERTY**

Date: 04/28/2016

Petition: x1098

- |  |  |
|--|--|
| <input type="checkbox"/> AT&T Telecommunication            | <input type="checkbox"/> Berm Use                |
| <input type="checkbox"/> Comcast Television (CATV)         | <input type="checkbox"/> Conversion to Easement  |
| <input type="checkbox"/> Detroit Edison (DTE)              | <input type="checkbox"/> Dedication              |
| <input type="checkbox"/> Fire Department                   | <input checked="" type="checkbox"/> Encroachment |
| <input type="checkbox"/> Michcon (DTE)                     | <input type="checkbox"/> Temporary Closing       |
| <input type="checkbox"/> Planning & Development Department | <input type="checkbox"/> Vacation                |
| <input type="checkbox"/> Public Lighting Authority         |  |
| <input type="checkbox"/> Public Lighting Department        |  |
| <input type="checkbox"/> Police Department                 |  |
| <input type="checkbox"/> Recreation Department             |  |
| <input type="checkbox"/> Solid Waste Division, DPW         |  |
| <input type="checkbox"/> Street Design Bureau, DPW         |  |
| <input type="checkbox"/> Street Maintenance Division, DPW  |  |
| <input type="checkbox"/> Traffic Engineering Division, DPW |  |
| <input type="checkbox"/> Water and Sewerage Department     |  |
| <input type="checkbox"/> _____                             |  |

A petition drawing is attached. Property shown on the attached print is proposed to be changed as indicated. Kindly report (using the back of this sheet) the nature of your services, if any affected by the proposed change and the estimated costs of removing and rerouting such services (if necessary).

Please return one copy to City Engineering Division, DPW within two weeks of the submittal date. Retain one copy and print for you file.

Ron Brundidge, Director, Department of Public Works

By: Richard Doherty, CED DPW  
City Engineer

**TO: City Engineering Division, DPW  
2 Woodward Ave., Suite 642  
Detroit, Michigan 48226-3462  
Survey Bureau: 313-224-3970**

**Petition:   x1098**

The proposed change in property (referred to on the other side of this sheet) would affect our services as follows:

- Not Involved
  
- Involved; but asking you to hold action on this petition until further notice.
  
- Involved; but no objections to the property change.
  
- Involved; but no objections to the property change...provided as easement of the full width of the public right-of-way (street, alley or other public place) is reserved.
  
- Involved; the nature of our services and the estimated costs of removing and/or rerouting such services are:

\_\_\_\_\_  
(Utility or City Department)

\_\_\_\_\_  
By

\_\_\_\_\_  
Title

\_\_\_\_\_  
Date

\_\_\_\_\_  
Area code – Telephone number

PETITION NO. 1098  
 GIFFELS WEBSTER  
 28 W. ADAMS, SUITE 1200  
 DETROIT, MICHIGAN 48226  
 C/O DEIRDRE CLEIN  
 PHONE NO. 313 962-4442



GD. RIVER AVE. 60 FT. WD.

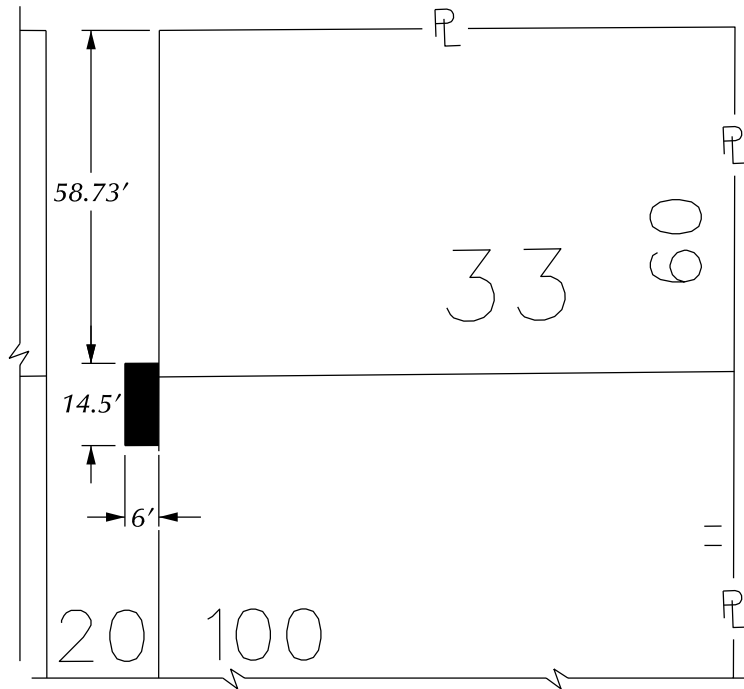

WOODWARD AVE. 120 FT. WD.

GD. RIVER AVE. 60 FT. WD.

GRISWOLD ST. 60 FT. WD.

100	20	100
60	69	33
"	"	"
"	71	35
"	"	"
"	73	37
"	"	"
60	75	39
100	20	100

WOODWARD AVE. 120 FT. WD.

STATE ST. 60 FT. WD.

 - REQUEST ENCROACHMENT  
 (With Ramp, Railing and Bollards)

(FOR OFFICE USE ONLY)

CARTO 28 B

B						<b>REQUEST ENCROACHMENT          INTO THE NORTH/SOUTH PUBLIC ALLEY          AT 1261 WOODWARD          (With Ramp, Railing and Bollards)</b>	<b>CITY OF DETROIT          CITY ENGINEERING DEPARTMENT          SURVEY BUREAU</b>	
A							JOB NO. 01-01	
DESCRIPTION		DRWN	CHKD	APPD	DATE		DRWG. NO. X 1098	
DRAWN BY		REVISIONS						
DATE		CHECKED		APPROVED				
04-28-16		WLW						

WOODWARD AVENUE

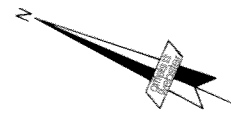

0 10' 20'  
SCALE: 1" = 20'

1275 WOODWARD AVENUE

1261 WOODWARD AVENUE

GRAND RIVER AVENUE

6 FT. WIDE BY 14.5 FT. LONG, 4 FT BELOW GRADE TO 6 FT ABOVE GRADE ALLEY RIGHT OF WAY ENCROACHMENT.

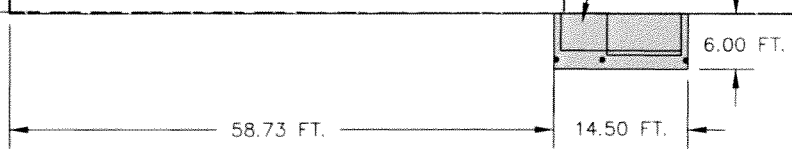

35 GRAND RIVER AVENUE



Know what's below.  
Call before you dig.

DETROIT, WAYNE, MICHIGAN

**giffels webster**

28 West Adams Road  
Suite 1200  
Detroit, MI 48226  
p (313) 962-4442  
f (313) 962-5068  
www.giffelswebster.com

1261 WOODWARD ALLEY  
ENCROACHMENT

Date: 04-11-2016  
Scale: 1"=20'  
Sheet: SK 101  
Project: 19006.00D

Copyright © 2016 Giffels Webster.  
No reproduction shall be made  
without the prior written consent of  
Giffels Webster.

V:\19006.00D\1249-1261 Woodward Community Store\Drawing Files\Engineering\SK 101 Encroachment Sketch.dwg

Engineers Surveyors Planners  
Landscape Architects

Contract No.	STC
Project Name	WOODWARD
Client	WVMA
Design	WVMA
Quality Control	WVMA
Scale	AS SHOWN



Project No.	1501
Sheet No.	1501-00
Date	03.20.2015
Scale	AS SHOWN
Project	1501-00

Bronson Road Estate Services  
 1201 Woodward Avenue  
 Detroit, MI 48226

**Improvement Plan**  
 1251 1201 Woodward Alley  
 City of Detroit  
 Wayne County  
 MICHIGAN

Date	03.20.2015
Scale	AS SHOWN
Project	1501-00

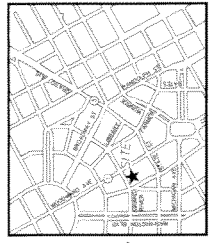

**LOCATION MAP**  
 (NOT TO SCALE)

PROPERTY STATEMENT  
 THE PROFESSIONAL JUDICIAL SURVEY HAS BEEN OBTAINED FROM THE CITY OF DETROIT. THE SURVEYOR MAKES NO GUARANTEE THAT THE UNDERLYING DATA IS CORRECT OR ACCURATE. THE SURVEYOR IS NOT RESPONSIBLE FOR ANY ERRORS OR OMISSIONS IN THIS DOCUMENT. THE SURVEYOR'S LIABILITY IS LIMITED TO THE PROFESSIONAL SERVICES PROVIDED AND DOES NOT INCLUDE THE DESIGN OR CONSTRUCTION OF ANY STRUCTURE OR THE PERFORMANCE OF ANY TRADE OR PROFESSION. THE SURVEYOR'S LIABILITY IS LIMITED TO THE PROFESSIONAL SERVICES PROVIDED AND DOES NOT INCLUDE THE DESIGN OR CONSTRUCTION OF ANY STRUCTURE OR THE PERFORMANCE OF ANY TRADE OR PROFESSION.

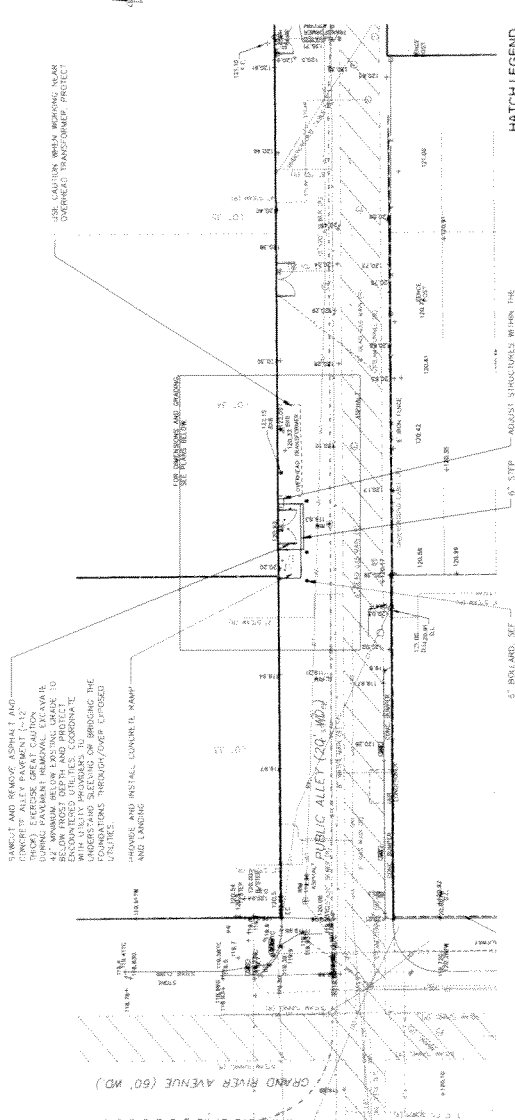

**HATCH LEGEND**

CONCRETE PAVEMENT



**GENERAL NOTES**

- IN CONNECTION WITH PUBLIC WORKS ON THE STATE OF MICHIGAN (EFFECTIVE JANUARY 1, 2014), THE CONTRACTOR SHALL BE RESPONSIBLE FOR OBTAINING ALL NECESSARY PERMITS AND APPROVALS FROM THE APPROPRIATE AGENCIES AND AGENCIES NEAR THE PROJECT SITE. THE CONTRACTOR SHALL BE RESPONSIBLE FOR OBTAINING ALL NECESSARY PERMITS AND APPROVALS FROM THE APPROPRIATE AGENCIES AND AGENCIES NEAR THE PROJECT SITE.
- THE CONTRACTOR SHALL BE RESPONSIBLE FOR OBTAINING ALL NECESSARY PERMITS AND APPROVALS FROM THE APPROPRIATE AGENCIES AND AGENCIES NEAR THE PROJECT SITE.
- THE CONTRACTOR SHALL BE RESPONSIBLE FOR OBTAINING ALL NECESSARY PERMITS AND APPROVALS FROM THE APPROPRIATE AGENCIES AND AGENCIES NEAR THE PROJECT SITE.
- THE CONTRACTOR SHALL BE RESPONSIBLE FOR OBTAINING ALL NECESSARY PERMITS AND APPROVALS FROM THE APPROPRIATE AGENCIES AND AGENCIES NEAR THE PROJECT SITE.
- THE CONTRACTOR SHALL BE RESPONSIBLE FOR OBTAINING ALL NECESSARY PERMITS AND APPROVALS FROM THE APPROPRIATE AGENCIES AND AGENCIES NEAR THE PROJECT SITE.
- THE CONTRACTOR SHALL BE RESPONSIBLE FOR OBTAINING ALL NECESSARY PERMITS AND APPROVALS FROM THE APPROPRIATE AGENCIES AND AGENCIES NEAR THE PROJECT SITE.
- THE CONTRACTOR SHALL BE RESPONSIBLE FOR OBTAINING ALL NECESSARY PERMITS AND APPROVALS FROM THE APPROPRIATE AGENCIES AND AGENCIES NEAR THE PROJECT SITE.
- THE CONTRACTOR SHALL BE RESPONSIBLE FOR OBTAINING ALL NECESSARY PERMITS AND APPROVALS FROM THE APPROPRIATE AGENCIES AND AGENCIES NEAR THE PROJECT SITE.
- THE CONTRACTOR SHALL BE RESPONSIBLE FOR OBTAINING ALL NECESSARY PERMITS AND APPROVALS FROM THE APPROPRIATE AGENCIES AND AGENCIES NEAR THE PROJECT SITE.
- THE CONTRACTOR SHALL BE RESPONSIBLE FOR OBTAINING ALL NECESSARY PERMITS AND APPROVALS FROM THE APPROPRIATE AGENCIES AND AGENCIES NEAR THE PROJECT SITE.

**DETAILED DIMENSION PLAN**  
 SCALE 1" = 10'



**DETAILED GRADING PLAN**  
 SCALE 1" = 10'

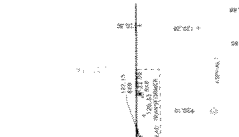

**SMOOTH CONC. GAP**

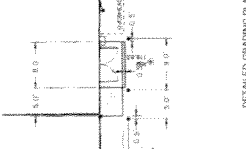

**BOLLARD DETAIL**  
 NOT TO SCALE  
 SEE PLAN FOR LOCATIONS

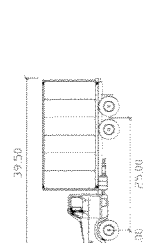
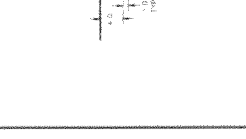

**SU-40 TRUCK**  
 39.50 FEET LENGTH  
 7.50 FEET WIDTH  
 4.00 FEET HEIGHT

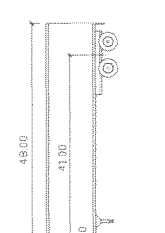

**MB-60 TRACTOR**  
 48.00 FEET LENGTH  
 4.50 FEET WIDTH  
 4.00 FEET HEIGHT

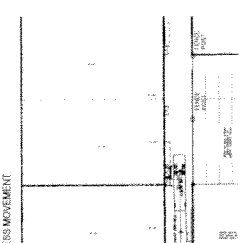

**SU-40 INGRESS MOVEMENT**

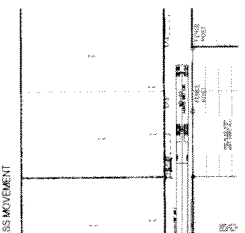

**MB-60 INGRESS MOVEMENT**

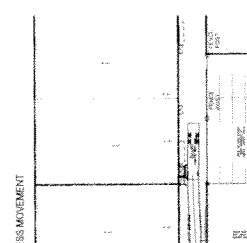

**SU-40 EGRESS MOVEMENT**

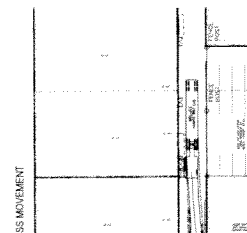

**MB-60 EGRESS MOVEMENT**

**TURNING ANALYSIS NOTES**

- MOVEMENTS ARE BACK IN CLASH.
- SU-40 IS A NON-ARTICULATING VEHICLE AND CAN MAKE EITHER BACKWARD OR FORWARD INGRESS MOVEMENTS AS NECESSARY.
- MOVEMENTS REALIZING THE MB-60 TRUCK (OVERALL LENGTH = 73.5 FEET) BUT THE TURNING MOVEMENTS DID NOT FIT WITHIN THE GIVEN DIMENSIONS.

## **PROVISIONS FOR ENCROACHMENT For Petition 1098**

Detroit Water and Sewerage (DWSD) agree to the proposed encroachment subject to the fulfilling of the following provisions:

1. By approval of this petition the (DWSD) does not waive any of its rights to its facilities located in the right of way, and at all time, DWSD, its agents or employees, shall have the right to enter upon the right of way to maintain, repair, alter, service, inspect, or install its facilities. All costs incident to the damaging, dismantling, demolishing, removal and replacement of structures or other improvements herein permitted and incurred in gaining access to DWSD's facilities for maintenance, repairing, alteration, servicing or inspection caused by the encroachment shall be borne by the petitioner. All costs associated with gaining access to DWSD's facilities, which could normally be expected had the petitioner not encroached into the right of way shall be borne by DWSD.
2. All construction performed under this petition shall not be commenced until after five (5) days written notice to DWSD. Seventy-two (72) hours notice shall also be provided in accordance with P.A. 53 1974, as amended, utilizing the MISS DIG one call system.
3. Construction under this petition is subject to inspection and approval by DWSD forces. The cost of such inspection shall, at the discretion of DWSD, be borne by the petitioner.
4. If DWSD facilities located within the right of way shall break or be damaged as the result of any action on the part of the petitioner, then in such event the petitioner agrees to be liable for all costs incident to the repair, replacement or relocation of such broken or damaged DWSD facilities.
5. The petitioner shall hold DWSD harmless for any damage to the encroaching device constructed or installed under this petition, which may be caused by the failure of DWSD's facilities.

