



City of Detroit
Inter-Departmental Communication

TO: Richard Doherty, City Engineer
City Engineering/Department of Public Works

FROM: Debra Singleton, Engineer
Detroit Water and Sewerage Department

DATE: June 30, 2016

RE: Petition No. 1065
Request for Conversion to Easement of the North/South Alleys in the Block
Bound by Jay, Orleans and Gratiot

The above petition received by this office on April 13, 2016 has been reviewed. With regard to DWSD's interests, our comments are as follows

- Our records indicate that there is a sewer in the easement conversion area. DWSD has no objection to the requested conversion to easement provided that the attached Provisions for Conversion to Easement are strictly followed.

If you have any questions, please call me at (313) 267-8309 or Mohamed Boudali at (313) 964-9236.

Sincerely, 



Debra Singleton
Engineer
Claims and Permits

DS/gl
Attachments

CC: Mohamad Farhat, CSF

City of Detroit
City Engineering Division, Department of Public Works
Survey Bureau

NOTICE OF PROPOSED CHANGE IN PROPERTY

Date: _____

Petition: _____

- | | |
|--|---|
| <input type="checkbox"/> AT&T Telecommunication | <input type="checkbox"/> Berm Use |
| <input type="checkbox"/> Comcast Television (CATV) | <input type="checkbox"/> Conversion to Easement |
| <input type="checkbox"/> Detroit Edison (DTE) | <input type="checkbox"/> Dedication |
| <input type="checkbox"/> Fire Department | <input type="checkbox"/> Encroachment |
| <input type="checkbox"/> Michcon (DTE) | <input type="checkbox"/> Temporary Closing |
| <input type="checkbox"/> Planning & Development Department | <input type="checkbox"/> Vacation |
| <input type="checkbox"/> Public Lighting Authority | |
| <input type="checkbox"/> Public Lighting Department | |
| <input type="checkbox"/> Police Department | |
| <input type="checkbox"/> Recreation Department | |
| <input type="checkbox"/> Solid Waste Division, DPW | |
| <input type="checkbox"/> Street Design Bureau, DPW | |
| <input type="checkbox"/> Street Maintenance Division, DPW | |
| <input type="checkbox"/> Traffic Engineering Division, DPW | |
| <input type="checkbox"/> Water and Sewerage Department | |
| <input type="checkbox"/> _____ | |

A petition drawing is attached. Property shown on the attached print is proposed to be changed as indicated. Kindly report (using the back of this sheet) the nature of your services, if any affected by the proposed change and the estimated costs of removing and rerouting such services (if necessary).

Please return one copy to City Engineering Division, DPW within two weeks of the submittal date. Retain one copy and print for you file.

Ron Brundidge, Director, Department of Public Works

By: Richard Doherty, CED DPW
City Engineer

**TO: City Engineering Division, DPW
2 Woodward Ave., Suite 642
Detroit, Michigan 48226-3462
Survey Bureau: 313-224-3970**

Petition: _____

The proposed change in property (referred to on the other side of this sheet) would affect our services as follows:

- Not Involved

- Involved; but asking you to hold action on this petition until further notice.

- Involved; but no objections to the property change.

- Involved; but no objections to the property change...provided as easement of the full width of the public right-of-way (street, alley or other public place) is reserved.

- Involved; the nature of our services and the estimated costs of removing and/or rerouting such services are:

(Utility or City Department)

By

Title

Date

Area code – Telephone number

PROVISIONS FOR CONVERSION TO EASEMENT

1. An easement, the full width of the existing right of way, is reserved for the Detroit Water and Sewerage Department for the purpose of installing, maintaining, repairing, removing, or replacing any sewers, water mains, fire hydrants and appurtenances, with the right of ingress and egress at any time to, and over said easement for the purpose above set forth.

Free and easy access to the sewers, water mains, fire hydrants and appurtenances within the easement is required for Detroit Water and Sewerage Department equipment, including the use of backhoes, bull dozers, cranes or pipe trucks, and other heavy construction equipment, as necessary for the alteration or repair of the sewer or water main facilities.

The Detroit Water and Sewerage Department retains the right to install suitable permanent main location guide posts over its water mains at reasonable intervals and at points of deflection.

2. Said owners of the adjoining property, for themselves, their heirs and assigns, agree that no building or structure of any nature whatsoever, including fences, porches, patios, balconies, etc., shall be built upon or over said easement, or that no grade changes or storage of materials shall be made within said easement without prior written approval and agreement with the Detroit Water and Sewerage Department.
3. If at any time in the future, the owners of any lots abutting on said vacated right of way shall request the removal and/or relocation of the aforementioned utilities in said easement, such owners shall pay all costs incident to such removal and/or relocation. It is further provided that if sewers, water mains, and/or appurtenances in said easement shall break or be damaged as a result of any action on the part of the owner, or assigns, then in such event, the owner or assigns shall be liable for all costs incident to the repair of such broken or damaged sewers and water mains, and shall also be liable for all claims for damages resulting from his action.

These provisions shall be made part of the City Council's Vacating Resolution.

04/08/13

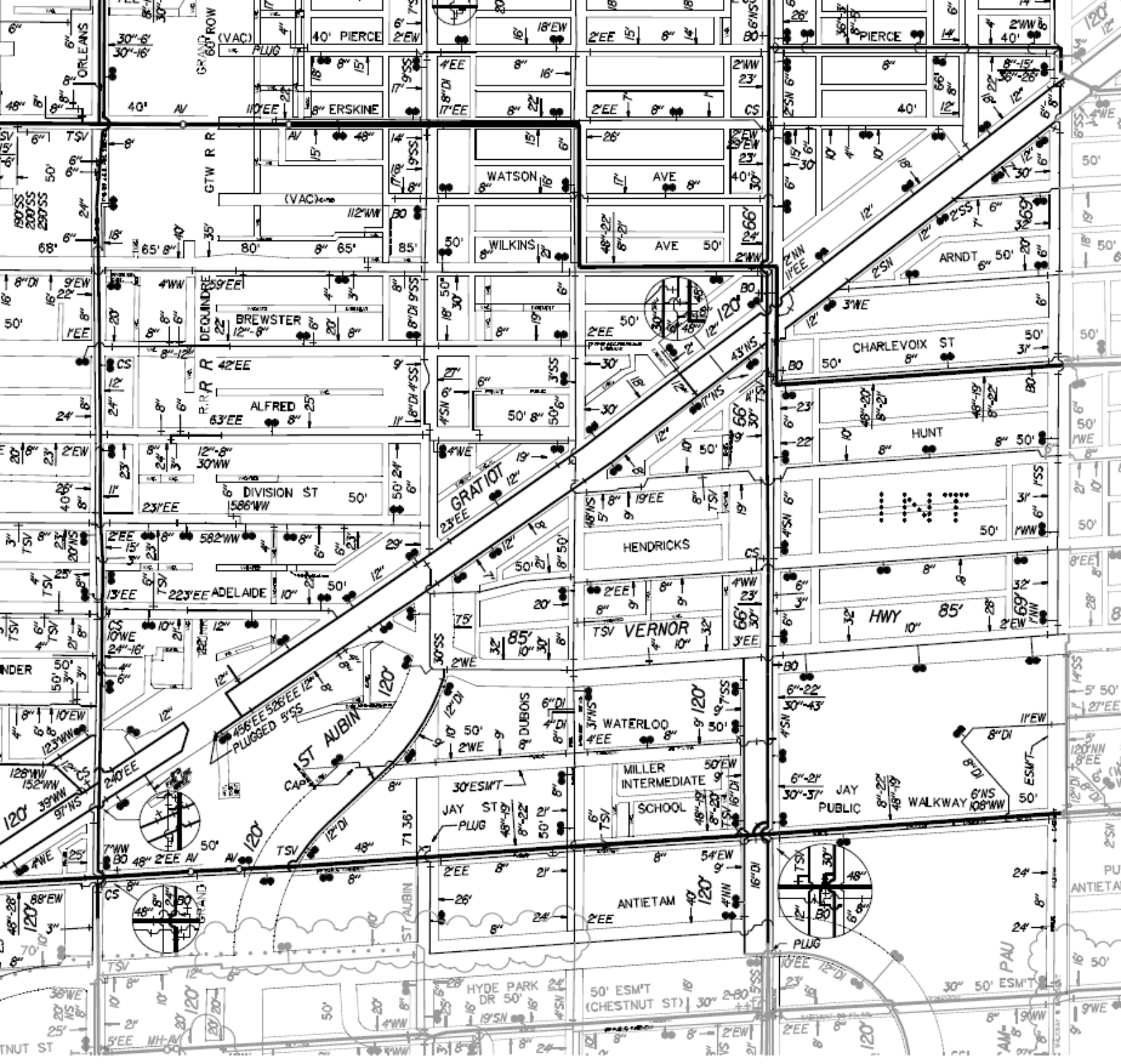

ORLEANS
30'-6"
30'-16"

ROW (VAC)
40' PIERCE
PLUG
8' ERSKINE

WATSON
WILKINS

WATSON
WILKINS

WATSON
WILKINS

WATSON
WILKINS

WATSON
WILKINS

WATSON
WILKINS

WATSON
WILKINS

WATSON
WILKINS

TSV
150'SS
200'SS
200'SS

GTW R R
112' WW
112' WW

WATSON
WILKINS

WATSON
WILKINS

WATSON
WILKINS

WATSON
WILKINS

WATSON
WILKINS

WATSON
WILKINS

WATSON
WILKINS

WATSON
WILKINS

TSV
16'-8"
16'-2"
9' EW
50'

DEQUINDRE
BREWSTER
ALFRED
DIVISION ST
582' WW
1586' WW

WATSON
WILKINS

WATSON
WILKINS

WATSON
WILKINS

WATSON
WILKINS

WATSON
WILKINS

WATSON
WILKINS

WATSON
WILKINS

WATSON
WILKINS

TSV
20'
23'
2' EW
40'-8"
8'

DEQUINDRE
BREWSTER
ALFRED
DIVISION ST
582' WW
1586' WW

WATSON
WILKINS

WATSON
WILKINS

WATSON
WILKINS

WATSON
WILKINS

WATSON
WILKINS

WATSON
WILKINS

WATSON
WILKINS

WATSON
WILKINS

TSV
3'
7' SW
4' SW
20' NS
20' NS

DEQUINDRE
BREWSTER
ALFRED
DIVISION ST
582' WW
1586' WW

WATSON
WILKINS

WATSON
WILKINS

WATSON
WILKINS

WATSON
WILKINS

WATSON
WILKINS

WATSON
WILKINS

WATSON
WILKINS

WATSON
WILKINS

TSV
10' WE
24'-16"
12'
12'

DEQUINDRE
BREWSTER
ALFRED
DIVISION ST
582' WW
1586' WW

WATSON
WILKINS

WATSON
WILKINS

WATSON
WILKINS

WATSON
WILKINS

WATSON
WILKINS

WATSON
WILKINS

WATSON
WILKINS

WATSON
WILKINS

TSV
128' WW
152' WW
123' WW
123' WW

DEQUINDRE
BREWSTER
ALFRED
DIVISION ST
582' WW
1586' WW

WATSON
WILKINS

WATSON
WILKINS

WATSON
WILKINS

WATSON
WILKINS

WATSON
WILKINS

WATSON
WILKINS

WATSON
WILKINS

WATSON
WILKINS

TSV
7' WW
48' ZEE
48' ZEE

DEQUINDRE
BREWSTER
ALFRED
DIVISION ST
582' WW
1586' WW

WATSON
WILKINS

WATSON
WILKINS

WATSON
WILKINS

WATSON
WILKINS

WATSON
WILKINS

WATSON
WILKINS

WATSON
WILKINS

WATSON
WILKINS

TSV
38' WE
20' NS
25' NS
5' YEE
MH-AV

DEQUINDRE
BREWSTER
ALFRED
DIVISION ST
582' WW
1586' WW

WATSON
WILKINS

WATSON
WILKINS

WATSON
WILKINS

WATSON
WILKINS

WATSON
WILKINS

WATSON
WILKINS

WATSON
WILKINS

WATSON
WILKINS

