

TO: City Engineering Division, DPW  
2 Woodward Ave., Suite 642  
Detroit, MI 48226-3462  
Survey Bureau: 313-224-3970

Ref. No. 201608023  
Petition No. 1058

The proposed change in property (referred to above) would affect our services as follows:

- ( ) Not Involved.
- ( ) Involved; but asking you to hold action on this petition until further notice.
- ( ) Involved; the nature of our services, and the estimated costs of removing and/or rerouting such services are:
- (X) Involved; have no objection to request for encroachment into second at 4111 Second Avenue (with wrought iron fencing) as shown on drawing no. x1058 dated 4/13/2016 provided that a minimum 9 ft wide sidewalk adjacent to the requested encroachment shall be maintained clear of any obstructions for use by pedestrian traffic at all times.

Traffic Engineering Division - DPW  
(Utility or City Department)

Ashok Patel  
By



City Traffic Engineer  
Title

August 16, 2016  
Date

313 224-1610  
Area code-Telephone number

MA/ma

PETITION NO. 1058  
 GREEN GARAGE  
 4444 SECOND AVE.  
 DETROIT, MICHIGAN 48201  
 C/O JOE GALLAGHER  
 PHONE NO. 248 345-8309



WILLIS AVE. 100 FT. WD.

THIRD AVE. 70 FT. WD.

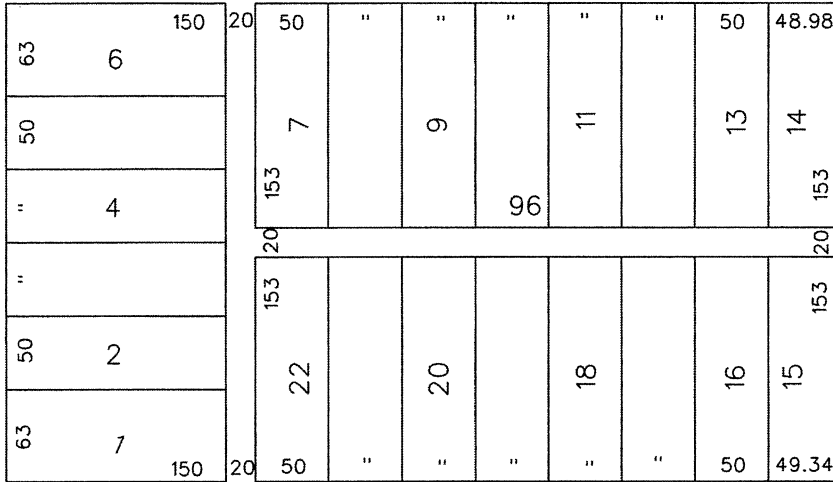

ALEXANDRINE AVE. 100 FT. WD.

SECOND BLVD. 100 FT. WD.

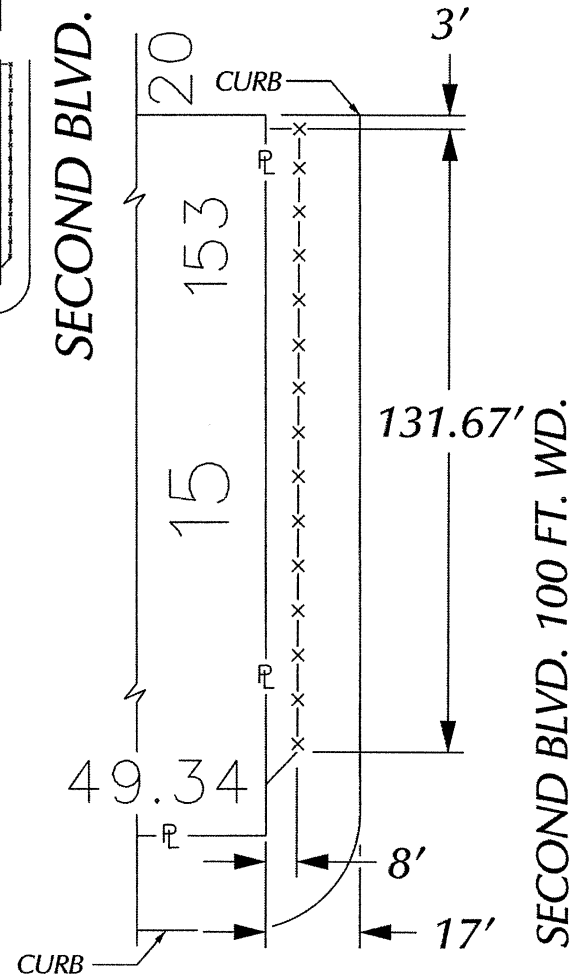

ALEXANDRINE AVE. 100 FT. WD.

-x-x-x- - REQUEST ENCROACHMENT  
 (With Wrought Iron Fencing)

(FOR OFFICE USE ONLY)

CARTO 30 E

B					
A					
DESCRIPTION		DRWN	CHKD	APPD	DATE
REVISIONS					
DRAWN BY		CHECKED			
DATE		APPROVED			
04-13-16					

REQUEST ENCROACHMENT  
 INTO SECOND  
 AT 4111 SECOND AVE.  
 (With Wrought Iron Fencing)

CITY OF DETROIT CITY ENGINEERING DEPARTMENT SURVEY BUREAU	
JOB NO.	01-01
DRWG. NO.	X 1058