

City of Detroit
City Engineering Division, Department of Public Works
Survey Bureau

5th Notice 9/8/16

4th Notice 8/9/16

3rd Notice 7/6/16

2nd Notice 6/1/16

NOTICE OF PROPOSED CHANGE IN PROPERTY

Date: 04/14/2016

Petition: x1058

- | | |
|--|--|
| <input type="checkbox"/> AT&T Telecommunication | <input type="checkbox"/> Berm Use |
| <input type="checkbox"/> Comcast Television (CATV) | <input type="checkbox"/> Conversion to Easement |
| <input type="checkbox"/> Detroit Edison (DTE) | <input type="checkbox"/> Dedication |
| <input type="checkbox"/> Fire Department | <input checked="" type="checkbox"/> Encroachment |
| <input type="checkbox"/> Michcon (DTE) | <input type="checkbox"/> Temporary Closing |
| <input type="checkbox"/> Planning & Development Department | <input type="checkbox"/> Vacation |
| <input checked="" type="checkbox"/> Public Lighting Authority | |
| <input checked="" type="checkbox"/> Public Lighting Department | |
| <input type="checkbox"/> Police Department | |
| <input type="checkbox"/> Recreation Department | |
| <input type="checkbox"/> Solid Waste Division, DPW | |
| <input type="checkbox"/> Street Design Bureau, DPW | |
| <input type="checkbox"/> Street Maintenance Division, DPW | |
| <input type="checkbox"/> Traffic Engineering Division, DPW | |
| <input type="checkbox"/> Water and Sewerage Department | |
| <input type="checkbox"/> _____ | |

A petition drawing is attached. Property shown on the attached print is proposed to be changed as indicated. Kindly report (using the back of this sheet) the nature of your services, if any affected by the proposed change and the estimated costs of removing and rerouting such services (if necessary).

Please return one copy to City Engineering Division, DPW within two weeks of the submittal date. Retain one copy and print for you file.

Ron Brundidge, Director, Department of Public Works

By: Richard Doherty, CED DPW
City Engineer

PETITION NO. 1058
 GREEN GARAGE
 4444 SECOND AVE.
 DETROIT, MICHIGAN 48201
 C/O JOE GALLAGHER
 PHONE NO. 248 345-8309



WILLIS AVE. 100 FT. WD.

THIRD AVE. 70 FT. WD.

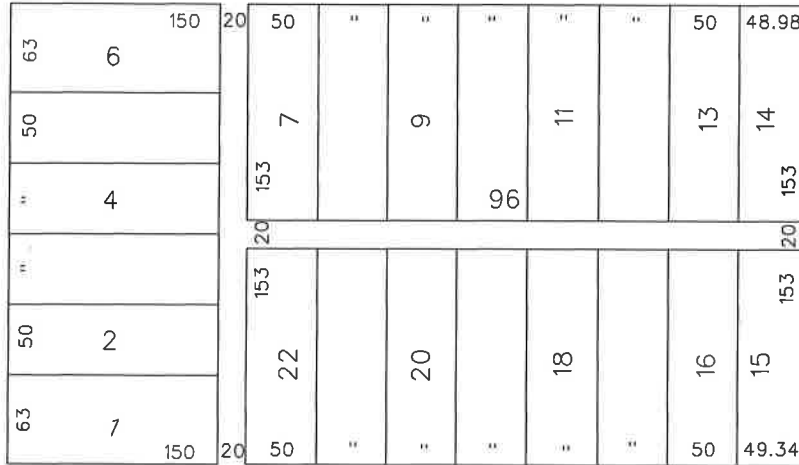

ALEXANDRINE AVE. 100 FT. WD.

SECOND BLVD. 100 FT. WD.

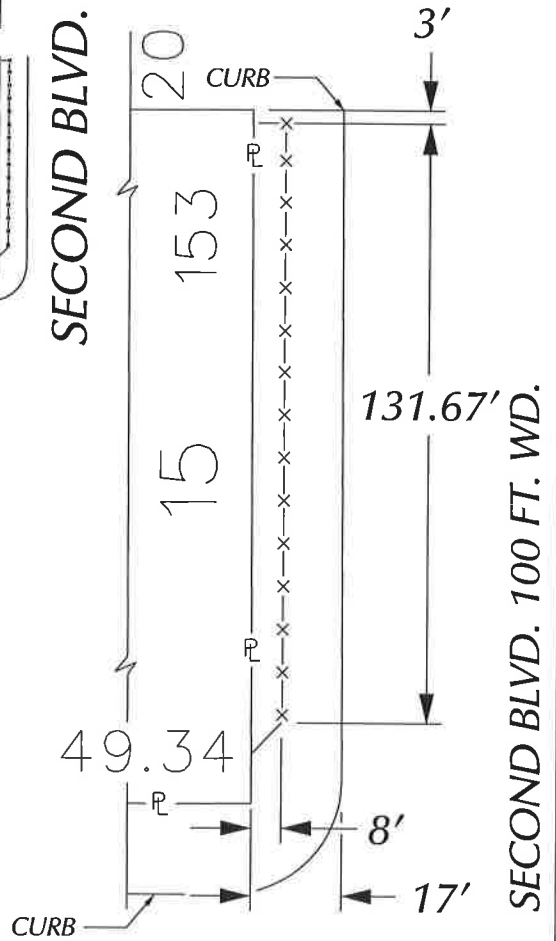

ALEXANDRINE AVE. 100 FT. WD.

-x-x-x- - REQUEST ENCROACHMENT
 (With Wrought Iron Fencing)

(FOR OFFICE USE ONLY)

CARTO 30 E

B					
A					
DESCRIPTION		DRWN	CHKD	APPD	DATE
REVISIONS					
DRAWN BY	WLW	CHECKED			
DATE	04-13-16	APPROVED			

**REQUEST ENCROACHMENT
 INTO SECOND
 AT 4111 SECOND AVE.
 (With Wrought Iron Fencing)**

CITY OF DETROIT CITY ENGINEERING DEPARTMENT SURVEY BUREAU	
JOB NO.	01-01
DRWG. NO.	X 1058