

City of Detroit
**City Engineering Division, Department of Public Works
Survey Bureau**

NOTICE OF PROPOSED CHANGE IN PROPERTY

Date: 04/14/2016

Petition: x1058

- | | |
|--|--|
| <input checked="" type="checkbox"/> AT&T Telecommunication | <input type="checkbox"/> Berm Use |
| <input type="checkbox"/> Comcast Television (CATV) | <input type="checkbox"/> Conversion to Easement |
| <input type="checkbox"/> Detroit Edison (DTE) | <input type="checkbox"/> Dedication |
| <input type="checkbox"/> Fire Department | <input checked="" type="checkbox"/> Encroachment |
| <input type="checkbox"/> Michcon (DTE) | <input type="checkbox"/> Temporary Closing |
| <input type="checkbox"/> Planning & Development Department | <input type="checkbox"/> Vacation |
| <input type="checkbox"/> Public Lighting Authority | |
| <input type="checkbox"/> Public Lighting Department | |
| <input type="checkbox"/> Police Department | |
| <input type="checkbox"/> Recreation Department | |
| <input type="checkbox"/> Solid Waste Division, DPW | |
| <input type="checkbox"/> Street Design Bureau, DPW | |
| <input type="checkbox"/> Street Maintenance Division, DPW | |
| <input type="checkbox"/> Traffic Engineering Division, DPW | |
| <input type="checkbox"/> Water and Sewerage Department | |
| <input type="checkbox"/> _____ | |

A petition drawing is attached. Property shown on the attached print is proposed to be changed as indicated. Kindly report (using the back of this sheet) the nature of your services, if any affected by the proposed change and the estimated costs of removing and rerouting such services (if necessary).

Please return one copy to City Engineering Division, DPW within two weeks of the submittal date. Retain one copy and print for you file.

Ron Brundidge, Director, Department of Public Works

By: Richard Doherty, CED DPW
City Engineer

TO: City Engineering Division, DPW
2 Woodward Ave., Suite 642
Detroit, Michigan 48226-3462
Survey Bureau: 313-224-3970

Petition: x1058

The proposed change in property (referred to on the other side of this sheet) would affect our services as follows:

- Not Involved
- Involved; but asking you to hold action on this petition until further notice.
- Involved; but no objections to the property change.
- Involved; but no objections to the property change...provided as easement of the full width of the public right-of-way (street, alley or other public place) is reserved.
*WE HAVE A CONDUIT RUNNING parallel to ALEXANDRINE + WILLIS
1/2 WAY BETWEEN (in the alley)*
- Involved; the nature of our services and the estimated costs of removing and/or rerouting such services are:

AT&T
(Utility or City Department)

JOSEPH PALETTA JP87SR
By

ENGINEER - DESIGN
Title

4-18-2016
Date

(313) 510-7734
Area code - Telephone number

2117B3

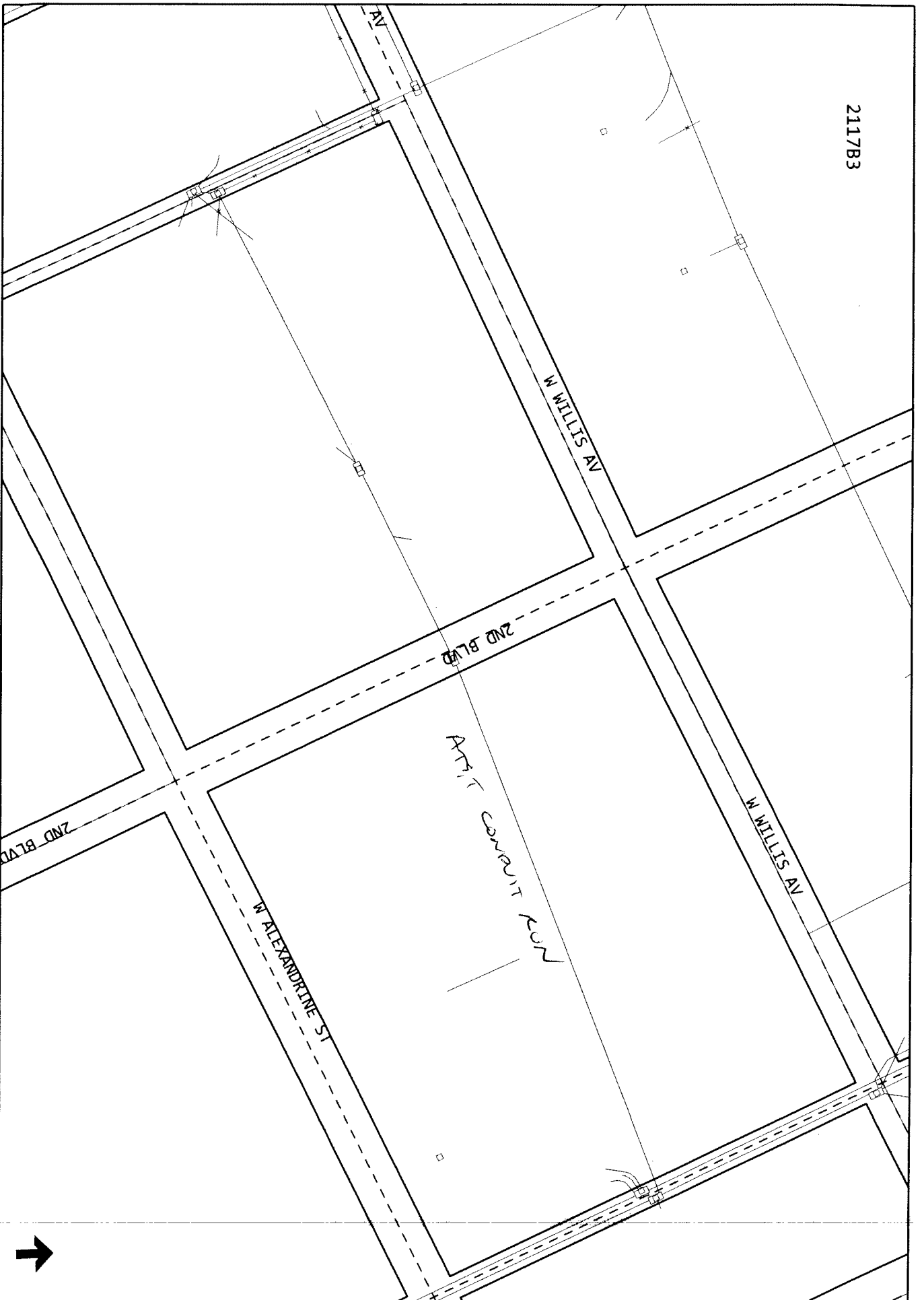

AT&T Proprietary (Internal Use Only). Not for use or disclosure outside of the AT&T companies except under written agreement.

jp875r

4/18/2016

PETITION NO. 1058
 GREEN GARAGE
 4444 SECOND AVE.
 DETROIT, MICHIGAN 48201
 C/O JOE GALLAGHER
 PHONE NO. 248 345-8309



THIRD AVE. 70 FT. WD.

WILLIS AVE. 100 FT. WD.

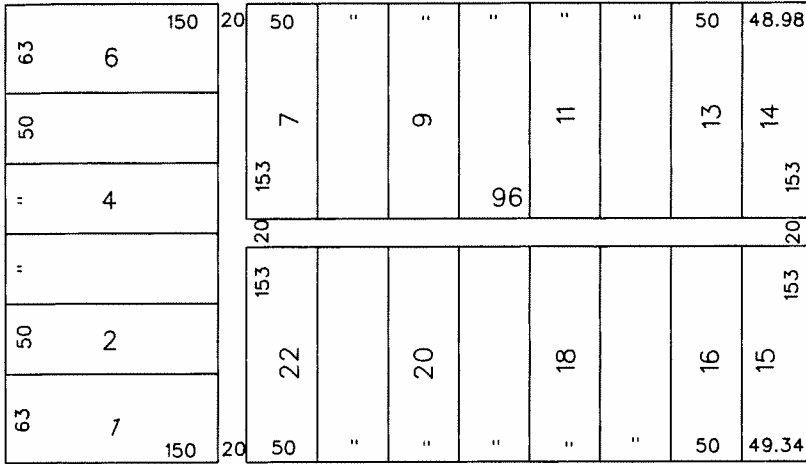

ALEXANDRINE AVE. 100 FT. WD.

SECOND BLVD. 100 FT. WD.

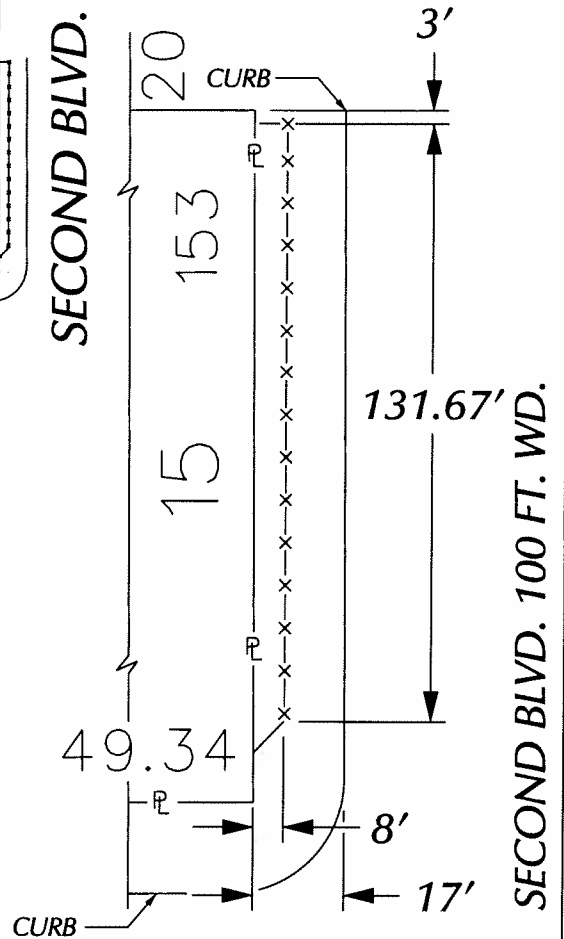

ALEXANDRINE AVE. 100 FT. WD.

-x-x-x- - REQUEST ENCROACHMENT
 (With Wrought Iron Fencing)

(FOR OFFICE USE ONLY)

CARTO 30 E

B					
A					
DESCRIPTION					
REVISIONS					
DRAWN BY	WLW	CHECKED		APPD	DATE
DATE	04-13-16	APPROVED			

**REQUEST ENCROACHMENT
 INTO SECOND
 AT 4111 SECOND AVE.
 (With Wrought Iron Fencing)**

CITY OF DETROIT CITY ENGINEERING DEPARTMENT	
SURVEY BUREAU	
JOB NO.	01-01
DRWG. NO.	X 1058