

TO: City Engineering Division, DPW  
2 Woodward Ave., Suite 642  
Detroit, MI 48226-3462  
Survey Bureau: 313-224-3970

Ref. No. 201603009  
Petition No. 1002

The proposed change in property (referred to above) would affect our services as follows:

- ( ) Not Involved.
- ( ) Involved; but asking you to hold action on this petition until further notice.
- ( ) Involved; the nature of our services, and the estimated costs of removing and/or rerouting such services are:
- (X) Involved; have no objection to the request to convert to easement the east/west public alley, 16 ft wide in the block bound by W. Warren, McDonald, Holmes Ave. and Penna.-Detroit Terminal R.R. as shown on drawing no. x1002 dated 3/10/2016 provided that 100% signatures of abutting property owners are secured.

Traffic Engineering Division - DPW  
(Utility or City Department)

*for* Ashok Patel   
By

Head Transportation Engineer  
Title

April 19, 2016  
Date

313 224-1610  
Area code-Telephone number

MA/ma

PETITION NO. 1002  
 NAGI MOHAMMAD  
 6332 TERNES AVE.  
 DEARBORN, MICHIGAN 48126  
 PHONE NO. 313 715-8522



PENNA.-DETROIT TERMINAL  
 RXR 100 FT. WD.

W. WARREN AVE. 100 FT. WD.

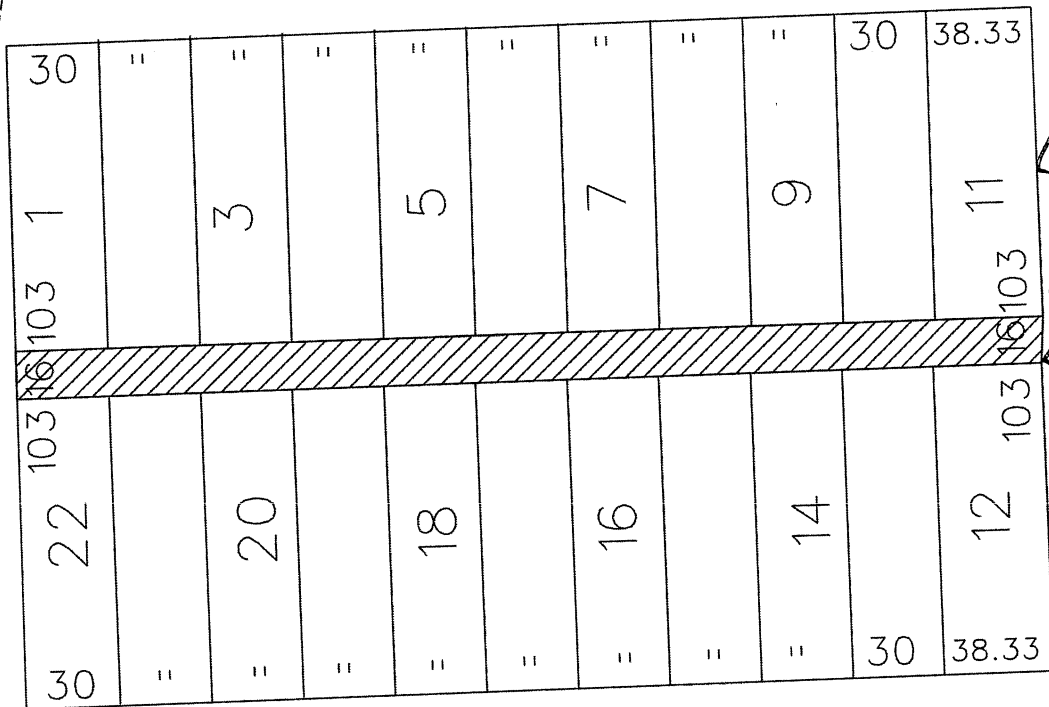

MC DONALD AVE. 50 FT. WD.

HOLMES AVE. 60 FT. WD.



- REQUESTED CONVERSION TO EASEMENT

(FOR OFFICE USE ONLY)

CARTO 5 B

B					
A					
DESCRIPTION		DRWN	CHKD	APPD	DATE
REVISIONS					
DRAWN BY		CHECKED			
DATE		APPROVED			
03-10-16					

REQUEST TO CONVERT TO EASEMENT  
 THE EAST/WEST PUBLIC ALLEY, 16 FT. WD.  
 IN THE BLOCK BOUND BY  
 W. WARREN, MC DONALD, HOLMES AVE.  
 AND PENNA.-DETROIT TERMINAL R.R.

CITY OF DETROIT  
 CITY ENGINEERING DEPARTMENT  
 SURVEY BUREAU  
 JOB NO. 01-01  
 DRWG. NO. X 1002