

PETITION NO. 1002
 NAGI MOHAMMAD
 6332 TERNES AVE.
 DEARBORN, MICHIGAN 48126
 PHONE NO. 313 715-8522



PENNA.-DETROIT TERMINAL
 RXR 100 FT. WD.

W. WARREN AVE. 100 FT. WD.

MC DONALD AVE. 50 FT. WD.

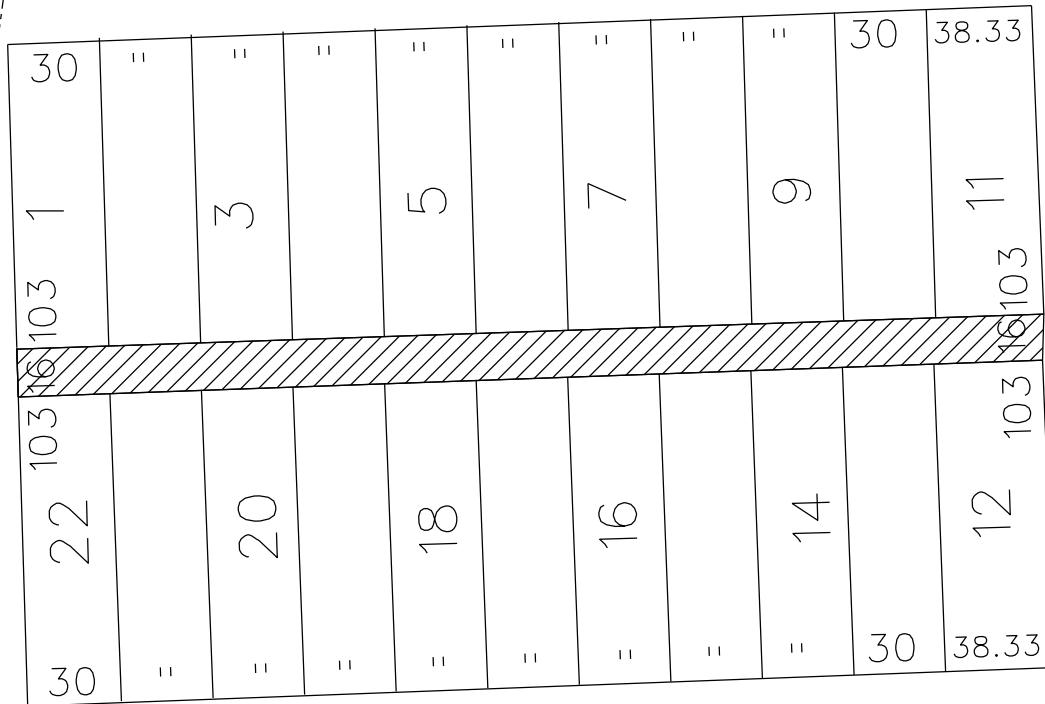

HOLMES AVE. 60 FT. WD.



- REQUESTED CONVERSION TO EASEMENT

(FOR OFFICE USE ONLY)

CARTO 5 B

B						REQUEST TO CONVERT TO EASEMENT THE EAST/WEST PUBLIC ALLEY, 16 FT. WD. IN THE BLOCK BOUND BY W. WARREN, MC DONALD, HOLMES AVE. AND PENNA.-DETROIT TERMINAL R.R.	CITY OF DETROIT CITY ENGINEERING DEPARTMENT SURVEY BUREAU
A							JOB NO. 01-01
DESCRIPTION		DRWN	CHKD	APPD	DATE		DRWG. NO. X 1002
DRAWN BY		CHECKED					
DATE		APPROVED					