

 - PETITIONER

 - PROPERTY OWNER

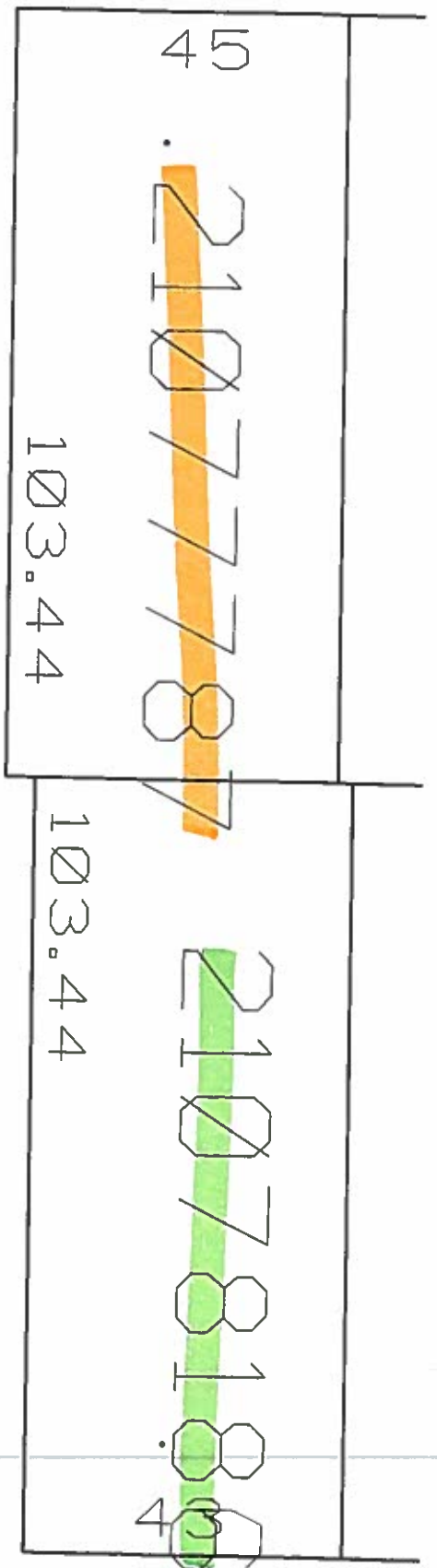
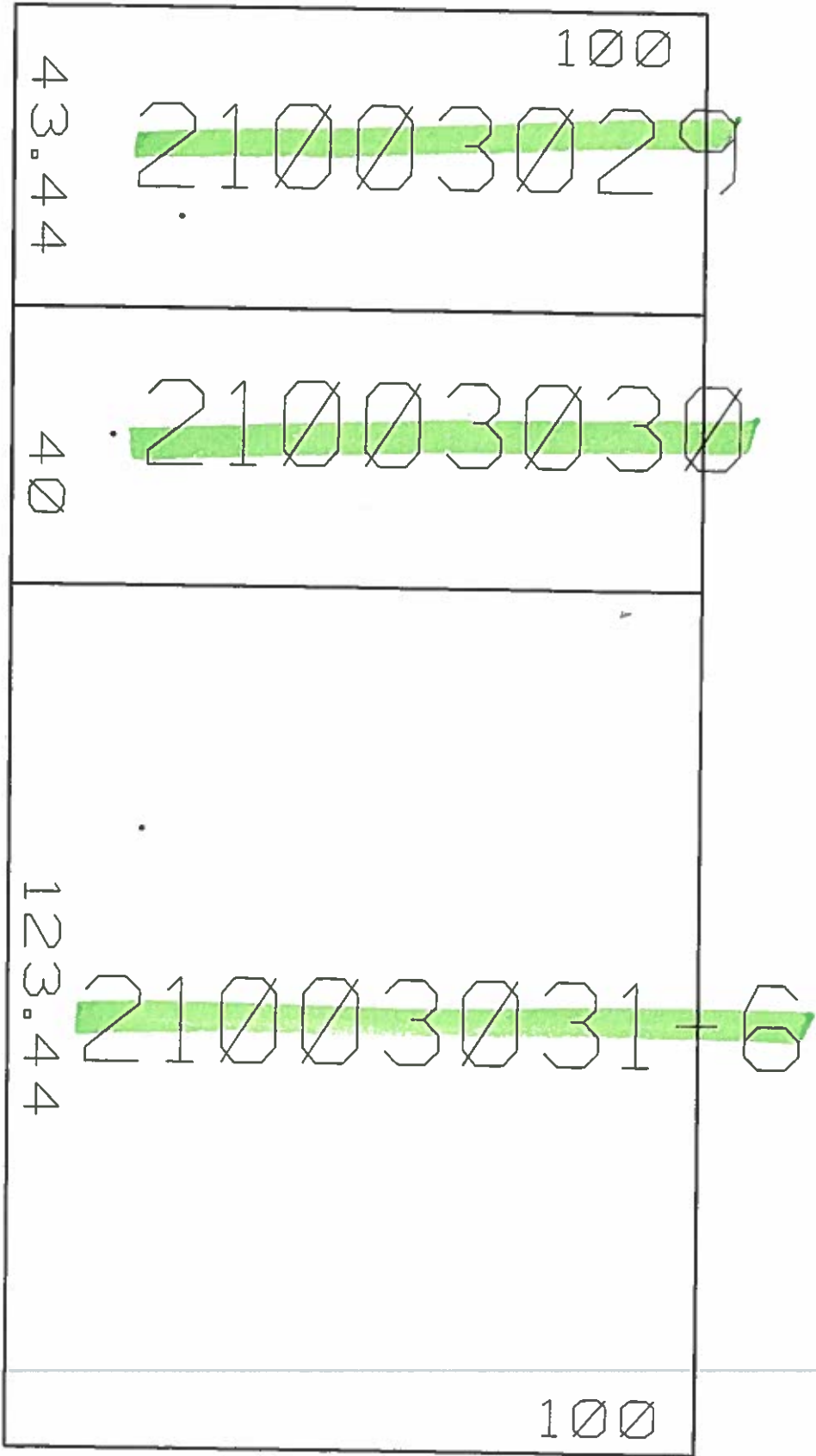

General Property Information

City of Detroit

[\[Back to Non-Printer Friendly Version\]](#) [\[Send To Printer\]](#)

Parcel: 21077787. Unit: CITY OF DETROIT

Flag: CADIEUX MACK - 45

Property Address	[collapse]
5026 LODEWYCK DETROITMI48230	

Owner Information	[collapse]
CRUZ, SALINA ANGELA 5026 LODEWYCK DETROIT, MI 48230	Unit: 01

Taxpayer Information	[collapse]
SEE OWNER INFORMATION	

General Information for Tax Year 2015				[collapse]
Property Class:	401 - 401-RESIDENTIAL	Assessed Value:	\$13,100	
School District:	D - DETROIT PUBLIC SCHOOLS	Taxable Value:	\$13,100	
State Equalized Value:	\$13,100	Map #	21	
DISTRICT	3	Date of Last Name Chg:	05/02/2011	
		Date Filed:	07/19/2011	
		Notes:	N/A	
Historical District:	N/A	Census Block Group:	N/A	
Principal Residence Exemption	June 1st	Final		
		-		
2015	100.0000 %	100.0000 %		
Previous Year Info	MBOR Assessed	Final S.E.V.	Final Taxable	
2014	\$16,793	\$16,793	\$16,793	
2013	\$18,659	\$18,659	\$18,659	

Land Information				[collapse]
	Frontage		Depth	
Lot 1:	45.00 Ft.		103.44 Ft.	
Lot 2:	0.00 Ft.		0.00 Ft.	
Lot 3:	0.00 Ft.		0.00 Ft.	
Total Frontage:	45.00 Ft.	Average Depth:	103.44 Ft.	
Total Acreage:	0.11			
Zoning Code:				
Total Estimated Land Value:	\$1,600	Mortgage Code:		
Land Improvements:	\$4,929	Lot Dimensions/Comments:	N/A	
Renaissance Zone:	NO			

Renaissance Zone Expiration
Date:

Legal Information for 21077787.

[collapse]

E LODEWYCK 154 MARY L HARRIS SUB NO 1 L51 P80 PLATS, W C R 21/851 45 X 103.44

Sales Information

4 sale record(s) found.						
Sale Date	Sale Price	Instrument	Grantor	Grantee	Terms Of Sale	Liber/Page
04/30/2010	\$25,000.00	PTA	JUDSON, JEFFREY A	CRUZ, SALINA ANGELA	NQ	
01/27/2005	\$230,000.00	WD	ALLEMON, PAUL H & MARION E	JUDSON, JEFFREY A	ARMS LENGTH	
01/01/1989	\$21,500.00	WD			ARMS LENGTH	24060:07490
05/01/1970	\$19,000.00	WD			ARMS LENGTH	00085:01670

Building Information

1 building(s) found.			
Description	Floor Area	Yr Built	
Residential Building 1	737 Sq. Ft.	1941	
General Information			
Floor Area:	737 Sq. Ft.	Estimated TCV:	N/A
Garage Area:	400 Sq. Ft.	Basement Area	553 Sq. Ft.
Foundation Size:	737 Sq. Ft.		
Year Built:	1941	Year Remodeled:	0
Occupancy:	Single Family	Class:	C
		Tri-Level?:	NO
Percent Complete:	100%	Heat:	Forced Air w/ Ducts
AC w/Separate Ducts:	NO	Wood Stove Add-on:	NO
Bedrooms:	0	Water:	N/A
Style:	SINGLE FAMILY	Sewer:	N/A
Area Detail - Basic Building Areas			
Height	Foundation	Exterior	Area
1+ Story	Full Bsmnt.	Brick	553 Sq. Ft.
1+ Story	Slab	Brick	184 Sq. Ft.
Area Detail - Overhangs			
Height	Exterior	Area	Included in Size for Rates
Basement Finish			
Recreation:	0 Sq. Ft.	Recreation % Good:	0
Living Area:	0 Sq. Ft.	Living Area % Good:	0
Walk Out Doors:	0	No Concrete Floor Area:	0 Sq. Ft.

Plumbing Information**3-Fixture Baths:** 1**Garage Information****Garage # 1**

Area:	400 Sq. Ft.	Exterior:	Siding
Foundation:	18 Inch	Common Wall:	Detached
Year Built:	1941	Finished?:	NO
Auto Doors:	0	Mech Doors:	0

Porch Information

WCP (1 Story):	177 Sq. Ft.	Foundation:	Standard
-----------------------	-------------	--------------------	----------

****Disclaimer:** BS&A Software provides this Web Site as a way for municipalities to display information online and is not responsible for the content or accuracy of the data herein. This data is provided for reference only and WITHOUT WARRANTY of any kind, expressed or inferred. Please contact your local municipality if you believe there are errors in the data.

[Privacy Policy](#)