



DTE Energy
Data Integrity and Technology, Drafting Department
One Energy Plaza, GO-838, 8TH Floor
City of Detroit, MI 48226

November 21, 2016

Richard Doherty, CED DPW, City Engineer
City of Detroit Engineering Division, DPW
65 Cadillac Square, Suite 900
City of Detroit, MI 48226-2873

RE: Petition #887 Dated: 11/07/16

The proposed change in property referred to would affect our services as follows:

- Not involved, no gas involved, and no objections.
- Involved but withholding action on petition until further notice.
- Involved but have no objection to the property change, provided that an easement of the full width of of the street/alley is reserved as shown. **See Remarks!**
- Involved – nature of services and estimated cost of removing or rerouting such services are:

REMARKS:

Involved but have no objections to the property change, provided that easements the full width of Hartwick Avenue is reserved for utility easements. Reason being is that, DTE Energy has an existing Gas Main Line (4"-CI_10#, and 4"-STL-10#) that runs North and South in Hartwick Avenue. Otherwise, contact DTE Gas Company Public Improvement Department: Michael Fedele at 313-389-7211 (Supervisor) or Laura Forrester at 313-389-7261 (Gas Planner), for the estimated cost of our services in abandoning/removing/ and/or relocating/rerouting, including the survey, design and drawing of our utilities. See enclosed strip prints for your use and information.

Please abide by Public Act 53, three (3) working days before you dig, dial toll free MISS DIG at: 1 – 800 – 482 – 7171.

Michcon Gas Leak Emergency Phone Number: 1- 800 – 947 – 5000.

Sincerely,

/s/ Neal Lauri

Senior Drafter
Data Integrity and Technology

NAL/
Enclosure

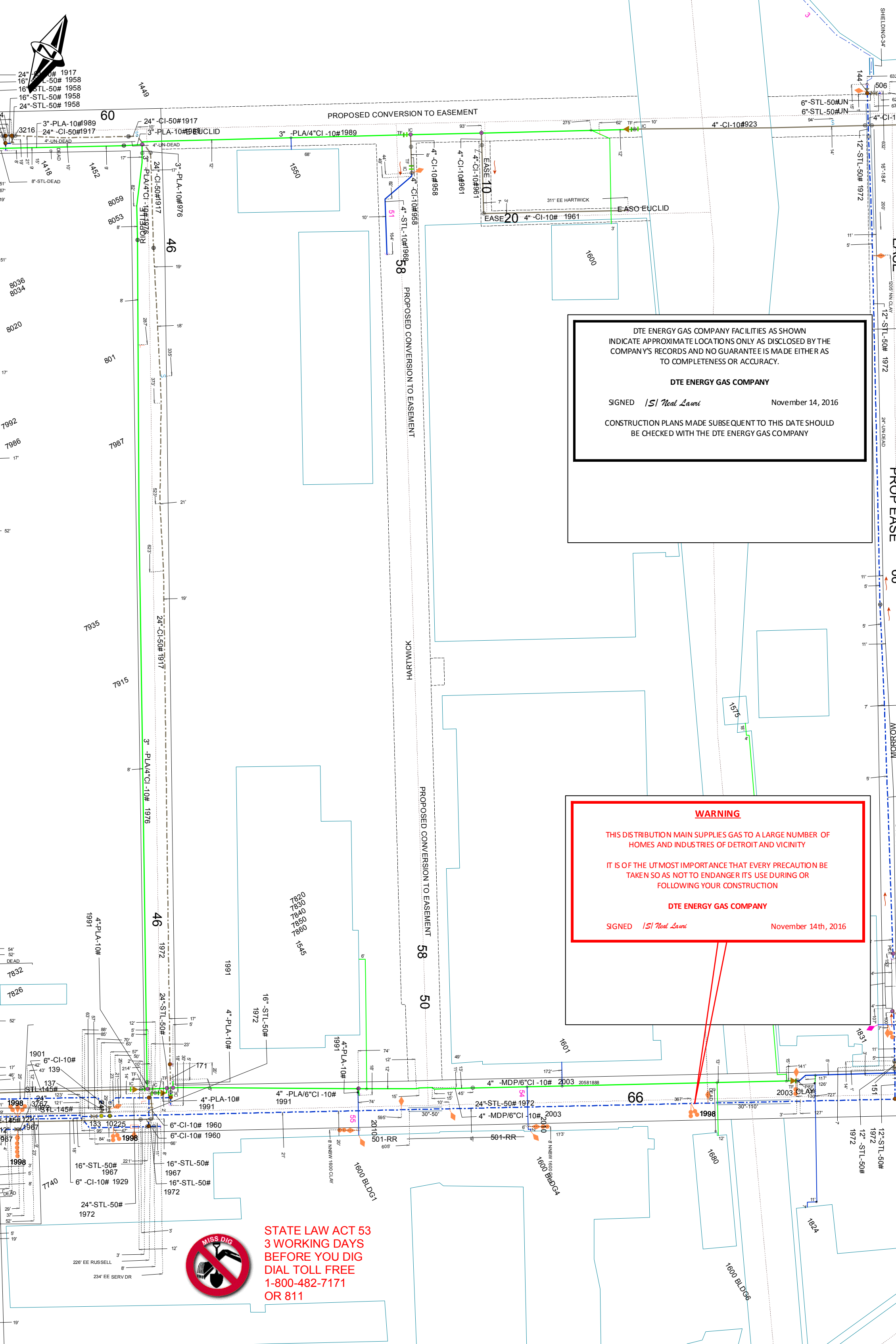
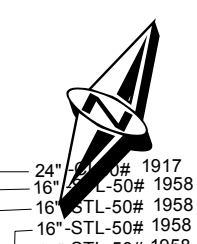

DTE ENERGY GAS COMPANY FACILITIES AS SHOWN INDICATE APPROXIMATE LOCATIONS ONLY AS DISCLOSED BY THE COMPANY'S RECORDS AND NO GUARANTEE IS MADE EITHER AS TO COMPLETENESS OR ACCURACY.

DTE ENERGY GAS COMPANY

SIGNED /S/ Neal Lawri November 14, 2016

CONSTRUCTION PLANS MADE SUBSEQUENT TO THIS DATE SHOULD BE CHECKED WITH THE DTE ENERGY GAS COMPANY

WARNING

THIS DISTRIBUTION MAIN SUPPLIES GAS TO A LARGE NUMBER OF HOMES AND INDUSTRIES OF DETROIT AND VICINITY

IT IS OF THE UT MOST IMPORTANCE THAT EVERY PRECAUTION BE TAKEN SO AS NOT TO ENDANGER ITS USE DURING OR FOLLOWING YOUR CONSTRUCTION

DTE ENERGY GAS COMPANY

SIGNED /S/ Neal Lawri November 14th, 2016



STATE LAW ACT 53
3 WORKING DAYS
BEFORE YOU DIG
DIAL TOLL FREE
1-800-482-7171
OR 811