

City of Detroit
City Engineering Division, Department of Public Works
Survey Bureau

NOTICE OF PROPOSED CHANGE IN PROPERTY

Date: 11/23/2015

Petition: x887

- | | |
|--|--|
| <input type="checkbox"/> AT&T Telecommunication | <input type="checkbox"/> Berm Use |
| <input type="checkbox"/> Comcast Television (CATV) | <input checked="" type="checkbox"/> Conversion to Easement |
| <input type="checkbox"/> Detroit Edison (DTE) | <input type="checkbox"/> Dedication |
| <input type="checkbox"/> Fire Department | <input type="checkbox"/> Encroachment |
| <input type="checkbox"/> Michcon (DTE) | <input type="checkbox"/> Temporary Closing |
| <input type="checkbox"/> Planning & Development Department | <input type="checkbox"/> Vacation |
| <input type="checkbox"/> Public Lighting Authority | |
| <input type="checkbox"/> Public Lighting Department | |
| <input checked="" type="checkbox"/> Police Department | |
| <input type="checkbox"/> Recreation Department | |
| <input type="checkbox"/> Solid Waste Division, DPW | |
| <input type="checkbox"/> Street Design Bureau, DPW | |
| <input type="checkbox"/> Street Maintenance Division, DPW | |
| <input type="checkbox"/> Traffic Engineering Division, DPW | |
| <input type="checkbox"/> Water and Sewerage Department | |
| <input type="checkbox"/> _____ | |

A petition drawing is attached. Property shown on the attached print is proposed to be changed as indicated. Kindly report (using the back of this sheet) the nature of your services, if any affected by the proposed change and the estimated costs of removing and rerouting such services (if necessary).

Please return one copy to City Engineering Division, DPW within two weeks of the submittal date. Retain one copy and print for you file.

Ron Brundidge, Director, Department of Public Works

By: Richard Doherty, CED DPW
City Engineer

TO: City Engineering Division, DPW
2 Woodward Ave., Suite 642
Detroit, Michigan 48226-3462
Survey Bureau: 313-224-3970

Petition: x887

The proposed change in property (referred to on the other side of this sheet) would affect our services as follows:

- Not Involved
- Involved; but asking you to hold action on this petition until further notice.
- Involved; but no objections to the property change.
- Involved; but no objections to the property change...provided as easement of the full width of the public right-of-way (street, alley or other public place) is reserved.
- Involved; the nature of our services and the estimated costs of removing and/or rerouting such services are:

DETROIT POLICE DEPT 3RD PCT.
(Utility or City Department)

CHRIS GIBSON
By

POLICE OFFICER 4449 CIVIL ENGAGEMENT
Title

DEC-8TH 2015
Date

313 596-1302, 596-1310
Area code - Telephone number

PETITION NO. 887
 EUCLID MANUFACTURING
 1500 EUCLID AVE.
 DETROIT, MICHIGAN 48211
 C/O DAWN DAYTON
 PHONE NO. 734 751-6300 EXT. 10274



PHILADELPHIA AVE. 50 FT. WD.

WALTER P. CHRYSLER FREEWAY

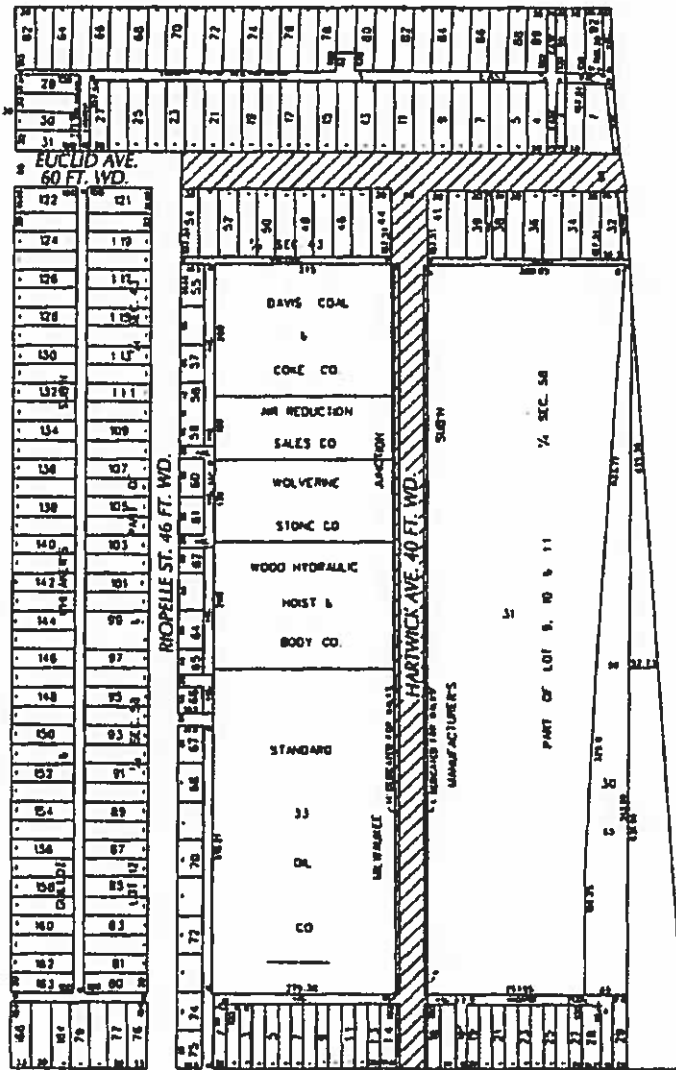

R.R.

TRUNK

GRAND

CLAY ST. 66 FT. WD.



- REQUESTED CONVERSION TO EASEMENT

(FOR OFFICE USE ONLY)

CARTO 41 C

B				
A				
DESCRIPTION	SEEN	CHG	APP	DATE
REVISIONS				
DRAWN BY	WLW	CHECKED		
DATE	11-23-15	APPROVED		

REQUEST TO CONVERT TO EASEMENT
 A PORTION OF E. EUCLID AVE. 60 FT. WD.
 HARDWICK AVE. 40 FT. WD. AND A PORTION
 OF THE EASTWEST PUBLIC ALLEY 18 FT. WD.
 IN THE BLOCK BOUND BY
 CLAY ST., WALTER P. CHRYSLER FWY., PHILADELPHIA AVE.
 AND GRAND TRUNK R.R.

CITY OF DETROIT
 CITY ENGINEERING DEPARTMENT
 SURVEY BUREAU
 JOB NO. 01-01
 DRWG. NO. X 887