

City of Detroit  
**City Engineering Division, Department of Public Works  
Survey Bureau**

**NOTICE OF PROPOSED CHANGE IN PROPERTY**

Date: 11/10/2015

Petition: x883

- |  |  |
|--|--|
| <input type="checkbox"/> AT&T Telecommunication            | <input type="checkbox"/> Berm Use                |
| <input type="checkbox"/> Comcast Television (CATV)         | <input type="checkbox"/> Conversion to Easement  |
| <input type="checkbox"/> Detroit Edison (DTE)              | <input type="checkbox"/> Dedication              |
| <input type="checkbox"/> Fire Department                   | <input checked="" type="checkbox"/> Encroachment |
| <input type="checkbox"/> Michcon (DTE)                     | <input type="checkbox"/> Temporary Closing       |
| <input type="checkbox"/> Planning & Development Department | <input type="checkbox"/> Vacation                |
| <input type="checkbox"/> Public Lighting Authority         |  |
| <input type="checkbox"/> Public Lighting Department        |  |
| <input type="checkbox"/> Police Department                 |  |
| <input type="checkbox"/> Recreation Department             |  |
| <input type="checkbox"/> Solid Waste Division, DPW         |  |
| <input type="checkbox"/> Street Design Bureau, DPW         |  |
| <input type="checkbox"/> Street Maintenance Division, DPW  |  |
| <input type="checkbox"/> Traffic Engineering Division, DPW |  |
| <input type="checkbox"/> Water and Sewerage Department     |  |
| <input type="checkbox"/> _____                             |  |

A petition drawing is attached. Property shown on the attached print is proposed to be changed as indicated. Kindly report (using the back of this sheet) the nature of your services, if any affected by the proposed change and the estimated costs of removing and rerouting such services (if necessary).

Please return one copy to City Engineering Division, DPW within two weeks of the submittal date. Retain one copy and print for you file.

Ron Brundidge, Director, Department of Public Works

By: Richard Doherty, CED DPW  
City Engineer

TO: City Engineering Division, DPW  
2 Woodward Ave., Suite 642  
Detroit, Michigan 48226-3462  
Survey Bureau: 313-224-3970

Petition: x883

The proposed change in property (referred to on the other side of this sheet) would affect our services as follows:

Not Involved

Involved; but asking you to hold action on this petition until further notice.

Involved; but no objections to the property change.

Involved; but no objections to the property change...provided as easement of the full width of the public right-of-way (street, alley or other public place) is reserved.

Involved; the nature of our services and the estimated costs of removing and/or rerouting such services are:

Detroit Police Dept  
(Utility or City Department)

[Signature] S-621

By [Signature]  
Title Sergeant

Date 11-10-15

(313) 596-1110  
Area code - Telephone number

PETITION NO. 883  
 DUCHARME PLACE, LLC.  
 25925 TELEGRAPH RD. SUITE 202  
 SOUTHFIELD, MICHIGAN 48033  
 C/O WALTER COHEN  
 PHONE NO. 248 353-7981

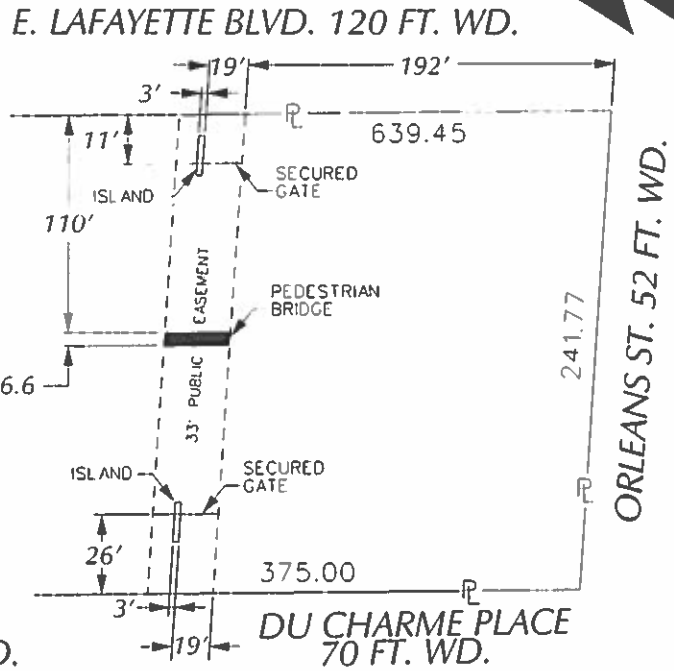

E. LAFAYETTE BLVD. 120 FT. WD.

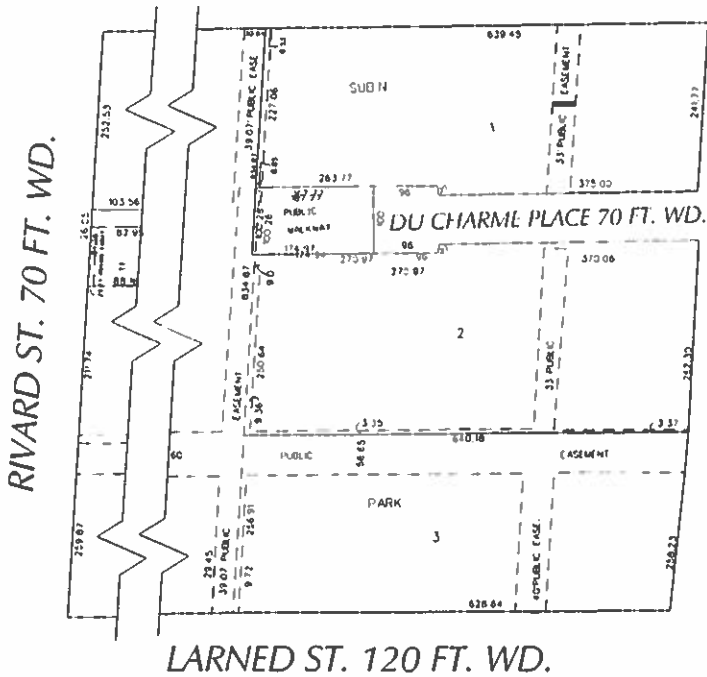

LARNED ST. 120 FT. WD.

 - REQUEST ENCROACHMENT  
 (With Pedestrian Bridge  
 and Secured Gate)

(FOR OFFICE USE ONLY)

CARTO 38 C & D

B					
A					
DESCRIPTION	DRWN	CHLD	APPD	DATE	
REVISIONS					
DRAWN BY	WLW	CHECKED			
DATE	11-10-15	APPROVED			

REQUEST ENCROACHMENT  
 INTO PUBLIC EASEMENT 33 FT. WD.  
 AT 1544 - 1556 E. LAFAYETTE BLVD.  
 (With Pedestrian Bridge and Secured Gate)

CITY OF DETROIT CITY ENGINEERING DEPARTMENT	
SURVEY BUREAU	
JOB NO.	01-01
DRWG. NO.	X 883