

TO: City Engineering Division, DPW  
2 Woodward Ave., Suite 642  
Detroit, MI 48226-3462  
Survey Bureau: 313-224-3970

Ref. No. 201510017  
Petition No. 845

The proposed change in property (referred to above) would affect our services as follows:

- ( ) Not Involved.
- ( ) Involved; but asking you to hold action on this petition until further notice.
- ( ) Involved; the nature of our services, and the estimated costs of removing and/or rerouting such services are:
- (X) Involved; have no objection to the requested encroachment into Plymouth and Evergreen Rd. at various locations (with creative bus shelters) as shown on drawing no. x845 dated 10/16/2015 provided that a minimum 6ft wide clear sidewalk shall be maintained for pedestrian traffic in front of the encroachment at all times.

Traffic Engineering Division - DPW  
(Utility or City Department)

for Ashok Patel   
By

Head Transportation Engineer  
Title

November 20, 2015  
Date

313 224-1610  
Area code-Telephone number

MA/ma

PETITION NO. 845  
 KEITH PARKER  
 DETROIT (C+PAD)  
 C/O COLLEGE OF CREATIVE STUDIES  
 406 W. BALTIMORE AVE. 6TH FLOOR  
 DETROIT, MICHIGAN 48202  
 PHONE NO. 720 291-3559

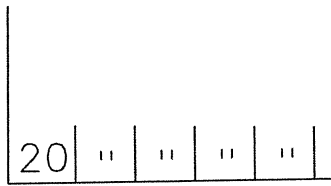
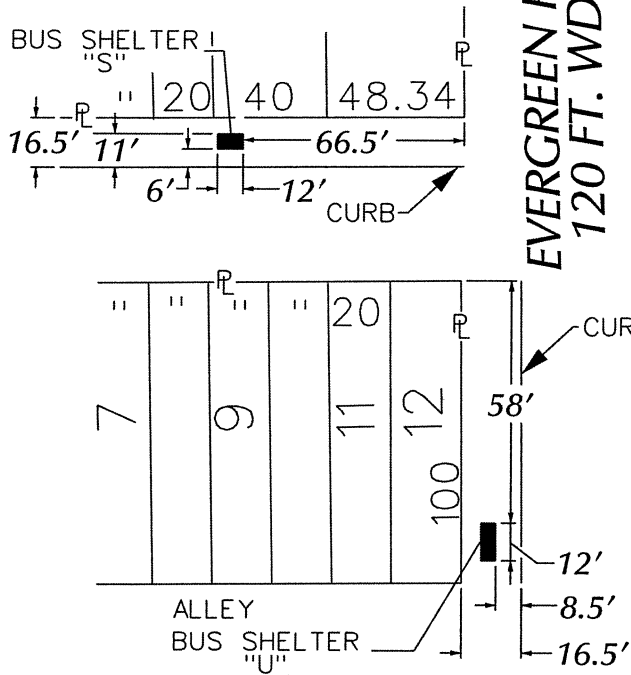

PLYMOUTH RD. 86 FT. WD.

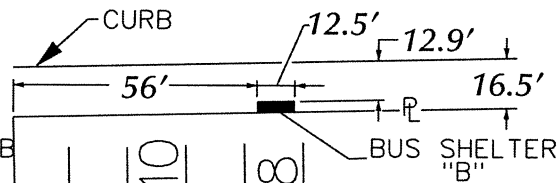

WADSWORTH AVE. 60 FT. WD.

246	148.55	100	501
248	148.60	299	10028
248	148.64	297	
248	148.68	295	
250	148.72	293	
252	148.76	291	
252	148.80	289	
254	148.84	287	
254	148.88	285	
256	148.92	283	
256	148.96	281	
258	149.00	279	
258	149.04	277	
260	149.08	275	
260	149.12	273	
262	149.16	271	
262	149.20	269	
264	149.24	267	
264	149.28	265	
266	149.32	263	
266	149.36	261	
268	149.40	259	
268	149.44	257	
270	149.48	255	
270	149.52	253	
272	149.56	251	
272	149.60	249	
274	149.64	247	
274	149.68	245	
276	149.72	243	
276	149.76	241	
278	149.80	239	
278	149.84	237	
280	149.88	235	
280	149.92	233	
282	149.96	231	
282	150.00	229	
284	150.04	227	
284	150.08	225	
286	150.12	223	
286	150.16	221	
288	150.20	219	
288	150.24	217	
290	150.28	215	
290	150.32	213	
292	150.36	211	
292	150.40	209	
294	150.44	207	
294	150.48	205	
296	150.52	203	
296	150.56	201	
298	150.60	199	
298	150.64	197	
300	150.68	195	
300	150.72	193	
302	150.76	191	
302	150.80	189	
304	150.84	187	
304	150.88	185	
306	150.92	183	
306	150.96	181	
308	151.00	179	
308	151.04	177	
310	151.08	175	
310	151.12	173	
312	151.16	171	
312	151.20	169	
314	151.24	167	
314	151.28	165	
316	151.32	163	
316	151.36	161	
318	151.40	159	
318	151.44	157	
320	151.48	155	
320	151.52	153	
322	151.56	151	
322	151.60	149	
324	151.64	147	
324	151.68	145	
326	151.72	143	
326	151.76	141	
328	151.80	139	
328	151.84	137	
330	151.88	135	
330	151.92	133	
332	151.96	131	
332	152.00	129	
334	152.04	127	
334	152.08	125	
336	152.12	123	
336	152.16	121	
338	152.20	119	
338	152.24	117	
340	152.28	115	
340	152.32	113	
342	152.36	111	
342	152.40	109	
344	152.44	107	
344	152.48	105	
346	152.52	103	
346	152.56	101	
348	152.60	99	
348	152.64	97	
350	152.68	95	
350	152.72	93	
352	152.76	91	
352	152.80	89	
354	152.84	87	
354	152.88	85	
356	152.92	83	
356	152.96	81	
358	153.00	79	
358	153.04	77	
360	153.08	75	
360	153.12	73	
362	153.16	71	
362	153.20	69	
364	153.24	67	
364	153.28	65	
366	153.32	63	
366	153.36	61	
368	153.40	59	
368	153.44	57	
370	153.48	55	
370	153.52	53	
372	153.56	51	
372	153.60	49	
374	153.64	47	
374	153.68	45	
376	153.72	43	
376	153.76	41	
378	153.80	39	
378	153.84	37	
380	153.88	35	
380	153.92	33	
382	153.96	31	
382	154.00	29	
384	154.04	27	
384	154.08	25	
386	154.12	23	
386	154.16	21	
388	154.20	19	
388	154.24	17	
390	154.28	15	
390	154.32	13	
392	154.36	11	
392	154.40	9	
394	154.44	7	
394	154.48	5	
396	154.52	3	
396	154.56	1	
398	154.60		
398	154.64		
400	154.68		
400	154.72		
402	154.76		
402	154.80		
404	154.84		
404	154.88		
406	154.92		
406	154.96		
408	155.00		
408	155.04		
410	155.08		
410	155.12		
412	155.16		
412	155.20		
414	155.24		
414	155.28		
416	155.32		
416	155.36		
418	155.40		
418	155.44		
420	155.48		
420	155.52		
422	155.56		
422	155.60		
424	155.64		
424	155.68		
426	155.72		
426	155.76		
428	155.80		
428	155.84		
430	155.88		
430	155.92		
432	155.96		
432	156.00		
434	156.04		
434	156.08		
436	156.12		
436	156.16		
438	156.20		
438	156.24		
440	156.28		
440	156.32		
442	156.36		
442	156.40		
444	156.44		
444	156.48		
446	156.52		
446	156.56		
448	156.60		
448	156.64		
450	156.68		
450	156.72		
452	156.76		
452	156.80		
454	156.84		
454	156.88		
456	156.92		
456	156.96		
458	157.00		
458	157.04		
460	157.08		
460	157.12		
462	157.16		
462	157.20		
464	157.24		
464	157.28		
466	157.32		
466	157.36		
468	157.40		
468	157.44		
470	157.48		
470	157.52		
472	157.56		
472	157.60		
474	157.64		
474	157.68		
476	157.72		
476	157.76		
478	157.80		
478	157.84		
480	157.88		
480	157.92		
482	157.96		
482	158.00		
484	158.04		
484	158.08		
486	158.12		
486	158.16		
488	158.20		
488	158.24		
490	158.28		
490	158.32		
492	158.36		
492	158.40		
494	158.44		
494	158.48		
496	158.52		
496	158.56		
498	158.60		
498	158.64		
500	158.68		
500	158.72		
502	158.76		
502	158.80		
504	158.84		
504	158.88		
506	158.92		
506	158.96		
508	159.00		
508	159.04		
510	159.08		
510	159.12		
512	159.16		
512	159.20		
514	159.24		
514	159.28		
516	159.32		
516	159.36		
518	159.40		
518	159.44		
520	159.48		
520	159.52		
522	159.56		
522	159.60		
524	159.64		
524	159.68		
526	159.72		
526	159.76		
528	159.80		
528	159.84		
530	159.88		
530	159.92		
532	159.96		
532	160.00		

PLYMOUTH RD. 86 FT. WD.

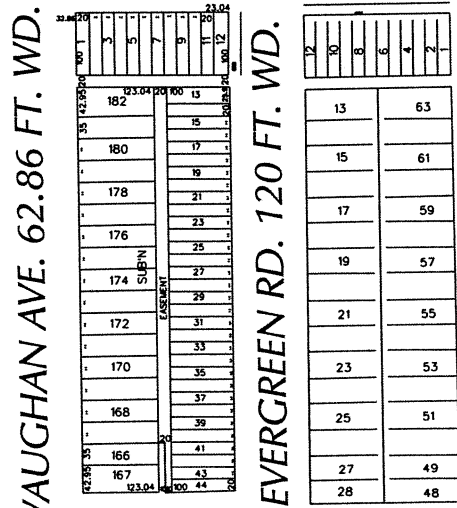

ELMIRA AVE. 60 FT. WD.

■ - REQUEST ENCROACHMENT  
 (With Creative Bus Shelters)

(FOR OFFICE USE ONLY)

CARTO 110 A & B, 111 E & F

B					
A					
DESCRIPTION		DRWN	CHKD	APPD	DATE
REVISIONS					
DRAWN BY	WLW	CHECKED			
DATE	10-16-15	APPROVED			

REQUEST ENCROACHMENT  
 INTO PLYMOUTH AND EVERGREEN RD.  
 AT VARIOUS LOCATIONS  
 (With Creative Bus Shelters)

CITY OF DETROIT CITY ENGINEERING DEPARTMENT SURVEY BUREAU	
JOB NO.	01-01
DRWG. NO.	X 845