

**TO: City Engineering Division, DPW
2 Woodward Ave., Suite 642
Detroit, Michigan 48226-3462
Survey Bureau: 313-224-3970**

Petition: x736

The proposed change in property (referred to on the other side of this sheet) would affect our services as follows:

- Not Involved
- Involved; but asking you to hold action on this petition until further notice.
- Involved; but no objections to the property change.
Within the Lower Woodward Historic District. P&DD Historic staff schedule hearings and provide reports to the HDC. Petitioner must obtain a Certificate of Appropriateness and the outdoor seating and canopy should be included in the scope of the associated project.
- Involved; but no objections to the property change...provided as easement of the full width of the public right-of-way (street, alley or other public place) is reserved.
- Involved; the nature of our services and the estimated costs of removing and/or rerouting such services are:

Planning & Development Department

(Utility or City Department)

By

Greg Moots-Lead Planner-Office of Zoning Innovation

Title

9/9/2016
Date

313-224-1358

Area code – Telephone number

"REVISED"

City of Detroit

**City Engineering Division, Department of Public Works
Survey Bureau**

5th Notice 9/8/16

4th Notice 8/9/16

3rd Notice 7/6/16

2nd Notice 4/16/16

NOTICE OF PROPOSED CHANGE IN PROPERTY

Date: 08/18/2015

Petition: x736

- | | |
|---|--|
| <input type="checkbox"/> AT&T Telecommunication | <input type="checkbox"/> Berm Use |
| <input type="checkbox"/> Comcast Television (CATV) | <input type="checkbox"/> Conversion to Easement |
| <input type="checkbox"/> Detroit Edison (DTE) | <input type="checkbox"/> Dedication |
| <input type="checkbox"/> Fire Department | <input checked="" type="checkbox"/> Encroachment |
| <input type="checkbox"/> Michcon (DTE) | <input type="checkbox"/> Temporary Closing |
| <input checked="" type="checkbox"/> Planning & Development Department | <input type="checkbox"/> Vacation |
| <input type="checkbox"/> Public Lighting Authority | |
| <input type="checkbox"/> Public Lighting Department | |
| <input type="checkbox"/> Police Department | |
| <input type="checkbox"/> Recreation Department | |
| <input type="checkbox"/> Solid Waste Division, DPW | |
| <input type="checkbox"/> Street Design Bureau, DPW | |
| <input type="checkbox"/> Street Maintenance Division, DPW | |
| <input type="checkbox"/> Traffic Engineering Division, DPW | |
| <input type="checkbox"/> Water and Sewerage Department | |
| <input type="checkbox"/> _____ | |

A petition drawing is attached. Property shown on the attached print is proposed to be changed as indicated. Kindly report (using the back of this sheet) the nature of your services, if any affected by the proposed change and the estimated costs of removing and rerouting such services (if necessary).

Please return one copy to City Engineering Division, DPW within two weeks of the submittal date. Retain one copy and print for you file.

Ron Brundidge, Director, Department of Public Works

By: Richard Doherty, CED DPW
City Engineer

PETITION NO. 736
 BEDROCK REAL ESTATE SERVICES
 1092 WOODWARD AVE.
 DETROIT, MICHIGAN 48226
 C/O SCOTT R. COLLINS
 PHONE NO. 313 373-8700



GRAND RIVER AVE. 60 FT. WD.

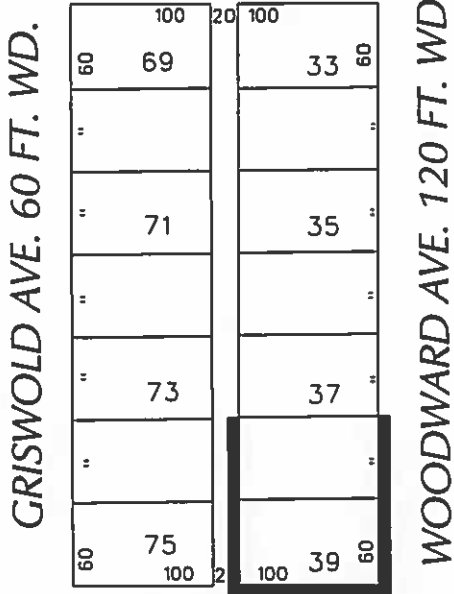

"REVISED"

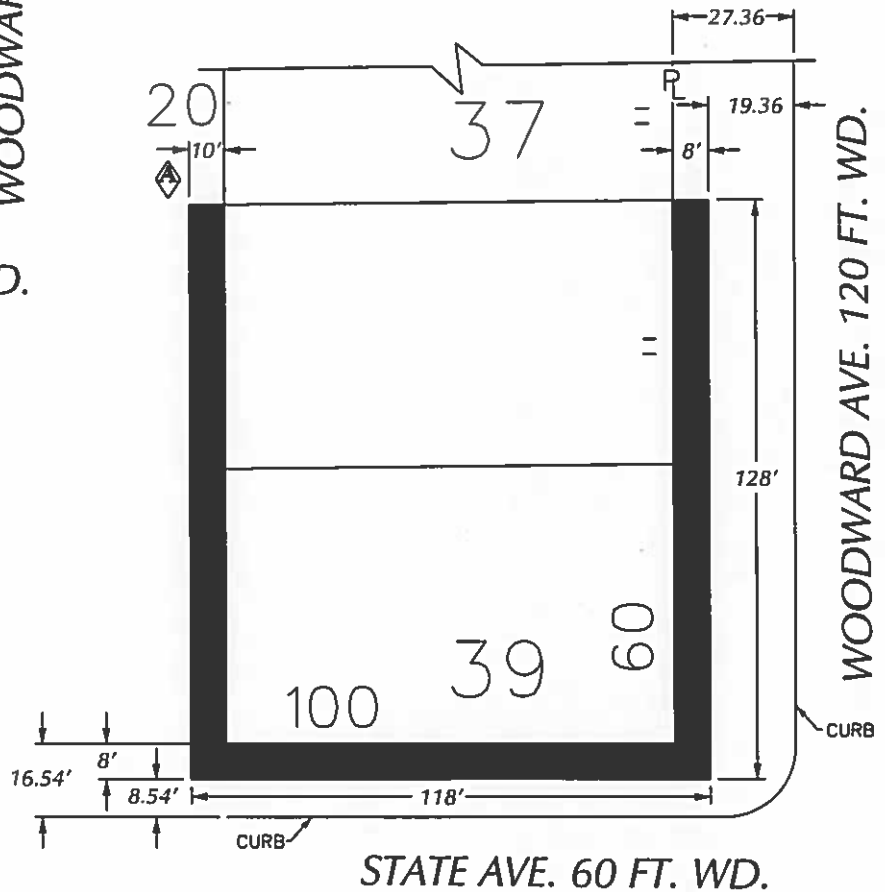

STATE AVE. 60 FT. WD.

STATE AVE. 60 FT. WD.

■ - REQUEST ENCROACHMENT
 (With Outdoor Seating,
 Storefront Canopy and Egress)

(FOR OFFICE USE ONLY)

CARTO 28 B

B						REQUEST ENCROACHMENT INTO WOODWARD AT 1201-1217 WOODWARD (With Outdoor Seating, Storefront Canopy) AND A PORTION OF THE NORTH/SOUTH PUBLIC ALLEY (Egress)	CITY OF DETROIT CITY ENGINEERING DEPARTMENT SURVEY BUREAU	
A	REVISED CHANGE DIMENSIONS FROM #	WLW	KSM	KSM	3/14/16		JOB NO. 01-01	
DESCRIPTION		DRWN	CHEK	APPR	DATE		DRWG. NO. X 736	
DRAWN BY		CHECKED						
DATE		APPROVED						

