

TO: City Engineering Division, DPW
900 Cadillac Tower Building
65 Cadillac Square
Detroit, Michigan 48226-2873
Survey Bureau: 313-224-3970
Fax: 313-224-3471

Ref. No. 201507003
Petition No. 709

The proposed change in property (referred to above) would affect our services as follows:

- Not Involved.
- Involved; but asking you to hold action on this petition until further notice.
- Involved; the nature of our services, and the estimated costs of removing and/or rerouting such services are:
- Involved; have no objection to the requested encroachment (with garbage bin/flower planter) into Cass at 1942 Grand River as shown on drawing no. x709 dated 06/24/2015 provided that a minimum unobstructed sidewalk width of 7'3" shall be maintained for pedestrian use at all times.

Traffic Engineering Division - DPW
(Utility or City Department)

for Ashok Patel
By



Head Transportation Engineer
Title

July 16, 2015
Date

313 224-1610
Area code-Telephone number

MA/JL

PETITION NO. 709
 REPUBLIC TAVERN & NEW GAR, LLC
 1942 GRAND RIVER AVE.
 DETROIT, MICHIGAN 48226
 C/O TOM CARLETON
 PHONE NO. 313 674-0280

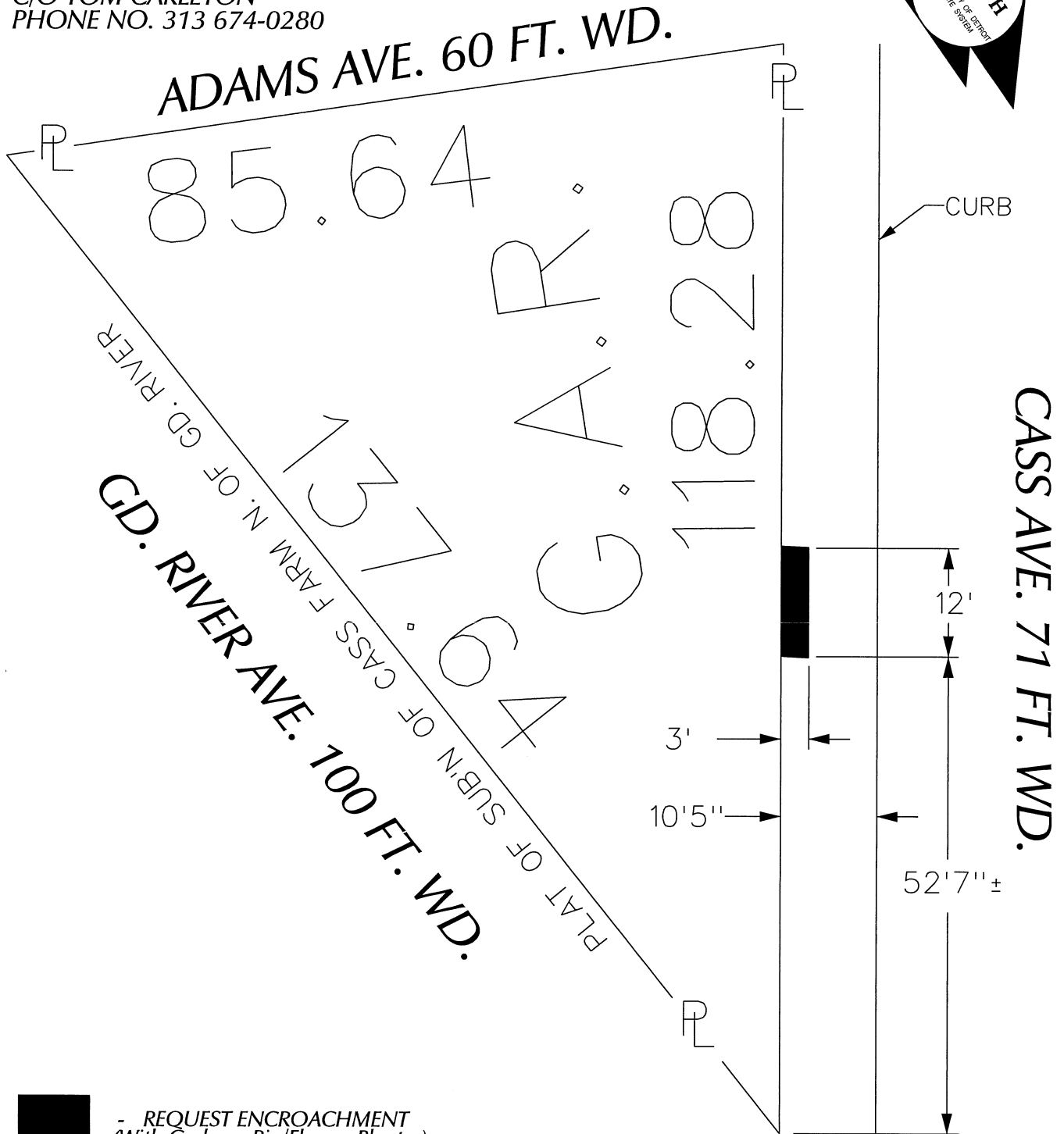

 - REQUEST ENCROACHMENT
 (With Garbage Bin/Flower Planter)

(FOR OFFICE USE ONLY)

CARTO 28 B

B					
A					
DESCRIPTION	DRWN	CHKD	APPD	DATE	
REVISIONS					
DRAWN BY	WLW	CHECKED			
DATE	06-24-15	APPROVED			

REQUEST ENCROACHMENT
 (With Garbage Bin/Flower Planter)
INTO CASS
AT 1942 GRAND RIVER

CITY OF DETROIT	
CITY ENGINEERING DEPARTMENT	
SURVEY BUREAU	
JOB NO.	01-01
DRWG. NO.	X 709

Sent to:
Walter Williams
WilliamsWL@detroitmi.gov
6-15-15

G.A.R. BUILDING Garbage Bin / Planter CASS AVE.

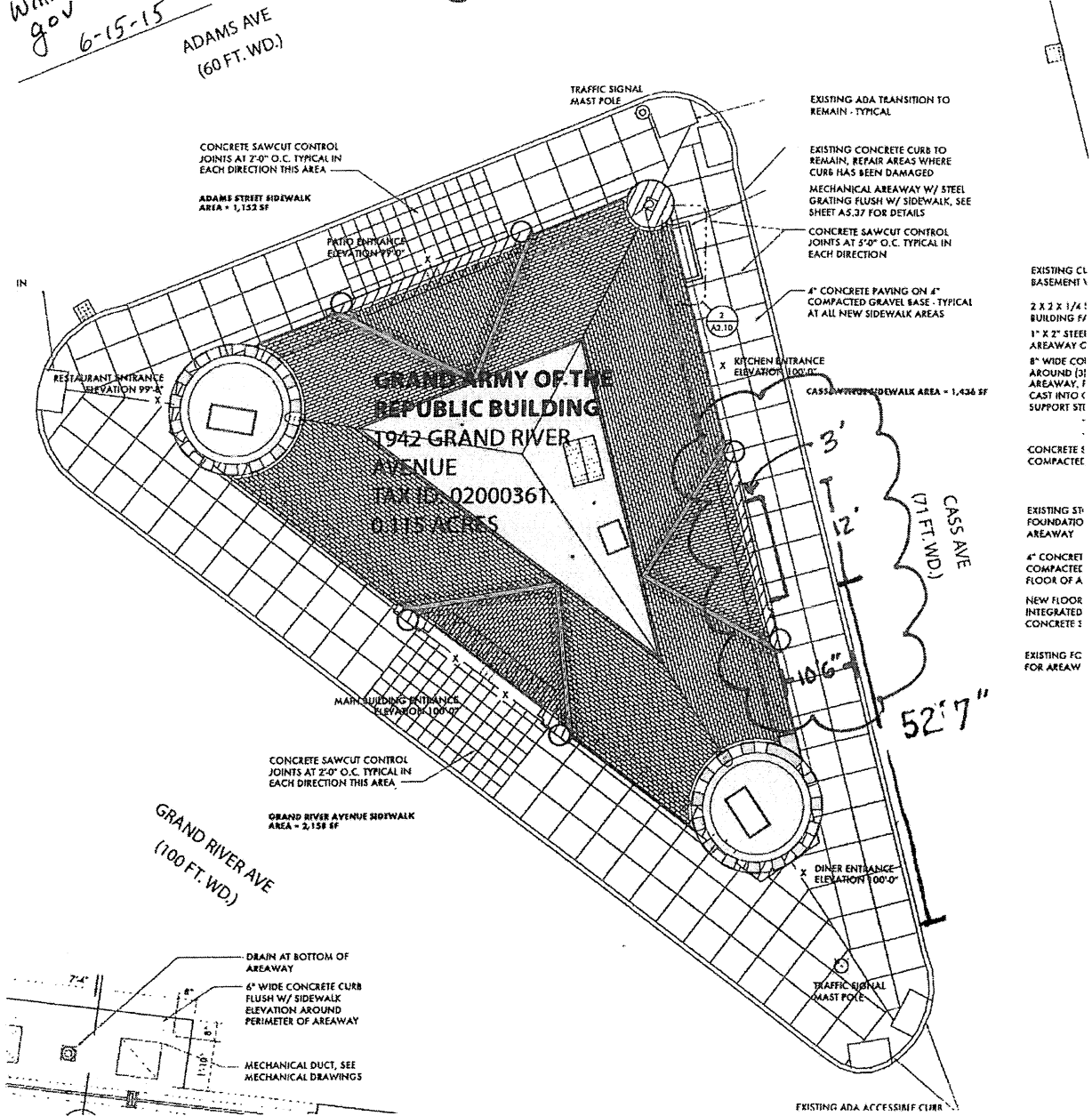

PETITION NO. 709
 REPUBLIC TAVERN & NEW GAR, LLC
 1942 GRAND RIVER AVE.
 DETROIT, MICHIGAN 48226
 C/O TOM CARLETON
 PHONE NO. 313 674-0280

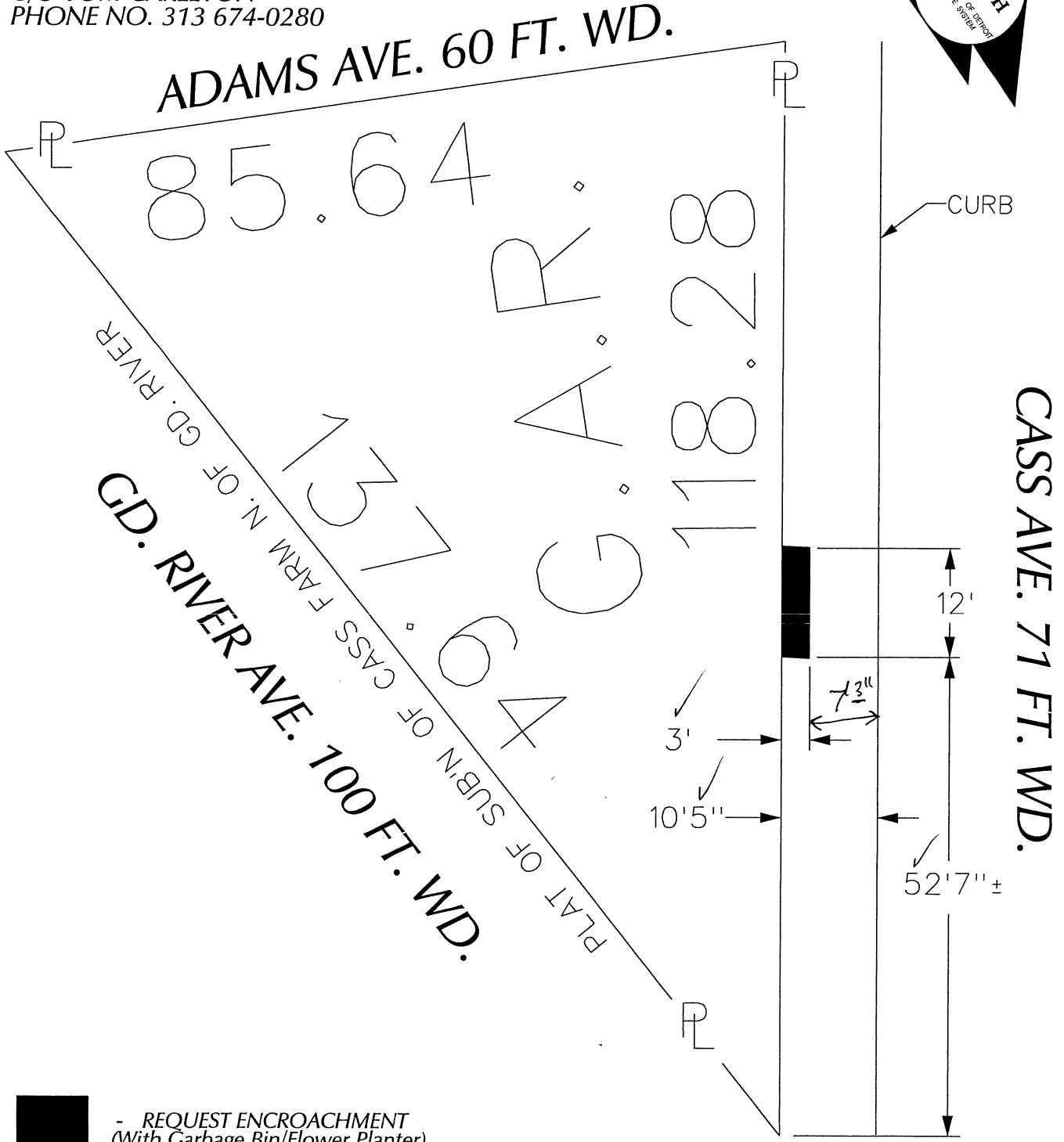

 - REQUEST ENCROACHMENT
 (With Garbage Bin/Flower Planter)

(FOR OFFICE USE ONLY)

CARTO 28 B

B					
A					
DESCRIPTION	DRWN	CHKD	APPD	DATE	
REVISIONS					
DRAWN BY	WLW	CHECKED			
DATE	06-24-15	APPROVED			

REQUEST ENCROACHMENT
 (With Garbage Bin/Flower Planter)
 INTO CASS
 AT 1942 GRAND RIVER

CITY OF DETROIT
 CITY ENGINEERING DEPARTMENT
 SURVEY BUREAU

JOB NO. 01-01
 DRWG. NO. X 709