

Walter Williams - RE: Starbucks #25844_Greektown Casino Hotel - City Council Petition Request #581

From: Seth Dorman <Seth.Dorman@WDPartners.com>
To: Walter Williams <williamswl@detroitmi.gov>
Date: 3/31/2015 9:53 AM
Subject: RE: Starbucks #25844_Greektown Casino Hotel - City Council Petition Request #581

Good catch Walter! I meant to say "...65.395' or 65.40' rounded up". Sorry about the typo!

Seth

Seth Dorman

Permitting & Planning Specialist

7007 Discovery Blvd, Dublin, OH 43017 USA

D [+1 614 634 7243](tel:+16146347243) | M [+1 614 264 3670](tel:+16142643670)

wd

wdpartners.com

What's next from WD

This transmission may contain information that is proprietary, confidential, and/or privileged and is intended only for the person or entity to which it is addressed. If you are not the intended recipient, you are hereby notified that any review, disclosure, copying, distribution, or use of the information contained herein is STRICTLY PROHIBITED. If you received this transmission in error, do not read it. Please immediately contact the sender and destroy the material in its entirety, whether in electronic or hard copy format, including attachments, and delete the material from any computer.

From: Walter Williams [williamswl@detroitmi.gov]

Sent: Tuesday, March 31, 2015 9:48 AM

To: Seth Dorman

Subject: RE: Starbucks #25844_Greektown Casino Hotel - City Council Petition Request #581

Is it 65.40' or 69.40'?

Thanks Seth.

Sincerely

Walter L. Williams

Sr. GIS Support Technician

Survey Bureau

City Engineering Division

Department of Public Works

[313-224-3970](tel:313-224-3970)

williamswl@detroitmi.gov

Mike Duggan, Mayor

>>> Seth Dorman <Seth.Dorman@WDPartners.com> 3/31/2015 9:31 AM >>>

Walter,

What I came up with is 65.395' or 69.40' when rounded up.

Please let me know if you need anything else!

Seth

Seth Dorman

Permitting & Planning Specialist

7007 Discovery Blvd, Dublin, OH 43017 USA

D [+1 614 634 7243](tel:+16146347243) | M [+1 614 264 3670](tel:+16142643670)

wd

wdpartners.com

[What's next from WD](#)

This transmission may contain information that is proprietary, confidential, and/or privileged and is intended only for the person or entity to which it is addressed. If you are not the intended recipient, you are hereby notified that any review, disclosure, copying, distribution, or use of the information contained herein is STRICTLY PROHIBITED. If you received this transmission in error, do not read it. Please immediately contact the sender and destroy the material in its entirety, whether in electronic or hard copy format, including attachments, and delete the material from any computer.

From: Walter Williams [<mailto:williamswl@detroitmi.gov>]

Sent: Tuesday, March 31, 2015 9:19 AM

To: Seth Dorman

Subject: RE: Starbucks #25844_Greektown Casino Hotel - City Council Petition Request #581

Good morning Seth:

Per our conversation, this is what was calculated: $65'-4\ 3/4" = 65.46'$. Can you please confirm?

Sincerely

Walter L. Williams
 Sr. GIS Support Technician
 Survey Bureau
 City Engineering Division
 Department of Public Works
[313-224-3970](tel:313-224-3970)
williamswl@detroitmi.gov

Mike Duggan, Mayor

>>> Seth Dorman <Seth.Dorman@WDPartners.com> 3/30/2015 10:21 AM >>>

Good morning Walter!

The dimension you requested, with the information that we have, comes out to 65'-4 ¾" .

Please let me know if you need anything else to complete your exhibit. What are the next steps in this process? Once Utilities reviews your exhibit; does it go on to Council for their consideration?

Thanks,

Seth

Seth Dorman

Permitting & Planning Specialist
 7007 Discovery Blvd, Dublin, OH 43017 USA
 D [+1 614 634 7243](tel:+16146347243) | M [+1 614 264 3670](tel:+16142643670)

wd

wdpartners.com

[What's next from WD](#)

This transmission may contain information that is proprietary, confidential, and/or privileged and is intended only for the person or entity to which it is addressed. If you are not the intended recipient, you are hereby notified that any review, disclosure, copying, distribution, or use of the information contained herein is STRICTLY PROHIBITED. If you received this transmission in error, do not read it. Please immediately contact the sender and destroy the material in its entirety, whether in electronic or hard copy format, including attachments, and delete the material from any computer.

From: Walter Williams [<mailto:williamswl@detroitmi.gov>]

Sent: Monday, March 30, 2015 10:08 AM

To: Seth Dorman

Subject: RE: Starbucks #25844_Greektown Casino Hotel - City Council Petition Request #581

Hello Seth:

I need one more thing. Attached is a copy of the Petition drawing that I will submit to the various Utilities. Can you give me the dimension of the question mark on the dimension drawing? If you have any questions, please let me know.

Sincerely

Walter L. Williams
Sr. GIS Support Technician
Survey Bureau
City Engineering Division
Department of Public Works
[313-224-3970](tel:313-224-3970)
williamswl@detroitmi.gov

Mike Duggan, Mayor

>>> Seth Dorman <Seth.Dorman@WDPartners.com> 3/25/2015 1:11 PM >>>

Walter,

Attached is the revised exhibit to show the dimension of the building width from the column nearest the covered valet entrance and the corner of the building at St. Antoine & Monroe. I hope this additional information provides you what you need to complete your evaluation of the proposed stairway and exterior entrance to Starbucks on St. Antoine! Please let me know if you have any questions or need anything else.

Sincerely,

Seth Dorman
Permitting & Planning Specialist
7007 Discovery Blvd, Dublin, OH 43017 USA
D [+1 614 634 7243](tel:+16146347243) | M [+1 614 264 3670](tel:+16142643670)

wd

wdpartners.com

[What's next from WD](#)

This transmission may contain information that is proprietary, confidential, and/or privileged and is intended only for the person or entity to which it is addressed. If you are not the intended recipient, you are hereby notified that any review, disclosure, copying, distribution, or use of the information contained herein is STRICTLY PROHIBITED. If you received this transmission in error, do not read it. Please immediately contact the sender and destroy the material in its entirety, whether in electronic or hard copy format, including attachments, and delete the material from any computer.

From: Seth Dorman
Sent: Monday, March 16, 2015 2:56 PM
To: 'Walter Williams'
Subject: Starbucks #25844_Greektown Casino Hotel - City Council Petition Request #581

Walter,

Attached please find the following revision to the exhibits that we submitted with our City Council Petition Request for the proposed Starbucks at Greektown Casio Hotel.

Page 1: This is an exhibit showing the approximate parcels that are occupied by the Greektown Casino Hotel. The remaining parcels in the block out to Chrysler Service Drive are occupied by the Hotel/Casino's parking structure.

Page 2: This is the revised site plan exhibit providing the additional dimensions you requested, including:

- (1) The distance from the corner of the hotel building (at Monroe & St. Antoine) to the curb; and
- (2) The distance from the rear corner of the proposed stairway to the curb of the first entrance into the covered valet area.

Page 3: This is the elevation of the first floor of the hotel showing the proposed stairway. My project lead has now added a dark line indicating the grade of the lobby, showing how the existing sidewalk is lower than the existing grade of the lobby area.

I hope this additional information provides you what you need to complete your evaluation of the proposed stairway and exterior entrance to Starbucks on St. Antoine! Please let me know if you have any questions or need anything else.

Sincerely,

From: Walter Williams [<mailto:williamswl@detroitmi.gov>]

Sent: Wednesday, March 04, 2015 9:53 AM

To: Seth Dorman

Subject: Microstation Drawing - Starbucks

Good morning Seth:

Per our conversation this morning, attached is the Microstation dgn. file. If you have any further questions, please let me know.

Sincerely

Walter L. Williams
Sr. GIS Support Technician
Survey Bureau
City Engineering Division
Department of Public Works
[313-224-3970](tel:313-224-3970)
williamswl@detroitmi.gov

Mike Duggan, Mayor

PETITION NO. 581
 WD PARTNERS
 7007 DISCOVERY BLVD.
 DUBLIN, OHIO 43017
 C/O SETH DORMAN
 PHONE NO. 614 634-7000



ST. ANTOINE ST. 50 FT. WD.

MACOMB AVE. 50 FT. WD.

50	"	"	50	53	"	"	"	"	53	57.96
105.25	4	FARM	2	7	105.25	105.25	7	5	3	7
20	VACATED								20	105.25
105.25	4	"	2	7	105.25	45.07	"	5	"	65.06
50	"	"	50	53	"	"	"	"	53	57.54
										105.25
										20

CHRYSLER FWY.

MONROE AVE. 50 FT. WD.

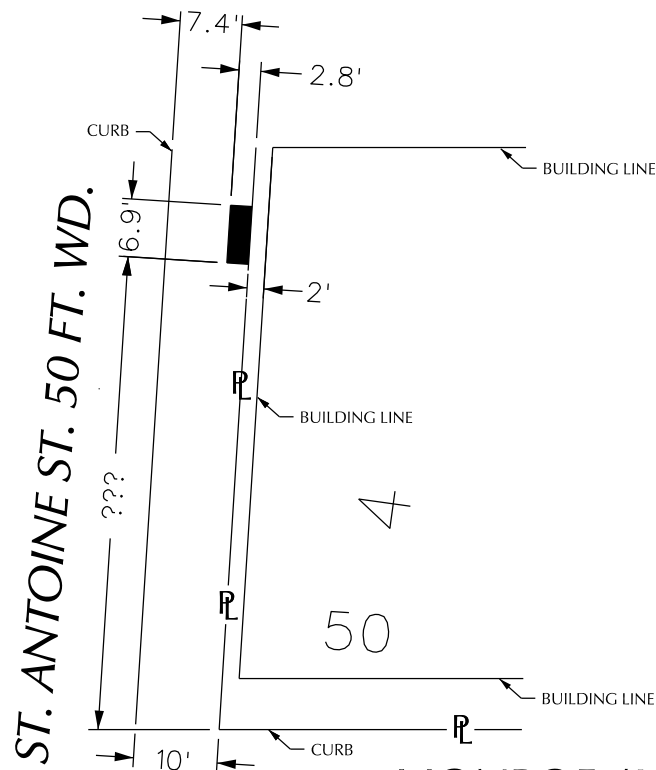

 - REQUEST ENCROACHMENT
 (With Permanent Stairwell)

MONROE AVE. 50 FT. WD.

(FOR OFFICE USE ONLY)

CARTO 28 A

B					
A					
DESCRIPTION	DRWN	CHKD	APPD	DATE	
REVISIONS					
DRAWN BY	WLW	CHECKED			
DATE	03-27-15	APPROVED			

REQUEST ENCROACHMENT
 INTO ST. ANTOINE
 AT 1200 ST. ANTOINE
 (With Permanent Stairwell)

CITY OF DETROIT
 CITY ENGINEERING DEPARTMENT
 SURVEY BUREAU

JOB NO. 01-01

DRWG. NO. X 581