

"REVISED"

City of Detroit  
**City Engineering Division, Department of Public Works  
Survey Bureau**

**NOTICE OF PROPOSED CHANGE IN PROPERTY** Second Notice 4/7/15

Date: 02/11/2015

Petition: x542

- |   |  |
|---|--|
| <input type="checkbox"/> AT&T Telecommunication                         |  |
| <input type="checkbox"/> Cable Television (CATV)                        | <input type="checkbox"/> Vacation                |
| <input type="checkbox"/> Detroit Edison (DTE)                           |  |
| <input type="checkbox"/> Michigan Consolidated Gas (DTE)                | <input type="checkbox"/> Conversion to Easement  |
| <input type="checkbox"/> Fire Department                                | <input type="checkbox"/> Dedication              |
| <input type="checkbox"/> Planning & Development Department              |  |
| <input type="checkbox"/> Public Lighting Authority                      | <input checked="" type="checkbox"/> Encroachment |
| <input type="checkbox"/> Public Lighting Dept. - Communication Division |  |
| <input type="checkbox"/> Public Lighting Dept. - Overhead Line Division |  |
| <input type="checkbox"/> Public Lighting Dept. - Underground Division   | <input type="checkbox"/> Temporary Closing       |
| <input type="checkbox"/> Police Department                              |  |
| <input type="checkbox"/> Recreation Department                          | <input type="checkbox"/> Berm Use                |
| <input type="checkbox"/> Sanitation Division, DPW                       |  |
| <input type="checkbox"/> Street Design Bureau, DPW                      |  |
| <input checked="" type="checkbox"/> Street Maintenance Division, DPW    |  |
| <input type="checkbox"/> Street and Traffic Division, DPW               |  |
| <input type="checkbox"/> Water and Sewerage Dept. - Sewer Design        |  |
| <input type="checkbox"/> Water and Sewerage Dept. - Water Design        |  |

A petition drawing is attached. Property shown on the attached print is proposed to be changed as indicated.

Kindly report (using the back of this sheet) the nature of your services If any) affected by the proposed change and the estimated costs of removing and rerouting such services (if necessary).

Please return one copy to City Engineering Division, DPW. Retain one copy and print for you file.

Ron Brundidge, Director, Department of Public Works

By: Richard Doherty, CED DPW  
City Engineer

**TO: City Engineering Division, DPW  
65 Cadillac Square, Suite 900  
Detroit, Michigan 48226-2873  
Survey Bureau: 313-224-3970**

x542

The proposed change in property (referred to on the other side of this sheet) would affect our services as follows:

- Not Involved
- Involved; but asking you to hold action on this petition until further notice.
- Involved; but no objections to the property change.
- Involved; but no objections to the property change...provided as easement of the full width of the public right-of-way (street, alley or other public place) is reserved.
- Involved; the nature of our services and the estimated costs of removing and/or rerouting such services are:

**DPW / Street Maintenance Division**

(Utility or City Department)

**Dhaval Patel**

By

**Supervisor**

Title

**4/7/2015**

Date

**313-224.0021**

Area code – Telephone number

PETITION NO. 542  
 GIFFELS WEBSTER  
 28 W. ADAMS, SUITE 1200  
 DETROIT, MICHIGAN 48226  
 C/O JAMES FOSTER  
 PHONE NO. 313 962-4442

**"REVISED"**



**GRAND RIVER AVE. 60 FT. WD.**

**LIBRARY AVE. 71 FT. WD.**

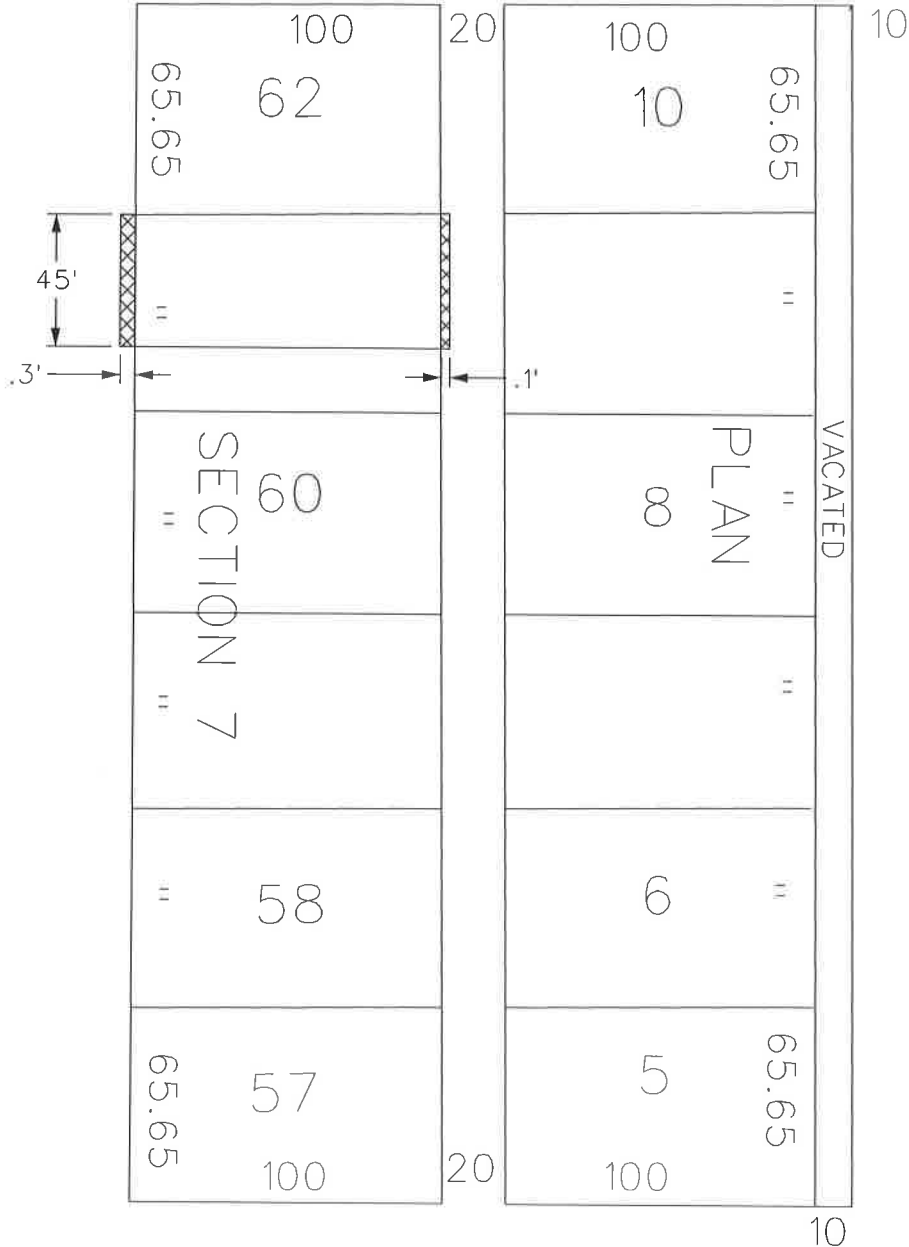

**BROADWAY AVE. 100 FT. WD.**

**GRATIOT AVE. 60 FT. WD.**

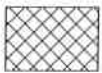

- REQUEST ENCROACHMENT  
 (With Facade Improvements)

(FOR OFFICE USE ONLY)

CARTO 28 A

<b>B</b>					
<b>A</b>	REVISED - CHANGE FROM VACATION TO ENCROACHMENT	WLW	KSM	KSM	02/11/15
DESCRIPTION		DRWN	CHKD	APPD	DATE
REVISIONS					
DRAWN BY		CHECKED			
DATE		APPROVED			
02-06-15					

REQUEST ENCROACHMENT  
 A PORTION OF 1260 LIBRARY ST.  
 AND A PORTION OF THE NORTH/SOUTH PUBLIC ALLEY  
 (With Facade Improvements)  
 BETWEEN E. GRAND RIVER  
 AND GRATIOT AVE.

CITY OF DETROIT	
CITY ENGINEERING DEPARTMENT	
SURVEY BUREAU	
JOB NO.	01-01
DRWG. NO.	X 542