



City of Detroit
Inter-Departmental Communication

TO: Richard Doherty, City Engineer
City Engineering/Department of Public Works

FROM: Debra Singleton, Manager II
Detroit Water and Sewerage Department

DATE: March 20, 2015

RE: Petition No. 542
Requested Encroachment into Library at 1260 Library and also a Portion of the
North/South Alley at the Same Location Bound by Gratiot, Broadway, Grand
River, and Library

We have reviewed the above Petition received by this office on February 11, 2015. With regard to DWSD's interests, our comment is as follows:

- Our records indicate that there are water mains and sewers in the areas of encroachments. DWSD has no objections to the requested encroachment provided that the attached Provisions for Encroachment are strictly followed.

If you have any questions, please call me at (313) 267-8309.

Sincerely,

A handwritten signature in black ink, appearing to read "D. Singleton".

Debra Singleton
Manager II
Claims and Permits

DS//gl
Attachments

CC: Cheryl Porter, WBB
Mohamad Farhat, CSF

Michael Duggan, Mayor

"REVISED"

City of Detroit
City Engineering Division, Department of Public Works
Survey Bureau

NOTICE OF PROPOSED CHANGE IN PROPERTY

Date: 02/11/2015

Petition: x542

- | | |
|---|--|
| <input type="checkbox"/> AT&T Telecommunication | |
| <input type="checkbox"/> Cable Television (CATV) | <input type="checkbox"/> Vacation |
| <input type="checkbox"/> Detroit Edison (DTE) | |
| <input type="checkbox"/> Michigan Consolidated Gas (DTE) | <input type="checkbox"/> Conversion to Easement |
| <input type="checkbox"/> Fire Department | <input type="checkbox"/> Dedication |
| <input type="checkbox"/> Planning & Development Department | |
| <input type="checkbox"/> Public Lighting Authority | <input checked="" type="checkbox"/> Encroachment |
| <input type="checkbox"/> Public Lighting Dept. - Communication Division | |
| <input type="checkbox"/> Public Lighting Dept. - Overhead Line Division | |
| <input type="checkbox"/> Public Lighting Dept. - Underground Division | <input type="checkbox"/> Temporary Closing |
| <input type="checkbox"/> Police Department | |
| <input type="checkbox"/> Recreation Department | <input type="checkbox"/> Berm Use |
| <input type="checkbox"/> Sanitation Division, DPW | |
| <input type="checkbox"/> Street Design Bureau, DPW | |
| <input type="checkbox"/> Street Maintenance Division, DPW | |
| <input type="checkbox"/> Street and Traffic Division, DPW | |
| <input type="checkbox"/> Water and Sewerage Dept. - Sewer Design | |
| <input type="checkbox"/> Water and Sewerage Dept. - Water Design | |

A petition drawing is attached. Property shown on the attached print is proposed to be changed as indicated.

Kindly report (using the back of this sheet) the nature of your services (if any) affected by the proposed change and the estimated costs of removing and rerouting such services (if necessary).

Please return one copy to City Engineering Division, DPW. Retain one copy and print for you file.

Ron Brundidge, Director, Department of Public Works

By: Richard Doherty, CED DPW
City Engineer

**TO: City Engineering Division, DPW
65 Cadillac Square, Suite 900
Detroit, Michigan 48226-2873
Survey Bureau: 313-224-3970**

x542

The proposed change in property (referred to on the other side of this sheet) would affect our services as follows:

- Not Involved
- Involved; but asking you to hold action on this petition until further notice.
- Involved; but no objections to the property change.
- Involved; but no objections to the property change...provided as easement of the full width of the public right-of-way (street, alley or other public place) is reserved.
- Involved; the nature of our services and the estimated costs of removing and/or rerouting such services are:

(Utility or City Department)

By

Title

Date

Area code – Telephone number

PETITION NO. 542
 GIFFELS WEBSTER
 28 W. ADAMS, SUITE 1200
 DETROIT, MICHIGAN 48226
 C/O JAMES FOSTER
 PHONE NO. 313 962-4442

"REVISED"



GRAND RIVER AVE. 60 FT. WD.

LIBRARY AVE. 71 FT. WD.

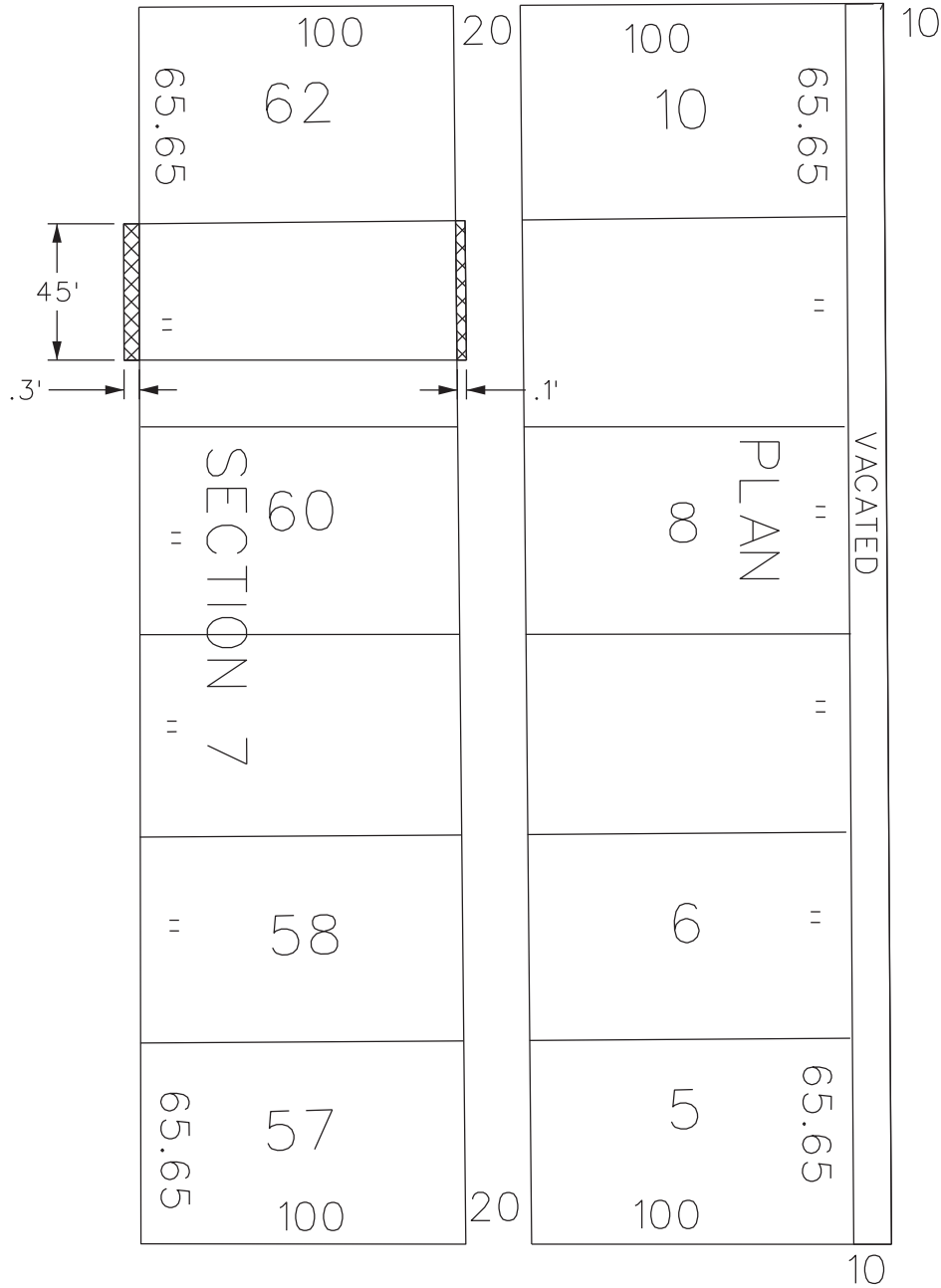

BROADWAY AVE. 100 FT. WD.

GRATIOT AVE. 60 FT. WD.



- REQUEST ENCROACHMENT
 (With Facade Improvements)

(FOR OFFICE USE ONLY)

CARTO 28 A

B						REQUEST ENCROACHMENT A PORTION OF 1260 LIBRARY ST. AND A PORTION OF THE NORTH/SOUTH PUBLIC ALLEY (With Facade Improvements) BETWEEN E. GRAND RIVER AND GRATIOT AVE.	CITY OF DETROIT CITY ENGINEERING DEPARTMENT SURVEY BUREAU	
A	REVISED - CHANGE FROM VACATION TO ENCROACHMENT	WLW	KSM	KSM	02/11/15			JOB NO. 01-01
DESCRIPTION		DRWN	CHKD	APPD	DATE			DRWG. NO. X 542
REVISIONS								
DRAWN BY	WLW	CHECKED						
DATE	02-06-15	APPROVED						

PROVISIONS FOR ENCROACHMENT For Petition 542

Detroit Water and Sewerage (DWSD) agree to the proposed encroachment subject to the fulfilling of the following provisions:

1. By approval of this petition the (DWSD) does not waive any of its rights to its facilities located in the right of way, and at all time, DWSD, its agents or employees, shall have the right to enter upon the right of way to maintain, repair, alter, service, inspect, or install its facilities. All costs incident to the damaging, dismantling, demolishing, removal and replacement of structures or other improvements herein permitted and incurred in gaining access to DWSD's facilities for maintenance, repairing, alteration, servicing or inspection caused by the encroachment shall be borne by the petitioner. All costs associated with gaining access to DWSD's facilities, which could normally be expected had the petitioner not encroached into the right of way shall be borne by DWSD.
2. All construction performed under this petition shall not be commenced until after five (5) days written notice to DWSD. Seventy-two (72) hours notice shall also be provided in accordance with P.A. 53 1974, as amended, utilizing the MISS DIG one call system.
3. Construction under this petition is subject to inspection and approval by DWSD forces. The cost of such inspection shall, at the discretion of DWSD, be borne by the petitioner.
4. If DWSD facilities located within the right of way shall break or be damaged as the result of any action on the part of the petitioner, then in such event the petitioner agrees to be liable for all costs incident to the repair, replacement or relocation of such broken or damaged DWSD facilities.
5. The petitioner shall hold DWSD harmless for any damage to the encroaching device constructed or installed under this petition, which may be caused by the failure of DWSD's facilities.

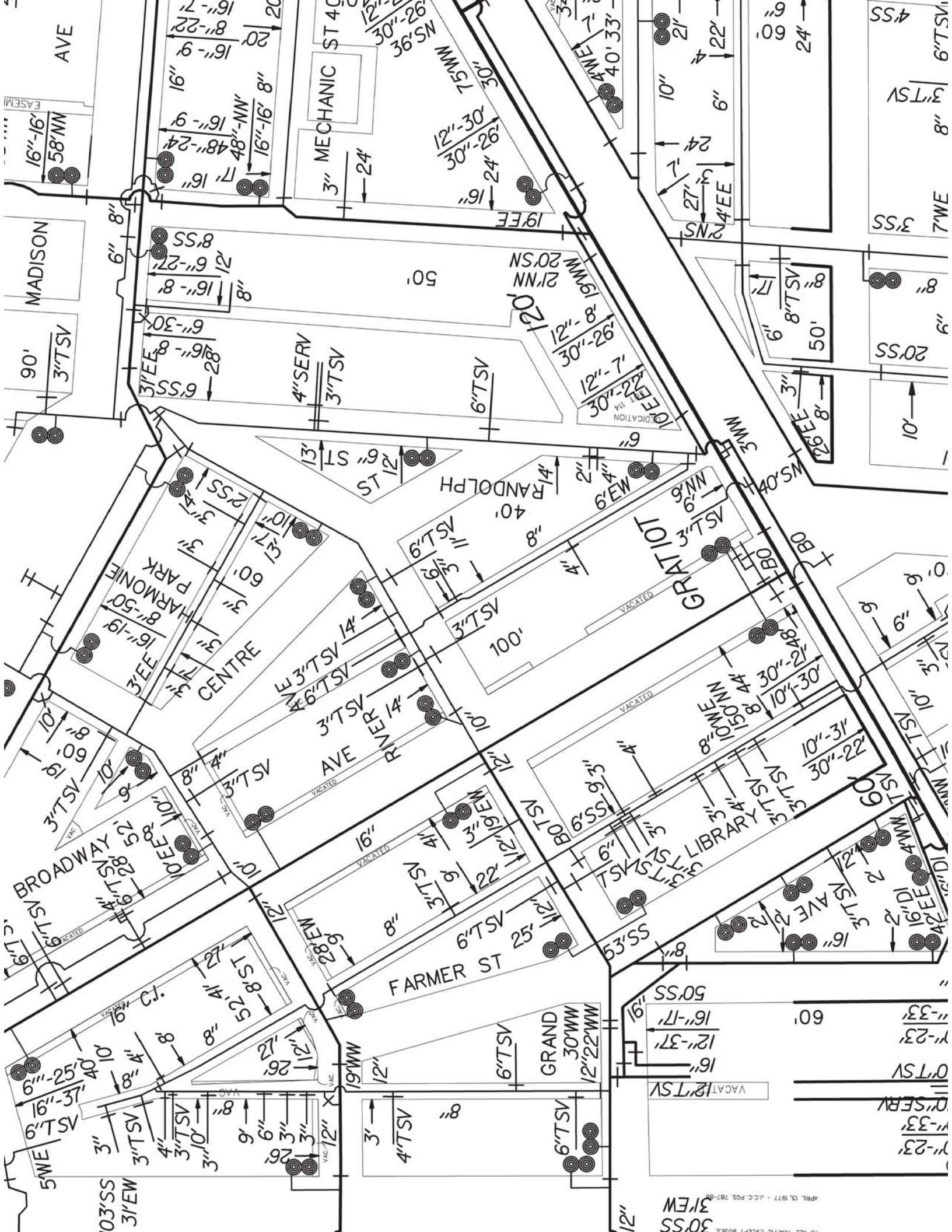

AVE

MADISON

90' 3" TSV

PARK HARMONIE

BROADWAY

5WE 3" TSV

MECHANIC ST 40

4" SERV 3" TSV

3" TSV 14'

3" TSV 10'

3" TSV 10'

RIVER AVE

FARMER ST

4" TSV

RANDOLPH

3" TSV

6" TSV

GRATIOT

LIBRARY

GRAND

3" TSV

10" EE

3" TSV

12" ST

3" TSV

10" EE

3" TSV

12" ST

3" TSV

10" EE

3" TSV

12" ST

3" TSV



1438 SEWER REPAIR FROM

15\"/>

1880
145'
30

1857
15\"/>

1890
15\"/>

1896-96
REBUILT
SECTION 7
R580
LIBRARY

1867
LIBRARY

1886
R484
PIPE
15\"/>

1895
R484
PIPE
15\"/>

1895
R484
PIPE
15\"/>

1895
R484
PIPE
15\"/>

STATE TO PARK
TEMP
CLOSED

1890
15\"/>

1896-96
REBUILT
SECTION 7
R580
LIBRARY

1867
LIBRARY

1886
R484
PIPE
15\"/>

1895
R484
PIPE
15\"/>

1895
R484
PIPE
15\"/>

1895
R484
PIPE
15\"/>

1895
R484
PIPE
15\"/>

1895
R484
PIPE
15\"/>

1890
15\"/>

1896-96
REBUILT
SECTION 7
R580
LIBRARY

1867
LIBRARY

1886
R484
PIPE
15\"/>

1895
R484
PIPE
15\"/>

1895
R484
PIPE
15\"/>

1895
R484
PIPE
15\"/>

1895
R484
PIPE
15\"/>

1895
R484
PIPE
15\"/>

1895
R484
PIPE
15\"/>

1890
15\"/>

1896-96
REBUILT
SECTION 7
R580
LIBRARY

1867
LIBRARY

1886
R484
PIPE
15\"/>

1895
R484
PIPE
15\"/>

1895
R484
PIPE
15\"/>

1895
R484
PIPE
15\"/>

1895
R484
PIPE
15\"/>

1895
R484
PIPE
15\"/>

1895
R484
PIPE
15\"/>

1890
15\"/>

1896-96
REBUILT
SECTION 7
R580
LIBRARY

1867
LIBRARY

1886
R484
PIPE
15\"/>

1895
R484
PIPE
15\"/>

1895
R484
PIPE
15\"/>

1895
R484
PIPE
15\"/>

1895
R484
PIPE
15\"/>

1895
R484
PIPE
15\"/>

1895
R484
PIPE
15\"/>

1890
15\"/>

1896-96
REBUILT
SECTION 7
R580
LIBRARY

1867
LIBRARY

1886
R484
PIPE
15\"/>

1895
R484
PIPE
15\"/>

1895
R484
PIPE
15\"/>

1895
R484
PIPE
15\"/>

1895
R484
PIPE
15\"/>

1895
R484
PIPE
15\"/>

1895
R484
PIPE
15\"/>

1890
15\"/>

1896-96
REBUILT
SECTION 7
R580
LIBRARY

1867
LIBRARY

1886
R484
PIPE
15\"/>

1895
R484
PIPE
15\"/>

1895
R484
PIPE
15\"/>

1895
R484
PIPE
15\"/>

1895
R484
PIPE
15\"/>

1895
R484
PIPE
15\"/>

1895
R484
PIPE
15\"/>

1890
15\"/>

1896-96
REBUILT
SECTION 7
R580
LIBRARY

1867
LIBRARY

1886
R484
PIPE
15\"/>

1895
R484
PIPE
15\"/>

1895
R484
PIPE
15\"/>

1895
R484
PIPE
15\"/>

1895
R484
PIPE
15\"/>

1895
R484
PIPE
15\"/>

1895
R484
PIPE
15\"/>

1890
15\"/>

1896-96
REBUILT
SECTION 7
R580
LIBRARY

1867
LIBRARY

1886
R484
PIPE
15\"/>

1895
R484
PIPE
15\"/>

1895
R484
PIPE
15\"/>

1895
R484
PIPE
15\"/>

1895
R484
PIPE
15\"/>

1895
R484
PIPE
15\"/>

1895
R484
PIPE
15\"/>

1890
15\"/>

1896-96
REBUILT
SECTION 7
R580
LIBRARY

1867
LIBRARY

1886
R484
PIPE
15\"/>

1895
R484
PIPE
15\"/>

1895
R484
PIPE
15\"/>

1895
R484
PIPE
15\"/>

1895
R484
PIPE
15\"/>

1895
R484
PIPE
15\"/>

1895
R484
PIPE
15\"/>