

# FAX TRANSMITTAL

## Office of the City Clerk

Coleman A Young Municipal Center  
Two Woodward Avenue, Suite 200  
Detroit, Michigan 48226  
Telephone: (313) 224-2070 Fax: (313) 224-2075

*Tuesday, February 03, 2015*

*No. of Pages 5*

FROM: *Mr. Andre Gilbert II, Junior Assistant City Council Committee Clerk*

SUBJECT: *Petition #541, Detroit Catholic Pastoral Alliance, request the conversion of one alley vacation/easement in the area of Gratiot Ave., Holcomb Ave., and Belvidere Ave. for the purpose of a new building located at 9100 Gratiot.*

### FAX TO THE FOLLOWING DEPARTMENT(S):

Mr. Richard Doherty, City Engineer

DPW - City Engineering Division

(313) 224-1464

Attachment

**City of Detroit**  
OFFICE OF THE CITY CLERK

Janice M. Winfrey  
*City Clerk*

Robin R. Underwood, CMC  
*Deputy City Clerk*

**DEPARTMENTAL REFERENCE COMMUNICATION**

*Tuesday, February 03, 2015*

*To: The Department or Commission Listed Below*

*From: Janice M. Winfrey, Detroit City Clerk*

---

The following petition is herewith referred to you for report and recommendation to the City Council.

In accordance with that body's directive, kindly return the same with your report in duplicate within four (4) weeks.

---

DPW - CITY ENGINEERING DIVISION

**541** *Detroit Catholic Pastoral Alliance, request the conversion of one alley vacation/easement in the area of Gratiot Ave., Holcomb Ave., and Belvidere Ave. for the purpose of a new building located at 9100 Gratiot.*

# Detroit Catholic Pastoral Alliance

## Board of Directors

**Christine P. McLaughlin**  
Chair  
Nativity of Our Lord

**Janet Moss**  
1<sup>st</sup> Vice-Chair  
Sacred Heart

**Rev. Norman P. Thomas**  
2<sup>nd</sup> Vice-Chair  
Sacred Heart/St. Elizabeth

**Tom Foster**  
Treasurer  
Servant Church of St. Alexander

**Sabina Dawson**  
Secretary  
St. Moses the Black

**Rowana Vance**  
Sacred Heart

**Jackie Fulbright**  
Gesu

**Alice Baker, IHM**  
Epiphany Education Center

**Marianne Krajenke Davis**  
St. Patrick

**Rev. Thomas Lumpkin**  
St. Ignatius/Day House

**William Samuels**  
St. Charles Lawanga

**Tamara Howard**  
Gratiot Woods

**Barbara June Johnson**  
St. Elizabeth

**George Rayes**  
Our Lady of the Rosary

**Tom Hinsberg**  
St. Aloysius

**Barbara White**  
Sacred Heart

**Bishop Thomas J. Gumbleton**  
Honorary

**Miriam Moses**  
Nativity of Our Lord

**Ed Shea**  
St. Peter Claver

**Linda Young**  
St. Charles Borromeo

**Rev. Jerome Singer**  
Nativity of Our Lord

**Ed Bell, Esquire**  
Sacred Heart

**Ed Ramey**  
Sacred Heart

**Cathey DeSantis, CSJ**  
Director

## ADVISORY BOARD

William Brooks  
Robin Cole  
Mary King  
Greg Longe  
Timothy O'Brien  
Donald Snider  
James Thompson  
James Vandenberg  
Kim Yamasaki



9200 Gratiot

Detroit, Michigan 48213

(313) 922-1435 Fax: (313) 922-8888

dcpa3@sbcglobal.net

#541

CITY CLERK 30 JAN 2015 PM 1:10

January 30, 2015

The Honorable City Council  
Office of the City Clerk  
200 Coleman A. Young Municipal Center  
Detroit, MI 48226

Dear Honorable City Council:

We are writing to request the conversion of (1) alley vacation/ easement in the area of Gratiot Avenue, Holcomb Avenue and Belvidere Avenue. The alley conversion will assist us in the development of a new residential / commercial building located at 9100 Gratiot, Detroit, MI 48213.

The vacating of the alley will also assist with additional residential greenspace and security. Enclosed please find plans for the area being developed. Please consider this request with the utmost consideration. If there are any questions or additional information needed please contact me at 313-922-1435 or email me at [cbradley@dcpasite.com](mailto:cbradley@dcpasite.com).  
Thanks!

Sincerely,

Cleophus Bradley  
Director of Community Development

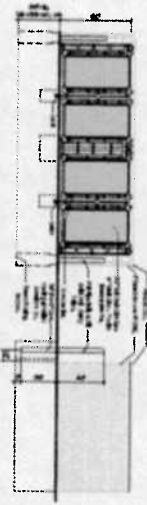

31 Elevation of Trash Dumpster Enclosure  
Scale: 1/4" = 1'-0"

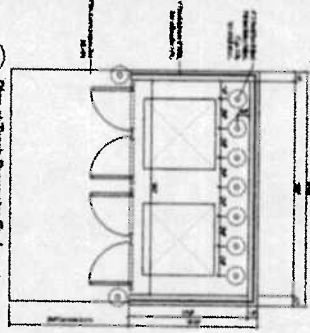

32 Plan of Trash Dumpster Enclosure  
Scale: 1/4" = 1'-0"

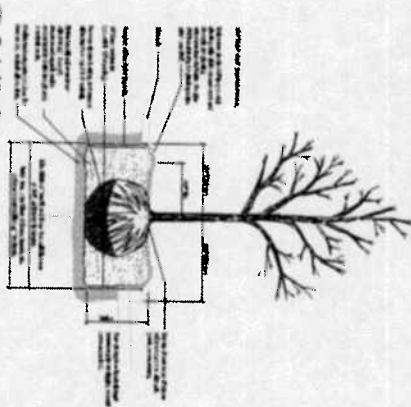

33 Typical Details  
Scale: 1/4" = 1'-0"

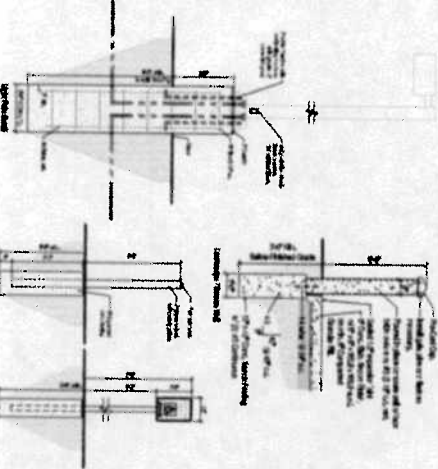

34 Typical Details  
Scale: 1/4" = 1'-0"

**Notes:**

1. ALL CONSTRUCTION SHALL BE IN ACCORDANCE WITH THE LATEST EDITIONS OF THE CALIFORNIA BUILDING CODES AND ALL APPLICABLE LOCAL ORDINANCES.
2. THE CONTRACTOR SHALL BE RESPONSIBLE FOR OBTAINING ALL NECESSARY PERMITS FROM THE LOCAL JURISDICTIONS.
3. THE CONTRACTOR SHALL MAINTAIN ACCESS TO ALL ADJACENT PROPERTIES AND UTILITIES AT ALL TIMES.
4. THE CONTRACTOR SHALL PROTECT ALL EXISTING UTILITIES AND STRUCTURES ON THE SITE.
5. THE CONTRACTOR SHALL MAINTAIN THE SITE IN A SAFE AND SOUND CONDITION AT ALL TIMES.
6. THE CONTRACTOR SHALL BE RESPONSIBLE FOR THE REMOVAL OF ALL DEBRIS AND WASTE MATERIALS FROM THE SITE.
7. THE CONTRACTOR SHALL MAINTAIN THE SITE ACCESSIBLE TO ALL ADJACENT PROPERTIES AND UTILITIES AT ALL TIMES.
8. THE CONTRACTOR SHALL BE RESPONSIBLE FOR THE PROTECTION OF ALL ADJACENT PROPERTIES AND UTILITIES.
9. THE CONTRACTOR SHALL MAINTAIN THE SITE IN A SAFE AND SOUND CONDITION AT ALL TIMES.
10. THE CONTRACTOR SHALL BE RESPONSIBLE FOR THE REMOVAL OF ALL DEBRIS AND WASTE MATERIALS FROM THE SITE.



35 Location Map  
Scale: 1" = 100'

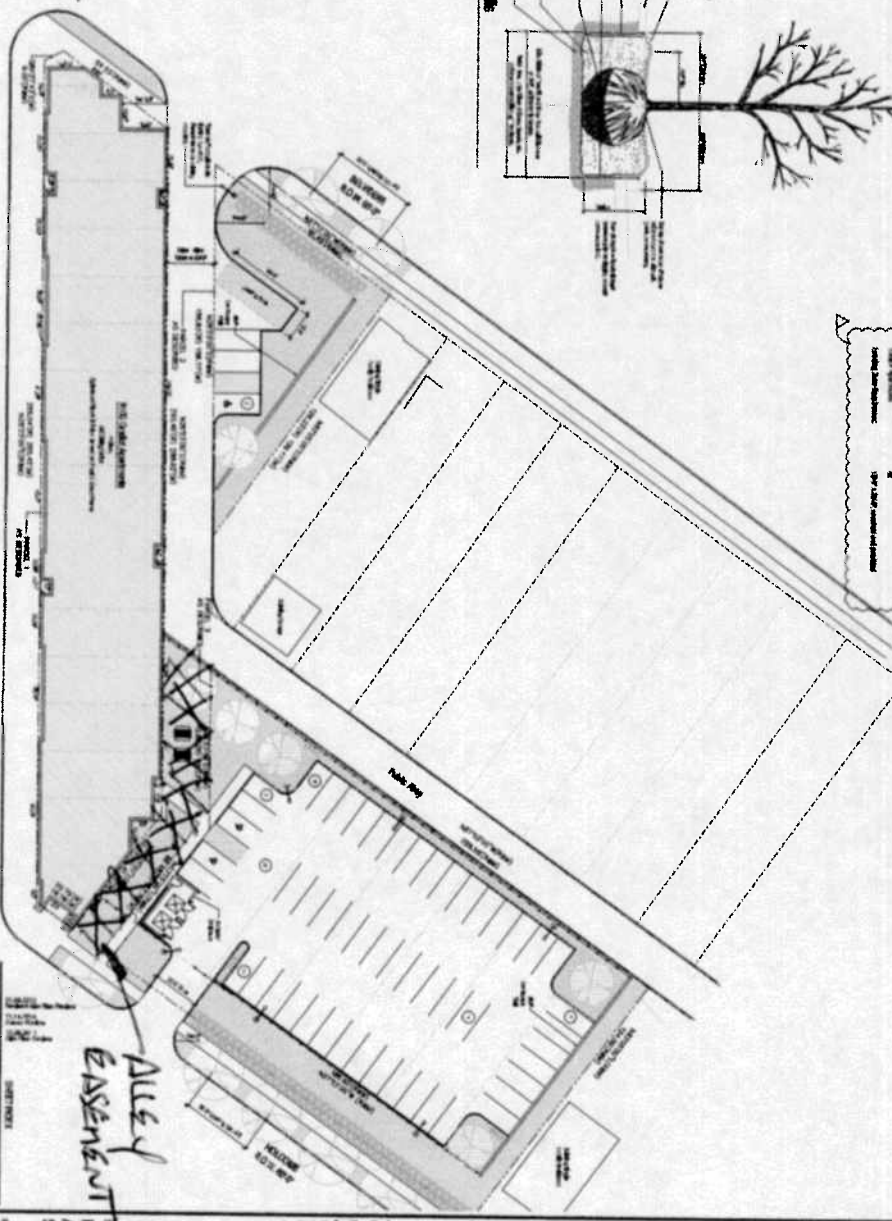

36 Proposed Architectural Site Plan  
Scale: 1/8" = 1'-0"

**SHELTER**  
SHELTER SYSTEMS, INC.  
1000 SHELTER DRIVE  
SHELTER, CALIFORNIA 94589  
TEL: (925) 461-1111  
WWW.SHELTERSYSTEMS.COM

**Project Information**  
Architectural Site Plan  
Site Details

**SP1**

