

FAX TRANSMITTAL

Office of the City Clerk

Coleman A Young Municipal Center
Two Woodward Avenue, Suite 200
Detroit, Michigan 48226
Telephone: (313) 224-2070 Fax: (313) 224-2075

Tuesday, January 20, 2015

No. of Pages 7

FROM: *Mr. Andre Gilbert II, Junior Assistant City Council Committee Clerk*

SUBJECT: ***Petition #520, Parjana & Parjana Distribution, request permission to correct underground water flow issues which are causing water to infiltrate the underground tunnel connecting the Federal Building and the building previously known as the Federal Reserve Building.***

FAX TO THE FOLLOWING DEPARTMENT(S):

Ms. Trisha Stein, Interim Director	Planning and Development Department	(313) 224-1629
Mr. Richard Doherty, City Engineer	DPW - City Engineering Division	(313) 224-1464

Attachment

City of Detroit
OFFICE OF THE CITY CLERK

Janice M. Winfrey
City Clerk

Robin R. Underwood, CMC
Deputy City Clerk

DEPARTMENTAL REFERENCE COMMUNICATION

Tuesday, January 20, 2015

To: The Department or Commission Listed Below

From: Janice M. Winfrey, Detroit City Clerk

The following petition is herewith referred to you for report and recommendation to the City Council.

In accordance with that body's directive, kindly return the same with your report in duplicate within four (4) weeks.

DPW - CITY ENGINEERING DIVISION PLANNING AND DEVELOPMENT DEPARTMENT

520 *Parjana & Parjana Distribution, request permission to correct underground water flow issues which are causing water to infiltrate the underground tunnel connecting the Federal Building and the building previously known as the Federal Reserve Building.*



PARJANA[®]
& PARJANA Distribution

1274 Library Street, Suite 600, Detroit, MI 48226
855-Parjana (855.727.5262) Fax: 313.915.5448
Website: Parjana.com Email: info@parjanadistribution.com

0716M* 5702 N81 37 XNETO ALLIO

520

January 12, 2015

Honorable Janice M. Winfrey
Office of the City Clerk, Room 200
200 Coleman A. Young Municipal Center
Detroit, MI 48226

Re: Petition to City Council

Your Honor;

Please accept this petition for work to be completed around an underground tunnel located on Shelby Street between West Fort Street and West Lafayette Boulevard. This will require the permission to close this section of Shelby St. to traffic during installation.

WHO: Parjana Distribution LLC of Detroit (1274 Library Street, Suite 600, 48226)

WHAT: To correct underground water flow issues which are causing water to infiltrate the underground tunnel connecting the Federal Building and the building previously known as the Federal Reserve Building.

WHERE: The underground tunnel on Shelby St. between W Fort St. and W Lafayette Blvd.

WHEN: Installation needs to take place as soon as possible to allow the Parjana System to acclimate.

SYNOPSIS: In order to mitigate the water infiltration problems, Parjana Distribution plans to drill a series of 4-inch diameter holes, at depths of 40 feet, through the street and into the soil surrounding the underground tunnel. Parjana Distribution will be responsible for patching these holes.

Attached are the project plans. For further information or questions pertaining to this project, please feel free to contact us:

Greg McPartlin
Parjana Distribution
(855) 727-5262

Thank you in advance for your prompt consideration.

Sincerely,

Greg McPartlin
Parjana Distribution LLC

SECTION 1: PRODUCT INFORMATION

Section 1: Product Information

1.1 TECHNICAL INFORMATION

Name: EGRP® (Energy-Passive Groundwater Recharge Product)

Base lengths: 5' (1.524 m), 10' (3.048 m), 20' (6.096 m) & 40' (12.192 m)

Diameter: 1 ¼" (31.75 mm)

Color: Natural Transparent Clear, Colorless

Material: Polyethylene per Parjana®, Inc.'s specifications

Material characteristics:

- Non-reactive with environment
- Excellent corrosion and abrasion resistance
- Working temperature -20°F to 180°F (-29°C to 82°C)
- Izod strength rating of 1.5 lbf / in² (10,342 N / m²)

1.2 PRODUCT DESCRIPTION

The EGRP®, Energy-Passive Ground Water Recharge Product is a five chambered tubular extrusion. This product speeds infiltration of surface water into the soil reducing runoff during wet weather conditions and evaporation during dry seasons by distributing water particles horizontally within the layers of the soil. It rebalances nature by mimicking the natural ground in areas where infrastructures have created impervious surfaces that disrupt natural absorption. It may be cut to specified lengths and bundled for high flow requirements. This product is a long-term solution, minimally invasive, self-cleaning, maintenance free and does not require an external energy source.

EGRP Installation

Line	Length (ft)	EGRP Device Lengths			Linear Feet	Caps
		5'	20'	40'		
A	77	0	0	15	1800	45
B	50	0	0	4	480	12
C	0	0	0	0	0	0
D	0	0	0	0	0	0
E	0	0	0	0	0	0
F	0	0	0	0	0	0
G	0	0	0	0	0	0
H	0	0	0	0	0	0
I	0	0	0	0	0	0
J	0	0	0	0	0	0
Total		0	0	19	2280	57

Note: 20' EGRP's and 40' EGRP's linear feet and caps is multiplied by 3 because there are 3 linked together.

LEGEND

- ⊕ 5' EGRP
- ⊕ 10' EGRP
- ⊕ 20' EGRP
- ⊕ 40' EGRP
- Structure Border
- - - Sewer Line
- Water Line
- Tree
- ⊙ Water Well
- ⊙ Sump Pump
- ▨ Building
- ▨ Backfill
- ▨ Structure
- ▨ Landscaping
- ▨ Open Area

Address: Shelby St. Between W Fort St & W Lafayette Blvd

Drawing Name: Bedrock Tunnel - Overview

Drawn By: P. N.

Scale: 1"=16'

Date: 11/24/2014

Parjana, Inc.

UTILITY NOTE:

All water main, storm sewer, sanitary sewer and public lighting utility as shown herein are taken from the best available records as disclosed by the various utility companies and/or municipalities. No guarantee can be given by Parjana as to the accuracy or completeness thereof. Gas and electric company utility were unavailable at the time of issuance of this survey.

Note:

Boundary description as provided existing utilities above and below ground have not been verified.

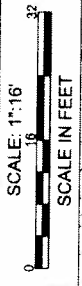

offset minimum 42" from known pipelines

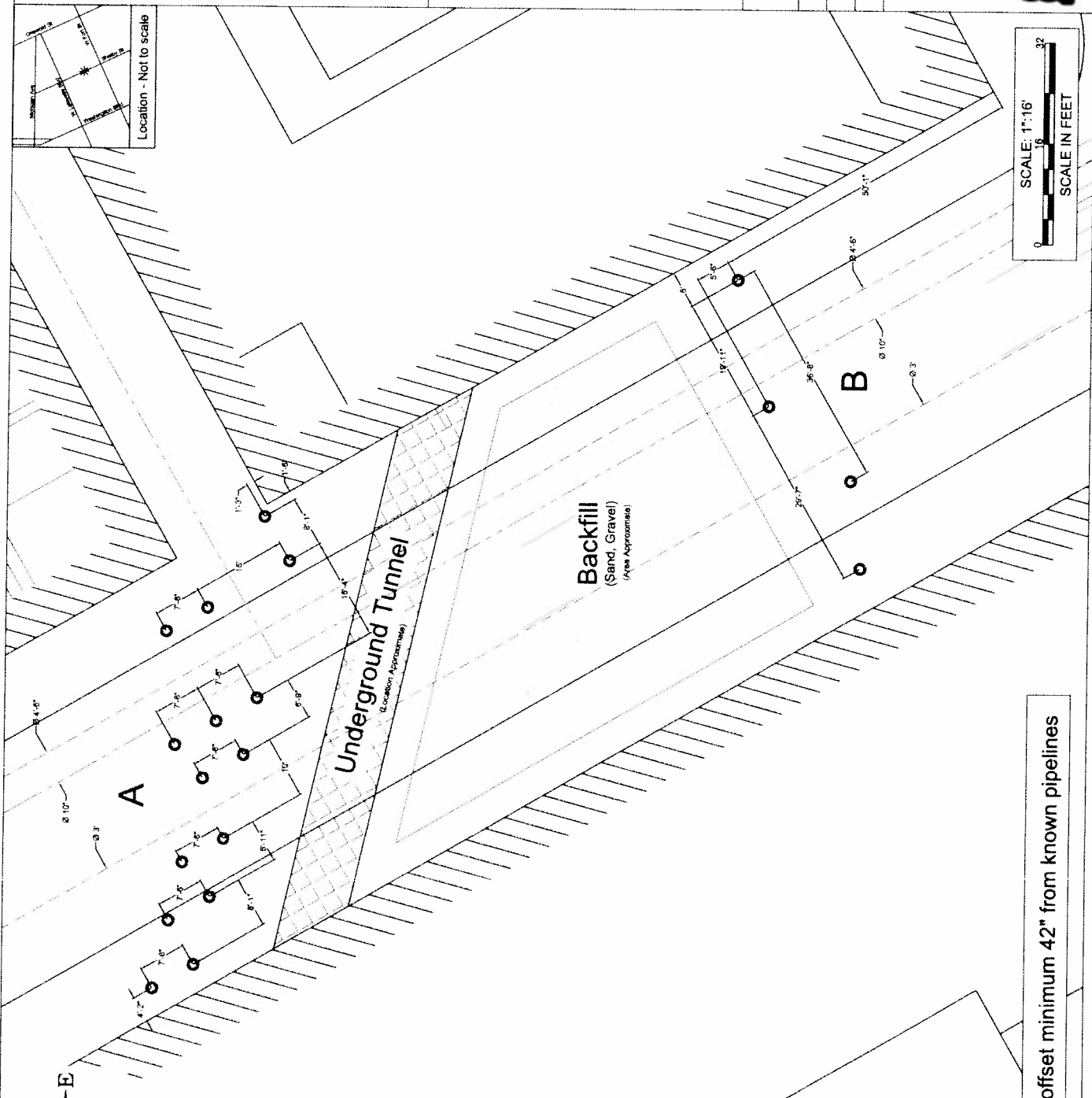

Location - Not to scale

-E Backfill
(Sand, Gravel)
(Area Approximate)

Location - Not to scale

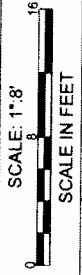

offset minimum 42" from known pipelines

EGRP Installation

Line	Length (ft)	EGRP Device Lengths			EGRP	Linear Feet	Caps
		5'	20'	40'			
A	77	0	0	15	1500	45	
B	50	0	0	4	450	12	
C	0	0	0	0	0	0	
D	0	0	0	0	0	0	
E	0	0	0	0	0	0	
F	0	0	0	0	0	0	
G	0	0	0	0	0	0	
H	0	0	0	0	0	0	
I	0	0	0	0	0	0	
J	0	0	0	0	0	0	
Total	0	0	0	19	2280	57	

Note: 20' EGRP's and 40' EGRP's linear feet and caps is multiplied by 3 because there are 3 linked together.

LEGEND

- 5' EGRP
- 10' EGRP
- 20' EGRP
- 40' EGRP
- Structure Border
- Sewer Line
- Water Line
- Tree
- ⊙ Water Well
- ⊙ Sump Pump
- ▨ Building
- ▨ Backfill
- ▨ Structure
- ▨ Landscaping
- ▨ Open Area

Address: Shelby St. Between W Fort St & W Lafayette Blvd

Drawing Name: Bedrock Tunnel - B

Drawn By: P. N. Scale: 1" : 8" Date: 11/24/2014

Parjana, Inc.

UTILITY NOTE:

All water main, storm sewer, sanitary sewer and public lighting utility as shown hereon are taken from the best available records as disclosed by the various utility companies and/or municipalities. No guarantee can be given by Parjana as to the accuracy or completeness thereof; gas and electric company utility were unavailable at the time of issuance of this survey.

Note: Boundary description as provided existing utilities above and below ground have not been verified.



