



DTE Energy - Michigan Consolidated Gas Company  
Data Integrity and Technology, Drafting Department  
One Energy Plaza, WCB-1836, 18<sup>TH</sup> Floor  
City of Detroit, MI 48226

January 23, 2015

**Richard Doherty, CED DPW, City Engineer**  
City of Detroit Engineering Division, DPW  
65 Cadillac Square, Suite 900  
City of Detroit, MI 48226-2873

**RE: Petition x520**

**Dated: 01/22/15**

The proposed change in property referred to would affect our services as follows:

- Not involved, no gas involved, and no objections.
- Involved but withholding action on petition until further notice.
- Involved but have no objection to the property change, provided that an easement of the full width of of the street/alley is reserved as shown. **See Remarks!**
- Involved – nature of services and estimated cost of removing or rerouting such services are:

**REMARKS:**

**Involved. DTE currently has a 12" steel gas main located at 27' west of east Shelby Avenue, as shown on the accompanying print. Please contact the DTE Gas Company Public Improvement Department: Michael Fedele at 313-389-7211 (Supervisor) or Laura Forrester at 313-389-7261 (Gas Planner), for the estimated cost of our services in abandoning/removing/ and/or relocating/rerouting, including the survey, design and drawing of our utilities. See enclosed strip prints for your use and information.**

**Please abide by Public Act 53, three (3) working days before you dig, dial toll free MISS DIG at: 1 – 800 – 482 – 7171.**

**Michcon Gas Leak Emergency Phone Number: 1- 800 – 947 – 5000.**

Sincerely,

*/s/ Neal Lauri*

Senior Drafter  
Data Integrity and Technology

NAL/  
Enclosure

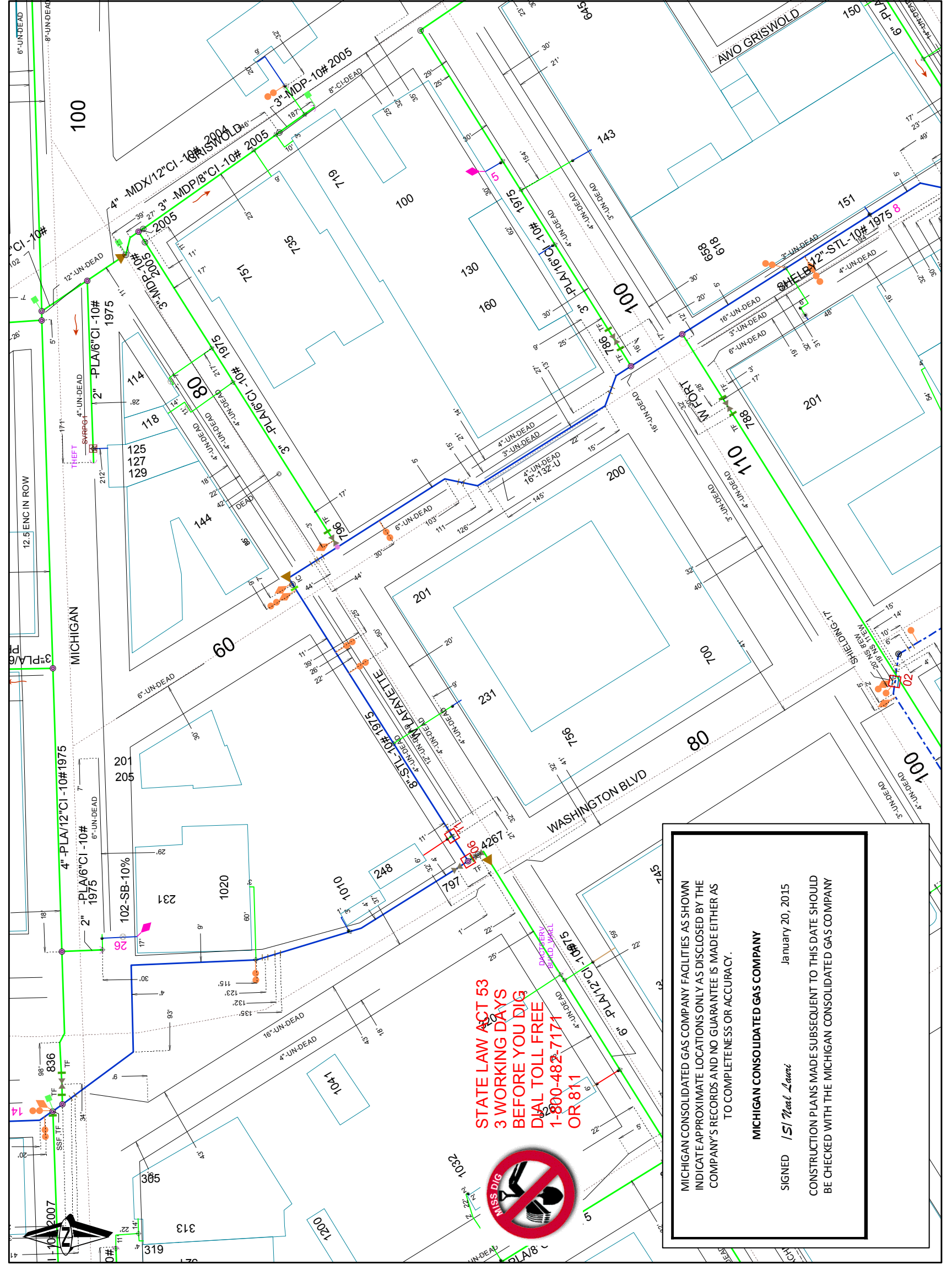

STATE LAW ACT 53  
 3 WORKING DAYS  
 BEFORE YOU DIG  
 DIAL TOLL FREE  
 1-800-482-7171  
 OR 811



MICHIGAN CONSOLIDATED GAS COMPANY  
 INDICATE APPROXIMATE LOCATIONS ONLY AS DISCLOSED BY THE  
 COMPANY'S RECORDS AND NO GUARANTEE IS MADE EITHER AS  
 TO COMPLETENESS OR ACCURACY.

**MICHIGAN CONSOLIDATED GAS COMPANY**  
 SIGNED */s/ Neal Lauri* January 20, 2015  
 CONSTRUCTION PLANS MADE SUBSEQUENT TO THIS DATE SHOULD  
 BE CHECKED WITH THE MICHIGAN CONSOLIDATED GAS COMPANY