

City of Detroit  
**City Engineering Division, Department of Public Works  
Survey Bureau**

**NOTICE OF PROPOSED CHANGE IN PROPERTY**

**Date:** 02/16/2015

**Petition:** x450

- |   |   |
|---|---|
| <input type="checkbox"/> AT&T Telecommunication                         |   |
| <input type="checkbox"/> Cable Television (CATV)                        | <input type="checkbox"/> Vacation                     |
| <input type="checkbox"/> Detroit Edison (DTE)                           |   |
| <input type="checkbox"/> Michigan Consolidated Gas (DTE)                | <input type="checkbox"/> Conversion to Easement       |
| <input type="checkbox"/> Fire Department                                | <input type="checkbox"/> Dedication                   |
| <input type="checkbox"/> Planning & Development Department              |   |
| <input type="checkbox"/> Public Lighting Authority                      | <input type="checkbox"/> Encroachment                 |
| <input type="checkbox"/> Public Lighting Dept. - Communication Division |   |
| <input type="checkbox"/> Public Lighting Dept. - Overhead Line Division |   |
| <input type="checkbox"/> Public Lighting Dept. - Underground Division   | <input checked="" type="checkbox"/> Temporary Closing |
| <input type="checkbox"/> Police Department                              |   |
| <input type="checkbox"/> Recreation Department                          | <input type="checkbox"/> Berm Use                     |
| <input type="checkbox"/> Sanitation Division, DPW                       |   |
| <input type="checkbox"/> Street Design Bureau, DPW                      |   |
| <input checked="" type="checkbox"/> Street Maintenance Division, DPW    |   |
| <input type="checkbox"/> Street and Traffic Division, DPW               |   |
| <input type="checkbox"/> Water and Sewerage Dept. - Sewer Design        |   |
| <input type="checkbox"/> Water and Sewerage Dept. - Water Design        |   |

A petition drawing is attached. Property shown on the attached print is proposed to be changed as indicated.

Kindly report (using the back of this sheet) the nature of your services if any affected by the proposed change and the estimated costs of removing and rerouting such services (if necessary).

Please return one copy to City Engineering Division, DPW. Retain one copy and print for you file.

Ron Brundidge, Director, Department of Public Works

By: Richard Doherty, CED DPW  
City Engineer

**TO: City Engineering Division, DPW  
65 Cadillac Square, Suite 900  
Detroit, Michigan 48226-2873  
Survey Bureau: 313-224-3970**

x450

The proposed change in property (referred to on the other side of this sheet) would affect our services as follows:

- Not Involved
- Involved; but asking you to hold action on this petition until further notice.
- Involved; but no objections to the property change.
- Involved; but no objections to the property change...provided as easement of the full width of the public right-of-way (street, alley or other public place) is reserved.
- Involved; the nature of our services and the estimated costs of removing and/or rerouting such services are:

DPW / Street Maintenance Division  
(Utility or City Department)

Dhaval Patel  
By 

Supervisor  
Title

3/31/2015  
Date

313.224.0021  
Area code – Telephone number

PETITION NO. 450  
 CADILLAC ACE HARDWARE  
 2497 W. DAVISON AVE.  
 DETROIT, MICHIGAN 48238  
 C/O DALTON BROWN  
 PHONE NO. 313 215-0693

**LINWOOD AVE. 86 FT. WD.**



**WAVERLY AVE. 50 FT. WD.**

**DAVISON AVE. 120 FT. WD.**

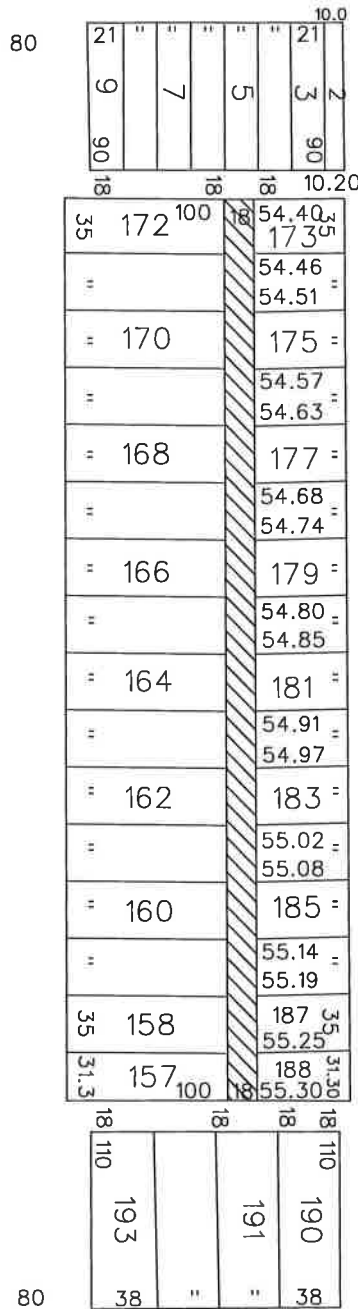

**LASALLE AVE. 80 FT. WD.**



- RENEWAL OF TEMPORARY ALLEY CLOSURE

(FOR OFFICE USE ONLY)

CARTO 23 A

B					
A					
DESCRIPTION	DRWN	CHKD	APPD	DATE	
REVISIONS					
DRAWN BY	WLW	CHECKED			
DATE	02-16-15	APPROVED			

**RENEWAL OF TEMPORARY ALLEY CLOSURE  
 THE EAST-WEST PUBLIC ALLEY  
 18 FT. WD. IN THE BLOCK BOUND BY  
 LASALLE, WAVERLY, LINWOOD  
 AND DAVISON AVE. W.**

**CITY OF DETROIT**  
 CITY ENGINEERING DEPARTMENT  
 SURVEY BUREAU  
 JOB NO. 01-01  
 DRWG. NO. X 450