

City of Detroit
City Engineering Division, Department of Public Works
Survey Bureau

NOTICE OF PROPOSED CHANGE IN PROPERTY

Third Notice 4/7/15
Second Notice 3/3/15

Date: 1/16/2015

Petition: x502

- AT&T Telecommunication
- Cable Television (CATV)
- Detroit Edison (DTE)
- Michigan Consolidated Gas (DTE)
- Fire Department
- Planning & Development Department
- Public Lighting Authority
- Public Lighting Dept. - Communication Division
- Public Lighting Dept. - Overhead Line Division
- Public Lighting Dept. - Underground Division
- Police Department
- Recreation Department
- Sanitation Division, DPW
- Street Design Bureau, DPW
- Street Maintenance Division, DPW
- Street and Traffic Division, DPW
- Water and Sewerage Dept. - Sewer Design
- Water and Sewerage Dept. - Water Design
- Vacation
- Conversion to Easement
- Dedication
- Encroachment
- Temporary Closing
- Berm Use

A petition drawing is attached. Property shown on the attached print is proposed to be changed as indicated.

Kindly report (using the back of this sheet) the nature of your services if any) affected by the proposed change and the estimated costs of removing and rerouting such services (if necessary).

Please return one copy to City Engineering Division, DPW. Retain one copy and print for you file.

Ron Brundidge, Director, Department of Public Works

By: Richard Doherty, CED DPW
City Engineer

**TO: City Engineering Division, DPW
65 Cadillac Square, Suite 900
Detroit, Michigan 48226-2873
Survey Bureau: 313-224-3970**

x502

The proposed change in property (referred to on the other side of this sheet) would affect our services as follows:

- Not Involved
- Involved; but asking you to hold action on this petition until further notice.
- Involved; but no objections to the property change.
- Involved; but no objections to the property change...provided as easement of the full width of the public right-of-way (street, alley or other public place) is reserved.
- Involved; the nature of our services and the estimated costs of removing and/or rerouting such services are:

Fica
(Utility or City Department)

Chief of P&E
By

Chief of Plans & Exams
Title

4/8/15
Date

(313) 224-1311
Area code - Telephone number

PETITION NO. 502
 BASELINE PROPERTY INVESTMENT, LLC
 20320 W. EIGHT MILE RD.
 SOUTHFIELD, MICHIGAN 48075
 C/O NAJAH GASSO
 PHONE NO. 248 353-4754



EIGHT MILE RD. 204 FT. WD.

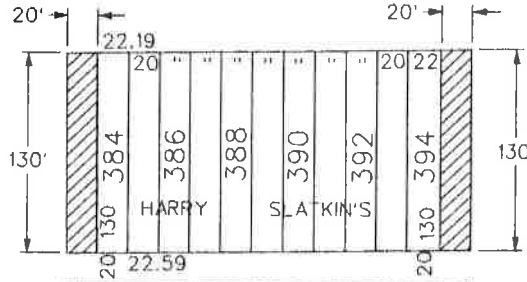

BURT RD. 86 FT. WD.

PIERSON AVE. 60 FT. WD.

53.01	131.65	54.43	133
46	409	408	55.47
	131.81	133	
46	92	53	46
	131.95		
"	132.05		"
"	90	55	"
	132.23		
"	132.37		"
"	88	57	"
	132.51		
46	132.65		"
47.52	86	46.56	59
	132.79	133	46

HESSEL AVE. 60 FT. WD.



- REQUESTED CONVERSION TO EASEMENT

(FOR OFFICE USE ONLY)

CARTO 115 B

B				REQUEST TO CONVERT TO EASEMENT A PORTION OF THE NORTH/SOUTH PUBLIC STREETS, 20 FT. WD. IN THE BLOCK BOUND BY PIERSON, HESSEL AVE., BURT AND EIGHT MILE RD W.				CITY OF DETROIT CITY ENGINEERING DEPARTMENT SURVEY BUREAU					
A								JOB NO. 01-01					
DESCRIPTION		DESN	CHGD					APPD	DATE	DRWG. NO. X 502			
DRAWN BY		REVISIONS						CHECKED					
DATE		APPROVED		DATE									

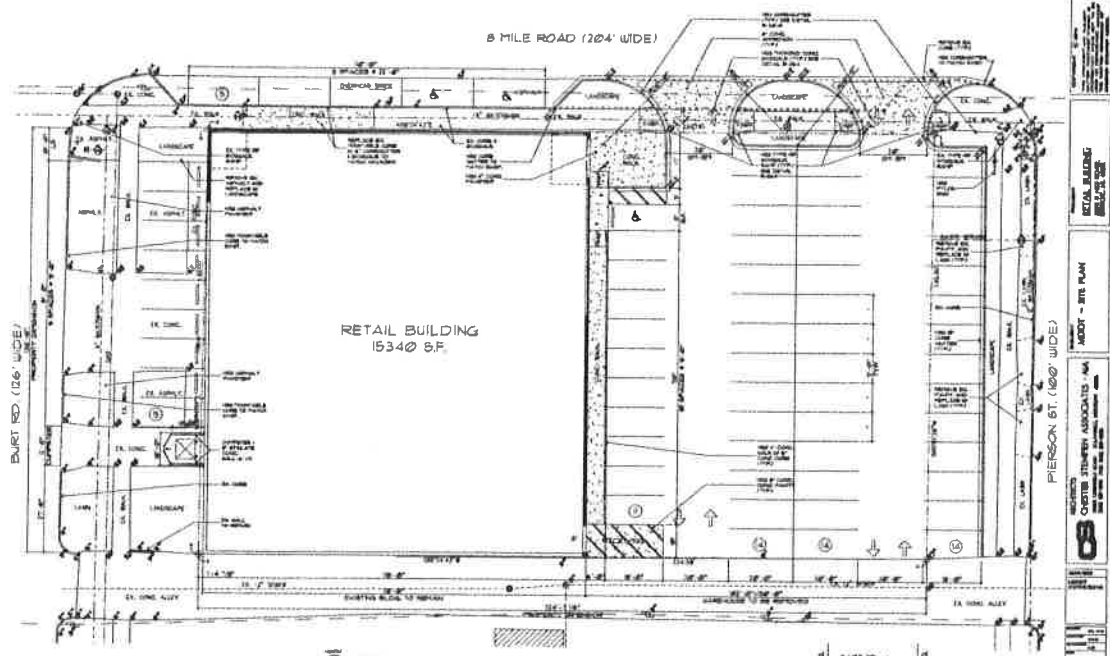

SITE PLAN
 SCALE: 1/8" = 1'-0"

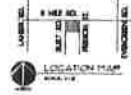

CONTRACT:
 DATE:
 SHEET NO.: 1111

PROJECT NO. 24056
SHEET NO. C.1
DRAWN BY DATE
CHECKED BY DATE
PROJECT NAME RETAIL BUILDING
CLIENT ADOT - SITE PLAN
ARCHITECT OSTER JENSEN ASSOCIATES - PA

TOPOGRAPHIC SURVEY

Op

DATE: 10/10/2014
 PROJECT: 14-00000000
 CLIENT: [REDACTED]
 SURVEYOR: [REDACTED]

LOCATION MAP

811

UTILITY INFORMATION

DATE: 10/10/2014

WEST 8 MILE ROAD (204 FEET WIDE)

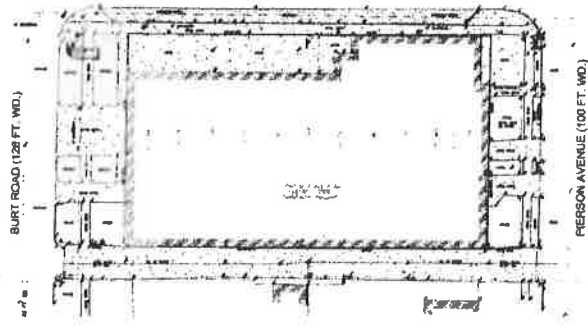

LEGEND

Symbol	Description	Symbol	Description
[Symbol]	Property Line	[Symbol]	Survey Station
[Symbol]	Corner Marker	[Symbol]	Spot Elevation
[Symbol]	Boundary Line	[Symbol]	Contour Line
[Symbol]	Existing Structure	[Symbol]	Proposed Structure
[Symbol]	Driveway	[Symbol]	Water Feature
[Symbol]	Setback Line	[Symbol]	Utility Line

LEGAL DESCRIPTION

SECTION 10, T4N, R10E, S4E, DISTRICT OF COLUMBIA

TOPOGRAPHIC SURVEY NOTES

ALL DIMENSIONS ARE IN FEET AND DECIMALS THEREOF.

ALL ANGLES ARE IN DEGREES, MINUTES AND SECONDS.

ALL DISTANCES ARE MEASURED ALONG THE CENTERLINE UNLESS OTHERWISE NOTED.

ALL CURVES ARE CIRCULAR UNLESS OTHERWISE NOTED.

ALL ELEVATIONS ARE IN FEET ABOVE MEAN SEA LEVEL UNLESS OTHERWISE NOTED.

ALL UTILITIES SHOWN ARE FROM FIELD SURVEY UNLESS OTHERWISE NOTED.

ALL STRUCTURES SHOWN ARE FROM FIELD SURVEY UNLESS OTHERWISE NOTED.

ALL RIGHTS RESERVED.

DATE: 10/10/2014