

DTE Energy - Gas Co.
Data Integrity and Technology
One Energy Plaza, GO-838
City of Detroit, MI 48226

October 8, 2015

Richard Doherty, CED DPW Head Engineer
City Engineering Division, DPW
2 Woodward Ave, Suite 642
Detroit, Michigan 48226-3462

RE: Petition #486

Dated: 10/8/2015

- Not involved. **See Remarks**
- Involved: but asking you to hold action on this petition until further notice.
- Involved but have no objection to the property change - - provided that an easement of the full width of the public right-of-way (street, alley or other public place) is reserved.
- Involved: the nature of our services, and the estimated costs of removing, rerouting or abandonment of such all gas mains and/or services

REMARKS:

Involved but have no objections to the property change, provided that the request Berm Use (For Parking Only) into Waltham Ave at 12700 E. Eight Mile Rd. Reason being is that, DTE Energy Gas Co. has an existing Gas main line (4"-CI-2# 1942) on Waltham between E. Eight Mile Rd. and Collingham Ave. Otherwise, contact DTE Energy Gas Company Public Improvement Department: Michael Fedele at 313-389-7211 (Supervisor) or Laura Forrester at 313-389-7261 (Gas Planner), for the estimated cost of our services in abandoning/removing/ and/or relocating/rerouting, including the survey, design and drawing of our utilities. See enclosed strip prints for your use and information regarding our gas main locations.

Please abide by Public Act 174, three (3) working days before you dig, dial toll free MISS DIG at: 1 – 800 – 482 – 7171.

DTE Energy Gas Leak Emergency Phone Number: 1- 800 – 947 – 5000.

Sincerely,

***RS* Russell E Thornton**

Drafter
Data Integrity and Technology

RET/
Enclosure

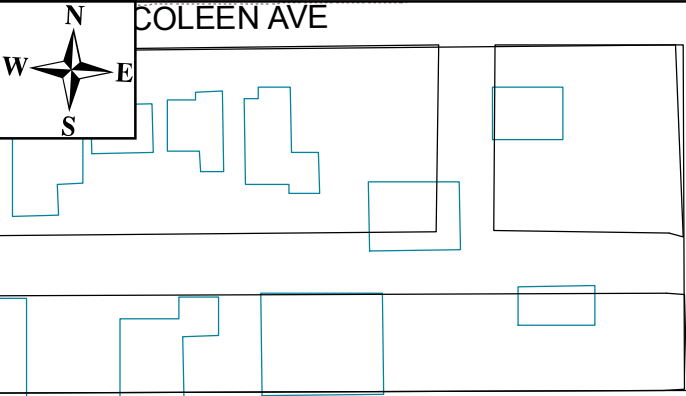

COLEEN AVE

WALTHAM
WALTHAM RD



STATE LAW ACT 174
3 WORKING DAYS
BEFORE YOU DIG
DIAL TOLL FREE
1-800-482-7171
OR 811

204

E 8 MILE RD

E 8 MILE RD

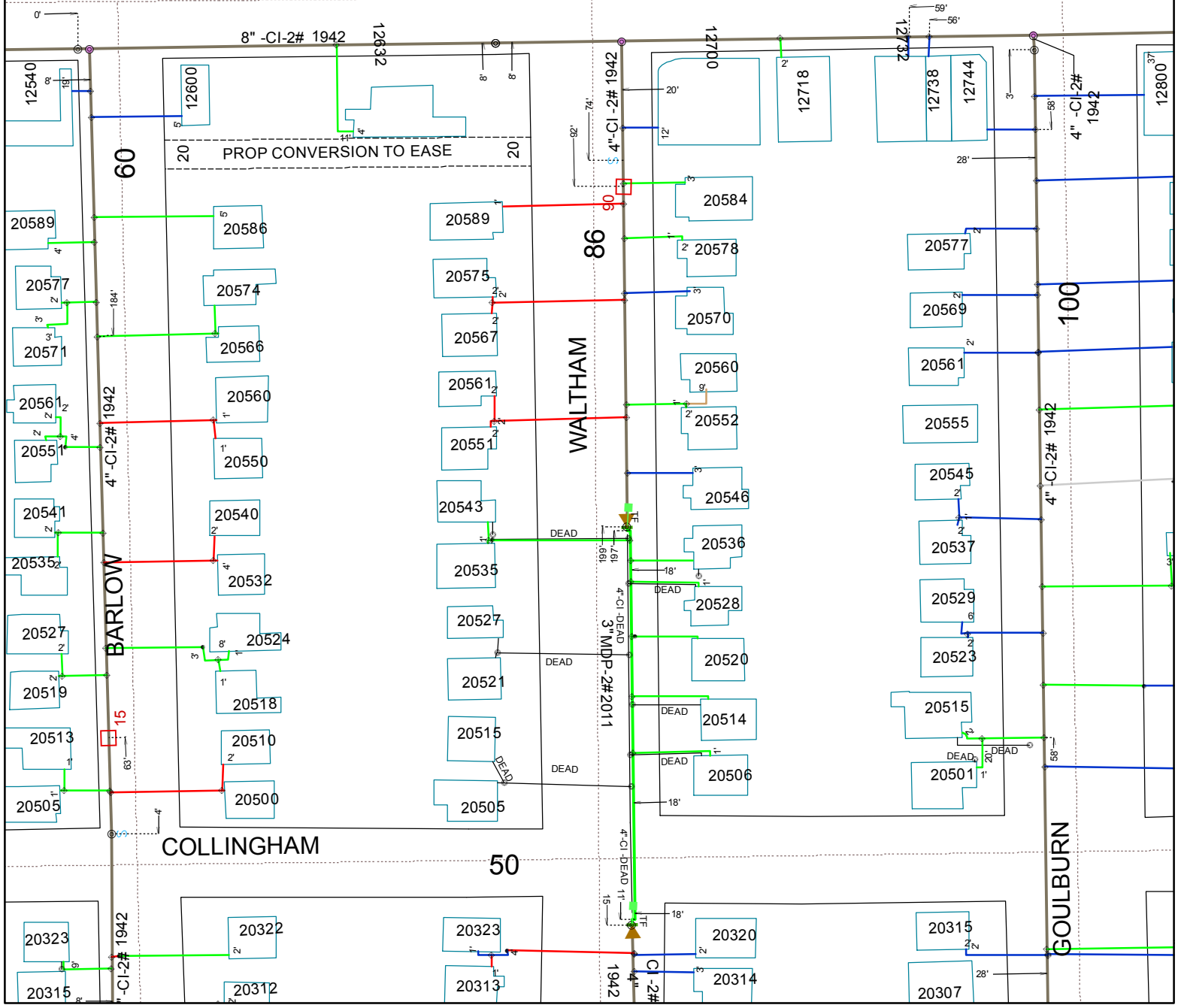

60

86

100

BARLOW

WALTHAM

GOULBURN

COLLINGHAM

50

12540

12600

12632

12700

12718

12738

12744

12800

20589

20586

20584

20578

20577

20575

20574

20570

20569

20567

20561

20561

20560

20555

20552

20555

20551

20545

20545

20577

20574

20570

20569

20566

20561

20561

20560

20555

20552

20555

20551

20545

20545

20571

20566

20560

20561

20561

20560

20555

20552

20555

20551

20545

20545

20561

20560

20555

20552

20555

20551

20545

20545

20541

20540

20546

20536

20537

20535

20528

20520

20529

20523

20520

20514

20514

20535

20532

20536

20537

20535

20528

20520

20529

20523

20520

20514

20514

20527

20524

20528

20523

20527

20520

20514

20514

20519

20518

20514

20514

20520

20514

20514

20514

20514

20514

20514

20514

20513

20510

20514

20514

20520

20514

20514

20514

20514

20514

20514

20514

20505

20500

20506

20501

20505

20506

20501

20506

20501

20506

20501

20506

20323

20322

20323

20315

20312

20323

20313

20320

20314

20314

20315

20307

20315

20314

20307

20315

Gas GIS Legend

Service Symbols

- EndCap
- LoopedService
- Section
- EFV Relief Valve
- AbandonedService

Aban. Service pipe

NOTE: Service line style is the same as the main it is tied into

Customer Events

- Service Event
- CUTCAP (CCType, location)

AbandonedGasPipesSymbol

- Abandoned Gas Device
- End Cap
- Section Symbol

Gas Pipe Protection

- Casing
- Shield
- Sleeve

Land

- Bridge
- DrainCreek
- Easement
- Lotline
- RailRoad
- RightOfWay
- Tunnel
- Water
- Street Centerline
- Building
- Landmark
- BrownField
- Known Sites of Environmental Contamination DEQ Dec2008

CPAnode

- Single
- Multiple

CP Rectifier

- Rectifier

Test Point

- DOT
- Regular TW

Tracer Wire

- Tracer Wire

Gas Valve

- Main, Closed
- Main, Open
- Service, Closed
- Service, Open

Regulator Station

- District
- Secondary
- Service

Controllable Fitting

- PCF Pressure Control Fitting
- SSF Short Stop
- Stopple Fitting
- Distribution Tiein
- Subtransmission Tiein
- Transmission Tiein
- Branch
- Cap
- Coupling
- Ell
- Insulated
- Reducer
- Section
- Tee
- Transition
- <all other values>

NonControllableFitting

- Branch
- Cap
- Coupling
- Ell
- Insulated
- Reducer
- Section
- Tee
- Transition
- <all other values>

Material Type

- CU - Copper
- CI - Cast Iron
- PLA - Plastic
- STL - Bare Steel
- STL - Coated Steel
- PLA - Plastic, Joint Trench
- OTR - Other
- UN - Unknown
- WI - Wrought Iron
- <all other values>
- Inactive - all material types

Main Lines Styles

- In Design Main (Proposed)
- Distribution Main
- Distribution - Joint Trench
- Subtransmission Main
- Transmission
- Exposed Pipe (Coated Steel)
- Pipe Lining (CI or WI)
- AbandonedGasPipe

Other Symbols

- Drip
- Flow Arrow
- Foreign Utility Pipe
- Public Improvement
- Pressure Monitoring Device
- Leak Report - Leak Repair
- Automated Repairs
- LowPoint
- Summit

Scaled Areas

- 10
- 30
- 50 SCALE