

City of Detroit
City Engineering Division, Department of Public Works
Survey Bureau

NOTICE OF PROPOSED CHANGE IN PROPERTY

Date: 04/22/2015

Petition: x482 ✓

- | | |
|--|--|
| <input type="checkbox"/> AT&T Telecommunication | |
| <input type="checkbox"/> Cable Television (CATV) | <input type="checkbox"/> Vacation |
| <input type="checkbox"/> Detroit Edison (DTE) | |
| <input type="checkbox"/> Michigan Consolidated Gas (DTE) | <input type="checkbox"/> Conversion to Easement |
| <input type="checkbox"/> Fire Department | <input type="checkbox"/> Dedication |
| <input type="checkbox"/> Planning & Development Department | |
| <input type="checkbox"/> Public Lighting Authority | <input checked="" type="checkbox"/> Encroachment |
| <input checked="" type="checkbox"/> Public Lighting Dept. - Communication Division | |
| <input checked="" type="checkbox"/> Public Lighting Dept. - Overhead Line Division | |
| <input checked="" type="checkbox"/> Public Lighting Dept. - Underground Division | <input type="checkbox"/> Temporary Closing |
| <input type="checkbox"/> Police Department | |
| <input type="checkbox"/> Recreation Department | <input type="checkbox"/> Berm Use |
| <input type="checkbox"/> Sanitation Division, DPW | |
| <input type="checkbox"/> Street Design Bureau, DPW | |
| <input type="checkbox"/> Street Maintenance Division, DPW | |
| <input type="checkbox"/> Street and Traffic Division, DPW | |
| <input type="checkbox"/> Water and Sewerage Dept. - Sewer Design | |
| <input type="checkbox"/> Water and Sewerage Dept. - Water Design | |

A petition drawing is attached. Property shown on the attached print is proposed to be changed as indicated.

Kindly report (using the back of this sheet) the nature of your services (if any) affected by the proposed change and the estimated costs of removing and rerouting such services (if necessary).

Please return one copy to City Engineering Division, DPW. Retain one copy and print for you file.

Ron Brundidge, Director, Department of Public Works

By: Richard Doherty, CED DPW
City Engineer

**TO: City Engineering Division, DPW
65 Cadillac Square, Suite 900
Detroit, Michigan 48226-2873
Survey Bureau: 313-224-3970**

x482

The proposed change in property (referred to on the other side of this sheet) would affect our services as follows:

- Not Involved
- Involved; but asking you to hold action on this petition until further notice.
- Involved; but no objections to the property change.
- Involved; but no objections to the property change...provided as easement of the full width of the public right-of-way (street, alley or other public place) is reserved.
- Involved; the nature of our services and the estimated costs of removing and/or rerouting such services are:

(Utility or City Department)

By

Title

Date

Area code – Telephone number

X482

Public Lighting Department (PLD)

By Denise Williams

Senior Assistant Mechanical Engineer

5/28/15

313-267-7216

PETITION NO. 482
 HONIGMAN
 C/O CURIS1274 LLC
 39400 WOODWARD AVE. SUITE 101
 BLOOMFIELD HILLS, MICHIGAN 48304
 C/O AARON BASS ESQ.
 PHONE NO. 248 566-8609



E. GD. RIVER AVE. 60 FT. WD.

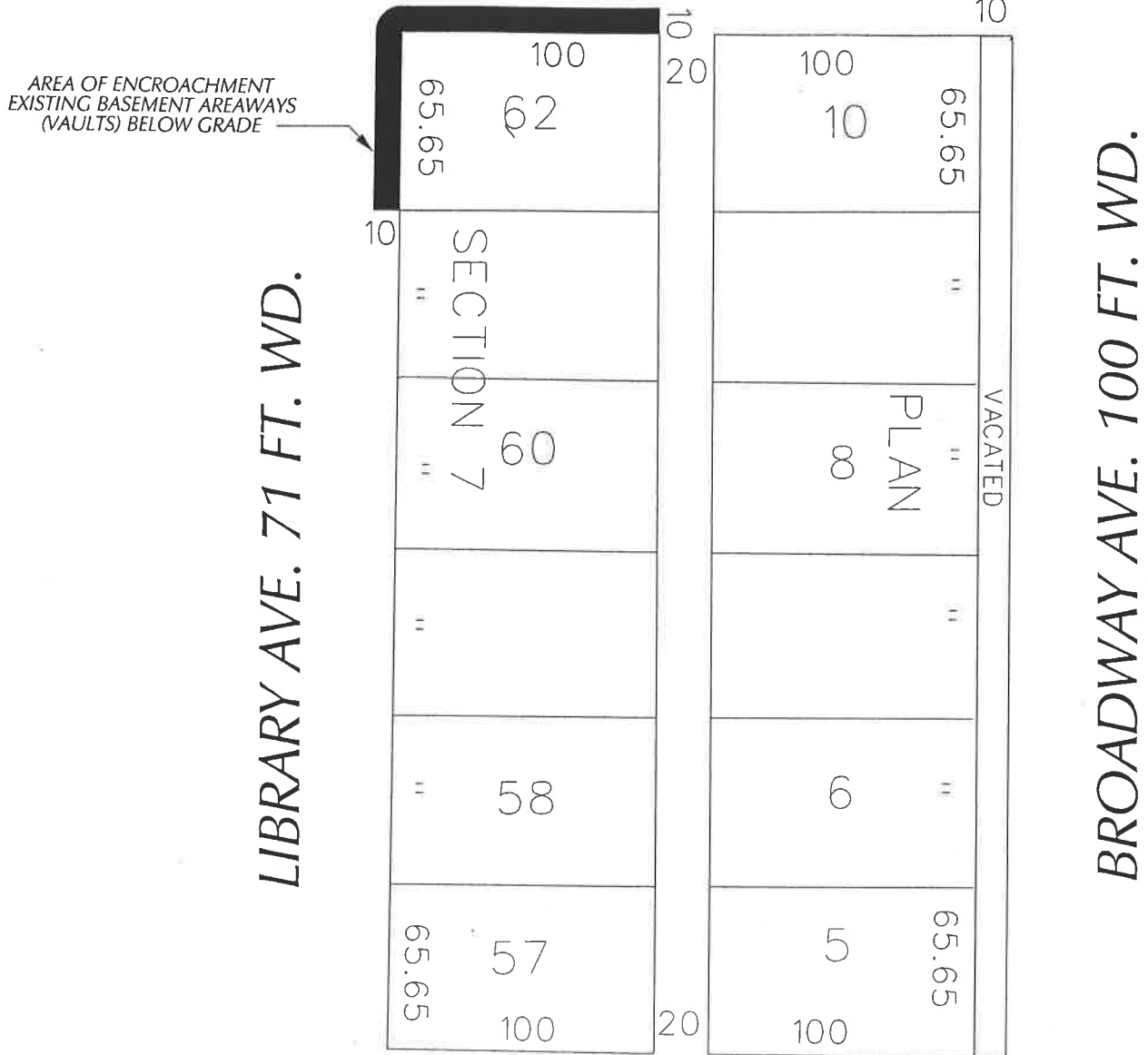

GRATIOT AVE. 60 FT. WD.



- REQUEST ENCROACHMENT
 (With Vaults Below Grade)

(FOR OFFICE USE ONLY)

CARTO 28 A

B						REQUEST FOR TRANSFER OF ENCROACHMENT INTO BOTH E. GRAND RIVER AND LIBRARY AVE. WITH EXITING BASEMENT AREAWAYS 10 FEET INTO R.O.W. (With Vaults Below Grade)	CITY OF DETROIT CITY ENGINEERING DEPARTMENT SURVEY BUREAU	
A					JOB NO. 01-01			
DESCRIPTION		DRWN	CHKD	APPD	DATE			DRWG. NO. x482 (aka x197)
DRAWN BY		REVISIONS						
DATE		CHECKED		APPROVED				
JK / WLW								
04-22-15								