

FAX TRANSMITTAL

Office of the City Clerk

Coleman A Young Municipal Center

Two Woodward Avenue, Suite 200

Detroit, Michigan 48226

Telephone: (313) 224-2070 Fax: (313) 224-2075

Monday, October 27, 2014

No. of Pages

FROM: *Mr. Andre Gilbert II, Junior Assistant City Council Committee Clerk*

SUBJECT: ***Petition #452, Detroit Regional Convention Facility Authority, request approval of exterior signage for the Cobo Center Capital Improvements Program.***

FAX TO THE FOLLOWING DEPARTMENT(S):

David Whitiker, Interim Director	Legislative Policy Division	(313) 224-4336
Mr. Richard Doherty, City Engineer	DPW - City Engineering Division	(313) 224-1464
David Bell, Building Official	Buildings Safety Engineering	(313) 224-1467

Attachment

City of Detroit
OFFICE OF THE CITY CLERK

Janice M. Winfrey
City Clerk

Robin R. Underwood, CMC
Deputy City Clerk

DEPARTMENTAL REFERENCE COMMUNICATION

Monday, October 27, 2014

To: The Department or Commission Listed Below

From: Janice M. Winfrey, Detroit City Clerk

The following petition is herewith referred to you for report and recommendation to the City Council.

In accordance with that body's directive, kindly return the same with your report in duplicate within four (4) weeks.

BUILDINGS SAFETY ENGINEERING DPW - CITY ENGINEERING DIVISION
LEGISLATIVE POLICY DIVISION

452 *Detroit Regional Convention Facility Authority, request approval of exterior signage for the Cobo Center Capital Improvements Program.*



Architects + Planners

October 21, 2014

Detroit City Council
1340 Coleman A. Young Municipal Center
Two Woodward Avenue,
Detroit, MI 48226

Re: **PETITION**
of Detroit Regional Convention Facility Authority
for COBO CENTER
Petition for approval of Exterior Signage

Dear Honorable Body:

On the instructions of the Detroit Regional Convention Facility Authority, we are hereby submitting this petition for approval of EXTERIOR SIGNAGE for the Cobo Center Capital Improvements Program.

On July 19th, 2011 your Honorable Body approved a special district review for major modifications to Cobo Center. The submitted material and therefore your approval did not include the exterior signage.

REQUESTS

The Detroit Regional Convention Facility Authority requests the following approvals for exterior signage:

1. Under the City of Detroit Zoning Code Section 61-6-111 (d) and 61-6-116 approval of the location and design of the exterior signs.

Sincerely,

GEOFFREY HARRISON
Principal

Contact Person – Tel: 313 961-9000 extension 109
E-Mail: gharrison@sdg-assoc.com
Fax: 313 964-3233

2014 OCT 23 A 10:44
DETROIT
CITY CLERK

615 Griswold
Ford Building
Suite 103
Detroit, Michigan 48226
(313) 961-9000
Fax: (313) 964-3233

Detroit Regional
Convention Facility
Authority



SDG

Project No. 13105.86

COVER SHEET

A1.00

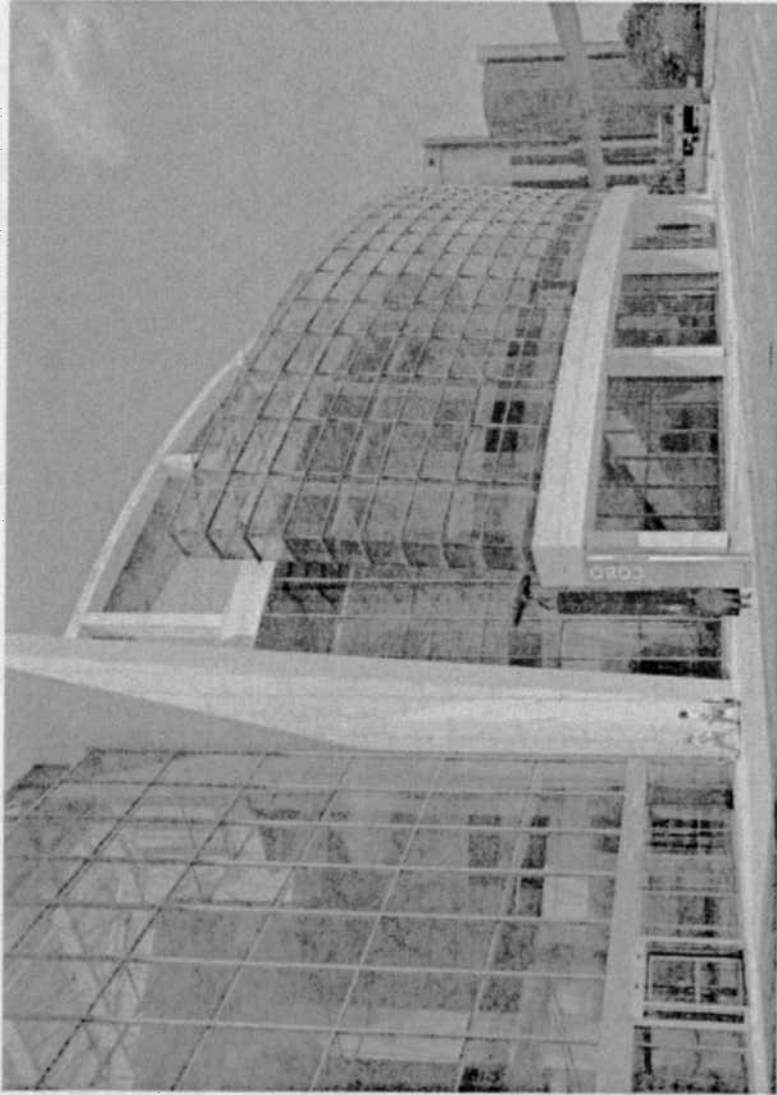

Cobo Exterior Wayfinding Signage

Exterior Signage and Right of Way

October 22, 2014

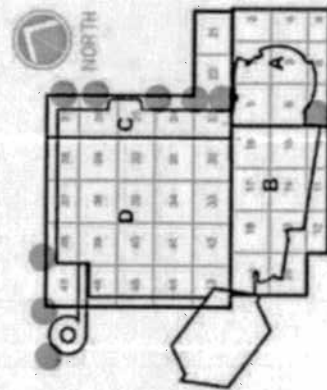

Contents:

A1.00	Cover Sheet
A1.01	Contents
A1.02	Signage Legend
A1.03	Boundary Survey (Flight of Way)
A1.04	Site Plan Signage Location
A1.05	Site Plan Signage Location
A1.06	Site Plan Signage Location
A1.07	Site Plan Signage Location
A1.08	Site Plan Signage Location
A1.09	Site Plan Signage Location
A1.10	Corbin Design Signage Detail
A1.11	Corbin Design Signage Detail
A1.12	Corbin Design Signage Detail
A1.13	Corbin Design Signage Detail



Project No. 13105.86

CONTENTS

A1.01

ENTRANCE SIGNAGE A

- A1 SHEET A1.06 (Right of Way)
- A2 SHEET A1.06 (Flight of Way)
- A3 SHEET A1.08 (COBO Property)
- A4 SHEET A1.08 (COBO Property)
- A5 SHEET A1.09 (COBO Property)



PARKING SIGNAGE B

- B1 SHEET A1.04 (Right of Way)
- B2 SHEET A1.07 (Right of Way)

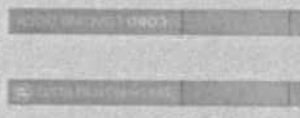

PARKING SIGNAGE C

- C1 SHEET A1.04 (COBO Property)
- C2 SHEET A1.05 (COBO Property)
- C3 SHEET A1.07 (COBO Property)



ELECTRONIC PARKING D

- D1 SHEET A1.05 (COBO Property)
- D2 SHEET A1.07 (COBO Property)

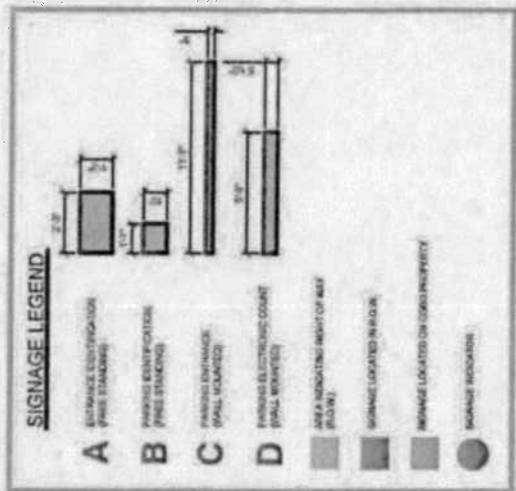
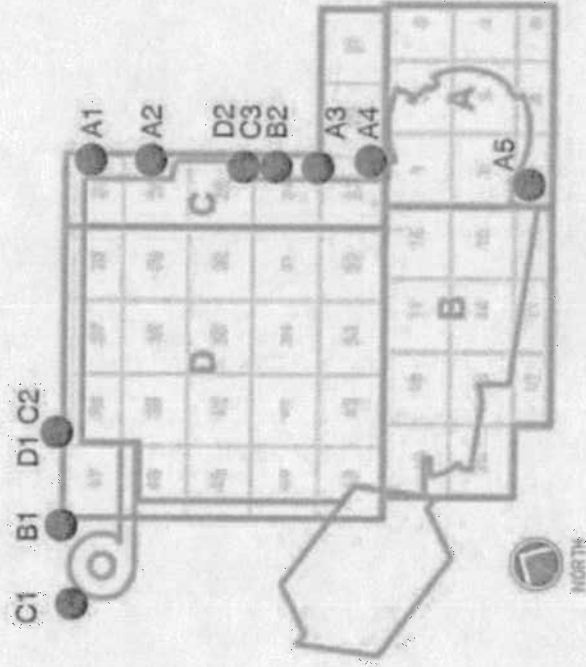

CITY OF DETROIT
DEPARTMENT OF PUBLIC WORKS
ENGINEERING DIVISION
BOUNDARY SURVEY

BOUNDARY SURVEY
CONTRACT NO.
DATE

BOUNDARY SURVEY
A1.03

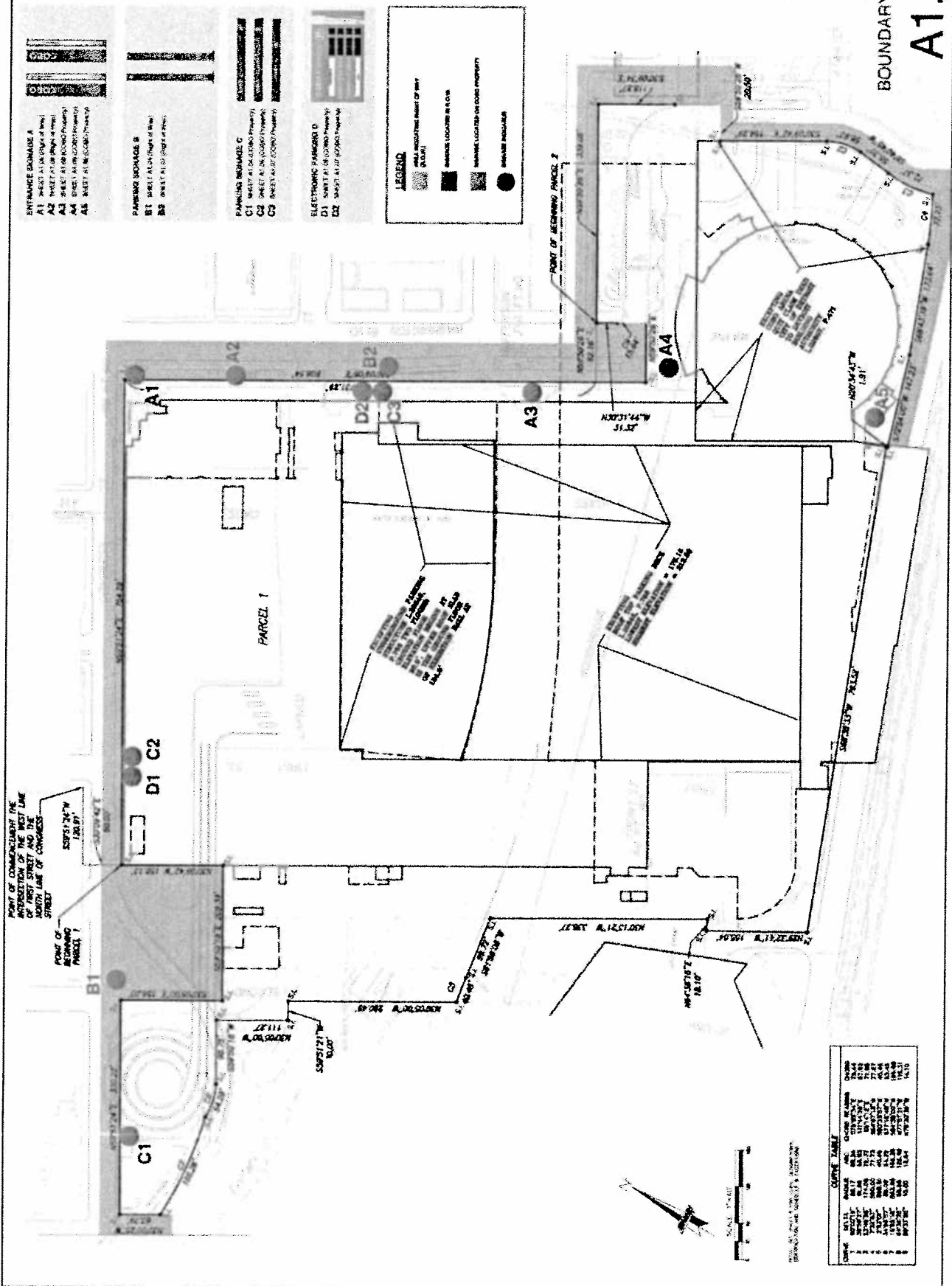

REGISTRATION SEAL
**PRELIMINARY
 NOT FOR
 CONSTRUCTION
 FOR REFERENCE
 ONLY**

SHEET NO. 13105.86
 SHEET LOCATION

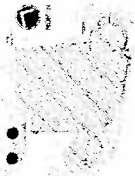

EXTERIOR WAYFINDING
 SIGNAGE LOCATION
 SITE SURVEY

SCALE AS SHOWN
 DATE 11/11/10
 DRAWN BY J. B. BROWN



PROJECT C-12
13105.86
A1.04

- ENTRANCE SIGNAGE A**
- A1 SHEET A1.08 (RIGHT OF WAY)
 - A2 SHEET A1.09 (RIGHT OF WAY)
 - A3 SHEET A1.10 (LOCAL PROPERTY)
 - A4 SHEET A1.08 (LOCAL PROPERTY)
 - A5 SHEET A1.09 (LOCAL PROPERTY)

- PARKING SIGNAGE B**
- B1 SHEET A1.08 (RIGHT OF WAY)
 - B2 SHEET A1.07 (RIGHT OF WAY)

- PARKING SIGNAGE C**
- C1 SHEET A1.08 (LOCAL PROPERTY)
 - C2 SHEET A1.08 (LOCAL PROPERTY)
 - C3 SHEET A1.07 (LOCAL PROPERTY)

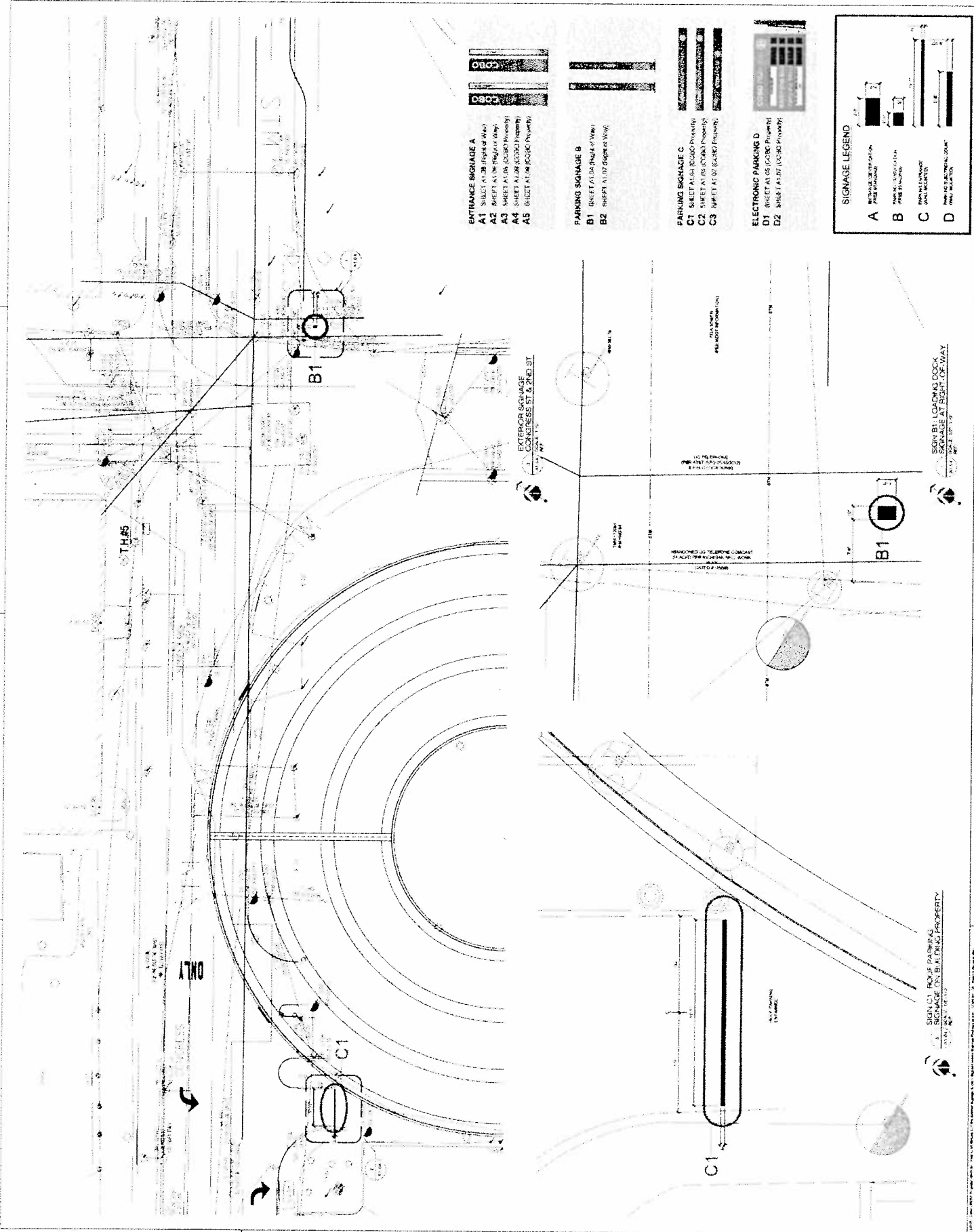
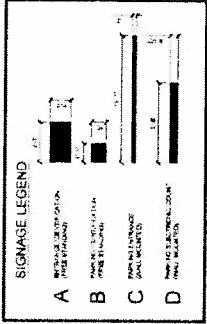
- ELECTRONIC PARKING D**
- D1 SHEET A1.08 (LOCAL PROPERTY)
 - D2 SHEET A1.07 (LOCAL PROPERTY)



REGISTRATION SEA
 PRELIMINARY
 NOT FOR
 CONSTRUCTION
 FOR REFERENCE
 ONLY

SEE MAP FOR
 SIGNAGE LOCATION

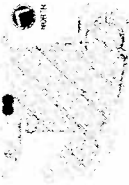

EXTERIOR WAYFINDING
 SIGNAGE LOCATION
 SITE SURVEY

SCALE: AS SHOWN
 SHEET NO. A1.05



 PROJECT C-12
 13105.86
 A1.05

- ENTRANCE SIGNAGE A**
- A1 SHEET A1.01 (Left of Way)
 - A2 SHEET A1.01 (Right of Way)
 - A3 SHEET A1.02 (COBO Property)
 - A4 SHEET A1.01 (COBO Property)
 - A5 SHEET A1.01 (COBO Property)

- PARKING SIGNAGE B**
- B1 SHEET A1.01 (Right of Way)
 - B2 SHEET A1.01 (Right of Way)

- PARKING SIGNAGE C**
- C1 SHEET A1.01 (COBO Property)
 - C2 SHEET A1.01 (COBO Property)
 - C3 SHEET A1.01 (COBO Property)

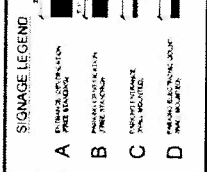
- ELECTRONIC PARKING D**
- D1 SHEET A1.01 (COBO Property)
 - D2 SHEET A1.01 (COBO Property)



EXTERIOR SIGNAGE
 CONGRESS ST & 1ST ST
 13105.86

SEE MAP FOR
 SIGNAGE LOCATION

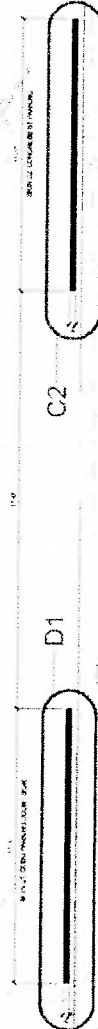

SIGN D1 & SIGN C2 CONGRESS ST PARKING
 SIGNAGE ON BUILDING PROPERTY

REGENERATION BLVD
 PRELIMINARY
 NOT FOR
 CONSTRUCTION
 FOR REFERENCE
 ONLY

SITE MAP
 SIGNAGE LOCATOR



EXTERIOR WAYFINDING
 SIGNAGE LOCATION
 SITE SURVEY

SCALE AS NOTED
 DATE

 PROJECT C-12
 13105.86
A1.06

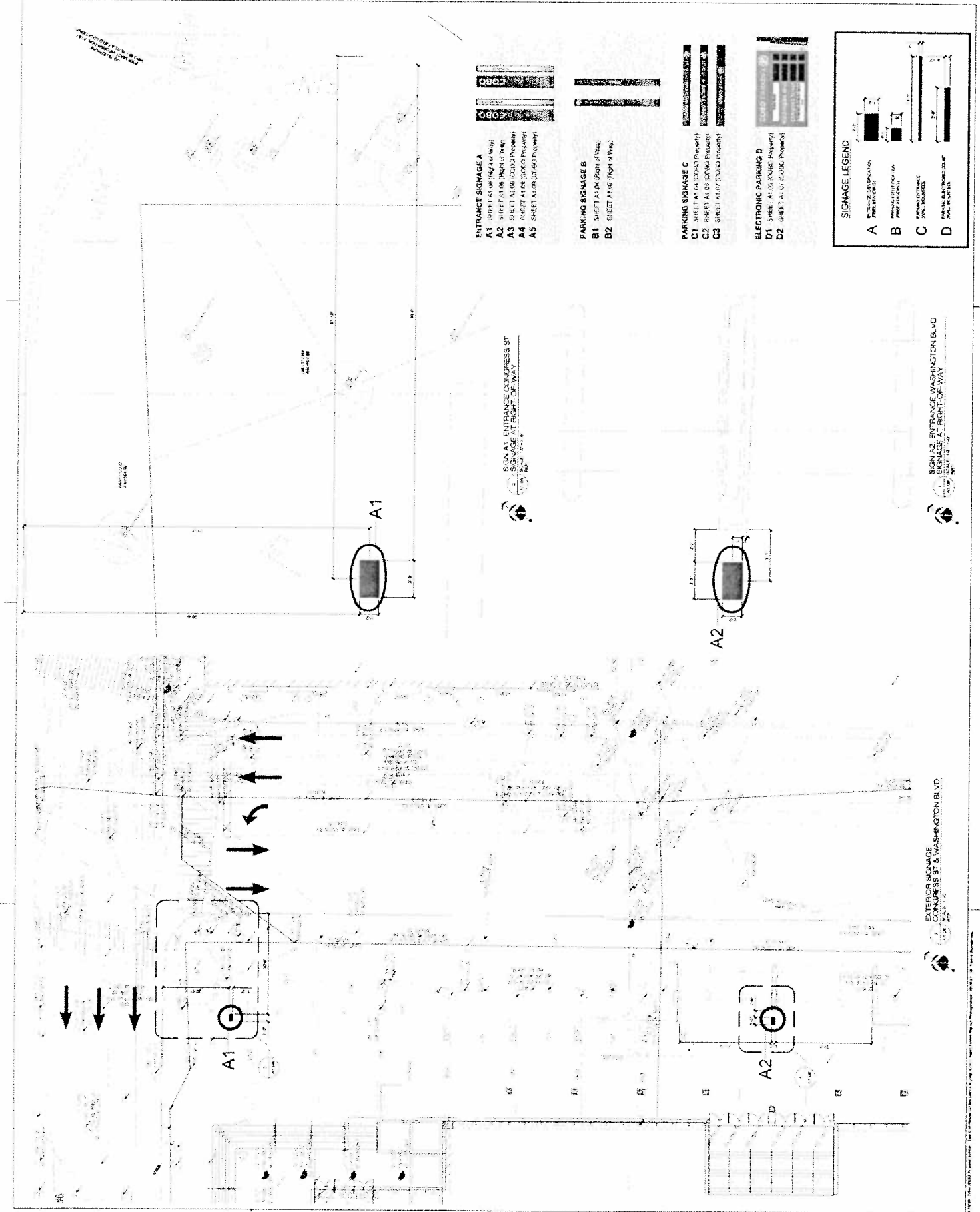

- ENTRANCE SIGNAGE A**
- A1 SHEET A1.06 (RIGHT OF WAY)
 - A2 SHEET A1.06 (RIGHT OF WAY)
 - A3 SHEET A1.06 (COMMON PROPERTY)
 - A4 SHEET A1.06 (COMMON PROPERTY)
 - A5 SHEET A1.06 (COMMON PROPERTY)

- PARKING SIGNAGE B**
- B1 SHEET A1.06 (RIGHT OF WAY)
 - B2 SHEET A1.06 (RIGHT OF WAY)

- PARKING SIGNAGE C**
- C1 SHEET A1.06 (COMMON PROPERTY)
 - C2 SHEET A1.06 (COMMON PROPERTY)
 - C3 SHEET A1.06 (COMMON PROPERTY)

- ELECTRONIC PARKING D**
- D1 SHEET A1.06 (COMMON PROPERTY)
 - D2 SHEET A1.06 (COMMON PROPERTY)

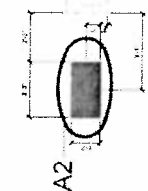
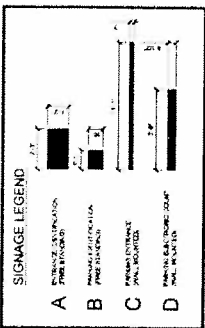

PRELIMINARY

 NOT FOR

 CONSTRUCTION

 FOR REFERENCE

 ONLY



EXTERIOR WAYFINDING

 SIGNAGE LOCATION

 SITE SURVEY

SCALE: AS NOTED

 DATE: 06.20.14

 PROJECT C-12

 13105.86

 A1.07

- ENTRANCE SIGNAGE A**
- A1 SIGN AT 100' (Right of Way)
 - A2 SIGN AT 100' (Right of Way)
 - A3 SIGN AT 100' (Right of Way)
 - A4 SIGN AT 100' (Right of Way)
 - A5 SIGN AT 100' (Right of Way)

- PARKING SIGNAGE B**
- B1 SIGN AT 100' (Right of Way)
 - B2 SIGN AT 100' (Right of Way)

- PARKING SIGNAGE C**
- C1 SIGN AT 100' (Right of Way)
 - C2 SIGN AT 100' (Right of Way)
 - C3 SIGN AT 100' (Right of Way)

- ELECTRONIC PARKING D**
- D1 SIGN AT 100' (Right of Way)
 - D2 SIGN AT 100' (Right of Way)

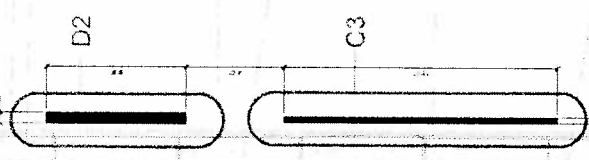
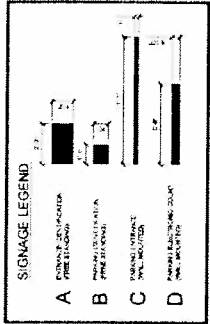

SIGN C3 & C2: PARKING AND COUNT SIGN

 SIGNAGE ON BUILDING PROPERTY



SIGN B2: WASHINGTON BLVD PARKING

 SIGNAGE AT RIGHT OF WAY

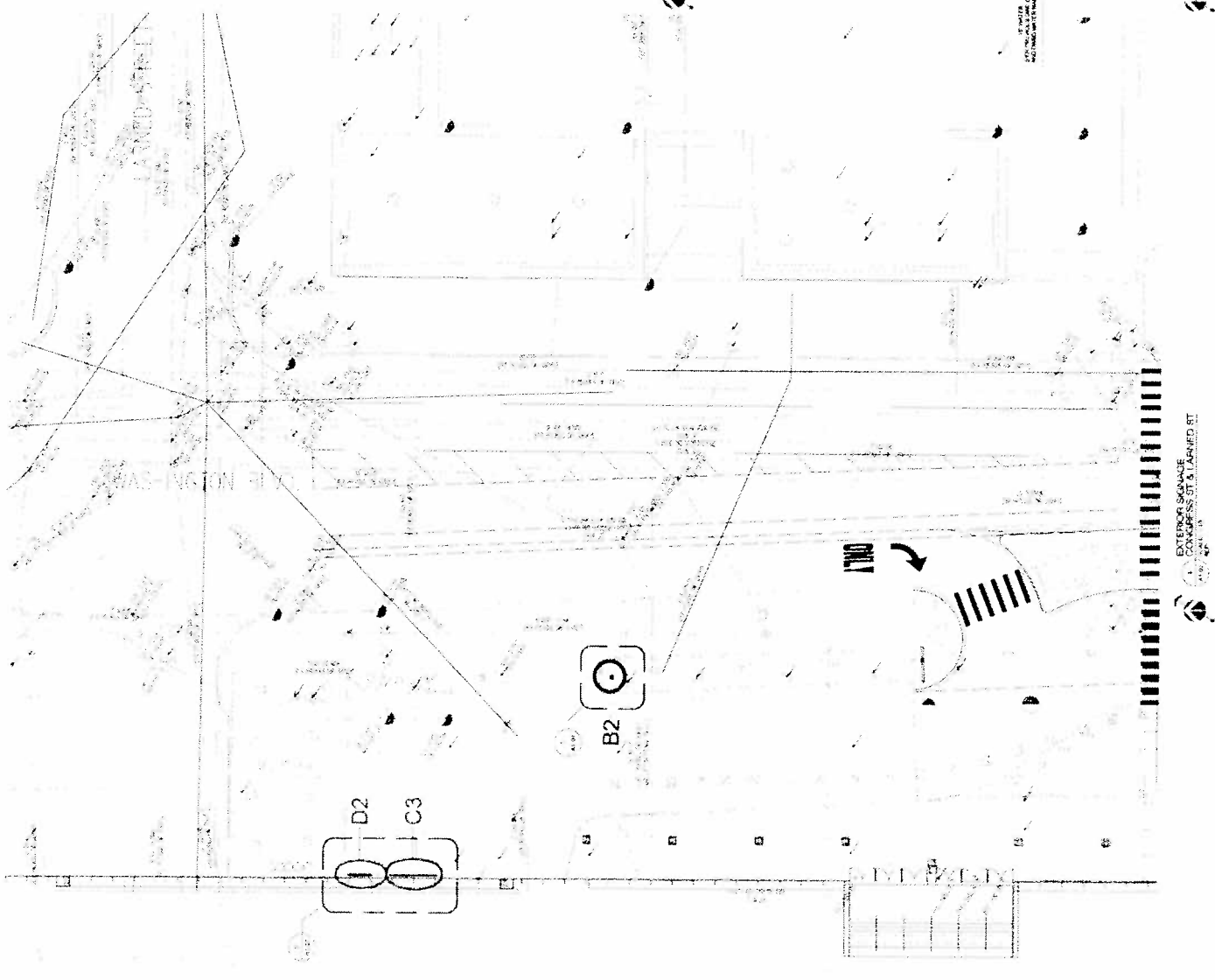

EXTERIOR SIGNAGE

 COMPASS, ST & LARNED ST

Sign Type	Exterior Free-Standing Entrance Identification
Scale	1/2" = 1'-0" (on an 11 x 17 sheet)
Color Code	MPO648 Gray Meter MPO823 Iron Age MPO388 Verton White Frosted Acrylic
Notes	This drawing is design intent only. Fabricator is responsible for fabrication details. Any changes in design, materials, fabrication or other details must be approved by Corbin Design and the representative of the Cobo Convention Center.
Date	10.01.12 Revised 02.06.14 Design intent
Client	COBO Convention Center Detroit, Michigan
SIGNAGE DETAIL A1.10	

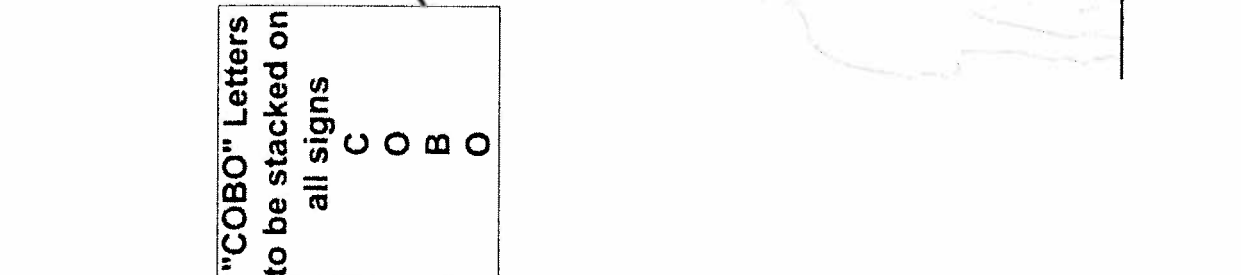
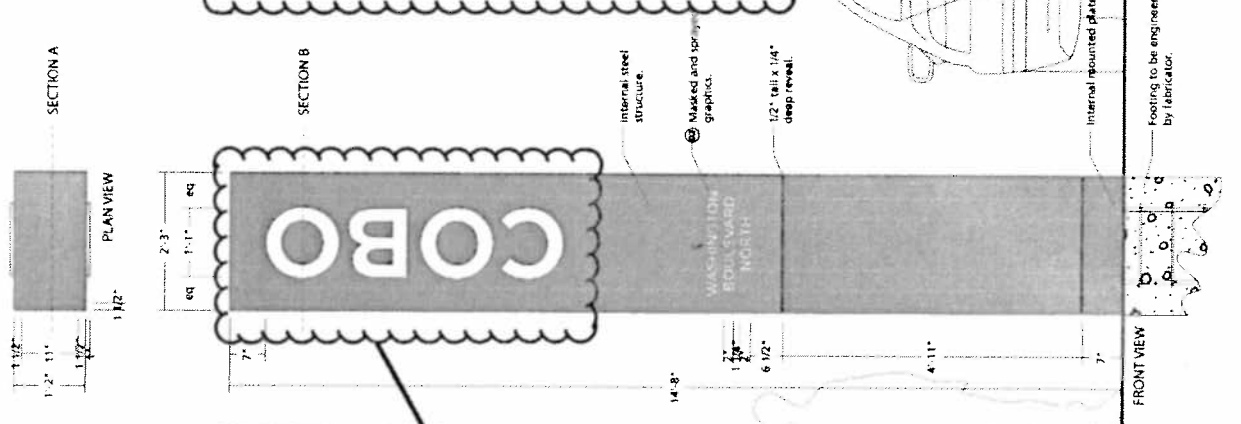
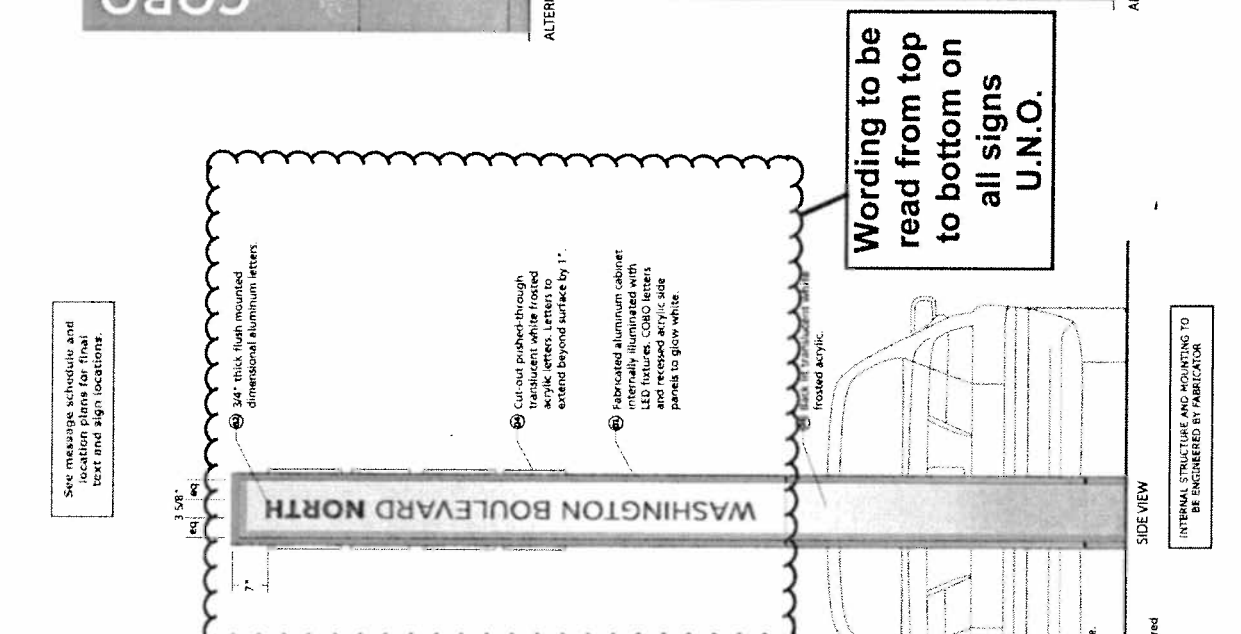
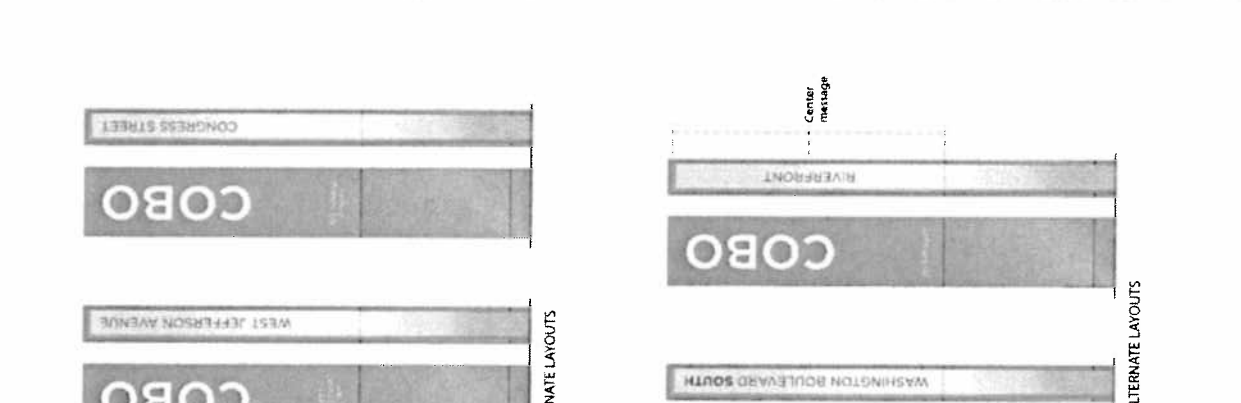

**"COBO" Letters
to be stacked on
all signs**

C
O
B
O

**Wording to be
read from top
to bottom on
all signs
U.N.O.**

INTERNAL STRUCTURE AND MOUNTING TO
BE ENGINEERED BY FABRICATOR

Footings to be engineered
by fabricator.

ALTERNATE LAYOUTS

ALTERNATE LAYOUTS

SIDE VIEW

FRONT VIEW

See message schedule and
location plans for final
text and sign locations.

Sign Type:
Ix-3
 Free-Standing
 Parking Identification

Scale:
 1/2" = 1'-0"
 (on an 11 x 17 sheet)

Color Code:

- MP05648 Gray Matte
- MP48029 Iron Age
- MP46386 Varian White
- Frosted Acrylic
- Parking Blue

corbin design

Notes:
 This drawing is design-intent only. Fabricator is responsible for fabrication and final level of quality. Any changes in design or materials, methods, or other details must be approved by Corbin Design and the representatives of the Cobo Convention Center.

Date:
 05.13.14 Preliminary
 04.06.14 Design Intent

Client:
 Cobo

Project:
 Cobo
 Convention Center
 Detroit, Michigan

SIGNAGE DETAIL
A1.11



ALTERNATE LAYOUT

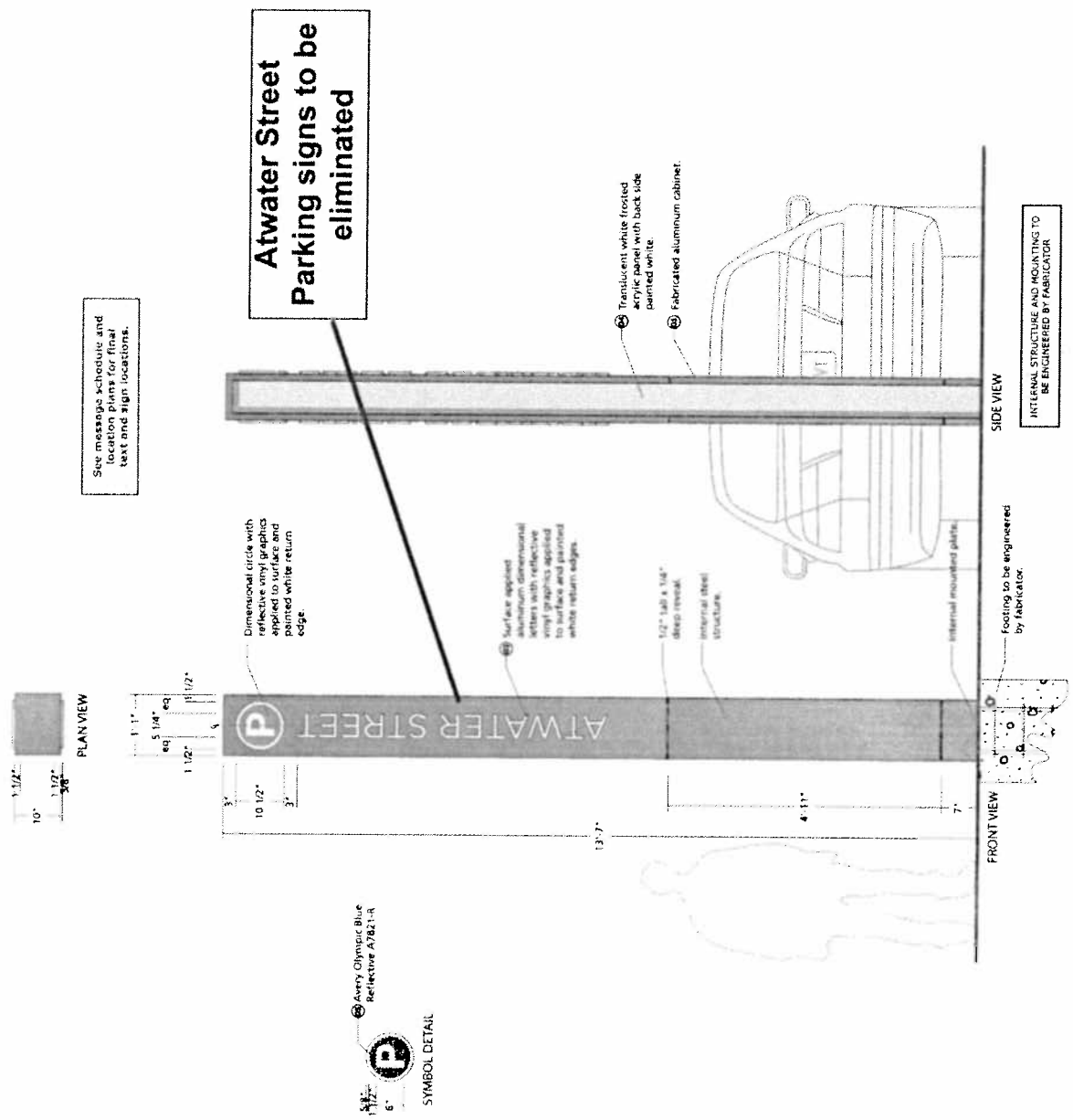

Sign Type

IX-3

Wall Mounted Parking
Entrance Identification

Scale

1/2" = 1'-0"
(on an 11 x 17 sheet)

Color Code

- HPO646 Gray Matter
- HPO8020 Iron Age
- HPI33360 Venison White
- Frosted Acrylic
- Parking Blue

corbindesign

NOTES

This drawing is design-intent only. It is not a contract document. It is subject to change without notice and overall level of quality. Any changes in design, material, fabrication method or other details must be approved by the Designer. This drawing is the property of the Cobo Convention Center.

DATE

10.01.12 Preliminary
02.06.14 Design intent

Client

COBO
Convention Center
Detroit, Michigan

SIGNAGE DETAIL

A1.12



ALTERNATE LAYOUTS



SYMBOL DETAIL

See message schedule and location plans for final text and sign locations.

INTERNAL STRUCTURE AND MOUNTING TO BE ENGINEERED BY FABRICATOR



PLAN VIEW

**Atwater Street
Parking signs to
be eliminated**



FRONT VIEW

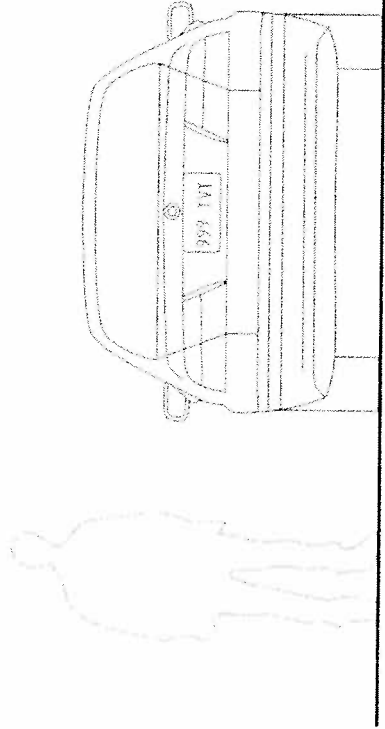

Direct-View LED Traffic Controller
SA3486RGGGG-#978

PRODUCT NUMBER
 2870

CABINET DIMENSIONS
 11 1/2" H x 15 1/2" W x 3 1/2" D

ILLUMINATION SOURCE
 100% LED
 100% LED
 100% LED
 100% LED

ELECTRICAL
 120V AC
 100W
 100W
 100W
 100W

CONSTRUCTION
 100% LED
 100% LED
 100% LED
 100% LED

FINISH
 100% LED
 100% LED
 100% LED
 100% LED

MESSAGE	COLOR	HEIGHT	AMP
COBO Arena	White reflective	5.0"	2.06
COBO Hall	White reflective	5.0"	2.06
COBO Rooftop	White reflective	5.0"	2.06
Detroit Hall	White reflective	5.0"	2.06

Direct-View LED Traffic Controller
SA3486RGGGG-#978

PRODUCT NUMBER
 2870

CABINET DIMENSIONS
 11 1/2" H x 15 1/2" W x 3 1/2" D

ILLUMINATION SOURCE
 100% LED
 100% LED
 100% LED
 100% LED

ELECTRICAL
 120V AC
 100W
 100W
 100W
 100W

CONSTRUCTION
 100% LED
 100% LED
 100% LED
 100% LED

FINISH
 100% LED
 100% LED
 100% LED
 100% LED

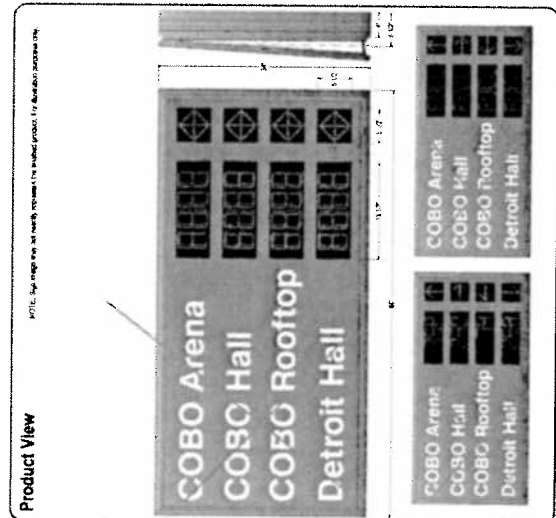

Sign Type
Electronic Parking Sign

four (4) total for
 Roof, Congress, &
 Washington

Scale
 NOT TO SCALE

Color Code
 #999999 Grey Matter
 #666029 Iron Age
 #F28384 Vertebrae White
 #FFFFFF Freshed Acrylic
 #0000FF Parking Blue

corbindesign

NOTES
 This drawing is a design-intent only. Fabricator is responsible for fabrication and overall level of quality. Any changes or substitutions must be approved by Corbin Design and the representatives of the Cobo Convention Center.

DATE Description
 02.06.14 Fabrication Design Intent

Client
COBO
 Convention Center
 Detroit, Michigan

SIGNAGE DETAIL
A1.13

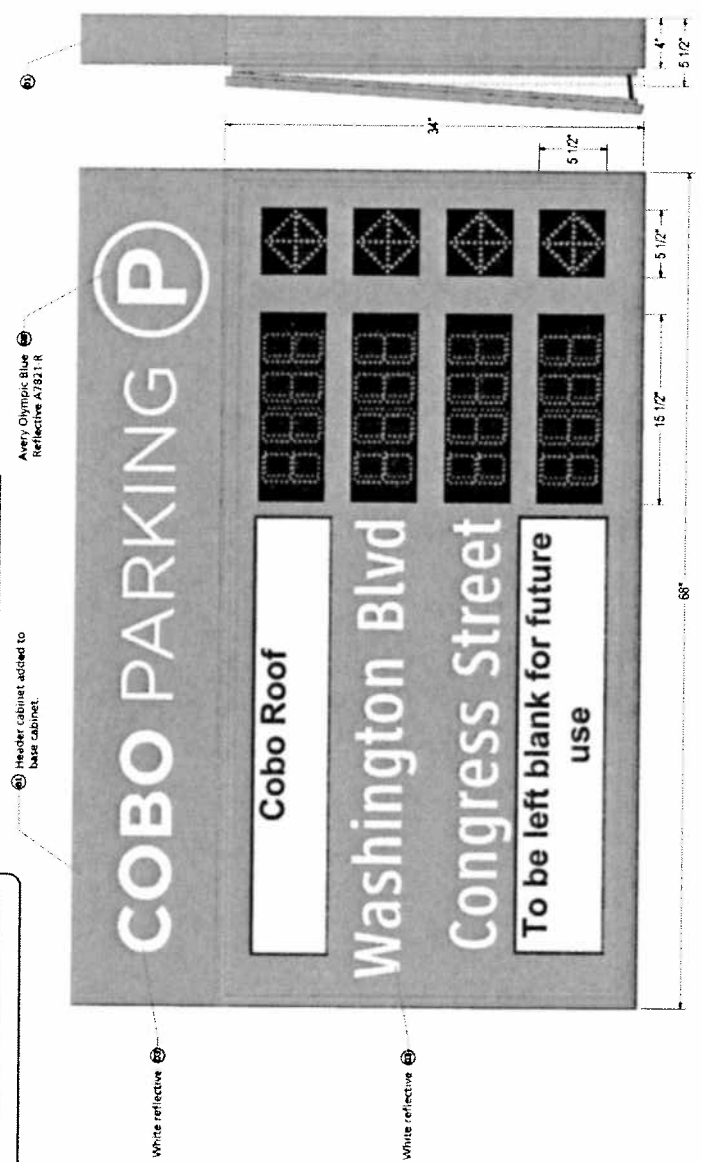

ORIGINAL DESIGN AND LAYOUT

PROPOSED DESIGN CHANGES

Header cabinet added to base cabinet

Avery Olympic Blue Reflective A7921 R

White reflective

White reflective

