

2013-11-23
ced/pet

City of Detroit
City Engineering Division, Department of Public Works
Survey Bureau

NOTICE OF PROPOSED CHANGE IN PROPERTY

Date: 09/11/2014

Petition: x381

- AT&T Telecommunication
- Cable Television (CATV)
- Detroit Edison (DTE)
- Michigan Consolidated Gas (DTE)
- Fire Department
- Planning & Development Department
- Public Lighting Dept. - Communication Division
- Public Lighting Dept. - Overhead Line Division
- Public Lighting Dept. - Underground Division
- Police Department
- Recreation Department
- Sanitation Division, DPW
- Street Design Bureau, DPW
- Street Maintenance Division, DPW
- Street and Traffic Division, DPW
- Water and Sewerage Dept. - Sewer Design
- Water and Sewerage Dept. - Water Design
- Vacation
- Conversion to Easement
- Dedication
- Encroachment
- Temporary Closing
- Berm Use

A petition drawing is attached. Property shown on the attached print is proposed to be changed as indicated.

Kindly report (using the back of this sheet) the nature of your services (if any) affected by the proposed change and the estimated costs of removing and rerouting such services (if necessary).

Please return one copy to City Engineering Division, DPW. Retain one copy and print for you file.

Alfred Jordan, Director, Department of Public Works

By: Richard Doherty, CED DPW
Head Engineer



TO: City Engineering Division, DPW
65 Cadillac Square, Suite 900
Detroit, Michigan 48226-2873
Survey Bureau: 313-224-3970

x381

The proposed change in property (referred to on the other side of this sheet) would affect our services as follows:

- Not Involved
- Involved; but asking you to hold action on this petition until further notice.
- Involved; but no objections to the property change .
- Involved; but no objections to the property change...provided as easement of the full width of the public right-of-way (street, alley or other public place) is reserved.
- Involved; the nature of our services, and the estimated costs of removing and/or rerouting such services are:

DETROIT POLICE DEPT 3RD DCT
(Utility or City Department)

CHRIE GIBSON 4649
By

POLICE OFFICER CODE ENFORCEMENT
Title

10-06-14
Date

313 596-1205
Area code - Telephone number

PETITION NO. 381
 GIFFELS WEBSTER
 28 W. ADAMS, SUITE 1200
 DETROIT, MICHIGAN 48226
 C/O JAMES FOSTER
 PHONE NO. 313 962-4442



"REVISED"

PRENTIS AVE. 60 FT. WD.

THIRD AVE. 70 FT. WD.

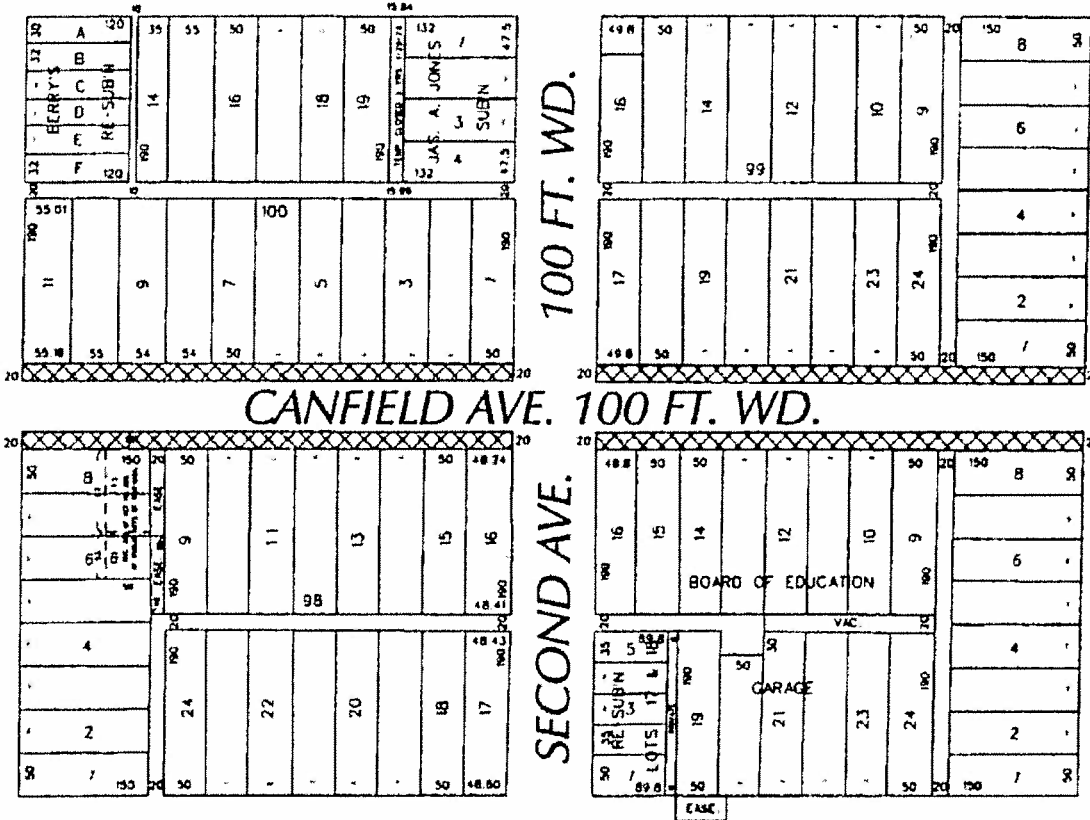

CANFIELD AVE. 100 FT. WD.

SECOND AVE. 100 FT. WD.

CASS AVE. 80 FT. WD.

WILLIS AVE. 100 FT. WD.



- REQUESTED VACATION

(FOR OFFICE USE ONLY)

CARTO 30 E

B				
A	REVISIONS	DATE	BY	APPROVED
	1		WLW	
	2			
	3			
	4			
	5			
	6			
	7			
	8			
	9			
	10			
	11			
	12			
	13			
	14			
	15			
	16			
	17			
	18			
	19			
	20			
	21			
	22			
	23			
	24			
	25			
	26			
	27			
	28			
	29			
	30			
	31			
	32			
	33			
	34			
	35			
	36			
	37			
	38			
	39			
	40			
	41			
	42			
	43			
	44			
	45			
	46			
	47			
	48			
	49			
	50			
	51			
	52			
	53			
	54			
	55			
	56			
	57			
	58			
	59			
	60			
	61			
	62			
	63			
	64			
	65			
	66			
	67			
	68			
	69			
	70			
	71			
	72			
	73			
	74			
	75			
	76			
	77			
	78			
	79			
	80			
	81			
	82			
	83			
	84			
	85			
	86			
	87			
	88			
	89			
	90			
	91			
	92			
	93			
	94			
	95			
	96			
	97			
	98			
	99			
	100			

REQUEST TO VACATE
 A PORTION OF CANFIELD AVE.,
 40 FT. WD. IN THE BLOCK BOUND BY
 THIRD, PRENTIS, CASS
 AND WILLIS AVE.

CITY OF DETROIT CITY ENGINEERING DEPARTMENT SURVEY BUREAU	
JOB NO.	01-01
DRWG. NO.	X 381

girfais
webster

City of Webster
Planning & Zoning
315 North Main
Webster, MO 64489
Phone: (660) 646-3333
Fax: (660) 646-3334
www.cityofwebster.com

Scale: 1" = 40'
North Arrow

Area	Acres
Lot 1	0.12
Lot 2	0.12
Lot 3	0.12
Lot 4	0.12
Lot 5	0.12
Lot 6	0.12
Lot 7	0.12
Lot 8	0.12
Lot 9	0.12
Lot 10	0.12
Lot 11	0.12
Lot 12	0.12
Lot 13	0.12
Lot 14	0.12
Lot 15	0.12
Lot 16	0.12
Lot 17	0.12
Lot 18	0.12
Lot 19	0.12
Lot 20	0.12
Lot 21	0.12
Lot 22	0.12
Lot 23	0.12
Lot 24	0.12
Lot 25	0.12
Lot 26	0.12
Lot 27	0.12
Lot 28	0.12
Lot 29	0.12
Lot 30	0.12
Lot 31	0.12
Lot 32	0.12
Lot 33	0.12
Lot 34	0.12
Lot 35	0.12
Lot 36	0.12
Lot 37	0.12
Lot 38	0.12
Lot 39	0.12
Lot 40	0.12
Lot 41	0.12
Lot 42	0.12
Lot 43	0.12
Lot 44	0.12
Lot 45	0.12
Lot 46	0.12
Lot 47	0.12
Lot 48	0.12
Lot 49	0.12
Lot 50	0.12
Lot 51	0.12
Lot 52	0.12
Lot 53	0.12
Lot 54	0.12
Lot 55	0.12
Lot 56	0.12
Lot 57	0.12
Lot 58	0.12
Lot 59	0.12
Lot 60	0.12
Lot 61	0.12
Lot 62	0.12
Lot 63	0.12
Lot 64	0.12
Lot 65	0.12
Lot 66	0.12
Lot 67	0.12
Lot 68	0.12
Lot 69	0.12
Lot 70	0.12
Lot 71	0.12
Lot 72	0.12
Lot 73	0.12
Lot 74	0.12
Lot 75	0.12
Lot 76	0.12
Lot 77	0.12
Lot 78	0.12
Lot 79	0.12
Lot 80	0.12
Lot 81	0.12
Lot 82	0.12
Lot 83	0.12
Lot 84	0.12
Lot 85	0.12
Lot 86	0.12
Lot 87	0.12
Lot 88	0.12
Lot 89	0.12
Lot 90	0.12
Lot 91	0.12
Lot 92	0.12
Lot 93	0.12
Lot 94	0.12
Lot 95	0.12
Lot 96	0.12
Lot 97	0.12
Lot 98	0.12
Lot 99	0.12
Lot 100	0.12

City Clerk
City Auditor
City Manager
City Council

City of Webster
Planning & Zoning
315 North Main
Webster, MO 64489
Phone: (660) 646-3333
Fax: (660) 646-3334
www.cityofwebster.com

City Clerk
City Auditor
City Manager
City Council

City of Webster
Planning & Zoning
315 North Main
Webster, MO 64489
Phone: (660) 646-3333
Fax: (660) 646-3334
www.cityofwebster.com

City Clerk
City Auditor
City Manager
City Council



CITY CLERK 22 MAR 20 - 4 PM 189

189