

City of Detroit
**City Engineering Division, Department of Public Works
Survey Bureau**

NOTICE OF PROPOSED CHANGE IN PROPERTY

Third Notice 10/8/14

Second Notice 9/3/14

Date: 08/04/2014

Petition: x359

- | | |
|---|---|
| <input type="checkbox"/> AT&T Telecommunication | |
| <input type="checkbox"/> Cable Television (CATV) | <input type="checkbox"/> Vacation |
| <input type="checkbox"/> Detroit Edison (DTE) | |
| <input type="checkbox"/> Michigan Consolidated Gas (DTE) | <input type="checkbox"/> Conversion to Easement |
| <input type="checkbox"/> Fire Department | <input type="checkbox"/> Dedication |
| <input type="checkbox"/> Planning & Development Department | |
| <input type="checkbox"/> Public Lighting Dept. - Communication Division | <input type="checkbox"/> Encroachment |
| <input type="checkbox"/> Public Lighting Dept. - Overhead Line Division | |
| <input type="checkbox"/> Public Lighting Dept. - Underground Division | <input checked="" type="checkbox"/> Temporary Closing |
| <input type="checkbox"/> Police Department | |
| <input type="checkbox"/> Recreation Department | <input type="checkbox"/> Berm Use |
| <input type="checkbox"/> Sanitation Division, DPW | |
| <input type="checkbox"/> Street Design Bureau, DPW | |
| <input checked="" type="checkbox"/> Street Maintenance Division, DPW | |
| <input type="checkbox"/> Street and Traffic Division, DPW | |
| <input type="checkbox"/> Water and Sewerage Dept. - Sewer Design | |
| <input type="checkbox"/> Water and Sewerage Dept. - Water Design | |

A petition drawing is attached. Property shown on the attached print is proposed to be changed as indicated.

Kindly report (using the back of this sheet) the nature of your services (if any) affected by the proposed change and the estimated costs of removing and rerouting such services (if necessary).

Please return one copy to City Engineering Division, DPW. Retain one copy and print for you file.

Alfred Jordan, Director, Department of Public Works

By: Richard Doherty, CED DPW
Head Engineer

**TO: City Engineering Division, DPW
65 Cadillac Square, Suite 900
Detroit, Michigan 48226-2873
Survey Bureau: 313-224-3970**

x359

The proposed change in property (referred to on the other side of this sheet) would affect our services as follows:

- Not Involved
- Involved; but asking you to hold action on this petition until further notice.
- Involved; but no objections to the property change .
- Involved; but no objections to the property change...provided as easement of the full width of the public right-of-way (street, alley or other public place) is reserved.
- Involved; the nature of our services, and the estimated costs of removing and/or rerouting such services are:

DPW / Street Maintenance Division
(Utility or City Department)

Dhaval Patel
By

Supervisor
Title

10/9/2014
Date

313.224.0021
Area code – Telephone number

PETITION NO. 359
 DETROIT HOUSING COMMISSION
 1301 E. JEFFERSON AVE.
 DETROIT, MICHIGAN 48207
 C/O MARTINA J. ORANGE
 PHONE NO. 313 877-8000



JOY RD. 120 FT. WD.

SOUTHFIELD FREEWAY

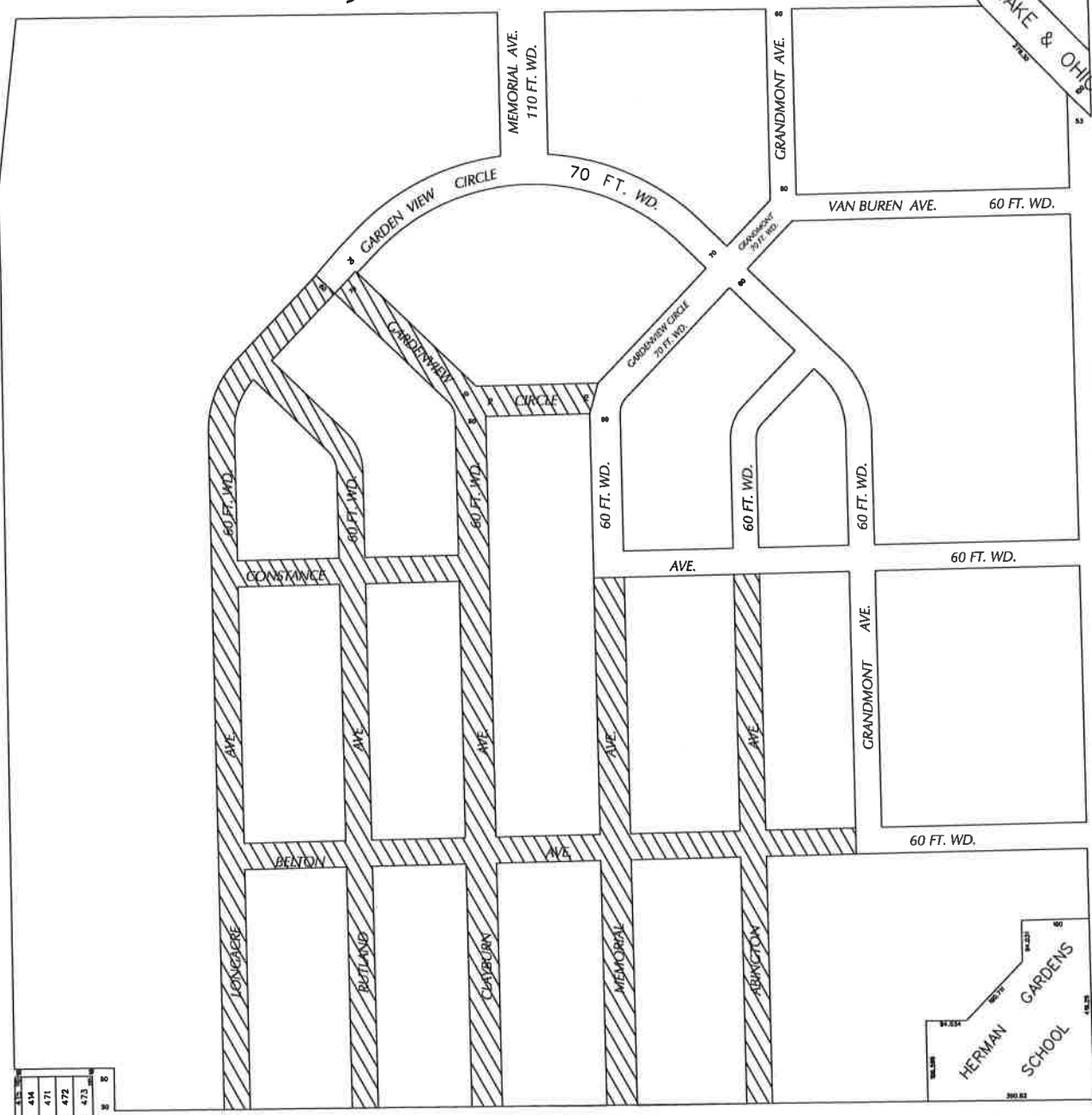

CHESAPEAKE & OHIO R.R.

ASBURY PARK AVE. 86 FT. WD.

TIREMAN AVE. 103 FT. WD.

43	44	45	46	47	48	49	50
43	44	45	46	47	48	49	50

WEST HAVEN SUB NO. 1

- REQUESTED TEMPORARY STREET CLOSURE
 (FOR OFFICE USE ONLY)

CARTO 99 B

B					
A					
DESCRIPTION	DRWN	CHKD	APPD	DATE	
REVISIONS					
DRAWN BY	WLW		CHECKED		
DATE	08-04-14		APPROVED		

REQUEST TO TEMPORARILY CLOSE
 VARIOUS PUBLIC STREET, VARIOUS WD.
 IN THE BLOCK BOUND BY
 JOY RD., ASBURY PARK, TIREMAN AVE.
 AND SOUTHFIELD FWY.

CITY OF DETROIT	
CITY ENGINEERING DEPARTMENT	
SURVEY BUREAU	
JOB NO.	01-01
DRWG. NO.	X 359

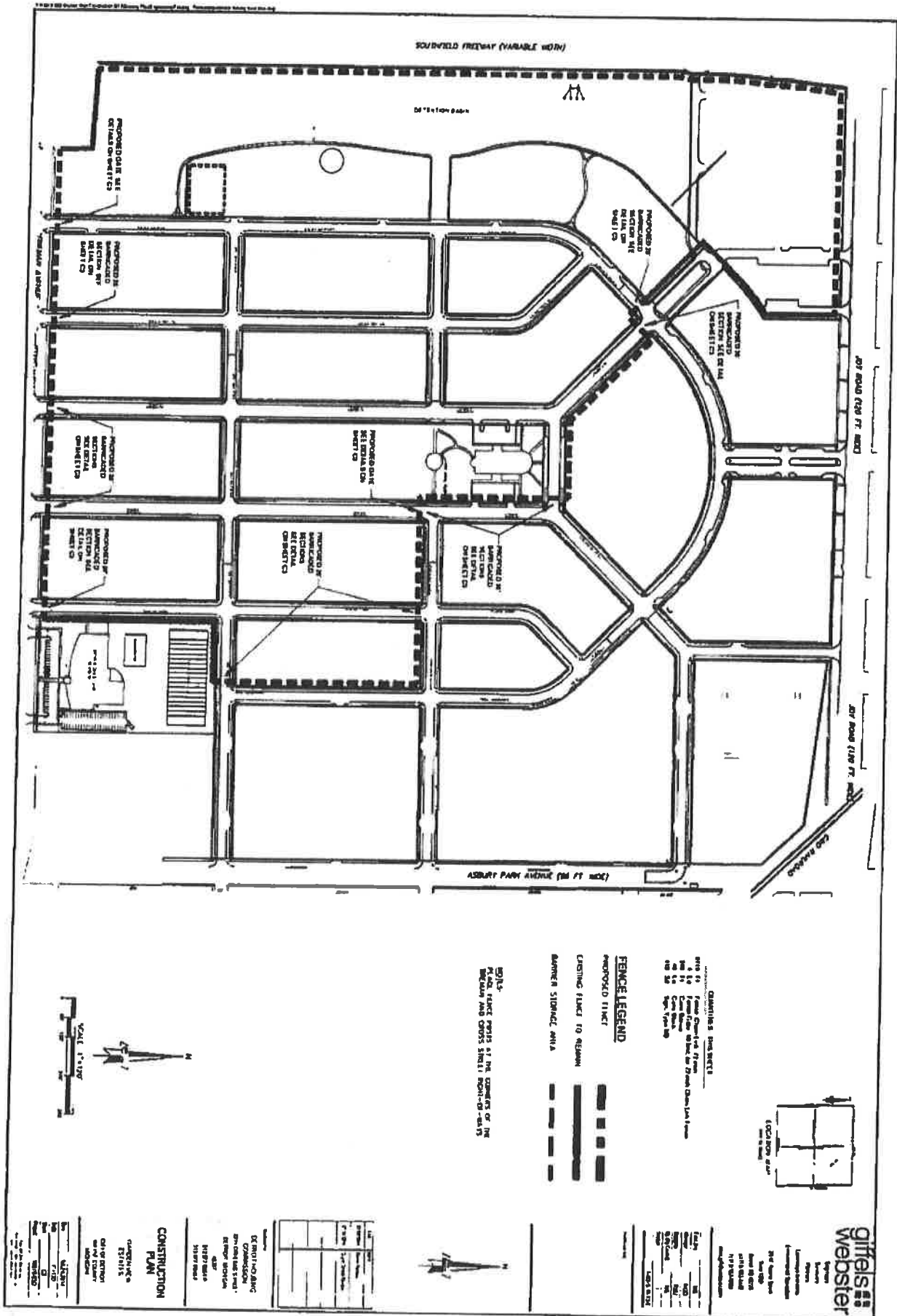

Professional Seal
Civil Engineer
No. 1112
Expiration Date
01/01/2014

Project Name	
Project No.	
Client Name	
Client Address	
Client Phone	
Client Email	
Client Website	
Client Logo	
Client Seal	



DATE OF ISSUE
COMMISSION
PROJECT NO.
PROJECT NAME

DETAILS

OWNER
ESTIMATOR
ENGINEER
ARCHITECT

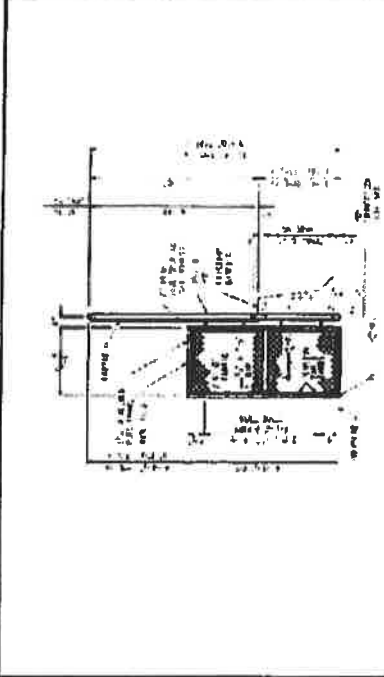

ANTI-CLIMB BRIZLID/POST DETAIL

FENCING FOR PEDESTRIAN STRUCTURE EXISTING TYPE 4 & 6 BARRIER

SECTION 01 60 00 - FENCING
B-36-D
1 of 1

DESCRIPTION:
FENCING FOR PEDESTRIAN STRUCTURE EXISTING TYPE 4 & 6 BARRIER. SEE SPECIFICATIONS FOR MATERIALS AND INSTALLATION. SEE SECTION 01 60 00 - FENCING FOR MATERIALS AND INSTALLATION. SEE SECTION 01 60 00 - FENCING FOR MATERIALS AND INSTALLATION. SEE SECTION 01 60 00 - FENCING FOR MATERIALS AND INSTALLATION.

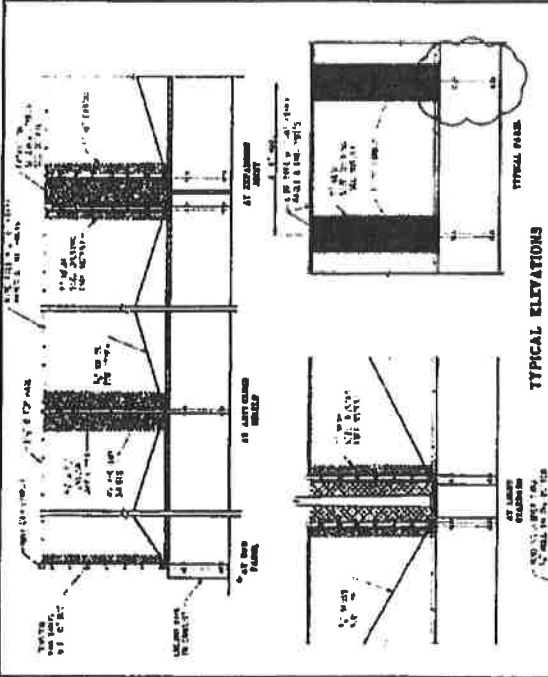

TYPICAL ELEVATIONS

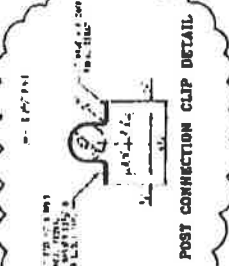

POST CONNECTION CLIP DETAIL

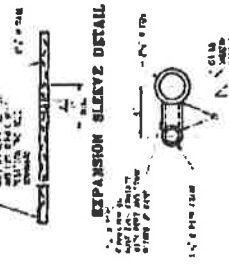

EXPANSION SLEEVE DETAIL

PIPE CONNECTOR DETAIL

FENCING FOR PEDESTRIAN STRUCTURE EXISTING TYPE 4 & 6 BARRIER

SECTION 01 60 00 - FENCING
B-36-D
1 of 1

DESIGNED BY: [Signature]
CHECKED BY: [Signature]
DATE: [Date]

NOTE:
ONLY REFERENCE POST CONNECTION CLIP DETAIL AND RELEVANT NOTES.

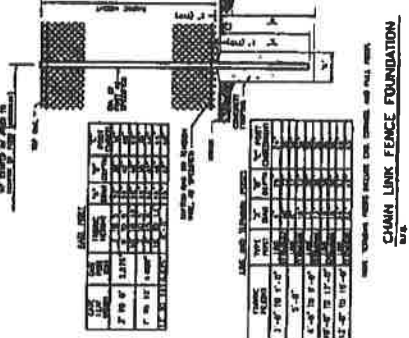
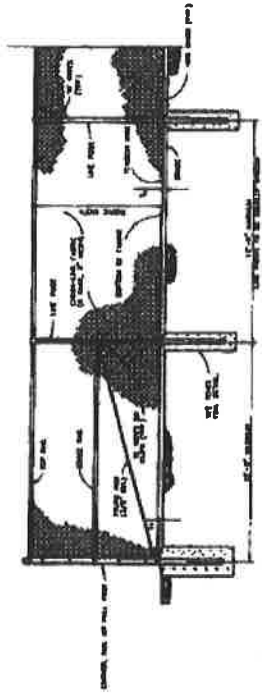
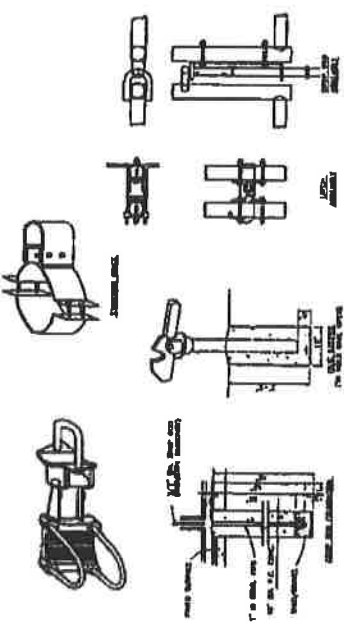
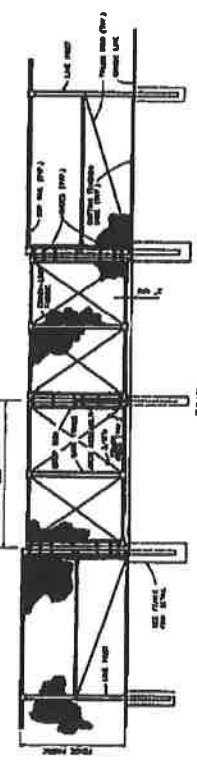

NOTES

- CHAIN LINK FENCE MATERIALS SHALL BE STEEL AND CONFORM TO THE REQUIREMENTS OF THE CURRENT STANDARD SPECIFICATIONS.
- WELDED BRACKLE POSTS SHALL BE PLACED ON ALL CORNERS AND ALL ENDS OF EACH END OF EACH SECTION. BRACKLE POSTS SHALL BE 1 1/2" DIA. 120" AND SHALL BE HEAVIER THAN THE 1 1/2" DIA. 72" POSTS.
- FENCE FABRIC SHALL BE SECURELY FASTENED TO TOP RAIL WITH FASTENERS SPACED 2' ON CENTER. FASTENERS SHALL BE 1 1/4" DIA. GALV. WIRE AND SHALL BE 11 GAUGE AND MATCH FABRIC CORN.
- POSTS SHALL BE SPACED TO MATCH TOP AND BOTTOM RAILS. TOP AND BOTTOM RAILS OF FENCE FABRIC SHALL HAVE A TWISTED AND BARRED FINISH. ALTERNATE POST SECTIONS MAY BE SUBMITTED FOR APPROVAL BY THE ENGINEER.
- ALL POSTS SHALL BE PLACED 10'-0" FROM THE PROPERTY LINE AND SHALL BE SET IN A 12" DIA. CONCRETE FOUNDATION.

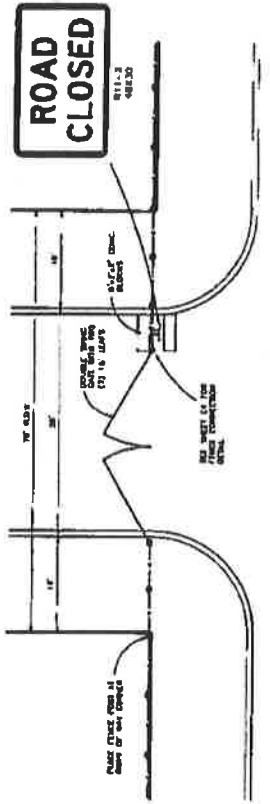

NOTES

- FOR 10' GATE, 20' WIDE DOUBLE BARRICADE SHALL HAVE TWO (2) 10' GATE SWINGING GATE MECHANISMS FOR BARRICADE SECTIONS (WHICH IS 20').
- SEE PLAN FOR GATE ATTACHMENT AND THE (2) 10' GATE MECHANISMS TO CORNER OF ROAD FOR THE 10' GATE AND THE (2) 10' GATE MECHANISMS TO CORNER OF ROAD FOR THE 20' GATE AND THE (2) 10' GATE MECHANISMS TO CORNER OF ROAD FOR THE 20' GATE.
- THESE MECHANISMS SHALL BE SET IN 12" DIA. CONCRETE FOUNDATIONS.
- SECTION 111.1 SHALL BE ADHERED TO FOR ALL DIMENSIONS AND MATERIALS.

DETAILS

DATE: 07-29-2014
DRAWN BY: [NAME]
CHECKED BY: [NAME]

LIST A-B

NO.	DESCRIPTION	QTY.	UNIT
1	CHAIN-LINK FENCE (10' DIA.)	100	L.F.
2	CHAIN-LINK FENCE (12' DIA.)	100	L.F.
3	POSTS (1 1/2" DIA.)	100	EA.
4	POSTS (1 1/2" DIA.)	100	EA.
5	POSTS (1 1/2" DIA.)	100	EA.
6	POSTS (1 1/2" DIA.)	100	EA.
7	POSTS (1 1/2" DIA.)	100	EA.
8	POSTS (1 1/2" DIA.)	100	EA.
9	POSTS (1 1/2" DIA.)	100	EA.
10	POSTS (1 1/2" DIA.)	100	EA.
11	POSTS (1 1/2" DIA.)	100	EA.
12	POSTS (1 1/2" DIA.)	100	EA.
13	POSTS (1 1/2" DIA.)	100	EA.
14	POSTS (1 1/2" DIA.)	100	EA.
15	POSTS (1 1/2" DIA.)	100	EA.
16	POSTS (1 1/2" DIA.)	100	EA.
17	POSTS (1 1/2" DIA.)	100	EA.
18	POSTS (1 1/2" DIA.)	100	EA.
19	POSTS (1 1/2" DIA.)	100	EA.
20	POSTS (1 1/2" DIA.)	100	EA.

