

4 PAGES

City of Detroit
City Engineering Division, Department of Public Works
Survey Bureau

NOTICE OF PROPOSED CHANGE IN PROPERTY

Date: 08/04/2014Petition: x359

- | | |
|--|---|
| <input type="checkbox"/> AT&T Telecommunication | |
| <input type="checkbox"/> Cable Television (CATV) | <input type="checkbox"/> Vacation |
| <input type="checkbox"/> Detroit Edison (DTE) | |
| <input type="checkbox"/> Michigan Consolidated Gas (DTE) | <input type="checkbox"/> Conversion to Easement |
| <input type="checkbox"/> Fire Department | <input type="checkbox"/> Dedication |
| <input type="checkbox"/> Planning & Development Department | |
| <input checked="" type="checkbox"/> Public Lighting Dept. - Communication Division | <input type="checkbox"/> Encroachment |
| <input checked="" type="checkbox"/> Public Lighting Dept. - Overhead Line Division | |
| <input checked="" type="checkbox"/> Public Lighting Dept. - Underground Division | <input checked="" type="checkbox"/> Temporary Closing |
| <input type="checkbox"/> Police Department | |
| <input type="checkbox"/> Recreation Department | <input type="checkbox"/> Berm Use |
| <input type="checkbox"/> Sanitation Division, DPW | |
| <input type="checkbox"/> Street Design Bureau, DPW | |
| <input type="checkbox"/> Street Maintenance Division, DPW | |
| <input type="checkbox"/> Street and Traffic Division, DPW | |
| <input type="checkbox"/> Water and Sewerage Dept. - Sewer Design | |
| <input type="checkbox"/> Water and Sewerage Dept. - Water Design | |

A petition drawing is attached. Property shown on the attached print is proposed to be changed as indicated.

Kindly report (using the back of this sheet) the nature of your services if any) affected by the proposed change and the estimated costs of removing and rerouting such services (if necessary).

Please return one copy to City Engineering Division, DPW. Retain one copy and print for you file.

Alfred Jordan, Director, Department of Public Works

By: Richard Doherty, CED DPW
 Head Engineer

TO: City Engineering Division, DPW
65 Cadillac Square, Suite 900
Detroit, Michigan 48226-2873
Survey Bureau: 313-224-3970

x359

The proposed change in property (referred to on the other side of this sheet) would affect our services as follows:

- Not Involved
- Involved; but asking you to hold action on this petition until further notice.
- Involved; but no objections to the property change .
- Involved; but no objections to the property change... provided as easement of the full width of the public right-of-way (street, alley or other public place) is reserved. *SEE ATTACHED SHEET.*
- Involved; the nature of our services, and the estimated costs of removing and/or rerouting such services are:

(Utility or City Department)

By

Title

Date

Area code - Telephone number

X359

This area is now blocked with jersey barriers and fences. The petitioner must provide PLD with a key. Contact Denise Williams (313-267-7216) to provide entry location and a key so PLD has unimpeded 24-hour heavy truck access to PLD-owned primary electric equipment.

Please withhold formal action until PLD has a key.

Public Lighting Department (PLD)

By Denise Williams

Senior Assistant Mechanical Engineer

8/19/14

313-267-7216

PETITION NO. 359
DETROIT HOUSING COMMISSION
1301 E. JEFFERSON AVE.
DETROIT, MICHIGAN 48207
C/O MARTINA J. ORANGE
PHONE NO. 313 877-8000



SOUTHFIELD FREEWAY

JOY RD. 120 FT. WD.

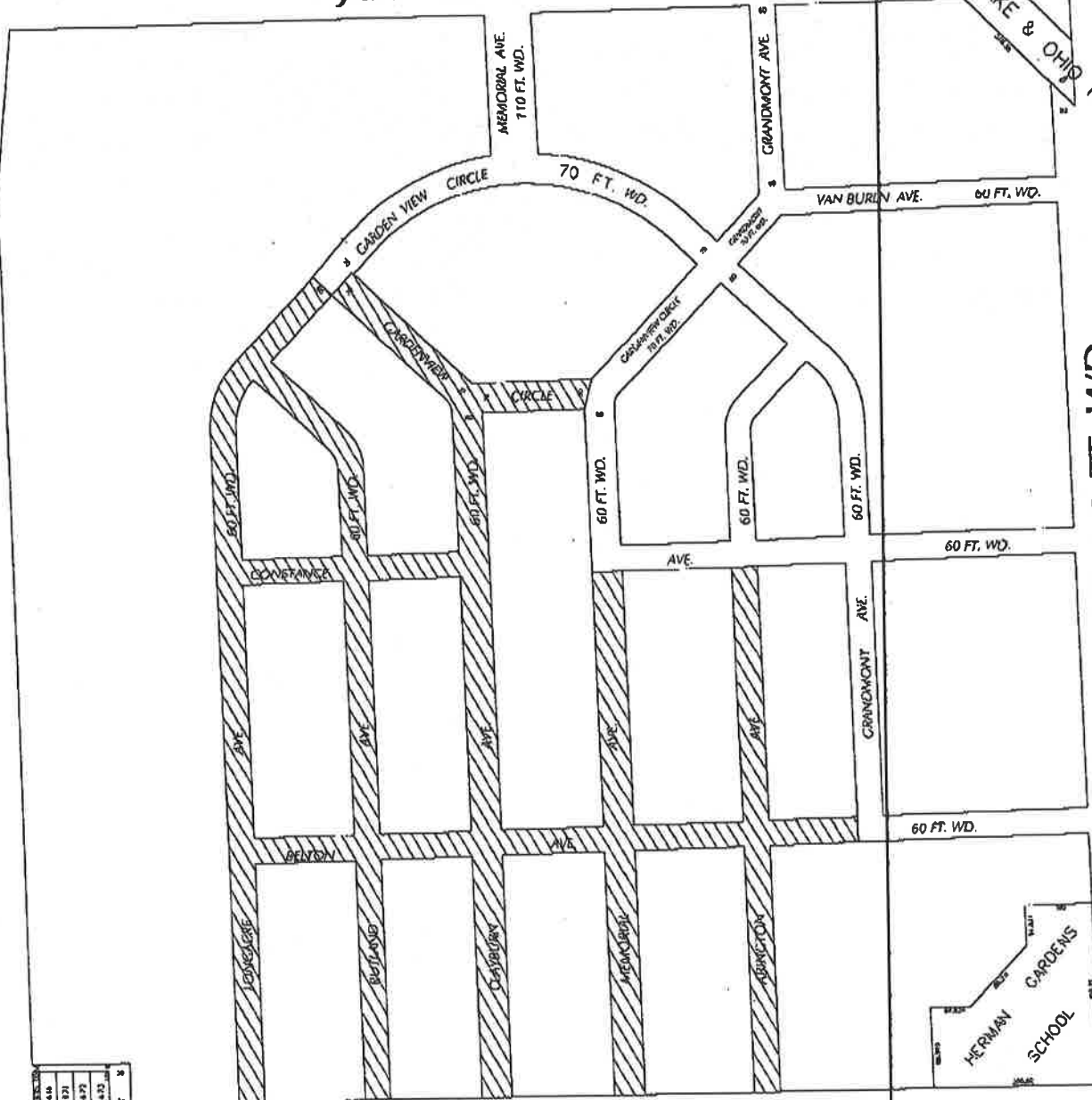

44	45	46	47	48
49	50	51	52	53
54	55	56	57	58
59	60	61	62	63

WEST HAVEN SUB. NO.1

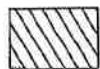

- REQUESTED TEMPORARY STREET CLOSURE

(FOR OFFICE USE ONLY)

TIREMAN AVE. 103 FT. WD.

CARTO 99 B

B					
A					
DESCRIPTION	DRWN	CHKD	APPD	DATE	
REVISIONS					
DRAWN BY	WLW	CHECKED			
DATE	08-04-14	APPROVED			

REQUEST TO TEMPORARY CLOSE
VARIOUS PUBLIC STREET, VARIOUS WD.
IN THE BLOCK BOUND BY
JOY RD., ASBURY PARK, TIREMAN AVE.
AND SOUTHFIELD FWY.

CITY OF DETROIT CITY ENGINEERING DEPARTMENT SURVEY BUREAU	
JOB NO.	01-01
DRWG. NO.	X 359