

City of Detroit  
**City Engineering Division, Department of Public Works  
Survey Bureau**

**NOTICE OF PROPOSED CHANGE IN PROPERTY**

**Date:** 4/28/2014

**Petition:** x2940

- |   |  |
|---|--|
| <input type="checkbox"/> AT&T Telecommunication                         |  |
| <input type="checkbox"/> Cable Television (CATV)                        | <input type="checkbox"/> Vacation                |
| <input checked="" type="checkbox"/> Detroit Edison (DTE)                |  |
| <input type="checkbox"/> Michigan Consolidated Gas (DTE)                | <input type="checkbox"/> Conversion to Easement  |
| <input type="checkbox"/> Fire Department                                | <input type="checkbox"/> Dedication              |
| <input type="checkbox"/> Planning & Development Department              |  |
| <input type="checkbox"/> Public Lighting Dept. - Communication Division | <input checked="" type="checkbox"/> Encroachment |
| <input type="checkbox"/> Public Lighting Dept. - Overhead Line Division |  |
| <input type="checkbox"/> Public Lighting Dept. - Underground Division   | <input type="checkbox"/> Temporary Closing       |
| <input type="checkbox"/> Police Department                              |  |
| <input type="checkbox"/> Recreation Department                          | <input type="checkbox"/> Berm Use                |
| <input type="checkbox"/> Sanitation Division, DPW                       |  |
| <input type="checkbox"/> Street Design Bureau, DPW                      |  |
| <input type="checkbox"/> Street Maintenance Division, DPW               |  |
| <input type="checkbox"/> Street and Traffic Division, DPW               |  |
| <input type="checkbox"/> Water and Sewerage Dept. - Sewer Design        |  |
| <input type="checkbox"/> Water and Sewerage Dept. - Water Design        |  |

A petition drawing is attached. Property shown on the attached print is proposed to be changed as indicated.

Kindly report (using the back of this sheet) the nature of your services (if any) affected by the proposed change and the estimated costs of removing and rerouting such services (if necessary).

Please return one copy to City Engineering Division, DPW. Retain one copy and print for you file.

Alfred Jordan, Director, Department of Public Works

By: Richard Doherty, CED DPW  
Head Engineer

**TO: City Engineering Division, DPW  
65 Cadillac Square, Suite 900  
Detroit, Michigan 48226-2873  
Survey Bureau: 313-224-3970**

x2940

The proposed change in property (referred to on the other side of this sheet) would affect our services as follows:

- Not Involved
- Involved; but asking you to hold action on this petition until further notice.
- Involved; but no objections to the property change .
- Involved; but no objections to the property change...provided as easement of the full width of the public right-of-way (street, alley or other public place) is reserved.
- Involved; the nature of our services, and the estimated costs of removing and/or rerouting such services are:

DTE Electric Company  
(Utility or City Department)

Kimberly A. Tassen  
By

Right of Way Facilitator  
Title

5/23/2014  
Date

313.235.4458  
Area code – Telephone number

PETITION NO. 2940  
 DEE & L DEVELOPMENT CORPORATION  
 1439 GRISWOLD AVE.  
 DETROIT, MICHIGAN 48226  
 C/O LARRY MONGO  
 PHONE NO. 313 303-2071

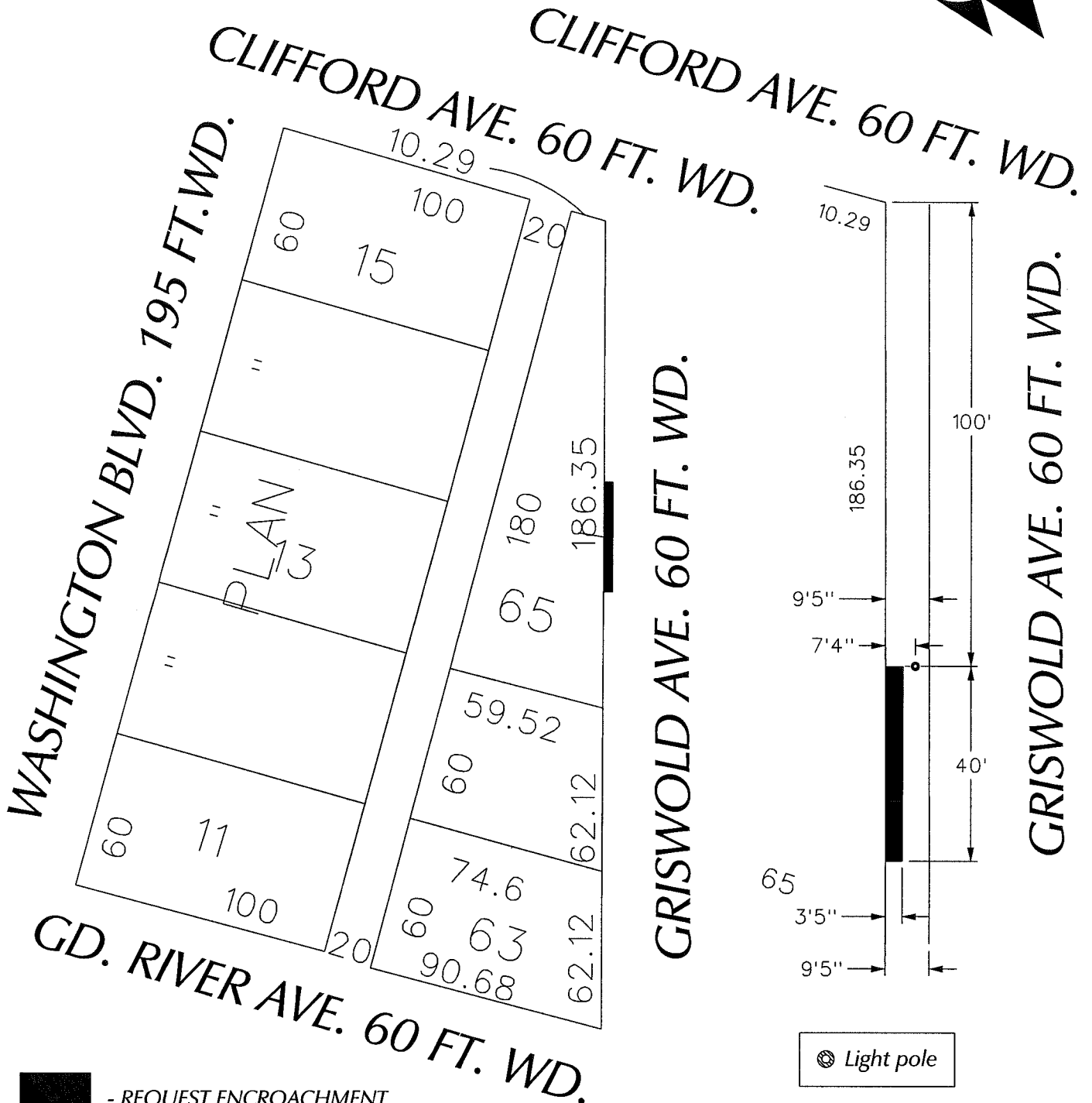

(FOR OFFICE USE ONLY)

CARTO 28 B

B					
A					
DESCRIPTION		DRWN	CHKD	APPD	DATE
REVISIONS					
DRAWN BY		CHECKED			
DATE		APPROVED			
04-24-14					

REQUEST ENCROACHMENT  
 INTO GRISWOLD  
 AT 1439 GRISWOLD  
 (With Outdoor Seating)

CITY OF DETROIT CITY ENGINEERING DEPARTMENT SURVEY BUREAU	
JOB NO.	01-01
DRWG. NO.	X 2940