

- Petti...
- Proport
Owner

WILLIS

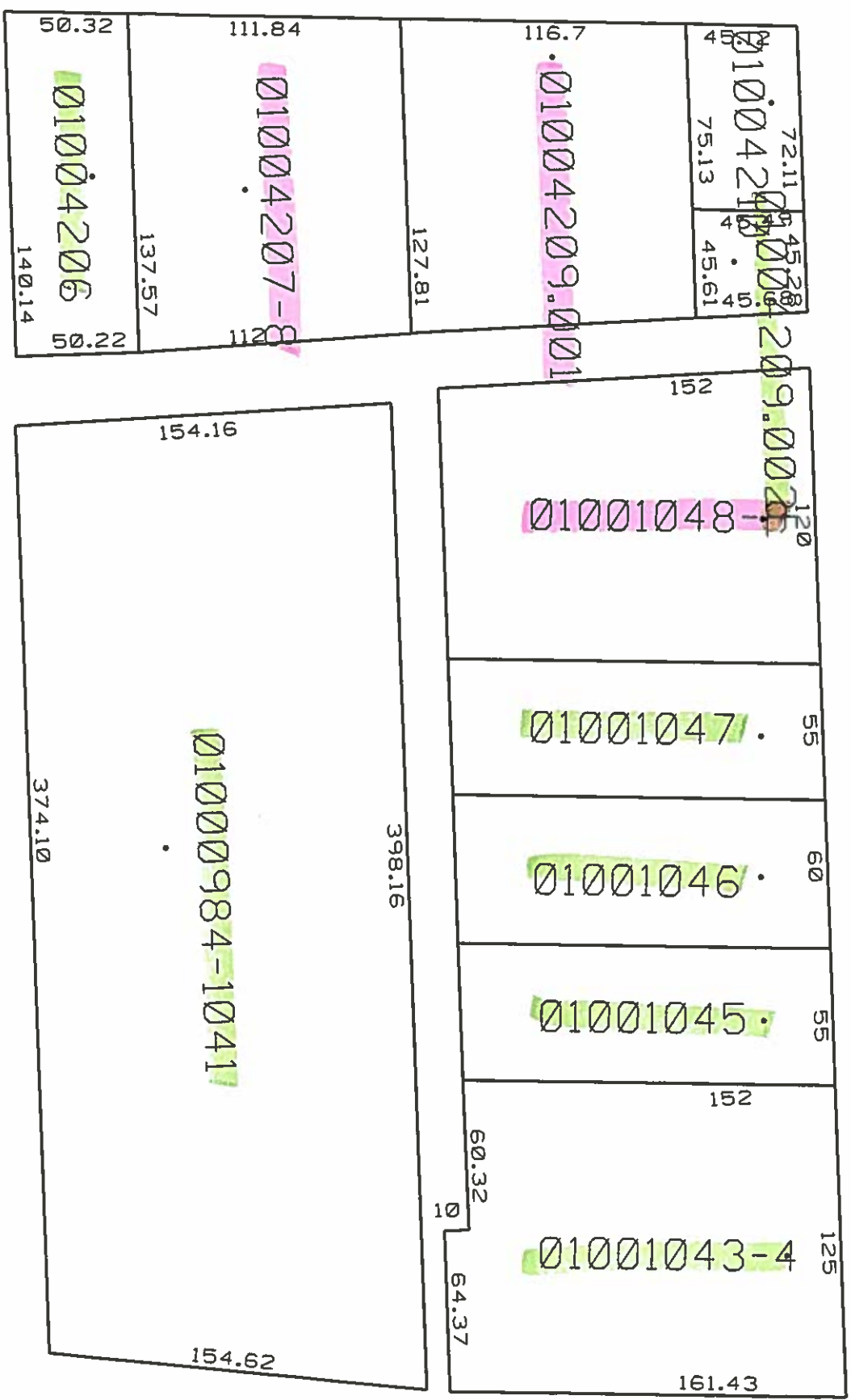

ALEXANDRINE

4100 WOODWARD AVENUE 48201 (Property Address)

Parcel Number: 01004206.



Item 1 of 2 1 Image / 1 Sketch

Property Owner: OID 4100 WOODWARD, LLC

Summary Information

- > Commercial/Industrial Building Summary > Assessed Value: \$184,600 | Taxable Value: \$149,556
 - Yr Built: 1958
 - Total Sq.Ft: 4,889
 - # of Buildings: 1
- > Property Tax information found

Owner and Taxpayer Information

Owner	OID 4100 WOODWARD, LLC 4120 WOODWARD AVE DETROIT, MI 48201-1192	Taxpayer	SEE OWNER INFORMATION
--------------	---	-----------------	-----------------------

General Information for Tax Year 2018

Property Class	201-COMMERCIAL	Unit	01 CITY OF DETROIT
School District	DETROIT PUBLIC SCHOOLS	Assessed Value	\$184,600
WARD#	01	Taxable Value	\$149,556
DISTRICT	4	State Equalized Value	\$184,600
ASMT CODE	<i>Not Available</i>	Date of Last Name Change	12/02/2008
RELATED #	<i>Not Available</i>	Notes	<i>Not Available</i>
Historical District	<i>Not Available</i>	Census Block Group	<i>Not Available</i>
COUNCIL #	<i>Not Available</i>	Exemption	<i>No Data to Display</i>

Principal Residence Exemption Information

Homestead Date *No Data to Display*

Principal Residence Exemption	June 1st	Final
2018	0.0000 %	0.0000 %

Land Information

Zoning Code	B4	Total Acres	0.160
Land Value	\$174,200	Land Improvements	\$1,895
Renaissance Zone	No	Renaissance Zone Expiration Date	<i>No Data to Display</i>
ECF Neighborhood	<i>Not Available</i>	Mortgage Code	<i>No Data to Display</i>
Lot Dimensions/Comments	<i>Not Available</i>	Neighborhood Enterprise Zone	No

Lot(s)	Frontage	Depth
Lot 1	50.00 ft	139.00 ft
Total Frontage: 50.00 ft		Average Depth: 139.00 ft

Legal Description

E WOODWARD S 50.32 FT OF W 140.14 FT 26 LUMSDENS L3 P84 PLATS, W C R 1/57 50.32 IRREG

Sale History

Sale Date	Sale Price	Instrument	Grantor	Grantee	Terms of Sale	Liber/Page
11/20/2008	\$425,000.00	PTA	DAVIES, KENNETH M	OID 4100 WOODWARD, LLC	VALID ARMS LENGTH	
08/01/1997	\$254,000.00	WD			NO CONSIDERATION	29686:39080

Building Information - 4889.00 sq ft Office Buildings (Commercial)

Floor Area	4,889 sq ft	Estimated TCV	<i>Not Available</i>
-------------------	-------------	----------------------	----------------------

32 E WILLIS DETROIT, 48201 (Property Address)

Parcel Number: 01004209.002L



Item 1 of 1 1 Image / 0 Sketches

Property Owner: ANNALISON COMPANY, LLC

Summary Information

> Assessed Value: \$12,800 | Taxable Value: \$11,125 > Property Tax information found

Owner and Taxpayer Information

Owner	ANNALISON COMPANY, LLC 908-2 TERRY LANE KEY WEST, FL 33040	Taxpayer	SEE OWNER INFORMATION
--------------	--	-----------------	-----------------------

General Information for Tax Year 2018

Property Class	202-COMMERCIAL VACANT	Unit	01 CITY OF DETROIT
School District	DETROIT PUBLIC SCHOOLS	Assessed Value	\$12,800
WARD#	01	Taxable Value	\$11,125
DISTRICT	4	State Equalized Value	\$12,800
ASMT CODE	Not Available	Date of Last Name Change	01/05/2011
RELATED #	Not Available	Notes	Not Available
Historical District	Not Available	Census Block Group	Not Available
COUNCIL #	Not Available	Exemption	No Data to Display

Principal Residence Exemption Information

Homestead Date No Data to Display

Principal Residence Exemption	June 1st	Final
2018	0.0000 %	0.0000 %

Land Information

Zoning Code	B4	Total Acres	0.044
Land Value	\$25,600	Land Improvements	\$2,070
Renaissance Zone	No	Renaissance Zone Expiration Date	No Data to Display
ECF Neighborhood	Not Available	Mortgage Code	No Data to Display
Lot Dimensions/Comments	Not Available	Neighborhood Enterprise Zone	No

Lot(s)	Frontage	Depth
Lot 1	45.00 ft	43.00 ft
Total Frontage: 45.00 ft		Average Depth: 43.00 ft

Legal Description

S WILLIS E-- E 45.28 FT ON N LINE BG E 45.61 FT ON S LINE OF W 117.39 FT ON N LINE BG W 120.74 FT ON S LINE PLAT OF PARK LOTS L34 P542 DEEDS, W C R 1/59 45.28 IRREG

Sale History

Sale Date	Sale Price	Instrument	Grantor	Grantee	Terms of Sale	Liber/Page
No sales history found.						

****Disclaimer:** BS&A Software provides BS&A Online as a way for municipalities to display information online and is not responsible for the content or accuracy of the data herein. This data is provided for reference only and WITHOUT WARRANTY of any kind, expressed or inferred. Please contact your local municipality if you believe there are errors in the data.