

TO: City Engineering Division, DPW
900 Cadillac Tower Building
65 Cadillac Square
Detroit, Michigan 48226-2873
Survey Bureau: 313-224-3970
Fax: 313-224-3471

Ref. No. 201303082
Petition No.2668Revised

- () Involved; but asking you to hold action on this petition until further notice.
- () Involved; but no objections to the property change – provided an easement of the full width of the public right-of-way (street, alley or other public place) is reserved.
- () Involved; the nature of our services, and the estimated costs of removing and/or rerouting such services are:
- (x) Involved; have no objection to the requested conversion to easement Keibler Avenue 60 ft wide in the area adjoining Lots 35-43 as shown in drawing X2668 dated 3/25/13 and revised on 8/19/2013, provided that signatures of 100% of all property owners in the block bound by Birch Avenue, Greenfield Avenue, Schoolcraft Avenue, and the N/S alley just west of Whitcomb Avenue are secured.

Traffic Engineering Division - DPW
(Utility or City Department)

for Ashok Patel
By

Jitendra Chauhan

Head Transportation Engineer
Title

August 20, 2013
Date

313-224-1610
Area code-Telephone number

MA/ma

PETITION NO. 2668
 WINNER'S CHAPEL
 13980 GREENFIELD AVENUE
 DETROIT, MICHIGAN 48227
 C/O MARTIN
 PHONE NO. 810 588 0080

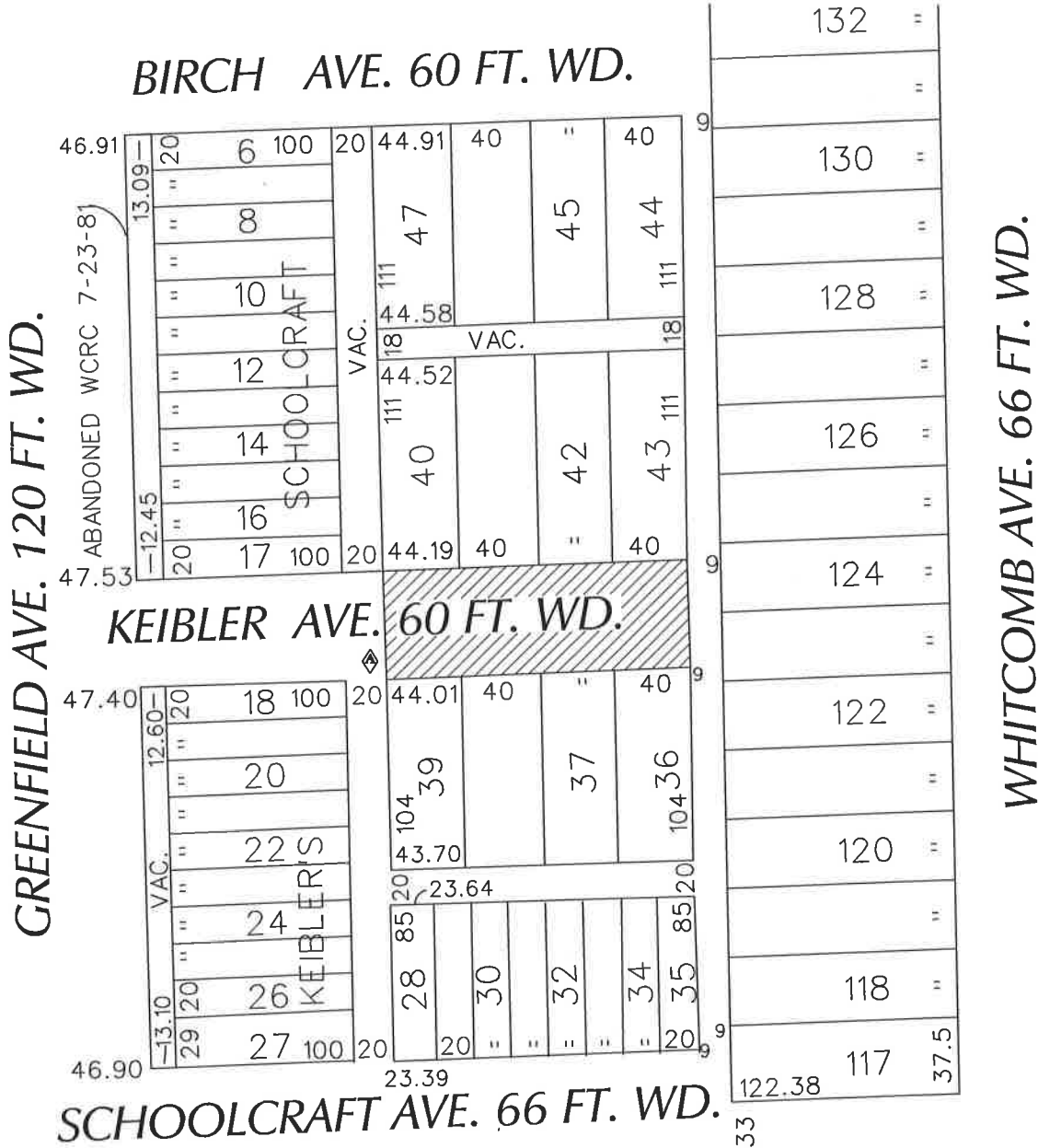

- AREA OF EASEMENT

(FOR OFFICE USE ONLY)

CARTO 84 D

B					
A	REDUCED ESM'NT TO ADJOINING LOTS 36-43	K.S.M.			8/19/13
REVISIONS					
DESCRIPTION	DRWN	CHKD	APPD	DATE	
DRAWN BY	CHECKED				
DATE	APPROVED				
3-25-13					

REQUEST CONVERSION TO EASEMENT
KEIBLER AVE. 60 FT. WD.
IN AREA ADJOINING
LOTS 36-43

CITY OF DETROIT	
CITY ENGINEERING DEPARTMENT	
SURVEY BUREAU	
JOB NO.	01-01
DRWG. NO.	X2668