



DTE Energy - Michigan Consolidated Gas Company
Data Integrity and Technology, Drafting Department
One Energy Plaza, WCB-1836, 18TH Floor
City of Detroit, MI 48226

April 2, 2013

Richard Doherty, CED DPW, City Engineer
City of Detroit Engineering Division, DPW
65 Cadillac Square, Suite 900
City of Detroit, MI 48226-2873

RE: Petition #2668 Dated: 03/26/2013

The proposed change in property referred to would affect our services as follows:

- Not involved, no gas involved, and no objections. **See Remarks!**
- Involved but withholding action on petition until further notice.
- Involved but have no objection to the property change, provided that an easement of the full width of of the street/alley is reserved as shown.
- Involved – nature of services and estimated cost of removing or rerouting such services are:

REMARKS:

Not involved, no gas involved, and no objections to the request for Conversion to Easement the 60' Wd. Keibler Ave. from Greenfield East o 18' Wd. N/S Alley. Please see enclosed strip print for your use and information.

Please abide by Public Act 53, three (3) working days before you dig, dial toll free MISS DIG at: 1 – 800 – 482 – 7171.

Michcon Gas Leak Emergency Phone Number: 1- 800 – 947 – 5000.

Sincerely,

/s/ Eddie A. Reyes
Senior Drafter
Data Integrity and Technology

EAR/
Enclosure

RECEIVED APR 04 2013



STATE LAW ACT 53
3 WORKING DAYS
BEFORE YOU DIG
DIAL TOLL FREE
1-800-482-7171
OR 811

WARNING!
HIGH PRESSURE
GAS MAIN

WARNING!
HIGH PRESSURE
GAS MAIN

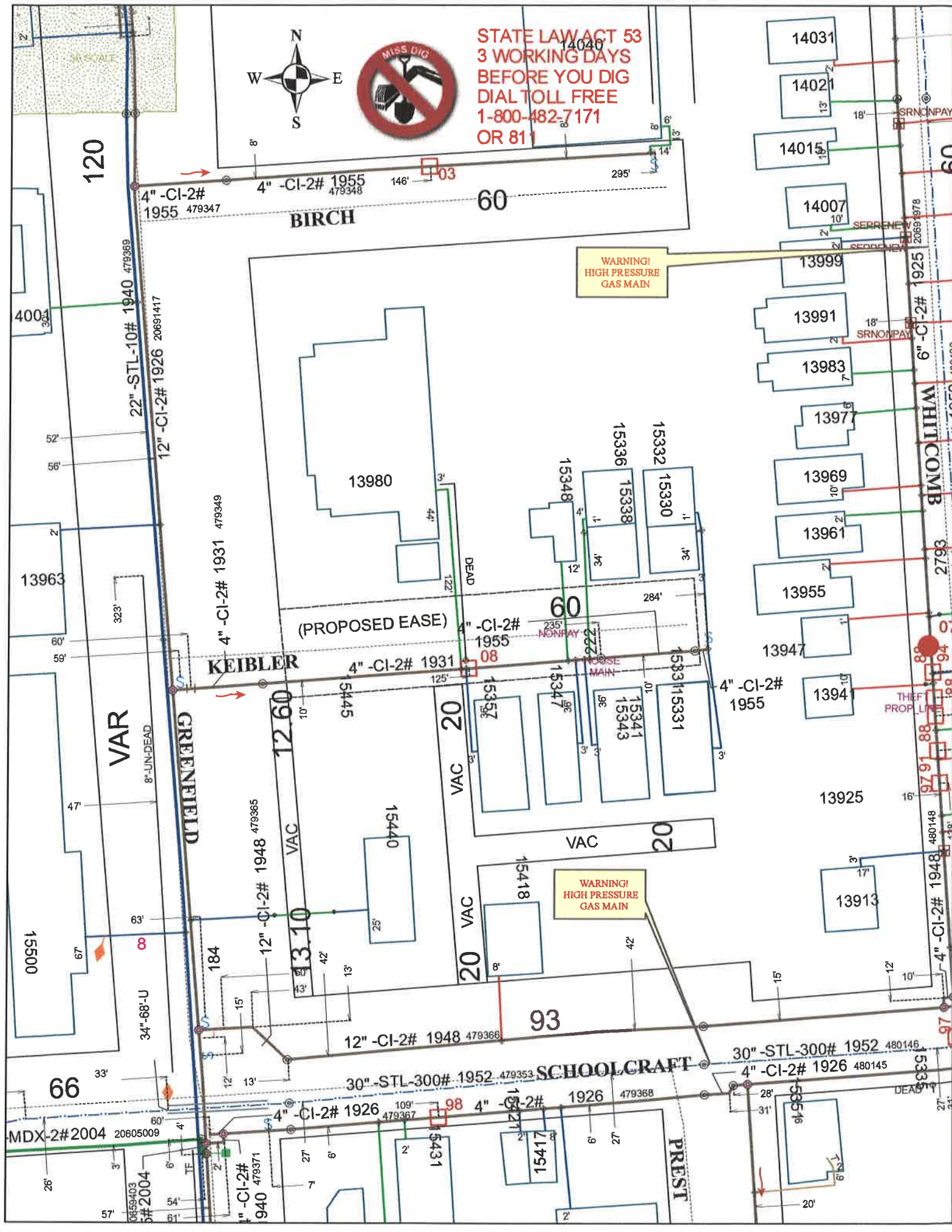

City of Detroit
**City Engineering Division, Department of Public Works
Survey Bureau**

NOTICE OF PROPOSED CHANGE IN PROPERTY

Date: 3-26-2013

Petition: x 2668

- | | |
|---|--|
| <input type="checkbox"/> AT&T Telecommunication | |
| <input type="checkbox"/> Cable Television (CATV) | <input type="checkbox"/> Vacation |
| <input type="checkbox"/> Detroit Edison (DTE) | |
| <input type="checkbox"/> Michigan Consolidated Gas (DTE) | <input checked="" type="checkbox"/> Conversion to Easement |
| <input type="checkbox"/> Fire Department | <input type="checkbox"/> Dedication |
| <input type="checkbox"/> Planning & Development Department | |
| <input type="checkbox"/> Public Lighting Dept. - Communication Division | <input type="checkbox"/> Encroachment |
| <input type="checkbox"/> Public Lighting Dept. - Overhead Line Division | |
| <input type="checkbox"/> Public Lighting Dept. - Underground Division | <input type="checkbox"/> Temporary Closing |
| <input type="checkbox"/> Police Department | |
| <input type="checkbox"/> Recreation Department | <input type="checkbox"/> Berm Use |
| <input type="checkbox"/> Sanitation Division, DPW | |
| <input type="checkbox"/> Street Design Bureau, DPW | |
| <input type="checkbox"/> Street Maintenance Division, DPW | |
| <input type="checkbox"/> Street and Traffic Division, DPW | |
| <input type="checkbox"/> Water and Sewerage Dept. - Sewer Design | |
| <input type="checkbox"/> Water and Sewerage Dept. - Water Design | |

A petition drawing is attached. Property shown on the attached print is proposed to be changed as indicated.

Kindly report (using the back of this sheet) the nature of your services if any) affected by the proposed change and the estimated costs of removing and rerouting such services (if necessary).

Please return one copy to City Engineering Division, DPW. Retain one copy and print for you file.

Alfred Jordan, Director, Department of Public Works

By: Richard Doherty, CED DPW
Head Engineer

